



LEOPARD IMAGING INC

Rev. 1.2

## Key Features

- USB 3.0 Super Speed support
- YUV output without compression
- UVC compliance
- Support External Trigger, Software Trigger
- Support register access function
- Support either CS or M12 lens
- Provide customization services
- USB +5VDC powered device
- Support 1080P WDR
- Built in AP0202 ISP
- Compact Size: 26mmx26mm
- 2 Boards are stacked

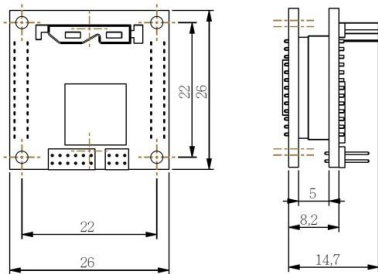

# LI-USB30-AR023ZWDR

## Data Sheet



## Default Lens Specification

- Model: M13B0618WR5
- Focal length: 6.0 mm
- Aperture, F/#: 1.8
- Built in IR cut filter
- FOV (D/H/V): 69° / 58° / 31°
- Mount: M12 x 0.5 – 6g

## Applications

- Machine Vision
- Medical Camera
- Video Conference
- Scientific Camera

## SDK Supported

- Camera Tool Source Code in C#
- Capture & Display
- Register access



Leopard Imaging Inc.

1130 Cadillac Ct., Milpitas, CA 95035, USA  
Phone: +1-408-263-0988  
Fax: +1-408-217-1960  
Email: sales@leopardimaging.com  
Website: www.leopardimaging.com

# Specification

General Behavior	
Video Resolution @ Frame rate	1920 x 1080 @ 30 fps, WDR
Sensitivity	TBD
Dynamic range	12 bit
Interface (Optical)	
IR cut filter (on lens)	Yes
Sensor specification	ON Semiconductor AR023Z 1080p HD Sensor
Shutter	Rolling
Format	1/2.7"
Resolution	H:1928, V:1088
Pixel size	H:3.0 um, V: 3.0 um
WDR	Support WDR (Wide Dynamic Range)
Color / Mono	Color
Lens mount	CS / M12 lens mount support (Default: M12 lens)
M12 Lens	6.0 mm (default), 4.2 mm, 2.6 mm Focal Length
Interface (Electrical)	
Interface	USB 3.0
Supply voltage	USB 3.0 +5 VDC power source
Current consumption	Approx. 297 mA at 5 VDC
Interface (Mechanical)	
Dimensions	L: 26 mm, W: 26 mm, H: 38 mm
Mass	22 g
Adjustment (Manual)	
Shutter	TBD
Gain	TBD
Register access	Support
Adjustment (Auto)	
Shutter	TBD
Gain	TBD
Environmental	
Max. temperature (operation)	0 °C ~ 50 °C (32 °F~ 122 °F)
Max. temperature (storage)	-20 °C ~ 80 °C (-4 °F~176 °F)
Max. humidity (operation)	20 % ~ 80 %, relative, non-condensing
Max. humidity (storage)	20 % ~ 80 %, relative, non-condensing



## X-ON Electronics

Largest Supplier of Electrical and Electronic Components

*Click to view similar products for [Cameras & Camera Modules](#) category:*

*Click to view products by [Leopard Imaging](#) manufacturer:*

Other Similar products are found below :

[FH-SC](#) [CAMOV5645](#) [73-540-420I](#) [Web Camera module 5.0M pixel](#) [LI-IMX424-GMSL2-070H](#) [73-951-0046](#) [73-954-0001T](#) [73-961-0005](#)  
[1202](#) [1203](#) [73-961-0003](#) [73-961-0012](#) [107139](#) [106983](#) [107115](#) [107149](#) [107142](#) [82535IVCHVM](#) [107140](#) [107113](#) [107112](#) [107141](#) [107147](#)  
[107148](#) [107110](#) [107150](#) [107145](#) [107111](#) [OKY3553](#) [10299](#) [10300](#) [11388](#) [613](#) [EP-DCINTELD-415](#) [1386](#) [4321](#) [4561](#) [43203](#) [104002](#)  
[105716](#) [105993](#) [107206](#) [107645](#) [107646](#) [107655](#) [108010](#) [108172](#) [108173](#) [CLEO-CAM1](#) [107114](#)