



LEOPARD IMAGING INC

LI-USB30-ISX017

Data Sheet

Key Features

- USB 3.0 Super Speed support
- YUV output without compression
- UVC compliance
- Support either CS or M12 lens
- Provide customization services
- USB +5VDC powered device
- Support WDR
- Compact Size: 26mmx26mm
- 2 Boards are stacked

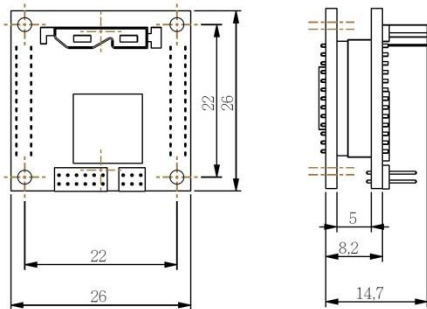

Default Lens Specification

- Model: YC-155N
- Focal length: 2.8 mm
- Aperture, F/#: 2.0
- Built in 650nm IR cut filter
- FOV (D/H/V): 97 ° / 87 ° / 50.5 °
- TV Distortion: < 12%
- Mount: M12 x P0.5

Applications

- Machine Vision
- Medical Camera
- Video Conference
- Scientific Camera

SDK Supported

- Camera Tool Source Code in C#
- Capture & Display



Leopard Imaging Inc.

1130 Cadillac Ct., Milpitas, CA 95035, USA
Phone: +1-408-263-0988
Fax: +1-408-217-1960
Email: sales@leopardimaging.com
Website: www.leopardimaging.com
www.leopard-security.com

Specification

General Behavior	
Video Resolution @ Frame rate	1280 x 720 @ 30 fps
Sensitivity	TBD
Interface (Optical)	
IR cut filter	Yes (on Lens)
Sensor specification	Sony ISX017 CMOS Sensor
Shutter	Rolling
Format	1/3.2"
Resolution	H:1297, V:977
Pixel size	H:3.5 um, V: 3.5 um
Color/Mono	Color
WDR	Support WDR (Wide Dynamic Range)
Lens mount	CS / M12 lens mount support (Default: M12 lens)
M12 Lens	6.0 mm, 2.8mm (default), 2.6 mm Focal Length
Interface (Electrical)	
Interface	USB 3.0
Supply voltage	USB 3.0 +5 VDC power source
Current consumption	Approx. 110 mA at 5 VDC
Interface (Mechanical)	
Dimensions (with lens)	L: 26 mm, W: 26 mm, H: 38 mm
Mass	20 g
Adjustment (Manual)	
Shutter	TBD
Gain	TBD
Adjustment (Auto)	
Shutter	TBD
Gain	TBD
Environmental	
Max. temperature (operation)	0 °C ~ 50 °C (32 °F~ 122 °F)
Max. temperature (storage)	-20 °C ~ 80 °C (-4 °F~176 °F)
Max. humidity (operation)	20 % ~ 80 %, relative, non-condensing
Max. humidity (storage)	20 % ~ 80 %, relative, non-condensing



Leopard Imaging Inc.

1130 Cadillac Ct., Milpitas, CA 95035, USA
Phone: +1-408-263-0988
Fax: +1-408-217-1960
Email: sales@leopardimaging.com
Website: www.leopardimaging.com
www.leopard-security.com

X-ON Electronics

Largest Supplier of Electrical and Electronic Components

Click to view similar products for [Cameras & Camera Modules](#) category:

Click to view products by [Leopard Imaging](#) manufacturer:

Other Similar products are found below :

[FH-SC](#) [CAMOV5645](#) [73-540-420I](#) [Web Camera module 5.0M pixel](#) [LI-IMX424-GMSL2-070H](#) [73-951-0046](#) [73-954-0001T](#) [73-961-0005](#)
[1202](#) [1203](#) [73-961-0003](#) [73-961-0012](#) [107139](#) [106983](#) [107115](#) [107149](#) [107142](#) [82535IVCHVM](#) [107140](#) [107113](#) [107112](#) [107141](#) [107147](#)
[107148](#) [107110](#) [107150](#) [107145](#) [107111](#) [OKY3553](#) [10299](#) [10300](#) [11388](#) [613](#) [EP-DCINTELD-415](#) [1386](#) [4321](#) [4561](#) [43203](#) [104002](#)
[105716](#) [105993](#) [107206](#) [107645](#) [107646](#) [107655](#) [108010](#) [108172](#) [108173](#) [CLEO-CAM1](#) [107114](#)