

PSD3508 Thru PSD3516

High Current Glass Passivated Molding Three -Phase Bridge Rectifier

Reverse Voltage 800 to 1600V Forward Current 35A

FEATURES

- Plastic Package has Underwriters Laboratory Flammability Classification 94V-0
- High current capacity with small package
- Glass passivated chip junctions
- Superior thermal conductivity
- High IFSM



1. Maximum & Thermal Characteristics Ratings at 25°C ambient temperature unless otherwise specified.

Item	Symbol	PSD3508	PSD3510	PSD3512	PSD3514	PSD3516	Unit
Maximum repetitive voltage	VRM	800	1000	1200	1400	1600	V
Maximum RMS Voltage	VRMS	560	700	840	980	1120	
Maximum DC Blocking Voltage	VDC	800	1000	1200	1400	1600	V
Peak Reverse Current (per leg) @Tj = 25°C	IR	10					μA
At Rated DC Blocking Voltage @Tj = 125°C		5					mA
Average rectified forward current 60Hz sine wave,R-load with heatsink Tc=62°C	Io	35					A
Peak forward surge current 8.3ms single half sine-wave superimposed on rated load	IFSM	450					A
RMS Isolation Voltage from Case to Lead	VISOL	2500					V
Max instantaneous forward voltage @17.5A/25°C	VF	1.1					V
Typical Thermal Resistance per Element	RθJC	1					°C/W
I2t Rating for Fusing	I2t	1030					A2sec
Operating junction temperature	Tj	-40~150					°C
Storage temperature	Tstg	-40~150					°C

PSD3508 Thru PSD3516

2. Ratings and Characteristic Curves ($T_A = 25^\circ\text{C}$ unless otherwise noted)

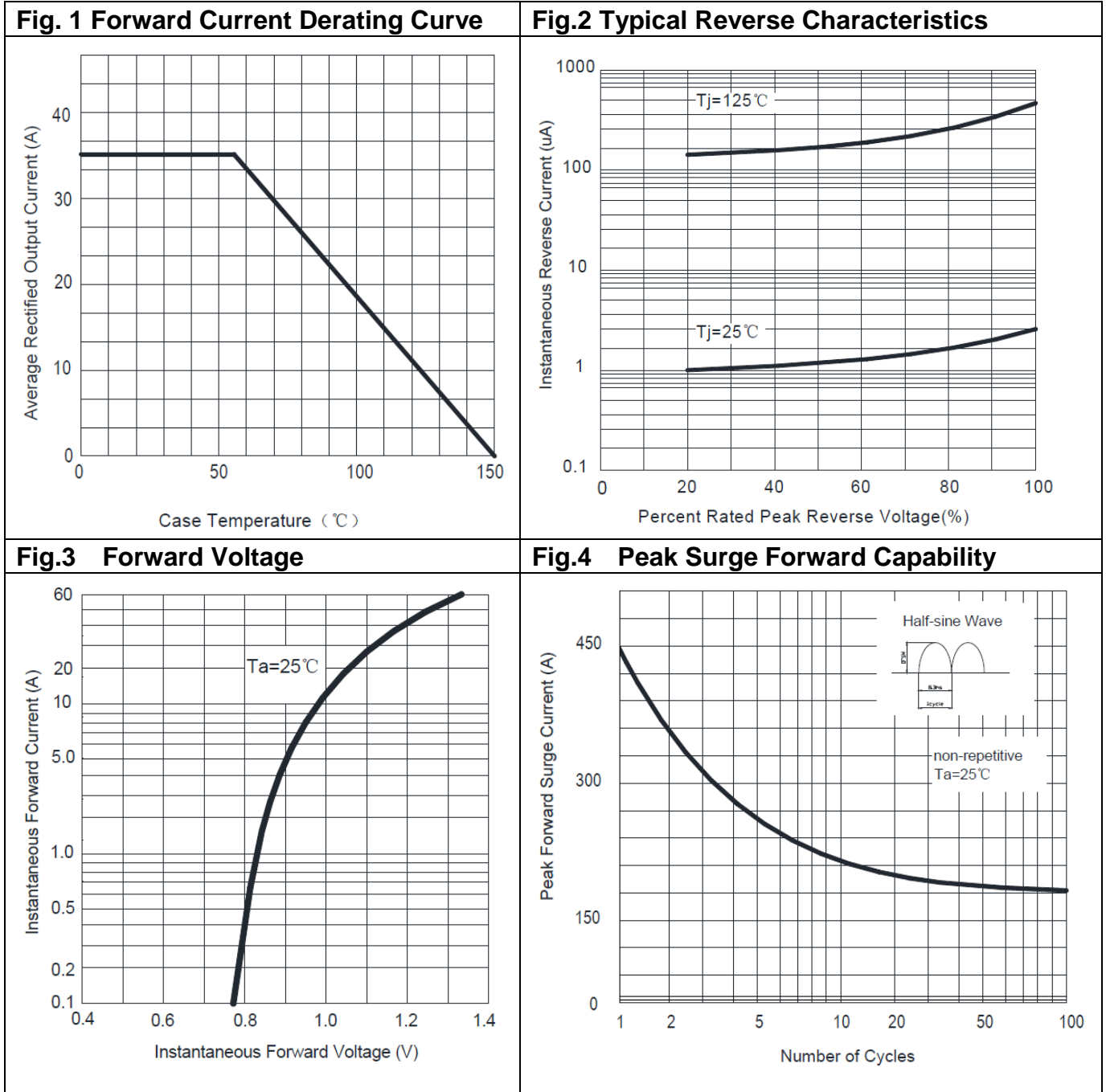

PSD3508 Thru PSD3516

3. Marking Identification

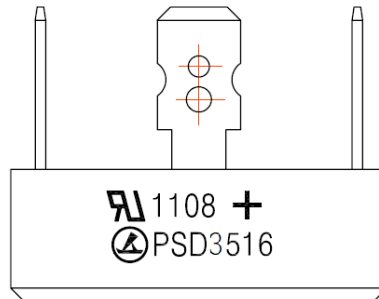

Note:

生产日期码包含4位数字，例如“1040”，前两个数字“10”表示为2010年，另外二个数字“40”是指第40周，即表示该产品为2010年40周生产。

型号：**PSD 35 14**

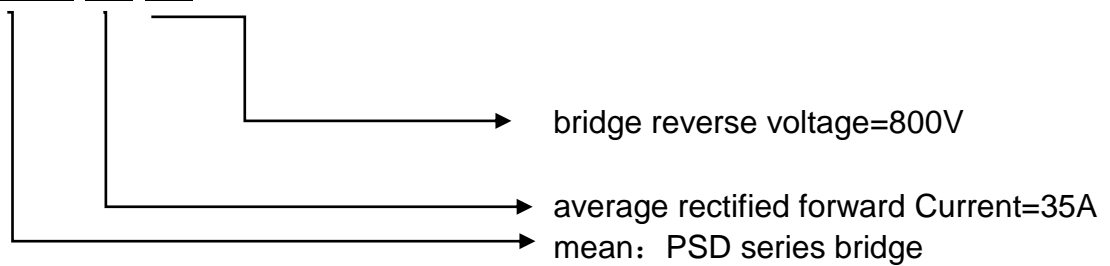

4. Dimension

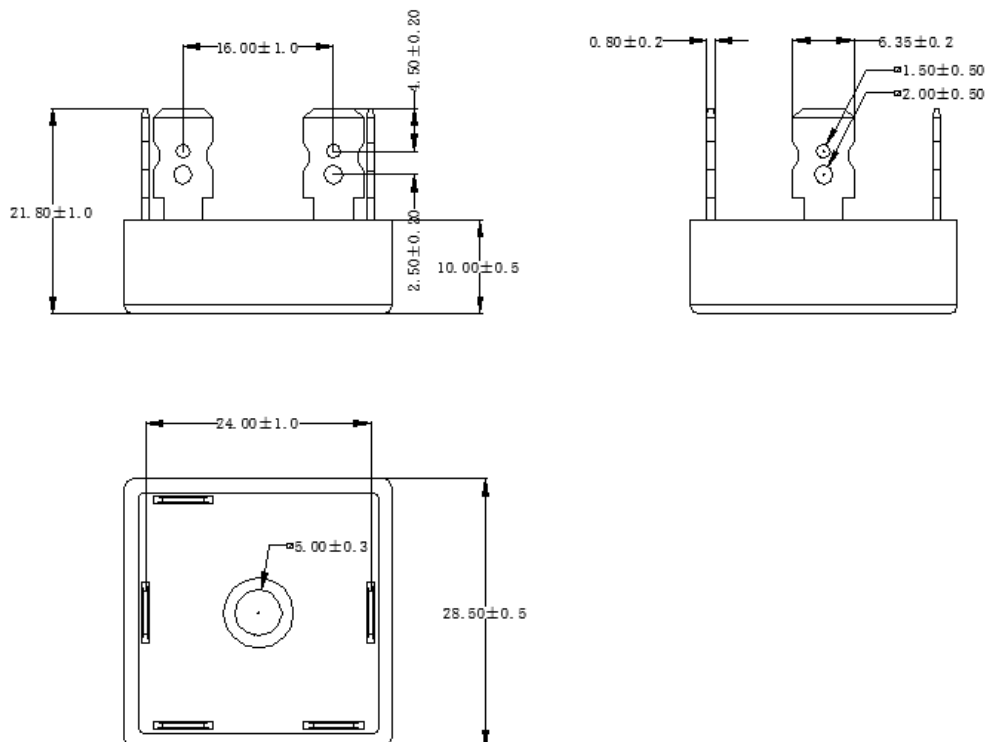

PSD3508 Thru PSD3516

5. Update Record

版次	更新记录	更新作者	更新日期
1	第一版	王锋	2010-5-25

X-ON Electronics

Largest Supplier of Electrical and Electronic Components

Click to view similar products for [Bridge Rectifiers](#) category:

Click to view products by [Leshan](#) manufacturer:

Other Similar products are found below :

[G3SBA60-E351](#) [GBJ1504-BP](#) [GBU10B-BP](#) [GBU15J-BP](#) [GBU15K-BP](#) [GBU4A-BP](#) [GBU4D-BP](#) [GBU6B-E3/45](#) [GSIB680-E3/45](#) [DB101-BP](#) [DBA100G](#) [DBA150G](#) [DBA20G](#) [DBA250G](#) [DBA40G](#) [DBD10G-TM-E](#) [DBF10G](#) [DBF250G](#) [DBG150G](#) [DBG250G](#) [DF10SA-E345](#) [APT30DF100HJ](#) [APT60DF20HJ](#) [B2S-E3/80](#) [BU1506-E351](#) [BU15085S-E345](#) [BU1508-E3/45](#) [BU1510-E3/45](#) [RS404GL-BP](#) [RS405GL-BP](#) [G3SBA20-E3/51](#) [G5SBA20-E3/51](#) [G5SBA60-E3/51](#) [GBJ1502-BP](#) [GBL02-E351](#) [GBL10-E3/45](#) [GBU10J-BP](#) [GBU4J-BP](#) [GBU4K-BP](#) [GBU6G-E3/45](#) [GBU8B-E3/45](#) [GBU8D-BP](#) [GBU8J-BP](#) [GSIB1520-E3/45](#) [MB1510](#) [MB352W](#) [MB6M-G](#) [B2M-E345](#) [B40C7000A](#) [B500C7000A](#)