

RS2ABF thru RS2MABF

Surface Mount Glass Passivated Super Fast Rectifiers

Reverse Voltage 50 to 1000V Forward Current 2.0A

FEATURES

- * Plastic package has Underwriters Laboratory Flammability Classification 94V-0
- * High temperature metallurgically bonded construction
- * Cavity-free glass passivated junction
- * Capable of meeting environmental standards of MIL-S-19500
- * Fast Switching for high efficiency
- * Typical IR less than 1.0 μ A
- * High temperature soldering guaranteed: 260°C/10 seconds

Terminals: Plated leads, solderable per

Case: JEDEC SMB-FL, molded plastic over glass die

Terminals: Plated leads, solderable per MIL-STD-750, Method 2026

Polarity: Color band denotes cathode end

Mounting Position: Any

Weight: 0.066 g

Handling precaution: None

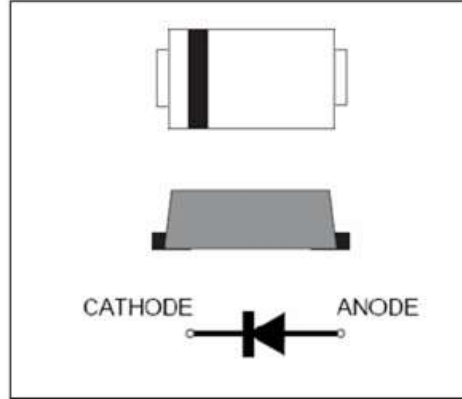

we declare that the material of product is halogen free (green epoxy compound).

1. Maximum & Thermal Characteristics Ratings at 25°C ambient temperature unless otherwise specified.

Parameter Symbol	symbol	RS2ABF	RS2BBF	RS2DBF	RS2GB _F	RS2JBF	RS2KBF	RS2MB _F	RS2MPBF	Unit
Device marking code		RS2A	RS2B	RS2D	RS2G	RS2J	RS2K	RS2M	RS2MP	
Maximum repetitive peak reverse voltage	V _{RRM}	50	100	200	400	600	800	1000	1000	V
Maximum RSM voltage	V _{RSM}	35	70	140	280	420	560	700	700	V
Maximum DC blocking voltage	V _{DC}	50	100	200	400	600	800	1000	1000	V
Maximum average forward rectified current 0.375" (9.5mm) lead length at T _C = 75°C	IF(AV)	2.0								A
Peak forward surge current 8.3ms single half sine-wave superimposed on rated load (JEDEC Method)	I _{FSM}	70								A
Typical thermal resistance (Note 2)	R θ JA	135								°C/W
	R θ JC	25								
Operating junction and storage temperature range	T _J , T _{STG}	-50 to +150								°C

Electrical Characteristics Ratings at 25°C ambient temperature unless otherwise specified.

Parameter Symbol	symbol	RS2ABF	RS2BBF	RS2DBF	RS2GB _F	RS2JBF	RS2KBF	RS2MB _F	RS2MPBF	Unit
Maximum instantaneous forward voltage at 2.0A	V _F	1.3								V
Maximum DC reverse current I _R = 25°C at rated DC blocking voltage T _J = 125°C	I _R	5.0								μ A
		100								
Typical reverse recovery time (Note 1)	t _{rr}	150				500		250		ns
Typical junction capacitance at 4.0V, 1MHz	C _J	8.0								PF

NOTES:

1. IF = 0.5A, IR = 1.0A, IRR = 0.25A
2. 8.0mm² (.013mm thick) land areas

RS2ABF thru RS2MABF

2. Ratings and Characteristic Curves (TA = 25°C unless otherwise noted)

Fig. 1 - Forward Current Derating Curve

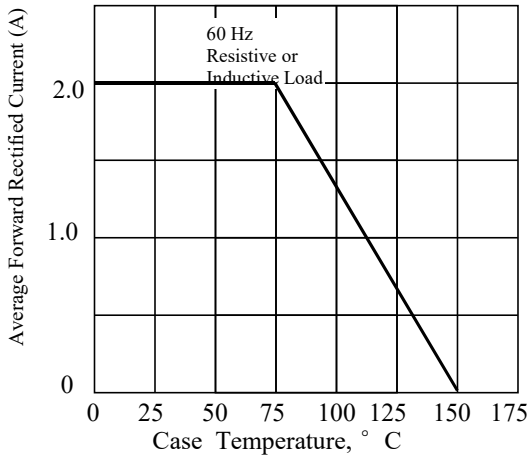

Fig. 2 - Maximum Non-repetitive Peak Forward Surge Current

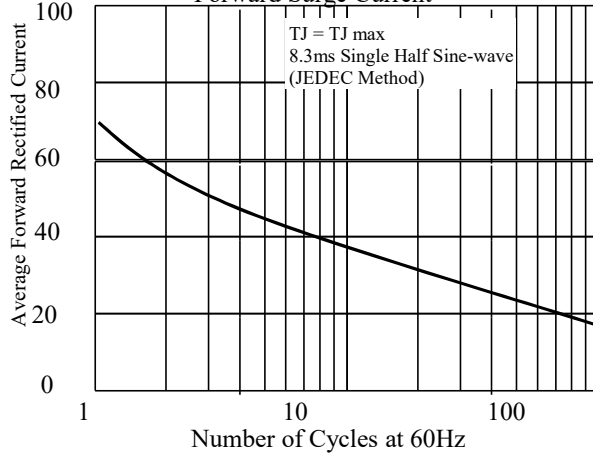

Fig 3 - Typical Instantaneous Forward Characteristics

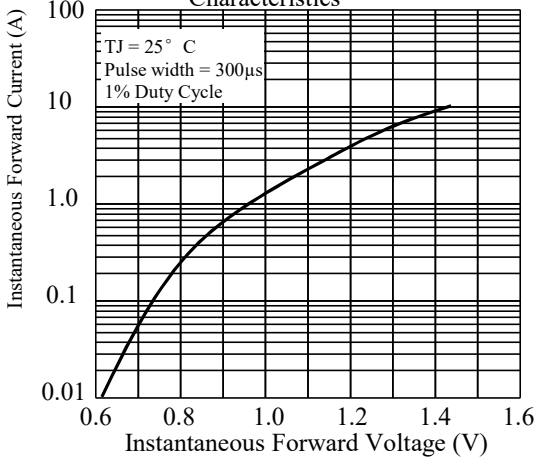

Fig 4 - Typical Reverse Characteristics

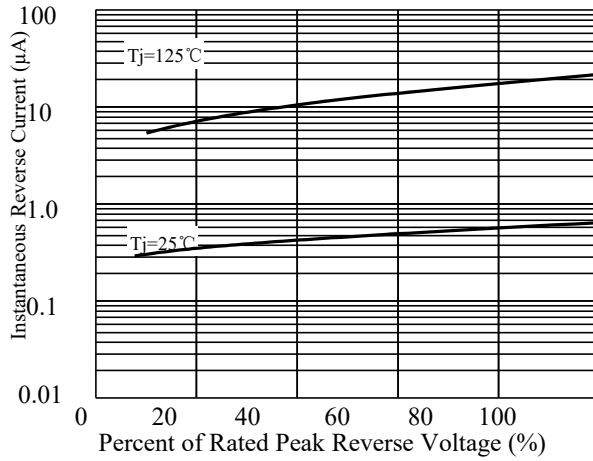

Fig 5 - typical transient thermal impedance

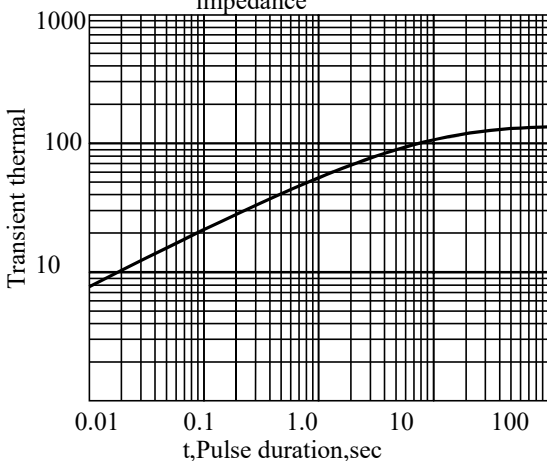
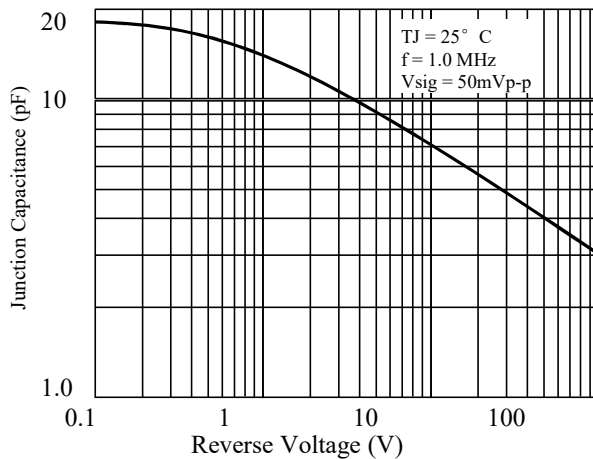

Fig 6 - Typical Junction Capacitance



RS2ABF thru RS2MABF

3. dimension:

SMB-FL

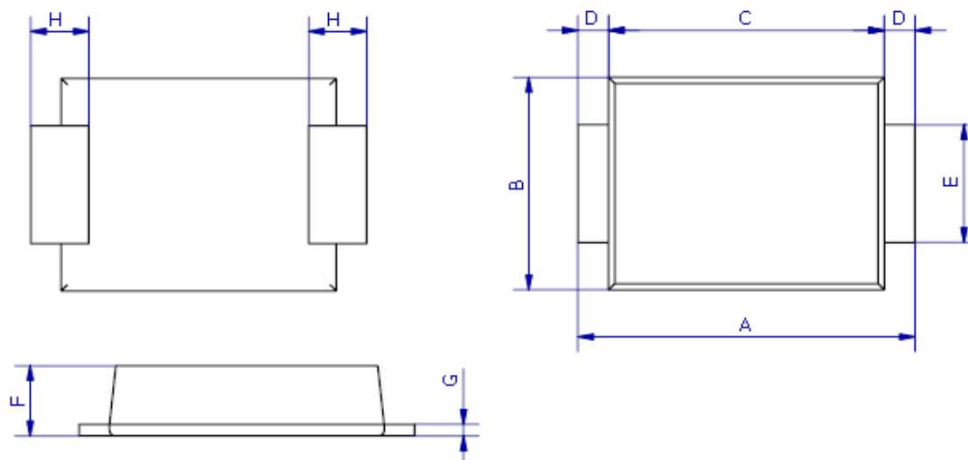

DIM	MILLIMETERS		INCHES	
	MIN	MAX	MIN	MAX
A	5.3	5.7	0.209	0.224
B	3.4	3.8	0.134	0.150
C	4.3	4.7	0.169	0.185
D	0.45Typ		0.018Typ	
E	1.9	2.1	0.0748	0.08268
F	1.05	1.40	0.04134	0.05512
G	0.2	0.3	0.00591	0.00984
H	0.95Typ		0.037Typ	

Mounting Pad Layout

--- SMB-FL

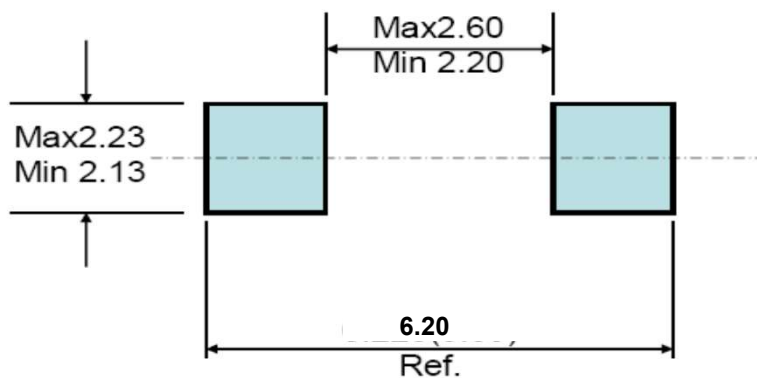

RS2ABF thru RS2MABF

4. Update Record

版次	更新记录	更新作者	更新日期
1	第一版	周杰	2014. 04. 30

X-ON Electronics

Largest Supplier of Electrical and Electronic Components

Click to view similar products for [Diodes - General Purpose, Power, Switching category:](#)

Click to view products by [Leshan manufacturer:](#)

Other Similar products are found below :

[MCL4151-TR3](#) [MMBD3004S-13-F](#) [RD0306T-H](#) [1N3611](#) [NTE156A](#) [NTE574](#) [NTE6244](#) [1SS193,LF](#) [1SS400CST2RA](#) [SDAA13](#)
[SHN2D02FUTW1T1G](#) [LS4151GS08](#) [1N4449](#) [1N456A](#) [1N4934-E3/73](#) [1N914BTR](#) [RFUH20TB3S](#) [D291S45T](#) [BAV300-TR](#) [BAW56DWQ-](#)
[7-F](#) [BAW56M3T5G](#) [BAW75-TAP](#) [MM230L-CAA](#) [IDW40E65D1](#) [JAN1N3600](#) [JAN1N4454UR-1](#) [LL4151-GS18](#) [SMMSD4148T3G](#)
[BYW95B/A52A](#) [NSVDAN222T1G](#) [CDSZC01100-HF](#) [LL4150-M-08](#) [1N4454-TR](#) [BAV70HDW-7](#) [BAS28-7](#) [JANTX1N6640](#) [BAW56HDW-](#)
[13](#) [BAS28 TR](#) [VS-HFA04SD60STR-M3](#) [NSVM1MA152WKT1G](#) [1SS388-TP](#) [RGP30D-E3/73](#) [VS-8EWF02S-M3](#) [BAV99TQ-13-F](#)
[BAV99HDW-13](#) [MMDB30-E28X](#) [IDP20C65D2XKSA1](#) [LS4148](#) [IDV15E65D2](#) [NSVM1MA152WAT1G](#)