

SMC/DO-214AB

FEATURES

- Plastic package has Underwrites Laboratory Flammability Classification 94V-0
- Metal-Silicon Junction
- For surface mount applications
- Guard ring for over voltage protection
- High forward surge current capability
- Super Low forward voltage
- High temperature soldering guaranteed: 260°C/10 seconds at terminals

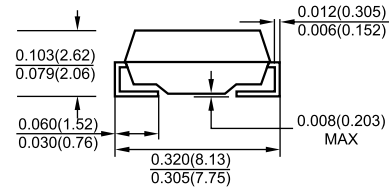
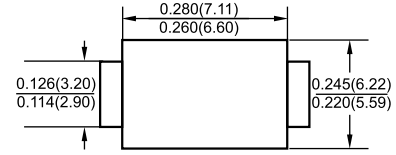

Dimensions in inches and (millimeters)

MECHANICAL DATA

- Case: Transfer molded plastic
- Epoxy: UL94V-O rate flame retardant
- Polarity: Color band denotes cathode end
- Lead: Plated axial lead, solderable per MIL-STD-750 method 2026
- Mounting position: Surface Mounted
- Weight: 0.007 ounce, 0.25 grams

MAXIMUM RATINGS AND ELECTRICAL CHARACTERISTICS

- Ratings at 25°C ambient temperature unless otherwise specified
- Single Phase, half wave, 60Hz, resistive or inductive load
- For capacitive load derate current by 20%

	SYMBOLS	ES5A	ES5B	ES5D	ES5G	ES5J	ES5K	ES5M	UNIT
Maximum Repetitive Peak Reverse Voltage	V_{RRM}	50	100	200	400	600	800	1000	Volts
Maximum RMS Voltage	V_{RMS}	35	70	140	280	420	560	720	Volts
Maximum DC Blocking Voltage	V_{DC}	50	100	200	400	600	800	1000	Volts
Maximum Average Forward Rectified Current	$I_{(AV)}$	5.0							Amp
Peak Forward Surge Current 8.3ms single half sine-wave superimposed on rated load	I_{FSM}	150							Amps
Maximum Instantaneous Forward Voltage at 5.0A (Note 1)	V_F	0.95		1.25		1.68		Volts	
Maximum DC Reverse Current at rated DC Blocking Voltage	$T_A = 25^\circ C$	5							u A
	$T_A = 100^\circ C$	100							
Maximum reverse recovery time(Note 2)	T_{rr}	35							ns
Operating Temperature Range	T_J	-55 to +150							°C
Storage Temperature Range	T_{STG}	-55 to +150							°C

Notes:

1. Pulse test: 300µs pulse width, 1% duty cycle
2. Test conditions : $I_F=0.5A, I_R=1.0A, I_{RR}=0.25A$

RATINGS AND CHARACTERISTIC CURVES

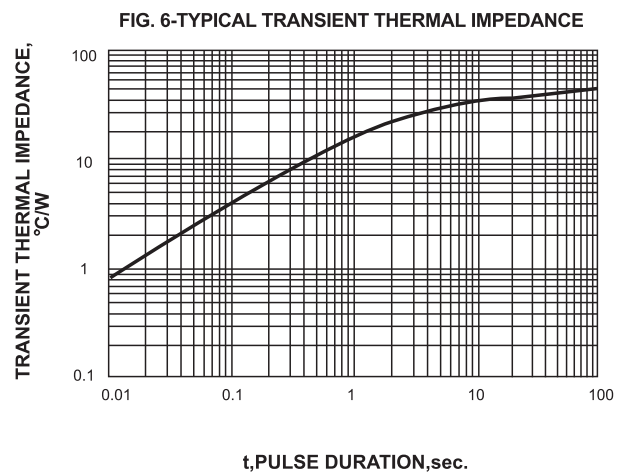
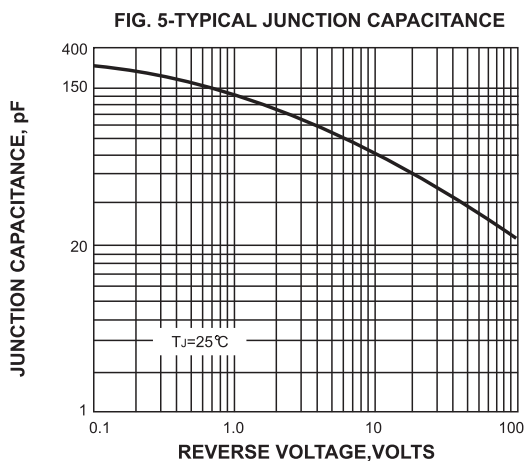
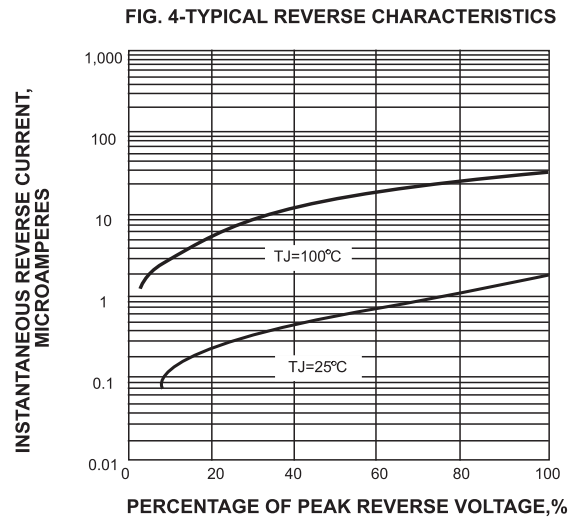
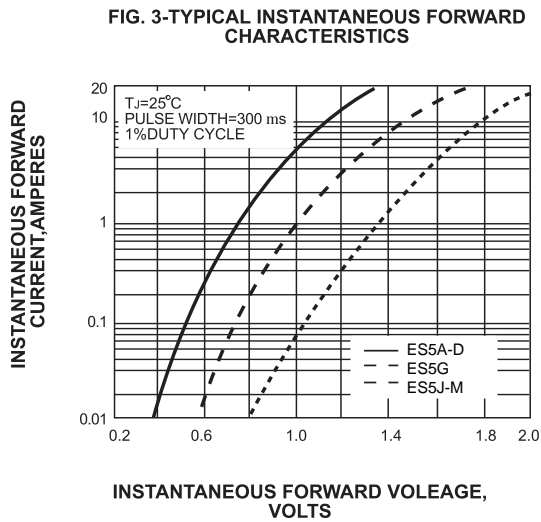
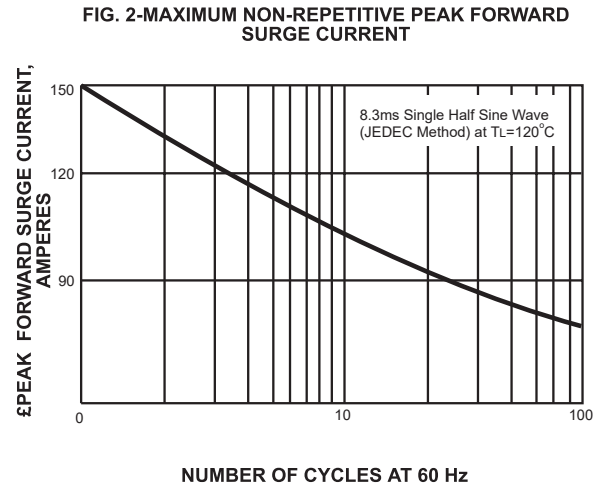
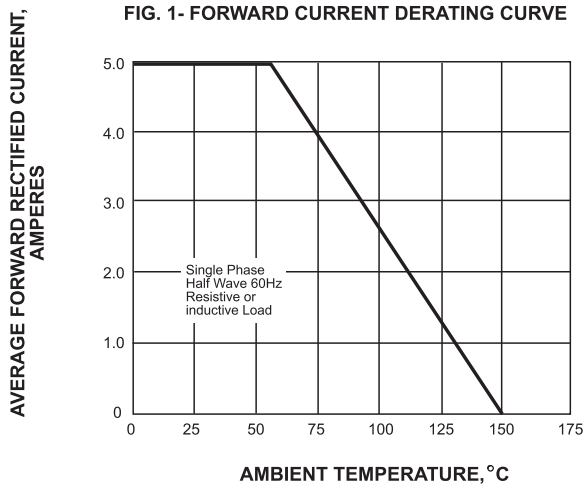

X-ON Electronics

Largest Supplier of Electrical and Electronic Components

Click to view similar products for [Rectifiers](#) category:

Click to view products by [LGE](#) manufacturer:

Other Similar products are found below :

[70HFR40](#) [FR105 R0](#) [RL252-TP](#) [1N5397](#) [1N4005-TR](#) [1N4007-BP](#) [UFS120Je3/TR13](#) [20ETS12S](#) [RRE02VS6SGTR](#) [MS306](#) [A1N5404G-G](#)
[CRF02\(T5L,TEMQ\)](#) [ACGRB207-HF](#) [CLH07\(TE16L,Q\)](#) [CLH03\(TE16L,Q\)](#) [1N5395-TP](#) [UES1302](#) [ACGRC307-HF](#) [ACEFC304-HF](#) [DZ-](#)
[1380](#) [85HFR60](#) [40HFR60](#) [70HF120](#) [85HFR80](#) [SCF7500](#) [SM100](#) [ACGRA4001-HF](#) [SKN70/08](#) [NTE5819](#) [NTE5827](#) [NTE5828](#) [NTE5911](#)
[NTE5915](#) [NTE6104](#) [NTE6163](#) [NTE6164](#) [NTE6165](#) [NTE6364](#) [TSD3G](#) [SET130312](#) [NRVUS110VT3G](#) [UES1106](#) [UES1306](#)
[NRVUS240VT3G](#) [D5FE60-5063](#) [R4000GPS-TP](#) [D4015L56TP](#) [UES1306HR2](#) [FX20K120](#) [D20XB60-7101](#)