

### FEATURES

- Rating to 1000V PRV
- Surge overload rating to 70Amperes peak
- Ideal for printed circuit board
- Reliable low cost construction utilizing molded plastic technique results in inexpensive product
- Lead solderable per MIL-STD-202 method 208
- Plastic material has UL flammability classification 94V-O
- Glass passivated chip junctions

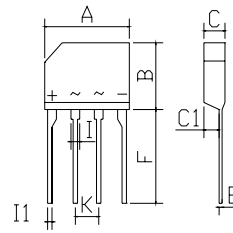

GBP		
Dim	Min	Max
A	14.45	14.85
B	10.30	10.70
C	3.45	3.75
C1	2.00	2.40
E	0.40	0.60
F	14.30	14.90
I	1.30	1.60
I1	0.60	0.90
K	3.75	4.30

All Dimensions in mm

### Maximum Ratings (@TA = 25°C unless otherwise specified)

Characteristic	Symbol	GBP 2005	GBP 201	GBP 202	GBP 204	GBP 206	GBP 207	GBP 208	GBP 210	UNITS
Maximum recurrent peak reverse voltage	$V_{RRM}$	50	100	200	400	600	700	800	1000	V
Maximum RMS voltage	$V_{RMS}$	35	70	140	280	420	490	560	700	V
Maximum DC blocking voltage	$V_{DC}$	50	100	200	400	600	700	800	1000	V
Maximum average forward Output current @TA=25°C	$I_{F(AV)}$	2.0								A
Peak forward surge current 8.3ms single half-sine-wave superimposed on rated load	$I_{FSM}$	60								A
I <sup>2</sup> t Rating for fusing @Tj=25°C	I <sup>2</sup> t	14.94								A <sup>2</sup> S

### Thermal Characteristics

Characteristic	Symbol	GBP 2005	GBP 201	GBP 202	GBP 204	GBP 206	GBP 207	GBP 208	GBP 210	UNITS
Typical Thermal Resistance (Note)	$R_{\theta JA}$ $R_{\theta JC}$ $R_{\theta JL}$	45 2.5 10								°C/W
Operating junction temperature range	$T_J$	- 55 ---- + 150								°C
Storage temperature range	$T_{STG}$	- 55 ---- + 150								°C

### Electrical Characteristics (@TA = 25°C unless otherwise specified)

Characteristic	Symbol	GBP 2005	GBP 201	GBP 202	GBP 204	GBP 206	GBP 207	GBP 208	GBP 210	UNITS
Maximum instantaneous forward voltage @1.0A	$V_F$	1.0								V
Maximum reverse current @TA=25°C at rated DC blocking voltage @TA=100°C	$I_R$	5.0 0.5								$\mu$ A mA

**RATINGS AND CHARACTERISTICS CURVES**

( $T_A = 25^\circ\text{C}$  unless otherwise noted)

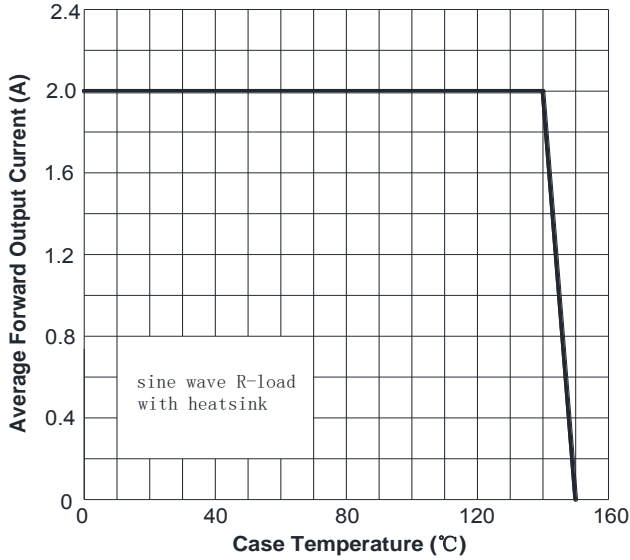
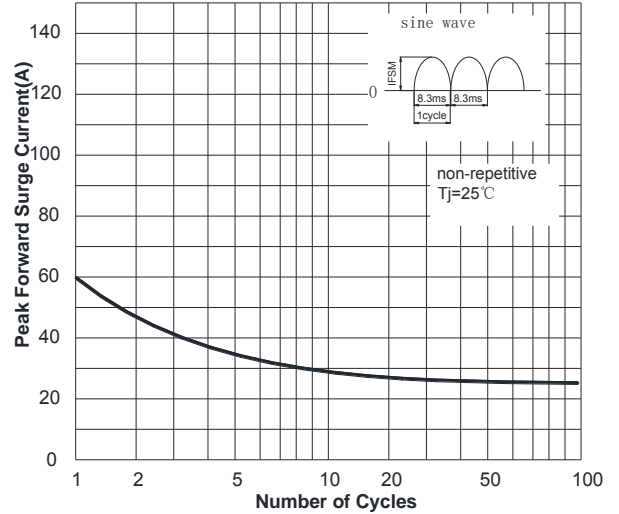
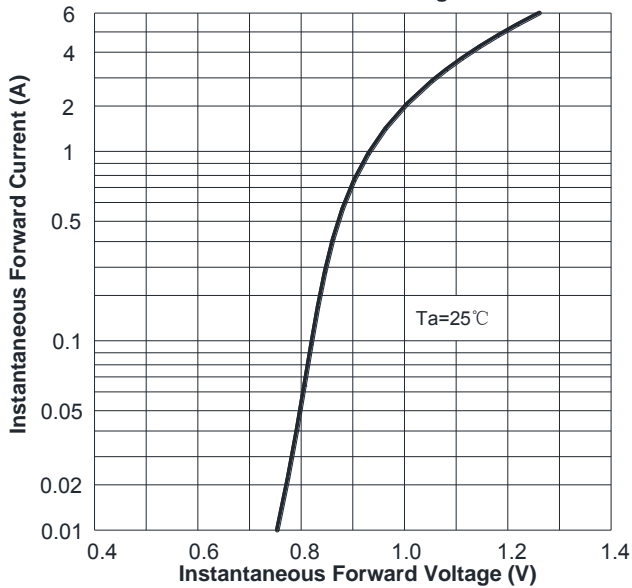
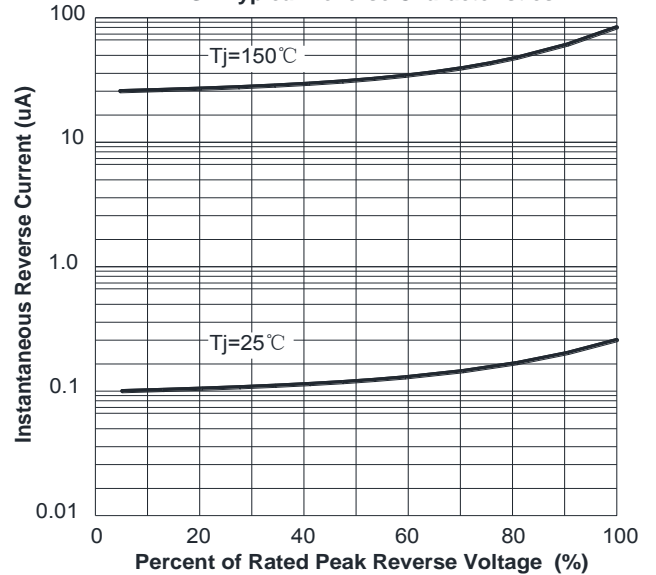
**FIG1:Io-Tc Curve**

**FIG2:Surge Forward Current Capability**

**FIG3: Forward Voltage**

**FIG4:Typical Reverse Characteristics**

Device	Package	Shipping
GBP2005--GBP210	GBP	500Units/Box

## X-ON Electronics

Largest Supplier of Electrical and Electronic Components

*Click to view similar products for [Bridge Rectifiers](#) category:*

*Click to view products by [LGE](#) manufacturer:*

Other Similar products are found below :

[MB252](#) [MB356G](#) [MB358G](#) [GBJ1504-BP](#) [GBU10B-BP](#) [GBU15K-BP](#) [GBU4A-BP](#) [GBU4D-BP](#) [DB101-BP](#) [DF01](#) [DF10SA-E345](#) [KBPC50-10S](#) [RS405GL-BP](#) [GBJ1502-BP](#) [GBU6M](#) [TB102M](#) [MB1510](#) [MB86](#) [TL401G](#) [MDA920A2](#) [TU602](#) [TU810](#) [MP5010W-BP](#) [MP501W-BP](#) [MP502-BP](#) [KBPC25-02](#) [VBO160-12NO7](#) [VS-110MT120KPBF](#) [VS-60MT80KPBF](#) [DB105-BP](#) [DF1510S](#) [VS-40MT160PAPBF](#) [GBU4G-BP](#) [GSIB15A80-E3/45](#) [DB104-BP](#) [D3SB60](#) [TB354](#) [GBJ2504-BP](#) [26MB100A](#) [B1S-G](#) [VS-40MT160KPBF](#) [VUO162-16NO7](#) [ABS10-G](#) [GBU6B-BP](#) [GBJ1508-BP](#) [BR5010-G](#) [ABS6-G](#) [B125C800G-E4/51](#) [MSB15MH-13](#) [LBS10-13](#)