



M49SMD 24.000MHZ 10PF±10PPM QUARTZ CRYSTAL



Parameters of the product 产品参数性能

Parameters 参数	
1. Nominal Frequency	24.000MHZ
2. Oscillation Mode	<input checked="" type="checkbox"/> Fundamental 3RD overtone <input type="checkbox"/> 5th overtone
3. Frequency stability(Tol)	± 10ppm(ref. at 25°C)
4. Operation Temperature	-20°C to +70°C
5. Storage Temperature	-40°C to +85°C
6. Temperature Characteristic	± 20ppm
7. Load Capacitance(CL)	10pF
8. Series Resisitance(ESR)	≤ 40 Ω
9. Drive Level	100uW
10. Shunt Capacitancnce (Co)	≤ 5pF Max (Or PF~ PF)
11. Aging Rate Per Year	± 3ppm/year
12. Insulation Resistance	500M Ω min.at DC 100V ± 10V
13. Test Circuit.	Measured by S&A 250B
14. Marking	LGE24.000M

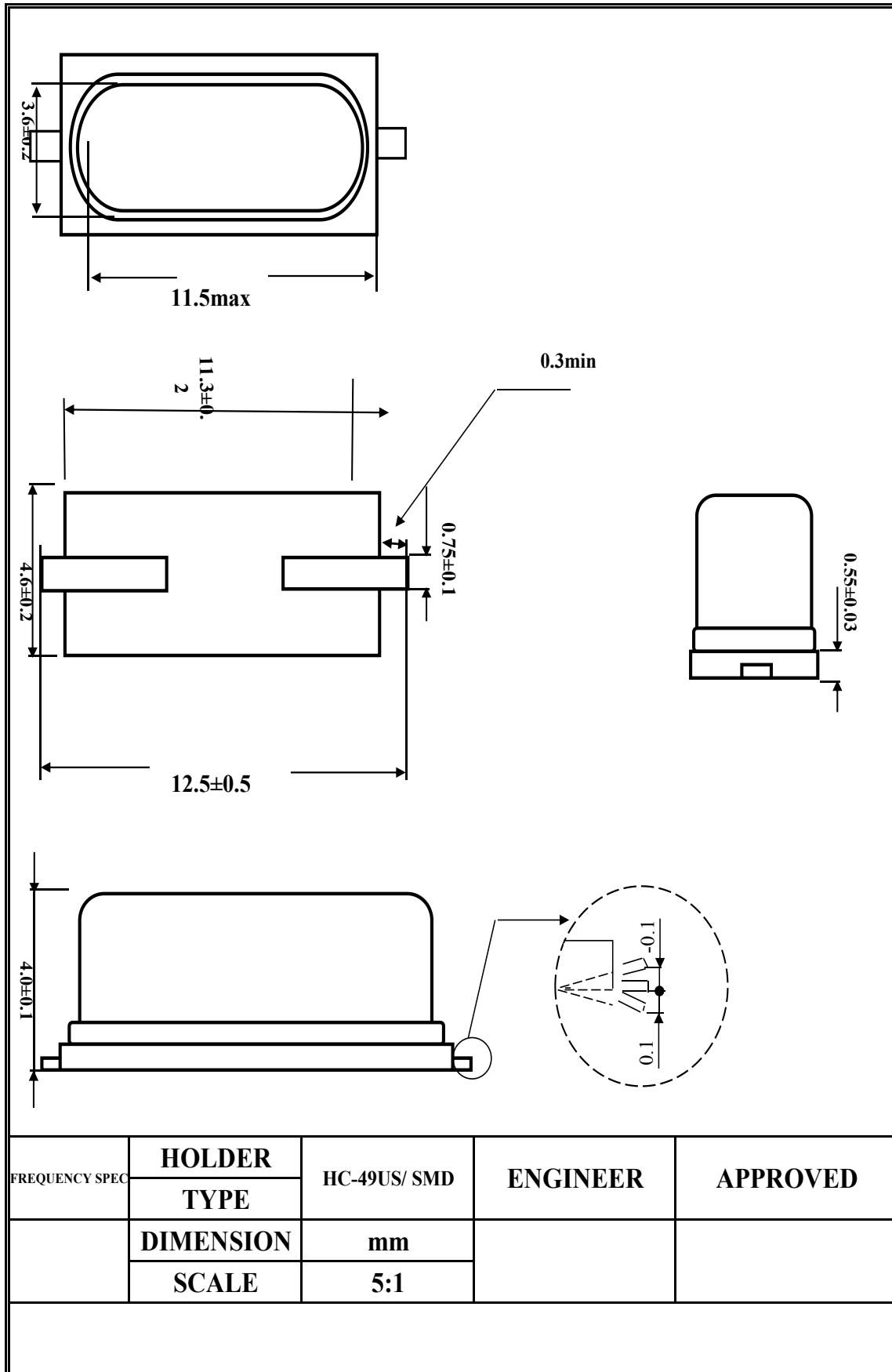



M49SMD 24.000MHZ 10PF±10PPM QUARTZ CRYSTAL

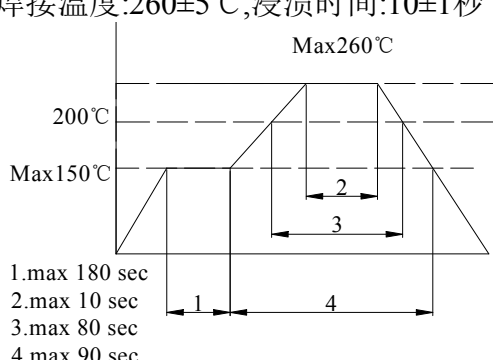

序号	RELIABILITY	JTC RELIABILITY CONDITIONS	SPECIFICATION
	试验名称	可靠度试验条件	规格说明
1	ELECTRODE TERMINAL PULL 电极端子拉力	1KG FORCE IN AXES OF ELECTRODE TERMINATION 10±1sec 1KG力垂直施于电极端子上10±1秒	1.GLASS HERMETICITY & VISUAL. 玻璃密封性和外观检视
2	ELECTRODE WIRE-LEAD BEND 电极端子弯曲拉力	2.5mm FROM ELECTRODE TERMINAL,BEND 90°, ' 0.45kg MASS APPLIED 3TIMES. 2.5毫米处电极端子弯曲 90°	2. LEAD CRACKED or BROKEN NOT ALLOWED' 不允许引线断裂或破裂
3	SOLDERABILITY 产品可焊性	SOLDER:235±5℃,DIPPING:5±0.5sec. 焊接温度:235±5℃,浸渍时间:5±0.5秒	AT LEAST 95% COATING. 至少覆盖率为95%
4	RESISTANCE TO 产品可焊耐热时间	SOLDER:260+5℃,DIPPING:10±1sec. 焊接温度:260±5℃,浸渍时间:10±1秒 	1.AT LEAST 95% COATING. 至少覆盖率为95% 2.△F/F≤±5ppm △F/Rr≤±10% or 2Ω BETTER,20%
5	VIBRATION TEST 振动测试	10g,10~55~10hz 1MINUTE,X、Y、Z PLANE EACH 2hrs. 10G, 10~55~10赫兹 1分钟,X、Y、Z 水平面,每 2小时	△F/F≤±5ppm △F/Rr≤±10% or 2Ω BETTER,20%
6	DROP TEST 跌落测试	75CM HIGH,3 TIMES ON HARD BOARD 75厘米高, 3次坠落在硬木质板上	△F/F≤±5ppm △F/Rr≤±10% Oor 2Ω BETTER,20%
7	AGING TEST 老化测试	85℃ Dynamic 1000hrs 85℃ 动态测试1000小时	△F/F≤±5ppm △F/Rr≤±10% or 2Ω BETTER,20%
8	CCELERATED AGING 加速老化测试	125℃±3℃, TIME:168 hrs. Dynamic 125℃±3℃, 的动态下:168小时.	△F/F≤±5ppm △F/Rr≤±10% or 2Ω BETTER,20%

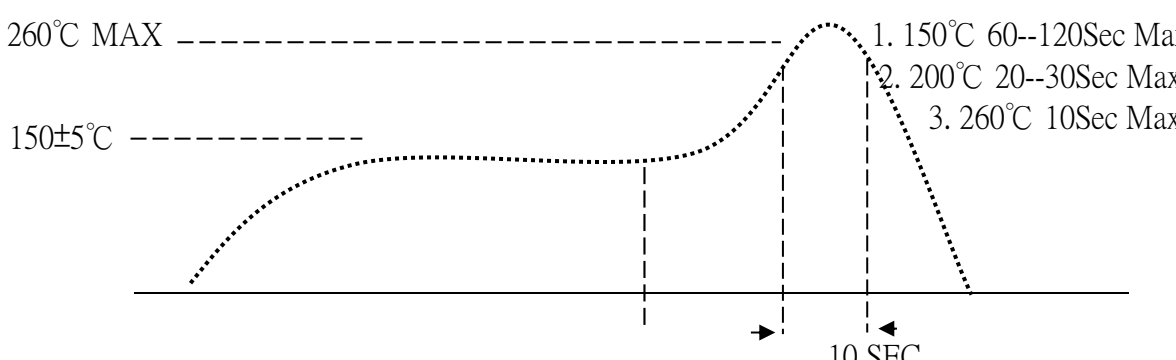
9	SALT SPRAY 盐水喷雾试验	5% NaCL 35℃±2℃ CHAMBER,48hrs.PH:6.5~7.2	1.NO CORROSION ON LEAD&CAN1. 基座和外壳无腐蚀
		5% NaCL(碳酸钠),35℃±2℃的温箱里,48小时 PH值:6.5~7.2	$\Delta F/F \leq \pm 5\text{ppm}$ $\Delta F/Rr \leq \pm 10\%$ or 2 Ω BETTER,20%
10	HIGH-LOW TEM.STORAGE(STATIC	HIGH TEM:125℃±2℃,1000hrs LOW TEM:-40℃±3℃,1000hrs高温:125℃±2℃,1000小时	$\Delta F/F \leq \pm 5\text{ppm}$
	STORAGE(STATIC) 高低温储存（静态测试）	LOW TEM:-40℃±3℃,1000hrs 低温:-40℃±3℃,1000小时	$\Delta F/Rr \leq \pm 10\%$ or 2 Ω BETTER,20%
11	HIGH TEM. & HUM. STORAGE TEST 高温高湿储存试验	TEM:40℃±2℃ HUM:83%-88%,96hrs 温度:40℃±2 湿度:83%-88% ,储存96小时	$\Delta F/F \leq \pm 5\text{ppm}$ $\Delta F/Rr \leq \pm 10\%$ or 2 Ω BETTER,20%
12	TEM. & HUM. CYCLING TEST	TEM:-10℃±2℃ ~ 65℃±2℃ 24hrs 1 cycle' HUM:93±3% 5 cycles	$\Delta F/F \leq \pm 5\text{ppm}$
	温湿度循环测试	温度:-10℃±2℃~65℃±2℃,湿度:93±3%, 24小时为1循环, 运行5个循环	$\Delta F/Rr \leq \pm 10\%$ or 2 Ω BETTER,20%
13	HIGH-LOW TEM.OPERATING TEST	HIGH TEM:70℃±2℃,2hrs LOW TEM:-20℃±2℃,2hrs 高温:70℃±2	$\Delta F/F \leq \pm 5\text{ppm}$
	OPERATING TEST 高-低温运行测试	LOW TEM:-20℃±2℃,2hrs 低温:-20℃±2℃运行2小时	$\Delta F/Rr \leq \pm 10\%$ or 2 Ω BETTER,20%
14	FREQUENCY/Rr V.S OPERATING TEM..	TEM:-10℃ ~ +60℃ 、 -20℃ ~ +70℃ 、 0℃ ~ 70℃ 'MEASURE POINT: EVERY 10℃ DEVIATION.	AS SPECIFICATION
	频率/电阻在操作温度下之变化测试	温度:-10℃ ~ +60℃、 -20℃ ~ +70℃ 0℃ ~ 70℃测试点:依每10℃测试一值	依客户要求
15	<p>HIGH LOW SHOCK 高低温冲击</p>  <p>SPECIFICATION</p> <p>规格说明: $\Delta F/F \leq \pm 5\text{ppm}$ $\Delta F/Rr \leq \pm 10\%$ or 2 Ω BETTER,20%</p>		

X-ON Electronics

Largest Supplier of Electrical and Electronic Components

Click to view similar products for [Crystals](#) category:

Click to view products by [LGE](#) manufacturer:

Other Similar products are found below :

[CX3225GB25000M0PPSZ1](#) [718-13.2-1](#) [7A-40.000MAAE-T](#) [FL2000085](#) [99-BU](#) [9B-15.360MBBK-B](#) [9C-7.680MBBK-T](#) [H10S-12.000-18-EXT-TR](#) [ABC2-6.000MHZ-D4Z-T](#) [ABLS-20.000MHZ-D2-T](#) [ABM3B-27.000MHZ-D4Y-T](#) [ABS071-32.768KHZ-6-T](#) [R38-32.768-12.5-5PPM-NPB](#) [BTD1062E05A-513](#) [21U15A-21.4MHZ](#) [RTX-781DF1-S-20.950](#) [LFXTAL066198Cutt](#) [9C-14.31818MBBK-T](#) [A-11.000MHZ-27](#) [ABL-27.000MHZ-B4Y-T](#) [ABM11-132-24.000MHZ-T3](#) [ABM3B1-25.000MHZ-D2Y-T](#) [SPT2A-.032768B](#) [SPT2A.032768G](#) [SSPT7F-9PF20-R](#) [LFXTAL065253Cutt](#) [LFXTAL066431Cutt](#) [XT9S20ANA14M7456](#) [XT9SNLANA16M](#) [7A-24.576MBBK-T](#) [7B-30.000MBBK-T](#) [MMCC2R32.7680KHZ](#) [7A-14.31818MBBK-T](#) [6504-202-1501](#) [6526-202-1501](#) [ABLS-12.000MHZ-B2Y-T](#) [7A-10.000MBBK-T](#) [SG636PCE-20.000MC](#) [3404](#) [E1SAA18-25.000M TR](#) [CM315D32768EZFT](#) [C1E-24.000-7-2020-R](#) [C1E-19.200-12-1530-X-R](#) [C1E-16.000-12-1530-X-R](#) [ABM11-16.000MHZ-9-B1U-T](#) [FL5000014](#) [EUCA18-3.1872M](#) [FX0800015](#) [425F35E027M0000](#) [FP0800018](#)