



## SMC/DO-214AB

### Features

- ✧ Low cost
- ✧ Low leakage
- ✧ Low forward voltage drop
- ✧ High current capability
- ✧ Easily cleaned with Alcohol, Isopropanol and similar solvents
- ✧ The plastic material carries U/L recognition 94V-0

### Mechanical Data

- ✧ Case: JEDEC DO-214AB, molded plastic
- ✧ Polarity: Color band denotes cathode
- ✧ Weight: 0.007 ounces, 0.21 gram
- ✧ Mounting position: Any

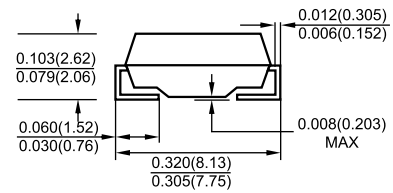
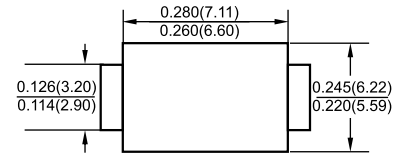

Dimensions in inches and (millimeters)

### MAXIMUM RATINGS AND ELECTRICAL CHARACTERISTICS

Ratings at 25°C ambient temperature unless otherwise specified.

Single phase, half wave, 60 Hz, resistive or inductive load. For capacitive load, derate by 20%.

		MURS340	MURS360	UNITS
Maximum recurrent peak reverse voltage	$V_{RRM}$	400	600	V
Maximum RMS voltage	$V_{RMS}$	280	420	V
Maximum DC blocking voltage	$V_{DC}$	400	600	V
Maximum average forward rectified current @ $T_L=130^\circ\text{C}$	$I_{F(AV)}$	3.0		A
Peak forward surge current 8.3ms single half-sine-wave superimposed on rated load @ $T_J=125^\circ\text{C}$	$I_{FSM}$	125		A
Typical reverse recovery time (Note1)	$t_{rr}$	50		ns
Maximum reverse current @ $T_J=25^\circ\text{C}$ at rated DC blocking voltage @ $T_J=150^\circ\text{C}$	$I_R$	10	250	$\mu\text{A}$
Maximum instantaneous forward voltage at 3.0 A	$V_F$	1.25		V
Typical thermal resistance (Note2)	$R_{\theta JL}$	11		$^\circ\text{C}/\text{W}$
Operating junction temperature range	$T_J$	- 55 ---- + 150		$^\circ\text{C}$
Storage temperature range	$T_{STG}$	- 55 ---- + 150		$^\circ\text{C}$

NOTE: 1. Measured with  $I_F=0.5\text{A}$ ,  $I_R=1\text{A}$ ,  $I_{rr}=0.25\text{A}$ .

2. Junction to lead.

## Ratings AND Characteristic Curves

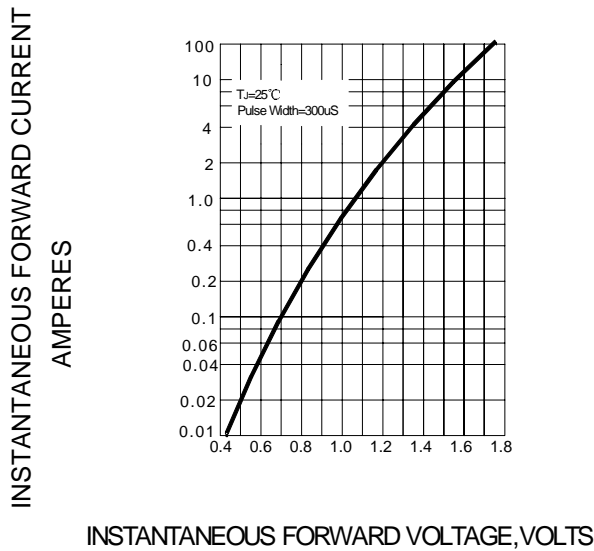
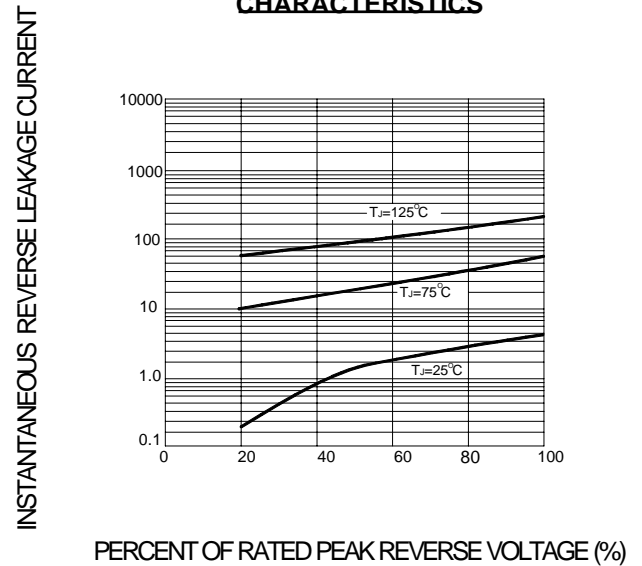
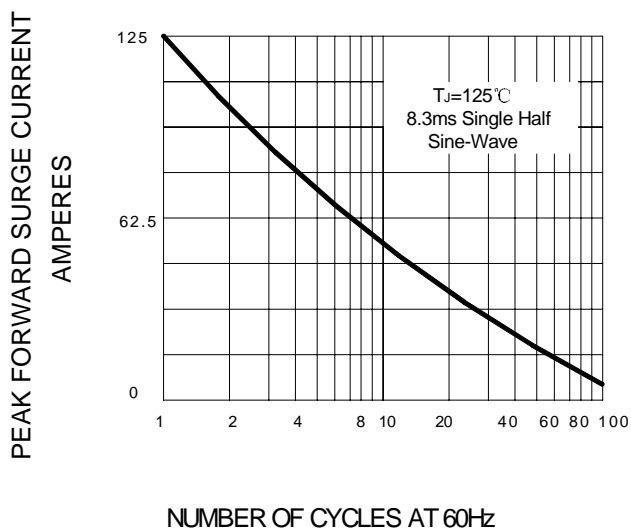
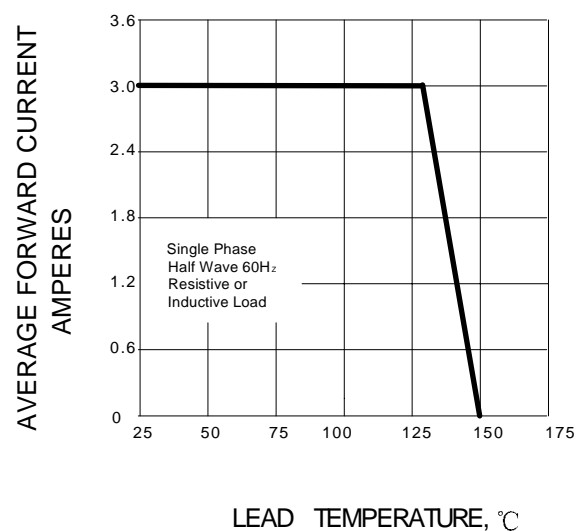
**FIG.1 – TYPICAL FORWARD CHARACTERISTIC**

**FIG.2 -- TYPICAL REVERSE LEAKAGE CHARACTERISTICS**

**FIG.3 – PEAK FORWARD SURGE CURRENT**

**FIG.4 – FORWARD DERATING CURVE**

PACKAGE	SPQ/PCS	CARTON SPQ/PCS	CARTON SIZE/CM	CARTON GW/KG	CARTON NW/KG
SMC	3000/REEL	42000	36X36X36.5	18.50	15.50

## X-ON Electronics

Largest Supplier of Electrical and Electronic Components

*Click to view similar products for [Rectifiers](#) category:*

*Click to view products by [LGE](#) manufacturer:*

Other Similar products are found below :

[70HFR40](#) [FR105 R0](#) [RL252-TP](#) [1N5397](#) [1N4005-TR](#) [1N4007-BP](#) [UFS120Je3/TR13](#) [20ETS12S](#) [RRE02VS6SGTR](#) [MS306](#) [A1N5404G-G](#)  
[CRF02\(T5L,TEMQ\)](#) [ACGRB207-HF](#) [CLH07\(TE16L,Q\)](#) [CLH03\(TE16L,Q\)](#) [1N5395-TP](#) [UES1302](#) [ACGRC307-HF](#) [ACEFC304-HF](#) [DZ-](#)  
[1380](#) [85HFR60](#) [40HFR60](#) [70HF120](#) [85HFR80](#) [SCF7500](#) [SM100](#) [ACGRA4001-HF](#) [SKN70/08](#) [NTE5819](#) [NTE5827](#) [NTE5828](#) [NTE5911](#)  
[NTE5915](#) [NTE6104](#) [NTE6163](#) [NTE6164](#) [NTE6165](#) [NTE6364](#) [TSD3G](#) [SET130312](#) [NRVUS110VT3G](#) [UES1106](#) [UES1306](#)  
[NRVUS240VT3G](#) [D5FE60-5063](#) [R4000GPS-TP](#) [D4015L56TP](#) [UES1306HR2](#) [FX20K120](#) [D20XB60-7101](#)