

### FEATURES

- Suitable replacement for MLV'S ESD protection
- Low leakage current
- Low clamping voltage
- Working voltage:5V~12V

### APPLICATIONS

- Single line TVS diode

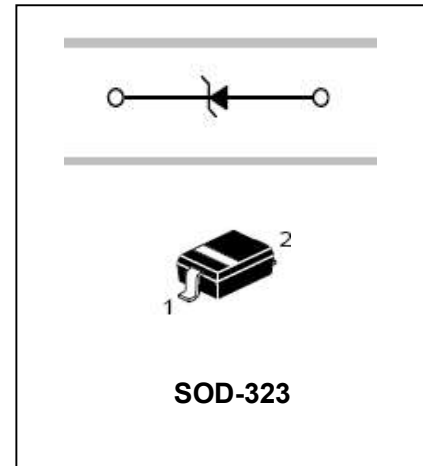

### ORDERING INFORMATION

Type No.	Marking	Package Code
SD05	5U	SOD-323
SD12	6U	SOD-323

### MAXIMUM RATING @ Ta=25°C unless otherwise specified

Parameter	Symbol	Limits	Unit
Peak pulse power dissipation( $t_p=8/20\mu s$ )	$P_{pk}$	350	W
Peak pulse current( $t_p=8/20\mu s$ )	$I_{PP}$	24	A
ESD Voltage (human Waveform per IEC 1000-4-2)	$V_{PP}$	30	kV
Lead soldering temperature	$T_L$	260(10 sec.)	°C
Junction temperature	$T_j$	-55 to+125	°C
Storage temperature	$T_{STG}$	-55 to+150	°C

**ELECTRICAL CHARACTERISTICS @ Ta=25°C unless otherwise specified**

**SD05 TVS for 5V Lines**

Parameter	Symbol	Conditions	Min	Typ	Max	Units
Reverse stand-off voltage	$V_{RWM}$				5	V
Reverse breakdown voltage	$V_{BR}$	$I_t=1mA$	6			V
Reverse leakage current	$I_R$	$V_{RWM}=5V, T=25^\circ C$			10	$\mu A$
Clamping voltage	$V_C$	$I_{PP}=5A, t_p=8/20\mu s$			9.8	V
Clamping voltage	$V_C$	$I_{PP}=24A, t_p=8/20\mu s$			14.5	V
Junction capacitance	$C_j$	$V_R=0V, f=1MHz$			350	pF

**SD12 TVS for 12V Lines**

Parameter	Symbol	Conditions	Min	Typ	Max	Units
Reverse stand-off voltage	$V_{RWM}$				12	V
Reverse breakdown voltage	$V_{BR}$	$I_t=1mA$	13.3			V
Reverse leakage current	$I_R$	$V_{RWM}=12V, T=25^\circ C$			1	$\mu A$
Clamping voltage	$V_C$	$I_{PP}=5A, t_p=8/20\mu s$			19	V
Clamping voltage	$V_C$	$I_{PP}=15A, t_p=8/20\mu s$			23	V
Junction capacitance	$C_j$	$V_R=0V, f=1MHz$			150	pF

**TYPICAL CHARACTERISTICS @ Ta=25°C unless otherwise specified**

**Non-Repetitive Peak Pulse Power vs. Pulse Time**

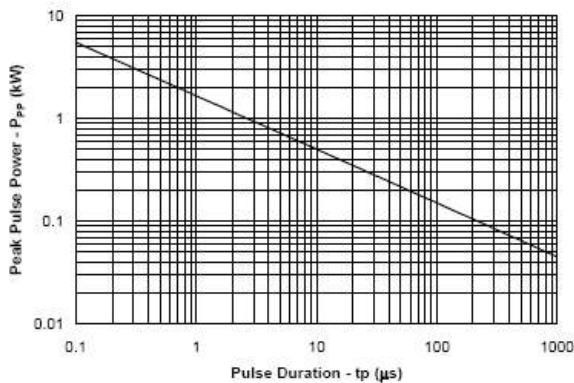

**Power Derating Curve**

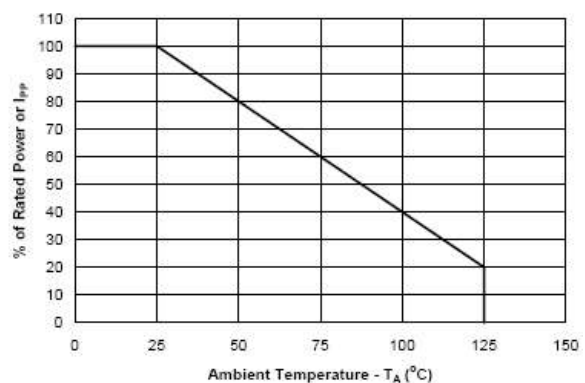

**Pulse Waveform**

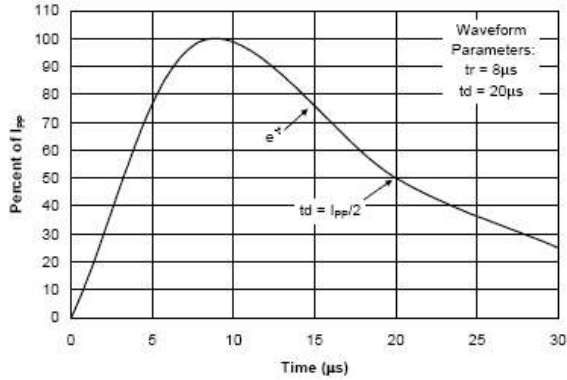

**Typical Clamping Characteristic**

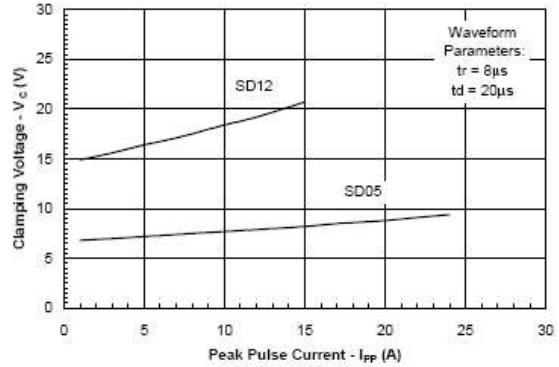

### PACKAGE OUTLINE

Plastic surface mounted package

SOD-323

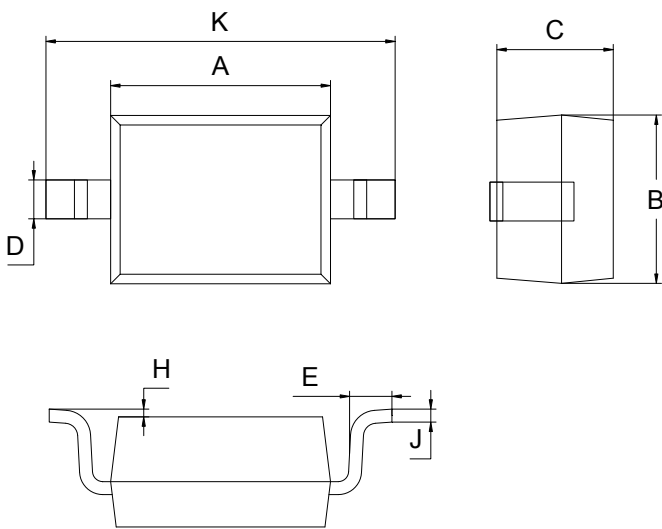

SOD-323		
Dim	Min	Max
A	1.60	1.80
B	1.20	1.40
C	0.80	0.90
D	0.25	0.35
E	0.22	0.42
H	0.02	0.1
J	0.05	0.15
K	2.55	2.75
All Dimensions in mm		

**SOLDERING FOOTPRINT**

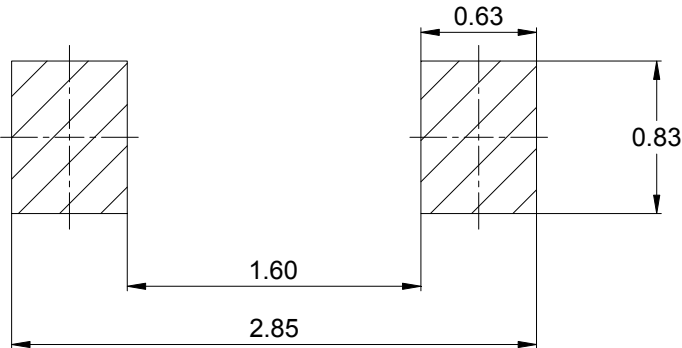

Unit : mm

**PACKAGE INFORMATION**

Device	Package	Shipping
SD05/SD12	SOD-323	3000/Tape&Reel

## X-ON Electronics

Largest Supplier of Electrical and Electronic Components

*Click to view similar products for [ESD Suppressors / TVS Diodes](#) category:*

*Click to view products by [LGE](#) manufacturer:*

Other Similar products are found below :

[60KS200C](#) [D18V0L1B2LP-7B](#) [D5V0F4U5P5-7](#) [NTE4902](#) [P4KE27CA](#) [P6KE11CA](#) [P6KE8.2A](#) [SA60CA](#) [SA64CA](#) [SMBJ12CATR](#)  
[SMBJ33CATR](#) [SMBJ6.5A](#) [SMBJ8.0A](#) [ESD101-B1-02ELS](#) [E6327](#) [ESD112-B1-02EL](#) [E6327](#) [ESD7451N2T5G](#) [19180-510](#) [CPDT-5V0USP-](#)  
[HF](#) [3.0SMCJ33CA-F](#) [3.0SMCJ36A-F](#) [HSPC16701B02TP](#) [JANTX1N6126A](#) [D3V3Q1B2DLP3-7](#) [D55V0M1B2WS-7](#) [SCM1293A-04SO](#)  
[ESD200-B1-CSP0201](#) [E6327](#) [SM12-7](#) [CEN955](#) [W/DATA](#) [VESD12A1A-HD1-GS08](#) [CPDQC5V0-HF](#) [D1213A-01LP4-7B](#) [ESD101-B1-02EL](#)  
[E6327](#) [AOZ8808DI-03](#) [5KP15A](#) [5KP48A](#) [5KP90A](#) [ESD3V3D7-TP](#) [15KPA36A-LF](#) [P4KE56CA](#) [P4KE68A](#) [P4KE91CATR](#) [P6KE120A](#)  
[P6KE13CA](#) [P6KE43CA](#) [P6KE6.8CA](#) [P6KE8.2](#) [P6SMBJ20CA](#) [JANTX1N6072A](#) [SR2835ESKG](#) [SA90CA](#)