



Features

- ✧ Plastic package has underwriters laboratories
- ✧ flammability classification 94V-0
- ✧ For surface mount applications
- ✧ Low profile package
- ✧ Easy pick and place
- ✧ Ultrafast recovery times for high efficiency
- ✧ Low forward voltage, low power loss
- ✧ Built-in strain relief, ideal for automated placement
- ✧ High temperature soldering:
- ✧ 250°C/10 seconds on terminals

Mechanical Data

- ✧ Case: JEDEC DO-214AB, molded plastic body
c over passivated chip
- Terminals: Solder Plated, solderable per MIL-STD-750,
- ✧ Method 2026
- ✧ Polarity: Color band denotes cathode end
- ✧ Weight: 0.007 ounces, 0.21 gram

SMC/DO-214AB

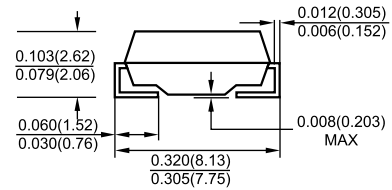
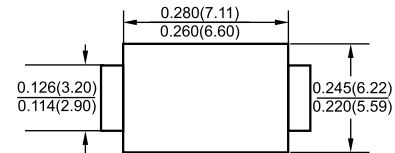

Dimensions in inches and (millimeters)

Marking Information



LGE: Lu Guang Electronic
XXXX: marking code (US3A-US3M)

MAXIMUM RATINGS AND ELECTRICAL CHARACTERISTICS

Ratings at 25°C ambient temperature unless otherwise specified

		US3A	US3B	US3D	US3G	US3J	US3K	US3M	UNITS
Device marking code		US3A	US3B	US3D	US3G	US3J	US3K	US3M	
Maximum repetitive peak reverse voltage	V_{RRM}	50	100	200	400	600	800	1000	V
Maximum RMS voltage	V_{RWS}	35	70	140	280	420	560	700	V
Maximum DC blocking voltage	V_{DC}	50	100	200	400	600	800	1000	V
Maximum average forward rectified current at $T_L=110^\circ\text{C}$	$I_{F(AV)}$	3.0							A
Peak forward surge current 8.3ms single half-sine-wave superimposed on rated load (JEDEC Method)	I_{FSM}	100							A
Maximum instantaneous forward voltage at 3A	V_F	1.0				1.7			V
Maximum DC reverse current @ $T_A=25^\circ\text{C}$ at rated DC blocking voltage @ $T_A=125^\circ\text{C}$	I_R	10 500							μA
Maximum reverse recovery time at $I_F=0.5\text{A}$ $I_R=1.0\text{A}$ $I_{tr}=0.25\text{A}$	t_{rr}	50					75		ns
Typical junction capacitance at 4.0V, 1MHz	C_J	70					50		pF
Maximum thermal resistance (NOTE1)	R_{JA}	25							$^\circ\text{C/W}$
Operating temperature range	T_J	-55-----+150							$^\circ\text{C}$
Storage temperature range	T_{STG}	-55-----+150							$^\circ\text{C}$

NOTE: 1.P.C.B.mounted on 0.2X0.2"(5.0X5.0mm)copper pad area

Ratings AND Characteristic Curves

FIG.1 – FORWARD CURRENT DERATING CURVE

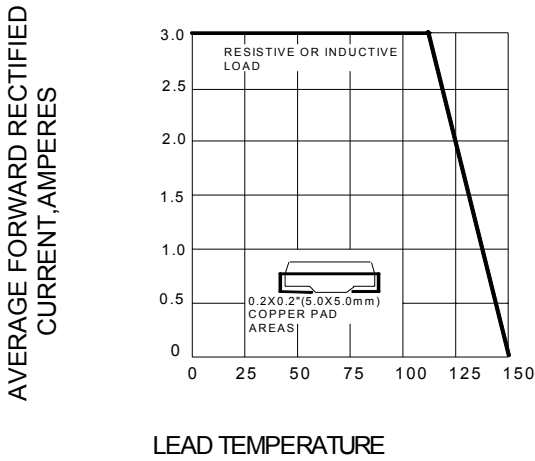

FIG.2 – MAXIMUM NON-REPETITIVE PEAK FORWARD SURGE CURRENT

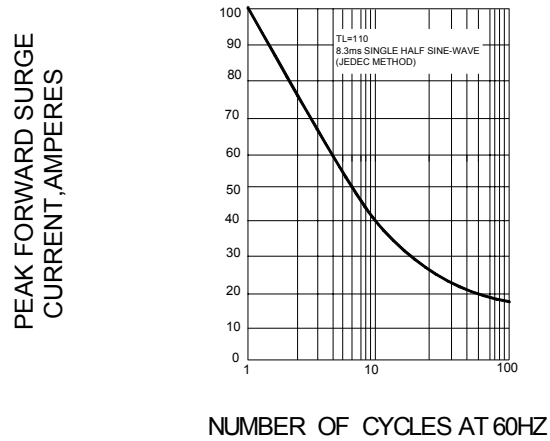

FIG.3 – TYPICAL INSTANTANEOUS FORWARD CHARACTERISTICS

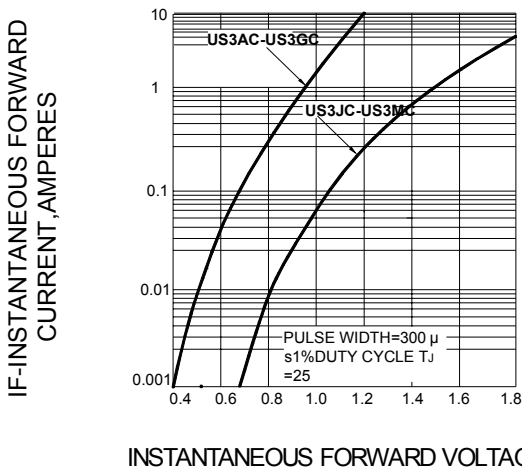

FIG.4 – TYPICAL REVERSE CHARACTERISTICS

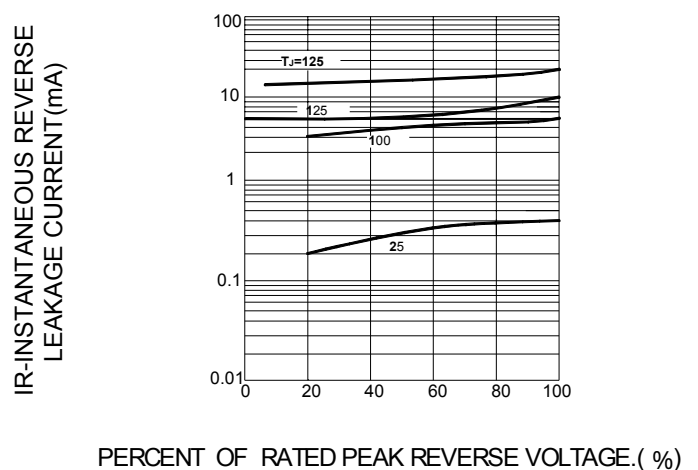

FIG.5 – TYPICAL JUNCTION CAPACITANCE

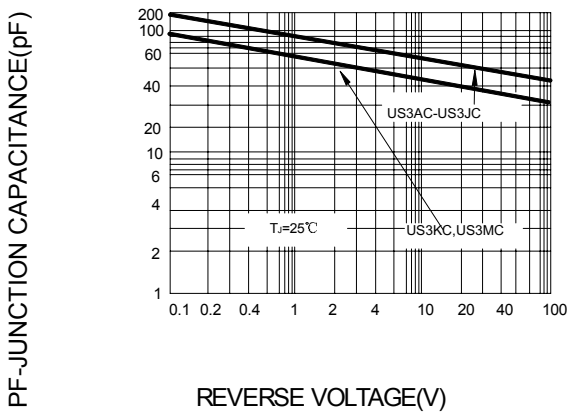
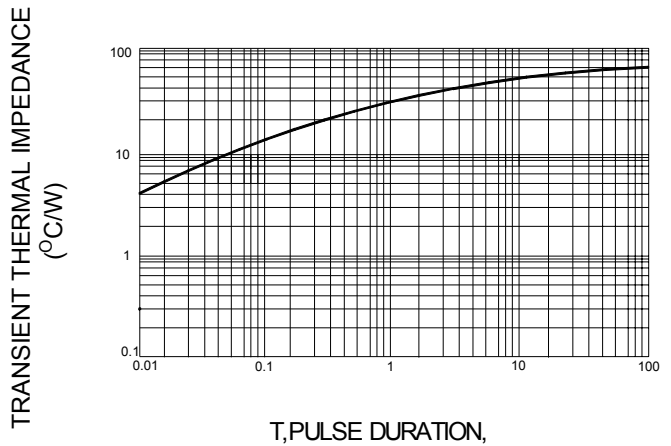

FIG.6 – TYPICAL TRANSIENT THERMAL IMPEDANCE



PACKAGE	SPQ/PCS	CARTON SPQ/PCS	CARTON SIZE/CM	CARTON GW/KG	CARTON NW/KG
SMC	3000/REEL	42000	36X36X36.5	18.50	15.50

X-ON Electronics

Largest Supplier of Electrical and Electronic Components

Click to view similar products for [Rectifiers](#) category:

Click to view products by [LGE](#) manufacturer:

Other Similar products are found below :

[70HFR40](#) [FR105 R0](#) [RL252-TP](#) [150KR30A](#) [1N5397](#) [1N4002G](#) [1N4005-TR](#) [UFS120Je3/TR13](#) [JANS1N6640US](#) [481235F](#)
[RRE02VS6SGTR](#) [067907F](#) [MS306](#) [70HF40](#) [T110HF60](#) [T85HFL60S02](#) [US2JFL-TP](#) [A1N5404G-G](#) [CRS12\(T5L,TEMQ\)](#) [ACGRB207-HF](#)
[CLH07\(TE16L,Q\)](#) [CLH03\(TE16L,Q\)](#) [ACGRC307-HF](#) [ACEFC304-HF](#) [NTE6356](#) [NTE6359](#) [85HFR60](#) [40HFR60](#) [70HF120](#) [85HFR80](#)
[D126A45C](#) [SCF7500](#) [D251N08B](#) [SCHJ22.5K](#) [SM100](#) [SCPA2](#) [SDHD5K](#) [ACGRA4001-HF](#) [D1821SH45T PR](#) [D1251S45T](#) [NTE6358](#)
[NTE5850](#) [NTE5819](#) [NTE5837](#) [NTE5892](#) [NTE5900](#) [NTE5911](#) [NTE5915](#) [NTE5921](#) [NTE6104](#)