

RECOMMENDED PCB PATTERN DIM.  
TOLERANCE : ±0.05

NOTES:

- 1.HUOSINGT: HIGH-TEMP THERMOPLASTIC UL94V-0 COLOR:BEIGE
- 2.TERMINAL:PHOSPHOR BRONZE
- PLATING:1.2" GOLD FLASH/VERALL 50~100μ" NICKEL UNDER PLATED.
- 3.CODING INFORMATION: XDBM-08\*\*~2\*NIP

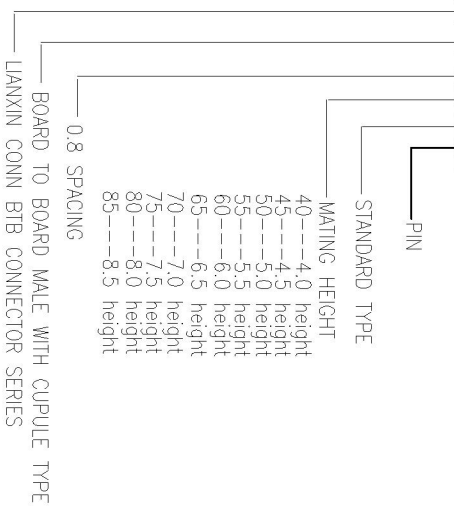

MATING HEIGHT	MALE H1	FEMALE H2
4.0	1.85	2.05
4.5	0.95	3.45
5.0	1.45	3.45
6.0	1.95	3.45
6.5	2.45	3.45
7.0	2.95	3.45
7.5	4.0	3.45
8.0	4.0	3.45
8.5	4.0	3.45

PIN	Dimensions			PIN	Dimensions		
	A	B	C		A	B	C
8(2*4)	5.0	2.4	3.6	34(2*17)	15.4	12.8	14.0
10(2*6)	5.8	3.2	4.4	36(2*18)	16.2	13.6	15.4
12(2*6)	6.6	4.0	5.2	38(2*19)	17.0	14.4	16.2
14(2*7)	7.4	4.8	6.0	40(2*20)	17.8	15.2	17.0
16(2*8)	8.2	5.6	6.8	42(2*21)	18.6	16.0	17.2
18(2*8)	9.0	6.4	7.6	44(2*22)	19.4	16.8	17.8
20(2*10)	9.8	7.2	8.4	46(2*23)	20.2	17.6	18.6
22(2*11)	10.6	8.0	9.2	48(2*24)	21.0	18.4	19.4
24(2*12)	11.4	8.8	10.0	50(2*25)	21.8	19.2	20.2
26(2*13)	12.2	9.6	10.8	52(2*26)	22.6	20.0	21.0
28(2*14)	13.0	10.4	11.6	54(2*27)	23.4	20.8	21.8
30(2*15)	13.8	11.2	12.4	56(2*28)	24.2	21.6	22.6
32(2*16)	14.6	12.0	13.2	58(2*29)	25.0	22.4	23.4
34(2*17)	15.4	12.8	14.0	60(2*30)	25.8	23.2	24.2

REV:	SIZE:	GENERAL TOLERANCE:	PART NO.:
A	A4	UNLESS OTHERWISE SPECIFIED	XDBM-08**~2*NIP
UNIT:	SCALE:		
MM	5:1		
SHEET NO.:	ANG.:		
1 OF 1	0°30'		
DRAWN BY:	CHECKED BY:		
DATE:	APPROVED BY:		
REVISIONS:			
SFR			

深圳市连欣科技有限公司

TITLE: 0.8 BOARD TO BOARD SMT V/T TYPE FEMALE

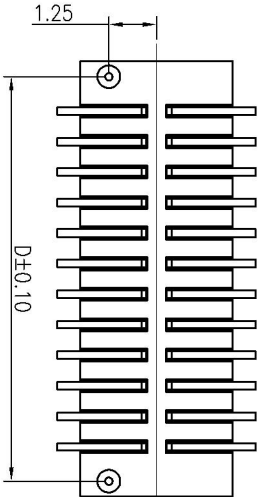
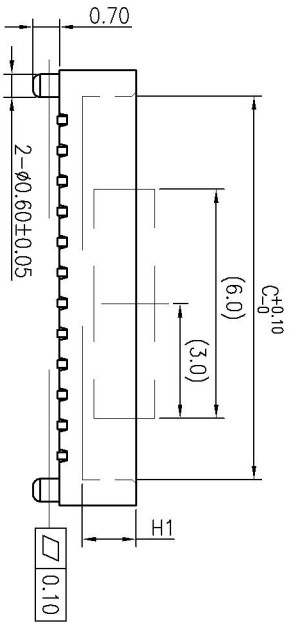
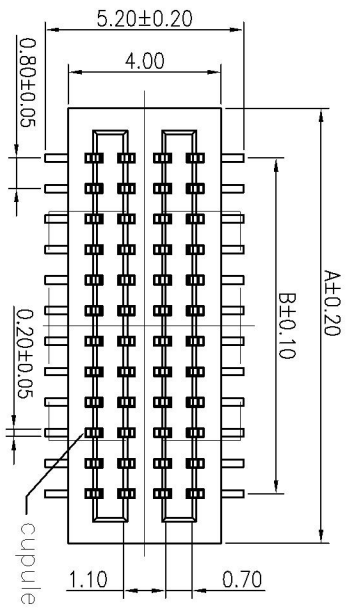

(MATING HEIGHT)

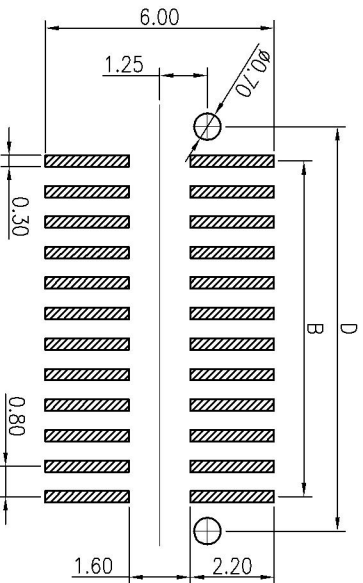
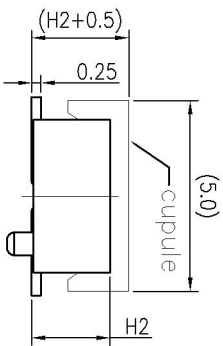
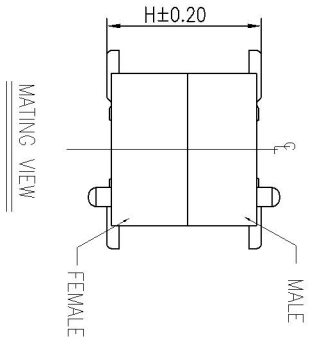

RECOMMENDED PCB PATTERN DIM.  
TOLERANCE : ±0.05

NOTES:

- 1.HUOSINGIT: HIGH-TEMP THERMOPLASTIC UL94V-0 COLOR:BRICE
- 2.TERMINAL:PHOSPHOR BRONZE PLATING:1μ" GOLD FLASH/VERALL 50~100μ" NICKEL UNDER PLATED.
- 3.CODING INFORMATION: XDBF-08\*\*--2\*NP

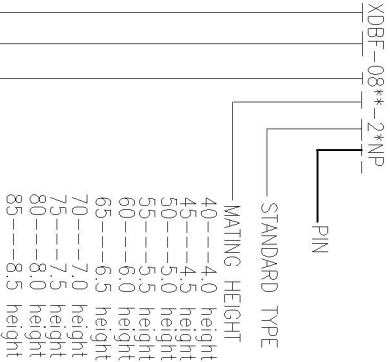

BOARD TO BOARD FEMALE WITH CUPULE TYPE  
LANXIN CONN BTB CONNECTOR SERIES

MATING HEIGHT	MALE H1	FEMALE H2
4.0	1.85	2.05
4.5	0.95	1.45
5.0	1.45	1.95
5.5	1.95	2.45
6.0	2.45	2.95
6.5	2.95	3.45
7.0	3.45	3.95
7.5	3.95	4.45
8.0	4.45	4.95
8.5	4.95	5.45

PIN	Dimensions			PIN	Dimensions		
	A	B	C		A	B	C
8(2*4)	5.0	2.4	3.65	4.2	3.4(2*1.7)	15.4	12.8
10(2*5)	5.8	3.2	4.45	5.0	3.6(2*1.8)	16.2	13.6
12(2*6)	6.6	4.0	5.25	5.8	3.8(2*1.9)	17.0	14.4
14(2*7)	7.4	4.8	6.05	6.6	4.0(2*2.0)	17.8	15.2
16(2*8)	8.2	5.6	6.85	7.4	4.2(2*2.1)	18.6	16.0
18(2*9)	9.0	6.4	7.65	8.2	4.4(2*2.2)	19.4	16.8
20(2*10)	9.8	7.2	8.45	9.0	4.6(2*2.3)	20.2	17.6
22(2*11)	10.6	8.0	9.25	9.8	4.8(2*2.4)	21.0	18.4
24(2*12)	11.4	8.8	10.05	10.6	5.0(2*2.5)	21.8	19.2
26(2*13)	12.2	9.6	10.85	11.4	5.2(2*2.6)	22.6	20.0
28(2*14)	13.0	10.4	11.65	12.2	5.4(2*2.7)	23.4	20.8
30(2*15)	13.8	11.2	12.45	13.0	5.6(2*2.8)	24.2	21.6
32(2*16)	14.6	12.0	13.25	13.8	5.8(2*2.9)	25.0	22.4
34(2*17)	15.4	12.8	14.05	14.6	6.0(2*3.0)	25.8	23.2

深圳市连欣科技有限公司

REV: A SIZE: A4  
SCALE: 5:1  
SHEET NO: 1 OF 1  
TITLE: XDBF-08\*\*--2\*NP  
0.8 BOARD TO BOARD SMT V/T TYPE FEMALE

REV:	SIZE:	GENERAL TOLERANCE	PART NO.:
A	A4	UNLESS OTHERWISE SPECIFIED	XDBF-08**--2*NP
UNIT:	SCALE:		
MM	5:1		
SHEET NO:	ANG.:		
1 OF 1	0°30'		
DRAWN BY:	CHECKED BY:		
	APPROVED BY:		
SER	REVISIONS	CHK	DATE

## X-ON Electronics

Largest Supplier of Electrical and Electronic Components

*Click to view similar products for [Board to Board & Mezzanine Connectors](#) category:*

*Click to view products by [Lian Xin](#) manufacturer:*

Other Similar products are found below :

[589158040000018](#) [MDF7C-18P-2.54DSA\(55\)](#) [FCN-268F036-G/BD](#) [FCN-268M012-G/0D](#) [FCN-268M024-G/1D](#) [MIS-048-01-F-D-DP-K](#)  
[832-10-034-10-001000](#) [FX4C-80S-1.27DSA](#) [93696-330](#) [224393](#) [FCN-235D050-G/C](#) [210-93-314-41-105000](#) [MDF7-40DP-2.54DSA\(55\)](#)  
[55323-1519](#) [069159702701000](#) [101A10019X](#) [105061100000861+](#) [75140-7012](#) [87471-650](#) [1744382-4](#) [063209](#) [10124054-515LF](#) [68685-603](#)  
[8-1616154-3](#) [541371078](#) [IL-WX-10PB-HF-B-E1000E](#) [FX23-40P-0.5SV15B](#) [FCN-214J100-G/0](#) [354184](#) [P50-028-DDS-TG](#) [53309-2471](#)  
[54546-2071](#) [1586617-1](#) [504248-1210](#) [504248-2010](#) [1-1437355-2](#) [9159005551906](#) [NDS100-004-BF](#) [93696-730LF](#) [91922-31141LF](#) [505274-](#)  
[3440](#) [501493-2410](#) [504208-3410](#) [505006-0811](#) [505274-2040](#) [202436-1600](#) [202477-0414](#) [71660-7580](#) [73420-5192](#) [360-10-107-00-001000](#)