

RoHS Compliant

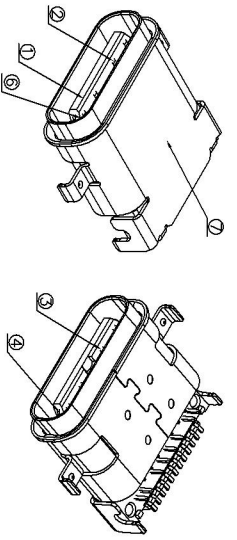

| Pin Name | Signal Name | Mating Sequence | Pin Name | Signal Name | Mating Sequence |
|----------|-------------|-----------------|----------|-------------|-----------------|
| A1       | GND         | First           | B12      | GND         | First           |
| A2       | SSTX01      | Second          | B11      | SSTX01      | Second          |
| A3       | SSTX01      | Second          | B10      | SSTX01      | Second          |
| A4       | Vcc         | First           | B9       | SSTX01      | Second          |
| A5       | GND         | Second          | B8       | SMD2        | Second          |
| A6       | D01         | Second          | B7       | D02         | Second          |
| A7       | D01         | Second          | B6       | D02         | Second          |
| A8       | SBU1        | Second          | B5       | C22         | Second          |
| A9       | Vcc         | First           | B4       | Vcc         | First           |
| A10      | SSTX02      | Second          | B3       | SSTX02      | Second          |
| A11      | SSTX02      | Second          | B2       | SSTX02      | Second          |
| A12      | GND         | First           | B1       | GND         | First           |
|          |             |                 | SMB1     | GND         | GND             |

CUSTOMER DRAWING

NOTES:  
1. MATERIAL: SEE TABLE 1\*  
2. FINISH: SEE TABLE 1\*  
3. ELECTRICAL:

- 5-1 CONTACT CURRENT RATING : 5Amps @ 15A(PIN)
  - 5-2 RESISTANCE : MAX 0.25A/(K/OTHER PM)
  - 3-2 MINIMUM OPERATING VOLTAGE : AT 250VDC
  - 3-3 DIELECTRIC WITHSTANDING VOLTAGE : 100VAC MIN.
  - 3-4 LOW LEVEL CONTACT RESISTANCE : INITIAL 40mΩ MAX. AFTER 50mΩ MAX.
- 4.MECHANICAL CHARACTERISTICS :
- 4-1. MATING FORCE 5~20N.
  - 4-2. UNMATING FORCE 8~20N(MIN),6~20N(MAX)
  - 4-3. DURABILITY : 10,000 MATING CYCLES.
  - 4-4. OPERATING TEMPERATURE : -40°C TO +80°C

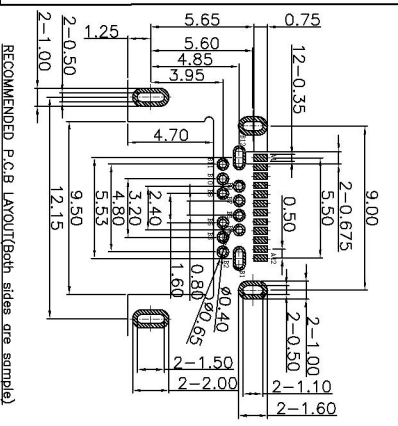
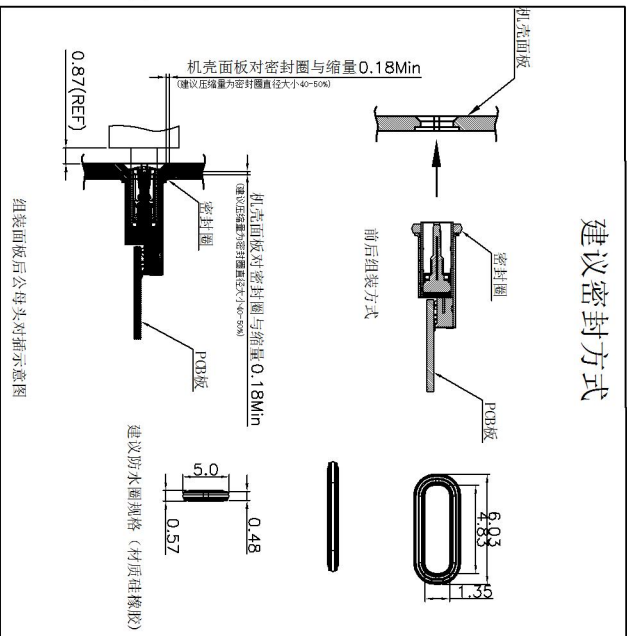
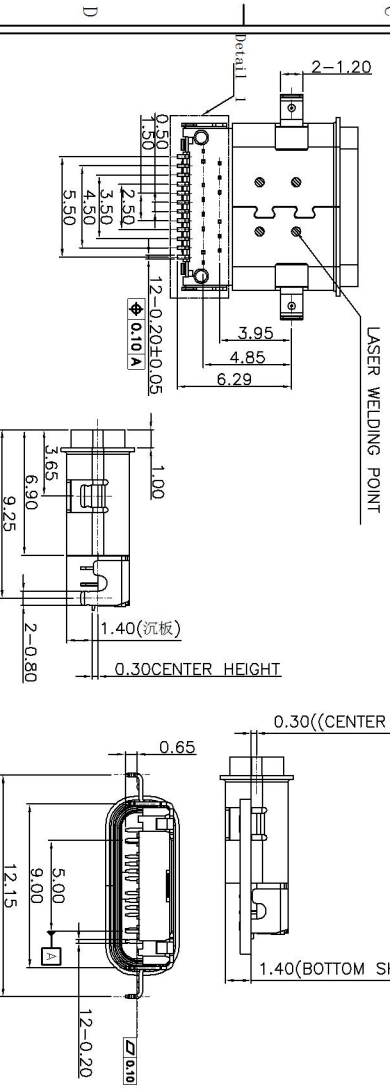
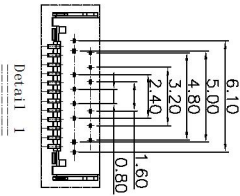
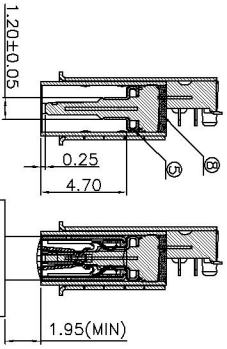
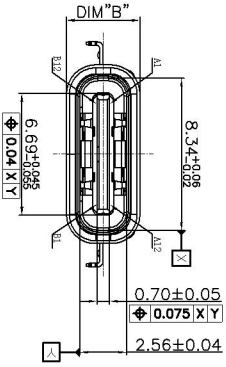
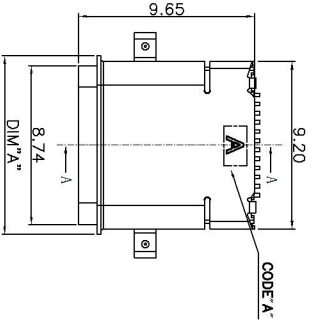

RECOMMENDED P.C.B LAYOUT(Both sides are sample)  
Tolerance:±0.05,Thickness=0.50mm

TABLE 1:

| NO. | PART NAME  | QTY | MATERIAL        | DESCRIPTION | REMARK   |
|-----|------------|-----|-----------------|-------------|----------|
| ⑧   | GLUE WATER | 1   | Epoxy           | BLACK:      |          |
| ⑦   | Shell-2    | 1   | Stainless steel | NI PLATING: | T=0.20mm |
| ⑥   | Shell-1    | 1   | Stainless steel | NI PLATING: | T=0.20mm |
| ⑤   | GND PLATE  | 1   | Stainless steel | NI PLATING: | T=0.10mm |
| ④   | MID PLATE  | 1   | Stainless steel |             | T=0.15mm |
| ③   | Terminal-B | 12  | Copper alloy    | TABLE 2     | T=0.12mm |
| ②   | Terminal-A | 12  | Copper alloy    | TABLE 2     | T=0.12mm |
| ①   | Housing    | 1   | HIGH TEMP       | Block       | T=0.12mm |

**深圳市连欣科技有限公司**

品名 (ITEM NO) TYPE-C 24PIN沉板1.4mm防水母座 直边  
料号 (PART NO) XUBF-0331-C140  
型号 (MODEL NO) N/A

| 图号 (DWG NO)               | 版本 (REV) | 日期 (DATE) | 设计 (DESIGN) | 审核 (CHECKED) | 核准 (APPROVED) | 单位 (UNIT) : MM |
|---------------------------|----------|-----------|-------------|--------------|---------------|----------------|
| A/0                       |          |           |             |              |               | 比例 (SCALE) 1:1 |
| 公差 (TOLERANCE) UNRESERVED |          |           |             |              |               | 未注公差           |
| X.X                       |          |           |             |              |               | ±0.30          |
| X.XX                      |          |           |             |              |               | ±0.20          |
| X.XXX                     |          |           |             |              |               | ±0.10          |
| X.X <sup>0.05</sup>       |          |           |             |              |               | ±0.05          |
| X.X <sup>0.02</sup>       |          |           |             |              |               | ±0.02          |

RoHS Compliant

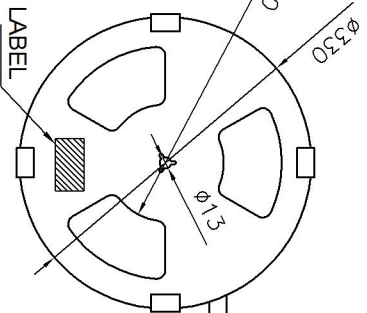
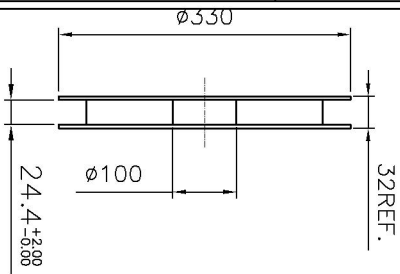

COVER TAPE PEELING ANGLE: 165~180°  
PEELING FORCE: 20~130g

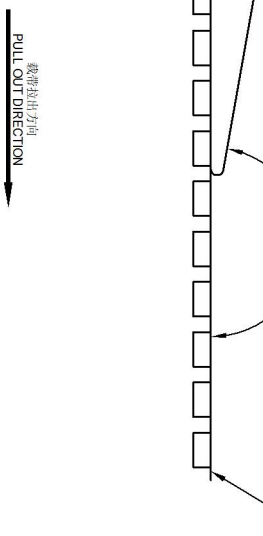

裁带裁出方向  
PULL OUT DIRECTION

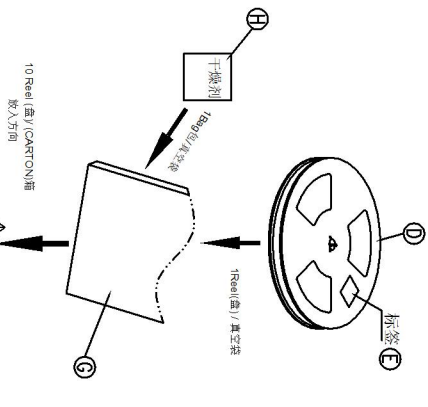
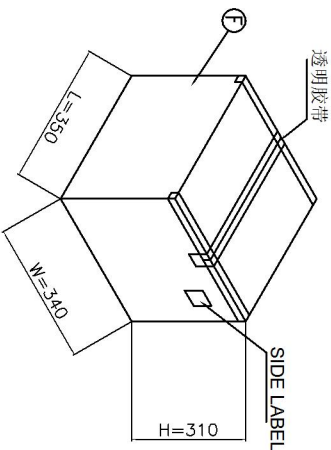
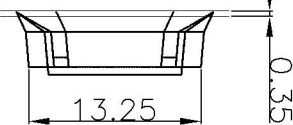
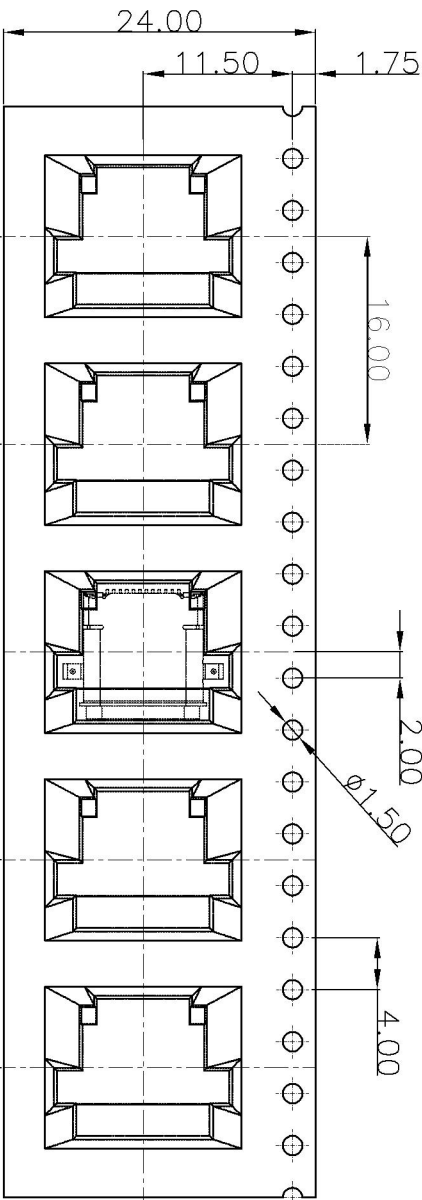

包装方式:  
第一步: 产品使用包装机入包装盘  
(1) 首先将包装盘贴上标签

第二步: 再将成品按照规定的所示方向摆放在于料带中进行包装  
(2) 每盘包装数量700PCS成品  
(3) 每盘包装数量700PCS成品

第三步: 将10个真空袋, 共10盘/7000PCS放入置入外箱的PE袋中  
(1) 将包装完的包装盘每1盘装入1个真空袋中  
(2) 每个真空袋中放入一包干燥剂, 并做真空包装处理  
(3) 将10个真空袋, 共10盘/7000PCS放入置入外箱的PE袋中

第四步: 外包装封口及贴标签  
(1) 先确认外箱里是否有10盘产品  
(2) 包装完成后使用透明胶带封口, 贴LABEL于规定的位置  
(3) 外包装封口及贴标签  
(4) 外包装封口及贴标签  
(5) 外包装封口及贴标签  
(6) 外包装封口及贴标签  
(7) 外包装封口及贴标签

# 深圳市连欣科技有限公司

|               |                            |
|---------------|----------------------------|
| 品名 (ITEM NO)  | TYPE-C 24PIN面板1.4mm防水母座 直边 |
| 料号 (PART NO)  | XUBF-0331-C140             |
| 型号 (MODEL NO) | N/A                        |

| 包装容量 (PACKING CAPACITY) |               |            | 重量 (WEIGHT) (Kg) |          |          |
|-------------------------|---------------|------------|------------------|----------|----------|
| PCS/REEL                | REEL/S/CARTON | PCS/CARTON | N.W./PCS         | N.W./BOX | G.W./BOX |
| 700                     | 10            | 7000       |                  |          |          |

|                            |          |           |             |              |               |                |
|----------------------------|----------|-----------|-------------|--------------|---------------|----------------|
| 图号 (DWG NO)                | 版本 (REV) | 日期 (DATE) | 设计 (DESIGN) | 审核 (CHECKED) | 核准 (APPROVED) | 单位 (UNIT): MM  |
|                            | A/0      |           |             |              |               | 比例 (SCALE) 1:1 |
| 公差 (TOLERANCE) UNSPECIFIED |          |           |             |              |               | 公差 (TOLERANCE) |
|                            |          |           |             |              |               | ±0.30          |
|                            |          |           |             |              |               | ±0.20          |
|                            |          |           |             |              |               | ±0.10          |
|                            |          |           |             |              |               | ±0.05          |
|                            |          |           |             |              |               | ±0.02          |
|                            |          |           |             |              |               | ±0.01          |
|                            |          |           |             |              |               | ±0.005         |
|                            |          |           |             |              |               | ±0.002         |

## X-ON Electronics

Largest Supplier of Electrical and Electronic Components

*Click to view similar products for [USB Connectors](#) category:*

*Click to view products by [Lian Xin](#) manufacturer:*

Other Similar products are found below :

[950](#) [MUSBD11135](#) [17-200721](#) [217450-1](#) [KMBVX-TH-5S-B30](#) [KUSBX-AS2N-W](#) [KUSBX-SMT2AP1S-W30](#) [935](#) [957](#) [30-498-6](#) [SK-60A-2](#)  
[1734082-1](#) [30-470](#) [30-489](#) [30-541](#) [A-USB A-2P-C](#) [MIKROE-1451](#) [USBFTVSCCG](#) [1-1734084-2](#) [10135326-001LF](#) [4198](#) [USB-A-D-VT](#)  
[USB-A-S-RA-TSMT](#) [1310-1023-02](#) [690-024-633-031](#) [UB-20PMFP-LC7001](#) [17-200011](#) [UB-20AFMM-LL7A01](#) [1040870124](#) [CAP-](#)  
[WCCMLPB1](#) [CAP-WCCMLPC1](#) [2274475-3](#) [UB-20BMFA-SL8001](#) [914-614A2025S10200](#) [USB3FTV7SAGF059](#) [ZX40-B-5S-1500-](#)  
[STDA\(30\)](#) [GSB3116344HR](#) [USB3FTV2SAZNF459](#) [USB3FTV7SAZNF459](#) [U221-041N-1WVS62-F5D](#) [HYCW153-USBD05-500B](#)  
[HYCW219-USBD05-075B](#) [HYCW148-USBD05-117B](#) [HYCW149-USBD05-740B](#) [HYCW204-USBD05-108B](#) [HYCW214-USBA04-113B](#)  
[HYCW213-USBA04-113B](#) [UB-20AMFM-SL7A01](#) [KMMX-BSMT35S-1-B30TR](#) [2345986-1](#)