



LED Display Product Data Sheet LTS-3361JD

Spec No.: DS30-2001-436

Effective Date: 09/30/2003

Revision: A

LITE-ON DCC

RELEASE

BNS-OD-FC001/A4

FEATURES

- * 0.3 inch (7.62 mm) DIGIT HEIGHT
- * CONTINUOUS UNIFORM SEGMENTS
- * LOW POWER REQUIREMENT
- * EXCELLENT CHARACTERS APPEARANCE
- * HIGH BRIGHTNESS & HIGH CONTRAST
- * WIDE VIEWING ANGLE
- * SOLID STATE RELIABILITY
- * CATEGORIZED FOR LUMINOUS INTENSITY

DESCRIPTION

The LTS-3361JD is a 0.3 inch (7.62 mm) height digit display. The device uses AS-AllnGaP HYPER RED LED chips (AllnGaP epi on GaAs substrate). The display has light gray face and white segments.

DEVICE

| PART NO. | DESCRIPTION |
|-------------------|--------------------|
| AllnGaP HYPER RED | Common Cathode |
| LTS-3361JD | Rt. Hande Decimal |

PACKAGE DIMENSIONS

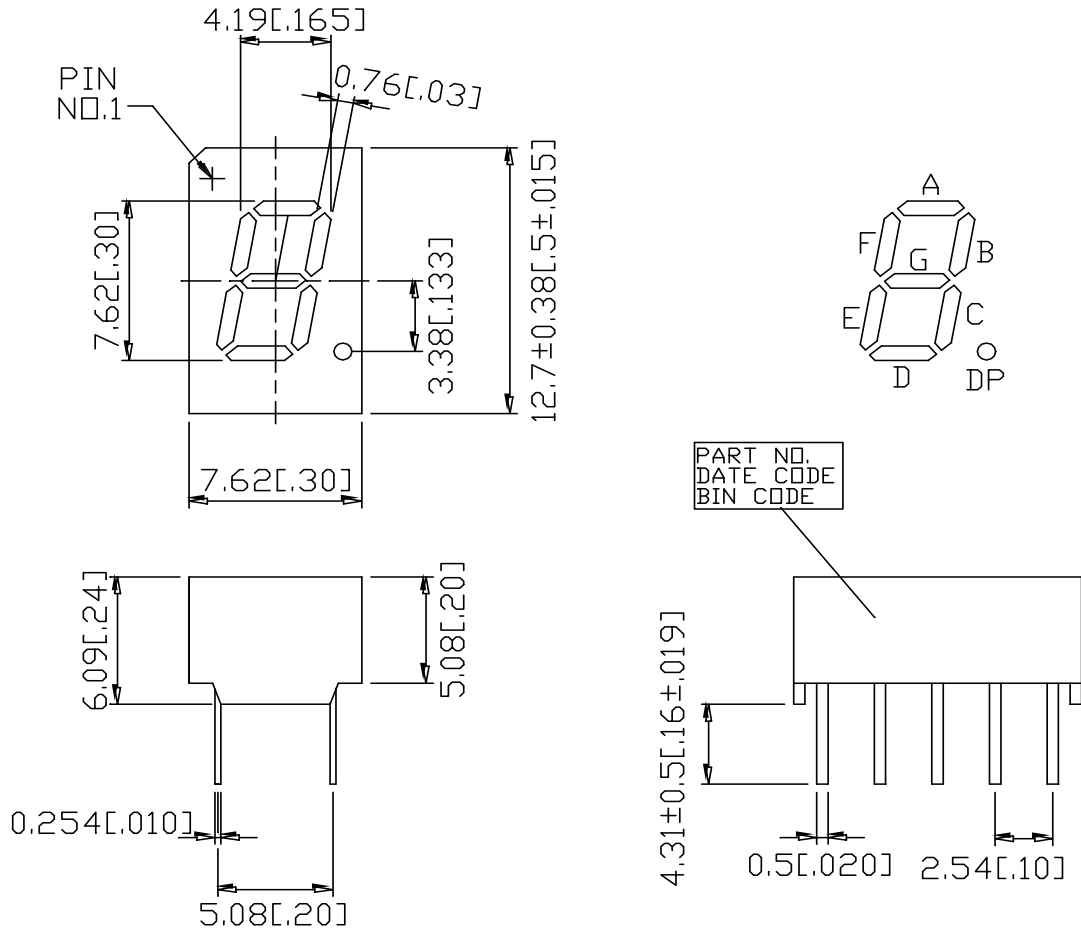

NOTES: All dimensions are in millimeters. Tolerances are ± 0.25 mm (0.01") unless otherwise noted.

INTERNAL CIRCUIT DIAGRAM

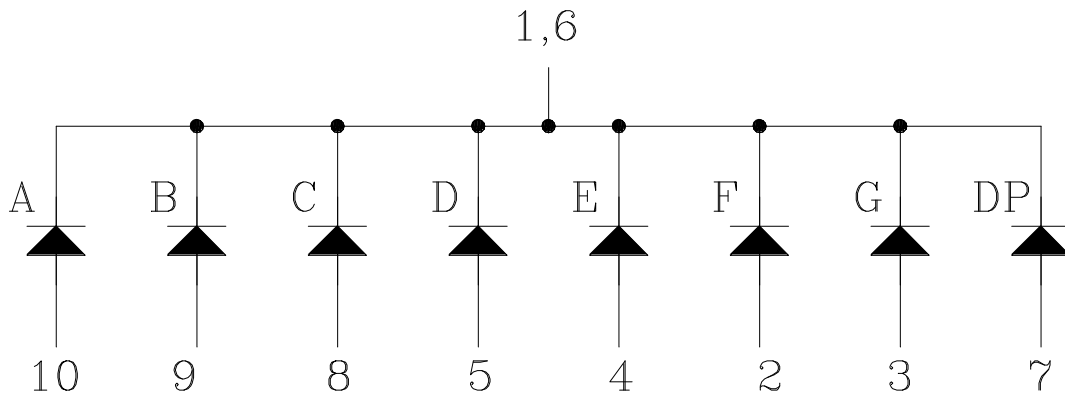

PIN CONNECTION

| No. | CONNECTION |
|------------|-------------------|
| 1 | COMMON CATHODE |
| 2 | ANODE F |
| 3 | ANODE G |
| 4 | ANODE E |
| 5 | ANODE D |
| 6 | COMMON CATHODE |
| 7 | ANODE DP |
| 8 | ANODE C |
| 9 | ANODE B |
| 10 | ANODE A |

ABSOLUTE MAXIMUM RATING

| PARAMETER | MAXIMUM RATING | UNIT |
|--|--|--------------------|
| Power Dissipation Per Segment | 70 | mW |
| Peak Forward Current Per Segment (Frequency 1Khz, 18% duty cycle) | 90 | mA |
| Continuous Forward Current Per Segment | 25 | mA |
| Forward Current Derating from 25 ⁰ C | 0.33 | mA/ ⁰ C |
| Reverse Voltage Per Segment | 5 | V |
| Operating Temperature Range | -35 ⁰ C to +85 ⁰ C | |
| Storage Temperature Range | -35 ⁰ C to +85 ⁰ C | |
| Soldering Conditions : 1/16 inch below seating plane for 3 seconds at 260 ⁰ C | | |

ELECTRICAL / OPTICAL CHARACTERISTICS AT Ta=25⁰C

| PARAMETER | SYMBOL | MIN. | TYP. | MAX. | UNIT | TEST CONDITION |
|--|-------------------|------|------|------|------|----------------------|
| Average Luminous Intensity Per Segment | I _v | 200 | 600 | | μcd | I _F =1mA |
| Peak Emission Wavelength | λ _p | | 650 | | nm | I _F =20mA |
| Spectral Line Half-Width | Δλ | | 20 | | nm | I _F =20mA |
| Dominant Wavelength | λ _d | | 639 | | nm | I _F =20mA |
| Forward Voltage Per Segment | V _F | | 2.1 | 2.6 | V | I _F =20mA |
| Reverse Current Per Segment | I _R | | | 100 | μA | V _R =5V |
| Luminous Intensity Matching Ratio | I _v -m | | | 2:1 | | I _F =1mA |

Note: Luminous intensity is measured with a light sensor and filter combination that approximates the CIE (Commision Internationale De L'Eclairage) eye-response curve.

TYPICAL ELECTRICAL / OPTICAL CHARACTERISTIC CURVES

(25°C Ambient Temperature Unless Otherwise Noted)

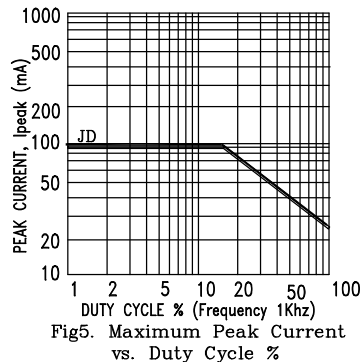
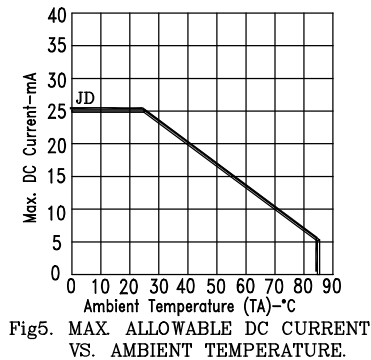
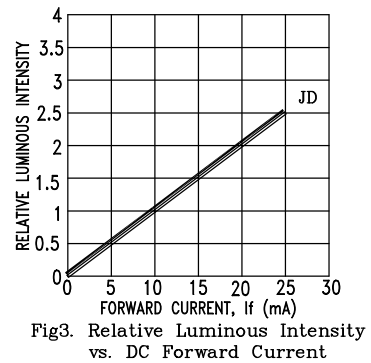
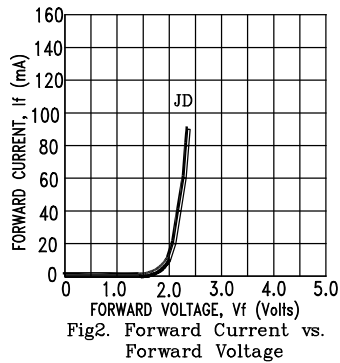
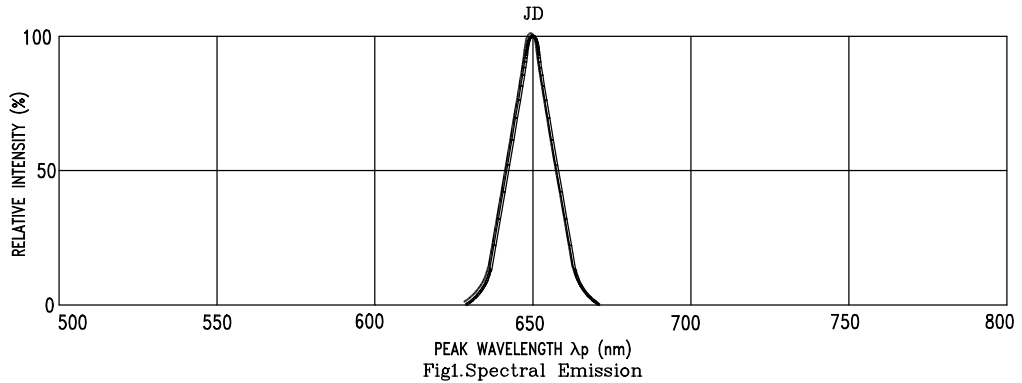

NOTE : JD=AlInGaP HYPER RED

X-ON Electronics

Largest Supplier of Electrical and Electronic Components

Click to view similar products for [LED Displays & Accessories](#) category:

Click to view products by [Lite-On](#) manufacturer:

Other Similar products are found below :

[LTC-2721WC](#) [LTC-4624JD](#) [LTC-4627G](#) [LTC-4627WC](#) [LTD-5021AWC](#) [LTM-8522G](#) [LTP-4323P](#) [LTP-747G](#) [LTS-3361JG-06](#)
[F416SYGWA/S530-E3](#) [EADST040RA2](#) [1668](#) [HT-F196NB-5323](#) [IPD2131-27](#) [SA03-12EWA](#) [LDD-E2802RD](#) [LDD-E306MI](#) [LDQ-N514RI](#)
[LDS-A3506RD](#) [LDS-A3926RI](#) [LDT-M516RI](#) [SC03-12HDB](#) [SI-B9T151550WW](#) [SI-B9V171550WW](#) [SLC-3PF-WL](#) [1624](#) [LTC-2621JD](#)
[LTC-2623WC](#) [LTC-4624P](#) [LTC-4627JD](#) [LTD-2601E](#) [LTD-322G](#) [LTD-482PC](#) [LTP-1457AKR](#) [LTP-3784G-01](#) [LTS-313AP](#) [LTS-4812SKR-](#)
[P](#) [LTS-547AE](#) [LTS-6780P](#) [446010401-3](#) [HV-7W30-6829](#) [CA12240_MINNIE-WWW-MTG-ASSY](#) [DA43-11GWA](#) [LDD-A516RI-17](#) [LDD-](#)
[E305RI](#) [LDQ-M513RI](#) [LDQ-M5204RI-SI](#) [LDQ-N3402RI](#) [LDQ-N3606RI](#) [LDT-M2804RI](#)