

MEGA® Fuses

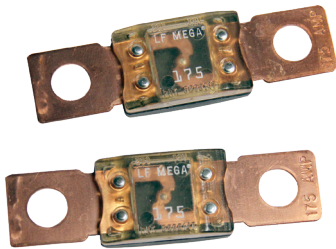

MEGA® Clear Top Housing Fuse

MEGA® and MEGA® Clear Top Fuse Rated 32V

The MEGA® Fuse is designed for high current circuit protection up to 500A with “Diffusion Pill Technology.” The MEGA® Fuse also provides time delay characteristics. Designed and patented by Littelfuse, the MEGA® Fuse is ideal for battery and alternator protection application and other heavy gauge cables requiring ultra-high current protection.

Specifications

| | |
|------------------------------|---|
| Interrupting Rating: | 2000A @ 32 VDC |
| Voltage Rating: | 32 VDC |
| Operating Temperature Range: | -40°C to + 125°C |
| Housing Material: | PPA-GF33HS |
| Flammability (UL 94): | HB |
| Clear Top Housing Material: | PES (top) PPA-GF33HS (bottom) |
| Terminals: | Copper (Silver plated copper available) M6 or M8 bolts available |
| Mounting Torque: | 8-14 Nm M6 12-18 Nm M8 |
| Complies with: | ISO 8820-5 |



Ordering Information

| Part Number | Rating | Package Size | Plating | Bolt Size | Bolt Hole Qty |
|---|-----------|--------------|---------|-----------|---------------|
| 0298xxx.ZXEH | 80 - 250 | 500 | None | M8 | 2 |
| 0298xxx.ZXH | 300 - 500 | 500 | None | M8 | 2 |
| 0298xxx.UX1M8 | 80 - 500 | 500 | None | M8 | 1 |
| 0298xxx.ZXB | 40 - 250 | 500 | Ag | M8 | 2 |
| 0298xxx.ZXA | 80 - 500 | 500 | None | M6 | 2 |
| MEGA Clear Top Housing Material Fuse | | | | | |
| 0298xxx.UXT | 40 - 250 | 500 | None | M8 | 2 |

Time-Current Characteristics

| % of Rating | Opening Time Min / Max (s) | |
|-------------|----------------------------|---------------|
| | 40-250 | 300-500 |
| 75 | - / - | 14,400 s / - |
| 100 | 14,400 s / - | - / - |
| 135 | 120 s / 1800 s | - / - |
| 200 | 1 s / 15 s | 1 s / 15 s |
| 350 | 0.300 s / 5 s | 0.500 s / 5 s |
| 600 | 0.100 s / 1 s | 0.100 s / 1 s |

Ratings

| Part Number | Current Rating (A) | Font Color* | Typ. Voltage Drop (mV) | Cold Resistance (mΩ) | Wire (mm ²) | I ² t (A ² s) |
|-------------|--------------------|-------------|------------------------|----------------------|-------------------------|-------------------------------------|
| 0298040._1 | 40 | - | 132 | 2.510 | 4 | 8700 |
| 0298060._1 | 60 | - | 119 | 1.504 | 6 | 21000 |
| 0298080._ | 80 | Red | 87 | 0.720 | 10 | 21500 |
| 0298100._ | 100 | Yellow | 87 | 0.562 | 16 | 31100 |
| 0298125._ | 125 | Green | 80 | 0.423 | 16 | 57800 |
| 0298150._ | 150 | Orange | 92 | 0.352 | 25 | 100000 |
| 0298175._ | 175 | White | 86 | 0.294 | 25 | 168000 |
| 0298200._ | 200 | Blue | 83 | 0.257 | 35 | 204000 |
| 0298225._ | 225 | Brown | 82 | 0.222 | 35 | 257000 |
| 0298250._ | 250 | Pink | 82 | 0.201 | 50 | 389000 |
| 0298300._2 | 300 | Grey | 74 ** | 0.167 | 70 | 315000 |
| 0298350._2 | 350 | Dark Green | 68 ** | 0.138 | 70 | 500000 |
| 0298400._2 | 400 | Purple | 64 ** | 0.126 | 70 | 610000 |
| 0298450._2 | 450 | Yellow | 60 ** | 0.112 | 70 | 1050000 |
| 0298500._2 | 500 | Brown | 58 ** | 0.092 | 70 | 2050000 |

Note 1: Not mentioned in ISO standards Note 2: Short Circuit Protector only

* 0298xxx.ZXB has white font color on all ratings.

** Voltage Drop measurements for short circuit protectors taken at 75% of rated current.

MEGA® Fuse Rated 32V

Dimensions

Dimensions in mm

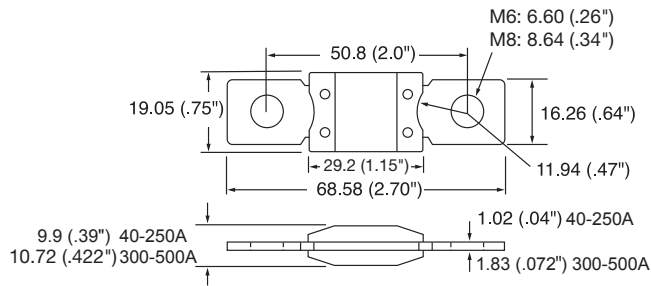

Typical Derating

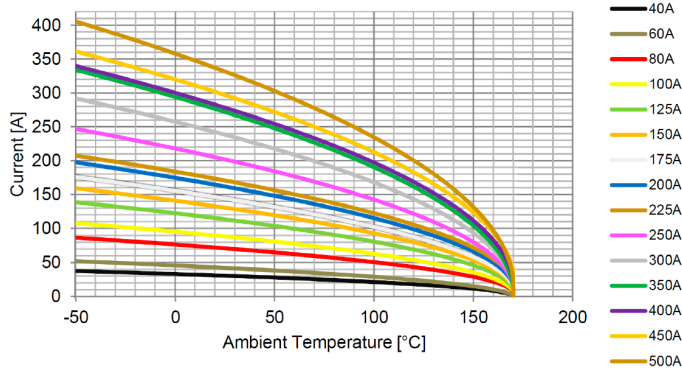

Temperature Security Margin is 20%
Wire Cross Sections And Test Fixture acc. ISO 8820-5

| max. allowed current load [A] at ambient temperature | | | | | | | | |
|--|-------|-----|------|------|------|------|-------|-------|
| | -20°C | 0°C | 20°C | 65°C | 85°C | 95°C | 105°C | 125°C |
| 40A | 35 | 33 | 31 | 26 | 23 | 22 | 20 | 17 |
| 60A | 48 | 46 | 43 | 36 | 32 | 30 | 28 | 23 |
| 80A | 81 | 76 | 72 | 61 | 55 | 52 | 49 | 41 |
| 100A | 101 | 95 | 90 | 76 | 69 | 65 | 61 | 51 |
| 125A | 129 | 123 | 116 | 98 | 88 | 83 | 78 | 66 |
| 150A | 149 | 141 | 133 | 112 | 102 | 96 | 90 | 76 |
| 175A | 164 | 156 | 147 | 124 | 112 | 106 | 99 | 84 |
| 200A | 184 | 175 | 165 | 139 | 126 | 119 | 112 | 94 |
| 225A | 194 | 184 | 174 | 147 | 134 | 127 | 119 | 101 |
| 250A | 230 | 218 | 205 | 173 | 157 | 147 | 138 | 116 |
| 300A | 272 | 258 | 242 | 204 | 184 | 174 | 162 | 136 |
| 350A | 311 | 294 | 277 | 232 | 209 | 197 | 184 | 154 |
| 400A | 317 | 300 | 283 | 239 | 216 | 204 | 191 | 161 |
| 450A | 337 | 320 | 302 | 256 | 232 | 219 | 206 | 175 |
| 500A | 378 | 358 | 337 | 284 | 257 | 242 | 227 | 191 |

Time-Current Characteristic Curves

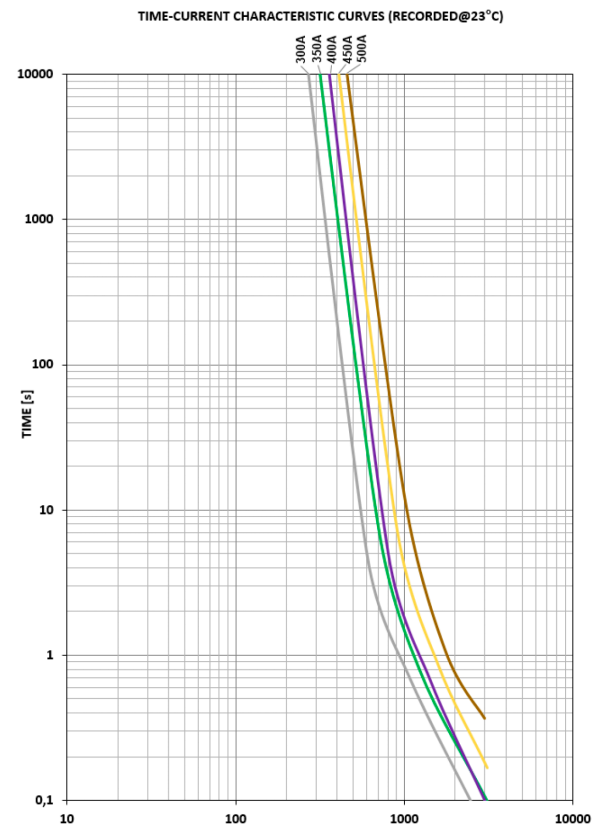
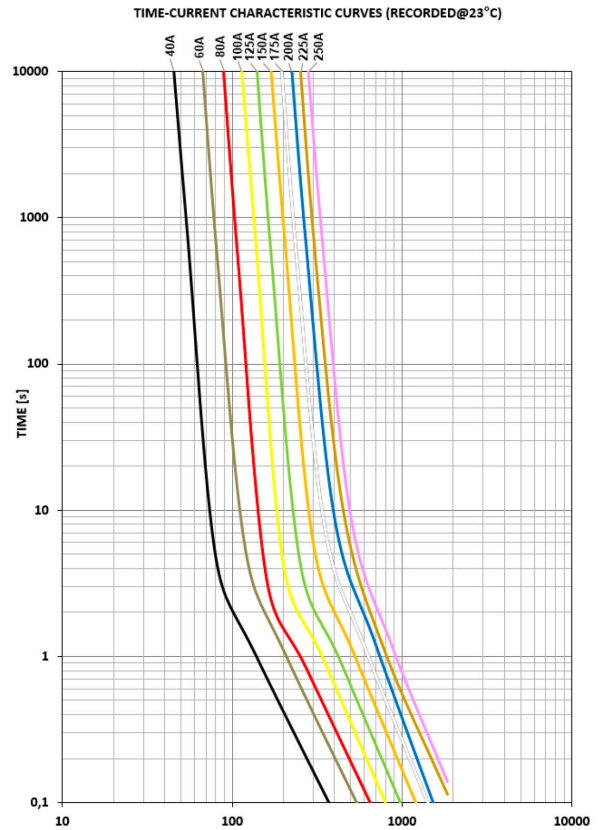

Littelfuse products are not designed for, and shall not be used for, any purpose (including, without limitation, automotive, military, aerospace, medical, life-saving, life-sustaining or nuclear facility applications, devices intended for surgical implant into the body, or any other application in which the failure or lack of desired operation of the product may result in personal injury, death, or property damage) other than those expressly set forth in applicable Littelfuse product documentation. Warranties granted by Littelfuse shall be deemed void for products used for any purpose not expressly set forth in applicable Littelfuse documentation. Littelfuse shall not be liable for any claims or damages arising out of products used in applications not expressly intended by Littelfuse as set forth in applicable Littelfuse documentation. The sale and use of Littelfuse products is subject to Littelfuse Terms and Conditions of Sale, unless otherwise agreed by Littelfuse.

X-ON Electronics

Largest Supplier of Electrical and Electronic Components

Click to view similar products for [Automotive Fuses](#) category:

Click to view products by [Littelfuse](#) manufacturer:

Other Similar products are found below :

[ATM-4LP](#) [299080](#) [0287015](#) [FMM-15](#) [0297003.WXT](#) [0695060.PXPS](#) [MRBF-075](#) [MRBF-300](#) [MRBF-200](#) [ANX80-UL-20A](#) [ANX80-UL-25A](#) [ANX80-UL-30A](#) [ANX80-UL-35A](#) [ANX80-UL-40A](#) [ANT-I-3A](#) [APM-I-25A](#) [APR-10A](#) [APR-25A](#) [ANX58-UL-20A](#) [ANX58-UL-25A](#) [ANX58-UL-35A](#) [ANX58-UL-40A](#) [ANX58-UL-50A](#) [ANM-4A](#) [ANM-25A](#) [ANE-175A](#) [APM-25A](#) [APM-4A](#) [ACB2-PL-15A](#) [ACB2-PL-25A](#) [ANM58-15A](#) [ANM58-5A](#) [MIDA-50A](#) [0695040.PXP](#) [0327030.YX2T](#) [0298500.UX1M8](#) [0299070.ZXT](#) [ATM-1](#) [MRBF-040](#) [MRBF-250](#) [MRBF-050](#) [MRBF-060](#) [CFCOVER-2R](#) [MRBF-030](#) [3298600.ZXM10](#) [AMG-80](#) [FLG-80](#) [BK-AMG-225](#) [BK/FMM-15](#) [0283070.H](#)