

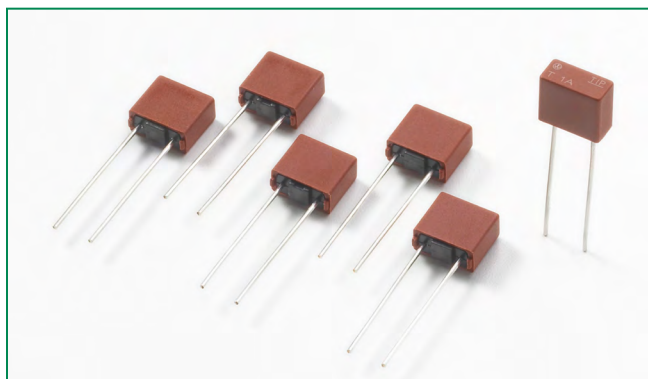

385 Series, TE5® Telecom Interface Protector Fuse



Agency Approvals

| Agency | Agency File Number | Ampere Range |
|---|--------------------|---------------|
|  | E67006 | 0.350A - 1.5A |

Additional Information



Datasheet



Resources



Samples

Description

The 385 Series TE5R Telecom Interface Protector Fuses are 125V rated, Time-Lag type and designed in accordance to UL 248-14.

Features

- Surge proof for telecom applications
- Reduced PCB space requirements
- Highly defined cut-off times
- Low internal resistance
- Irreversible physical separation
- Flame resistant encapsulated casing
- Available from 0.350A to 1.5A

Applications

- Battery chargers
- Consumer Electronics
- Telecom
- Power supplies
- Industrial controllers

Electrical Characteristics

| % of Ampere Rating | Opening Time |
|--------------------|-----------------------------|
| 100% | 2 Hours, |
| 300% | 300 ms., Min.; 5 sec., Max. |

Electrical Characteristics

| Amp Code | Rated Current | Voltage Rating | Breaking Capacity | Nominal Cold Resistance (Ohms) | Voltage Drop 1.0xI _N max. (mV) | Power Dissipation 1.0xI _N max. (mW) | Melting Integral 10xI _N max. (A ² s) | Surge Amplitude (A) ¹ | | | Agency Approvals |
|----------|---------------|----------------|-------------------|--------------------------------|---|--|--|----------------------------------|----------|-----|------------------|
| | | | | | | | | FCC | Bellcore | ITU | |
| 0350 | 350mA | 125V | 50A @125VAC | 0.4320 | 250 | 90 | 0.78 | 32 | 19 | 36 | x |
| 0500 | 500mA | 125V | | 0.2570 | 220 | 110 | 1.81 | 48 | 26 | 61 | x |
| 0800 | 800mA | 125V | | 0.1290 | 170 | 130 | 4.35 | 80 | 42 | 67 | x |
| 1100 | 1.00A | 125V | | 0.0830 | 140 | 130 | 6.75 | 100 | 52 | 67 | x |
| 1125 | 1.25A | 125V | | 0.0610 | 125 | 140 | 9.84 | 128 | 65 | 67 | x |
| 1150 | 1.50A | 125V | | 0.0495 | 120 | 170 | 11.52 | 155 | 78 | 67 | x |

¹ FCC 47 Part 68: Minimum pulse load quantity is 2 pulses at a test generator output of 800V and 10x560µs waveform.
 ITU-T K.20: Minimum pulse load quantity is 30 pulses at a test generator output of 1000V, 67A and 10x700µs waveform.
 Bellcore GR-1089: Minimum pulse load quantity is 50 pulses at a test generator output of 1000V and 10x1000µs.
 Note: 1.00 means the number one with two decimal places. 1,000 means the number one thousand.

Temperature Re-rating Curve

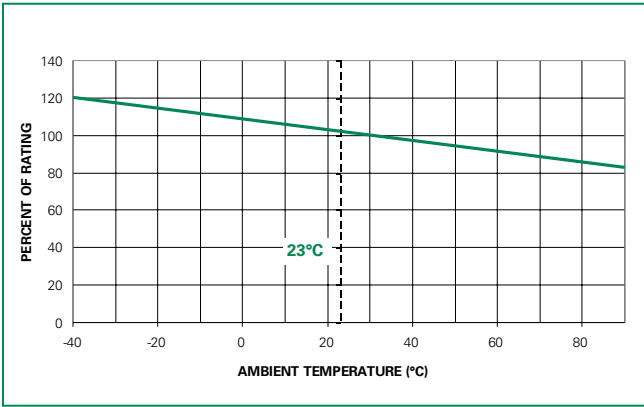

Note:
1. Rerating depicted in this curve is in addition to the standard derating of 25% for continuous operation.

Average Time Current Curves

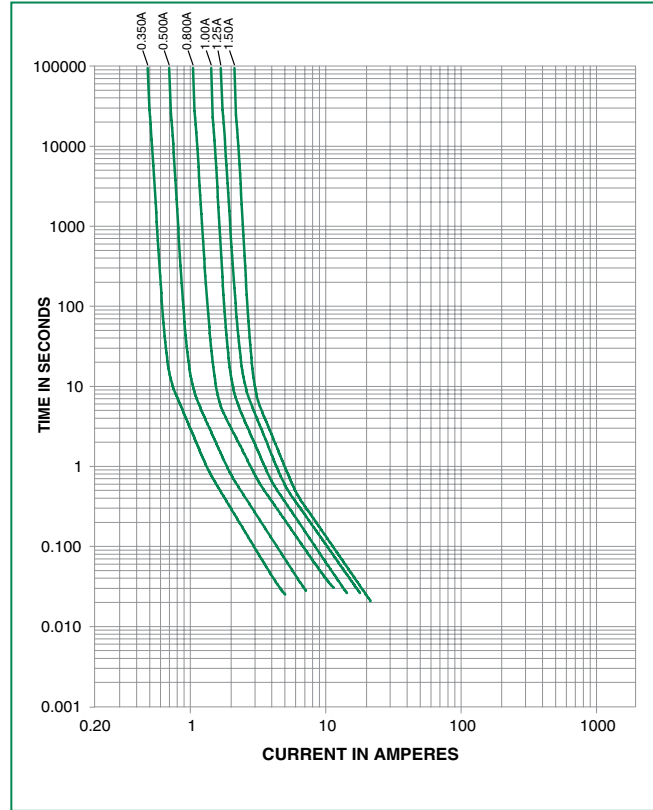

Soldering Parameters - Wave Soldering

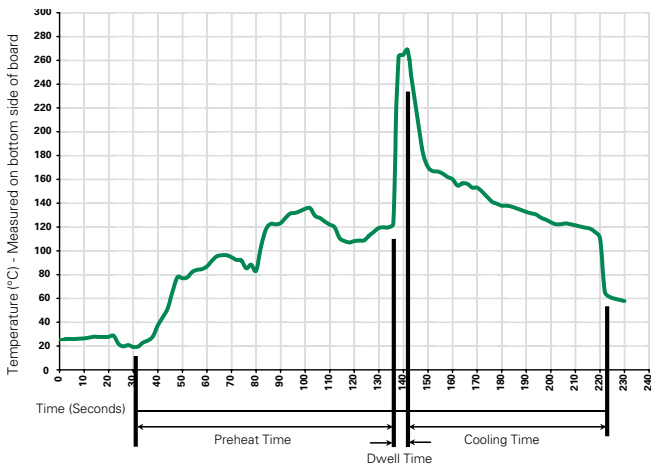

Recommended Process Parameters:

| Wave Parameter | Lead-Free Recommendation |
|---|-----------------------------------|
| Preheat: (Depends on Flux Activation Temperature) | (Typical Industry Recommendation) |
| Temperature Minimum: | 100°C |
| Temperature Maximum: | 150°C |
| Preheat Time: | 60-180 seconds |
| Solder Pot Temperature: | 260°C Maximum |
| Solder Dwell Time: | 2-5 seconds |

Solder Iron Temperature: 350°C +/- 5°C
Heating Time: 5 seconds max.

Product Characteristics

| | |
|----------------------------------|--|
| Materials | Base/Cap: Brown Thermoplastic Polyamide PA 6.6, UL 94V-0 Round Pins: Copper, Tin-plated |
| Lead Pull Strength | 10N (IEC 60068-2-21) |
| Solderability | 260°C, ≤ 3s. (Wave) 350°C, ≤ 1s. (Soldering Iron) |
| Soldering Heat Resistance | 260°C, 10s. (IEC 60068-2-20) 350°C, 3s. (Soldering Iron) |

| | |
|------------------------------|--|
| Operating Temperature | -40°C to +85°C (consider re-rating) |
| Climatic Category | -40°C to +85°C/21 days (IEC 60068-1,-2-1,-2-2,-2-78) |
| Stock Conditions | +10°C to +60°C RH, ≤ 75% yearly average, without dew, maximum value for 30 days-95% |
| Vibration Resistance | 24 cycles at 15 min. each (IEC 60068-2-6) 10 - 60Hz at 0.75mm amplitude 60 - 2000Hz at 10g acceleration |

Dimensions

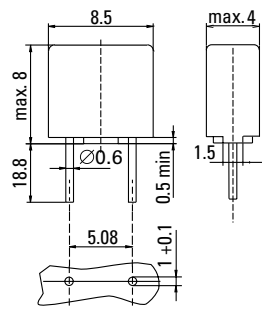

Holes in the printed circuit board

Dimensions (mm)
Long Leads (L=18.8mm)

Part Numbering System

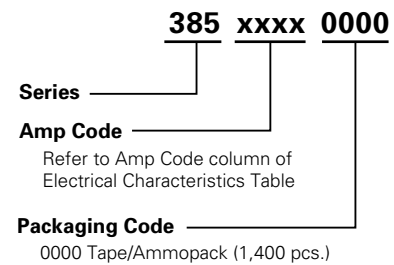

Packaging

| Packaging Option | Packaging Specification | Quantity | Quantity & Packaging Code | Taping Width |
|-------------------|-------------------------|----------|---------------------------|--------------|
| 385 Series | | | | |
| Tape & Ammopack | N/A | 1,400 | 0000 | N/A |

X-ON Electronics

Largest Supplier of Electrical and Electronic Components

Click to view similar products for [Fuses with Leads - Through Hole](#) category:

Click to view products by [Littelfuse](#) manufacturer:

Other Similar products are found below :

[89096-013](#) [89096-015](#) [A170100400](#) [252010](#) [25202.5](#) [252.062](#) [263.500](#) [265.750](#) [272.005](#) [273.600V](#) [274.250](#) [SR-5H-5A-BK](#) [SS-5-800MA-AP](#) [SS-5F-3.15A-AP](#) [252004](#) [263.750](#) [273.005](#) [3701630000](#) [LKB-3](#) [0473004.MAT1L](#) [0473.750HAT1L](#) [0473001.HAT1L](#) [0473002.HAT1L](#) [0473.500HAT1L](#) [SS-5-1.6A-AP](#) [SS-5F-2.5A-AP](#) [SS-5-6.3A-BK](#) [SR-5H-4A-AP](#) [RST 5-AMMO](#) [SR-5H-3.15A-BK](#) [SR-5H-2A-BK](#) [89096-005](#) [SR-5F-1-6A-BK](#) [SS-5FH-3.15A-AP](#) [SS-5-630MA-AP](#) [047301.5HAT1L](#) [SS-5H-1-25A-APH](#) [SR-5H-800MA-APH](#) [0034.722](#) [34.732](#) [MSF 4A 250V](#) [22D03-200](#) [883324G](#) [883220G](#) [883317G](#) [883217G](#) [0263004.HAT1L](#) [0263.750HAT1L](#) [0473003.MXL](#) [0697-0100-01](#)