

Holder / No. 562 PC Mount, for TR5®/TE5® Fuses

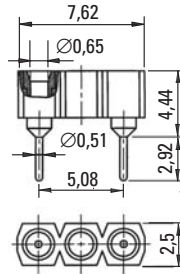

Holes in PCB

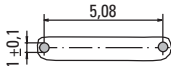

Specifications

- Packaging**
100 bulk (1000 pcs.)
- Mounting**
PC Board, 5.08mm pin spacing
- Materials**
Holder: Black Thermoplastic, UL94 V-0
 Nylon 46
Terminals: Copper alloy; solderable
 tinned
- Electrical Data (23°C)**
Rated Voltage: 250V
Max. Current/Power: 6.3A/1.6W
- Minimum Cross Section**
Conducting path - 0.1mm²
- Unit Weight**
0.12g



Order Information

Qty.	Order-Number	Series	Packaging
		562	0000 100

Specifications are subject to change without notice

Holder / No. 564 Surface Mount, for TR5®/TE5® Fuses

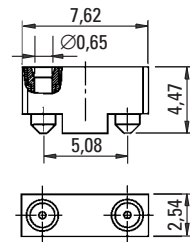

recommended Pad Layout (mm)

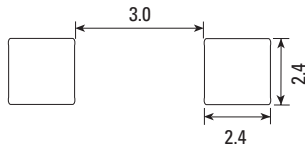

- Packaging**
100 Tape/Reel (1500 pcs.)
 Carrier tape width 16 mm
 Reel diameter 33 cm
- Order Number**
Holder No. 564 0000 100
- Mounting**
PC Board, 5.08mm pad spacing
- Materials**
Holder: Black Thermoplastic, UL94 V-0
 Nylon 46
Terminals: Copper alloy; solderable
 tinned
- Electrical Data (23°C)**
Rated Voltage: 250V
Max. Current/Power: 6.3A/1.6W
- Minimum Cross Section**
Conducting path - 0.1mm²
- Unit Weight**
0.44g



Order Information

Qty.	Order-Number	Series	Packaging
		564	0000 100

Specifications are subject to change without notice

Note: 1.00 means the number one with two decimal places. 1,000 means the number one thousand.

X-ON Electronics

Largest Supplier of Electrical and Electronic Components

Click to view similar products for [Fuse Holder](#) category:

Click to view products by [Littelfuse](#) manufacturer:

Other Similar products are found below :

[570-290-741P40](#) [570-290-751P40](#) [020417G](#) [020418E](#) [6R30A1B](#) [F600A3B](#) [80910030](#) [8601.2020](#) [G15A2SPQ](#) [9-3557-GP REV A](#) [HDJ-B](#)
[R6J30A3S](#) [HFH-1](#) [RF30A2B](#) [RF30A3SP](#) [15600-08-10](#) [BK/FHN19G](#) [BK/HHM](#) [BK/HKP-CCHH](#) [BK/HKP-JJ](#) [BK/HTJ-LES-FUSE](#) [HMG-](#)
[241](#) [HTJ-LES-FUSE](#) [C4044-1](#) [2086-1](#) [2193](#) [2602](#) [2650](#) [178.000100](#) [FHN31G1](#) [T30A2B](#) [G4PB8](#) [2660](#) [2799](#) [CQ-209V](#) [HKP-CCHH](#)
[R6F30A2S](#) [341001A](#) [345621A](#) [CVRMCC](#) [4202](#) [4407](#) [4408](#) [4413](#) [4423](#) [4532](#) [4537](#) [TSD1404-12](#) [BK/FHN31G1](#) [BK/HC-5](#)