

**MEGA®-FLEX Holder for MEGA® Fuses**

RoHS



**Specifications:**

<b>Max. Voltage Rating:</b>	32 VDC
<b>Max. Current Rating:</b>	500A
<b>Operating Temperature Range:</b>	-40°C to +125°C
<b>Wire Size:</b>	70 - 8 mm <sup>2</sup>
<b>Recommended Fuse Installation Torque:</b>	12 - 18Nm
<b>Recommended Mounting (using M6 Screw/Washer):</b>	5Nm
<b>Base Material:</b>	UL94V0 Glass-filled PPA
<b>Cover Material:</b>	UL94V0 Elastomer

The MEGA®-FLEX fuse holder is used with the MEGA® style bolt-down fuse, which is available up to 500A. This holder offers a flexible cover, which allows cable entry from virtually any direction, large wire size, and ring terminal stack up. Slots on the base allow holder to be mounted with tie wraps. Dovetail features allow you to interlock multiple MEGA®-FLEX fuse holders together for a high power distribution block. Bus bars are available for multiple holder applications.

Part Number	Description	Material (Studs and hardware)
02981028HXFCB	Base-only (No Hardware)	Zinc-Plated Steel
02981028HXFCC	Cover-only	-
02981028HXFC	Assembly	Zinc-Plated Steel
02981028HXFC-SS	Assembly	Stainless Steel
882-835-2	2-Position bus Bar	Tin-Plated Copper
882-835-3	3-Position bus Bar	Tin-Plated Copper
882-835-4	4-Position bus Bar	Tin-Plated Copper
882-835-5	5-Position bus Bar	Tin-Plated Copper

**MEGA®-FLEX Holder for MEGA® Fuses**

Dimensions in mm

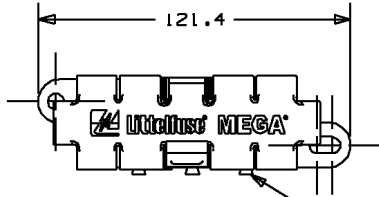

DOVETAIL FEATURES  
USED TO INTERLOCK  
MULTIPLE HOLDERS

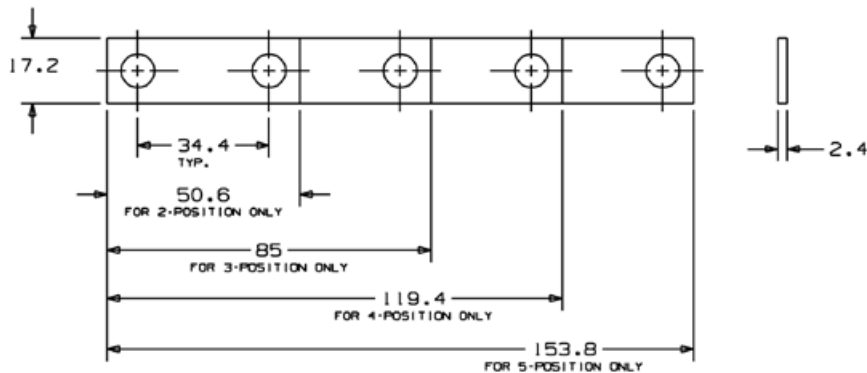
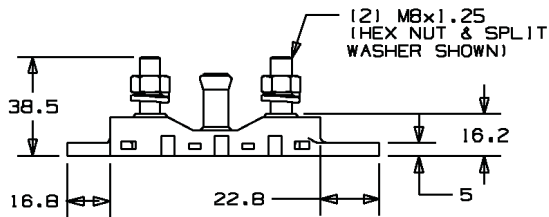
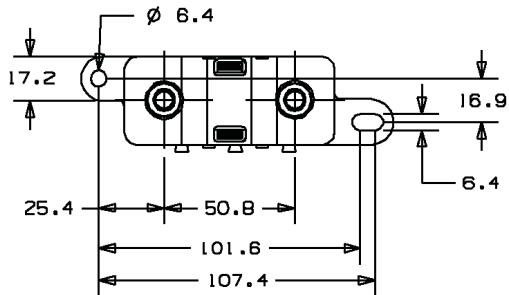
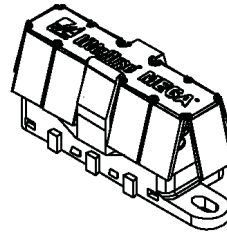
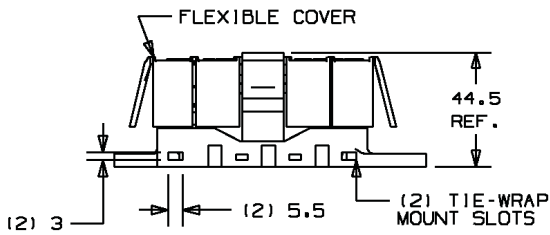
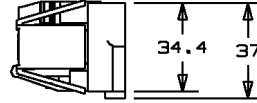

## X-ON Electronics

Largest Supplier of Electrical and Electronic Components

*Click to view similar products for [Automotive Connectors](#) category:*

*Click to view products by [Littelfuse](#) manufacturer:*

Other Similar products are found below :

[003-018-000](#) [600858](#) [60403001](#) [60993906-B](#) [60993913-B](#) [629515004020001](#) [M902-2131](#) [M902-2161](#) [M902-2344](#) [72.330.1035.1](#)  
[73.353.4028.0](#) [F118010](#) [F119300-B](#) [F132210](#) [F132210-B](#) [F166900](#) [F180100](#) [F258300](#) [F258300-B](#) [F294300-B](#) [F339100](#) [F339700](#) [F358300-](#)  
[B](#) [F374110](#) [F407400](#) [F412210](#) [F427600](#) [F444110](#) [F487000](#) [F495100-B](#) [F500900-B](#) [F509500B-B](#) [770444-1](#) [776880-1](#) [827153-1](#) [881735-1](#)  
[8N1515-32-24P](#) [9-1326727-8](#) [9-1326729-8](#) [925467-1](#) [925474-1](#) [928905-1](#) [936398-2](#) [964562-1](#) [964562-4](#) [964731-2](#) [965051-1](#) [968782-1](#)  
[GT17SA-8DS-HU](#) [GT17VS-10DP-5.2CF](#)