

03

0317

Circular connectors with threaded joint M16 acc. to IEC 61076-2-106, IP40/IP68



Chassis plug acc. to IEC 61076-2-106, IP68, with threaded joint, for printed circuit boards, for back side mounting

03 0317

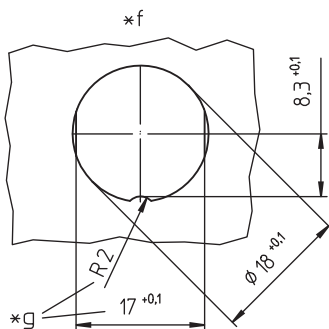
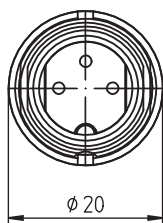
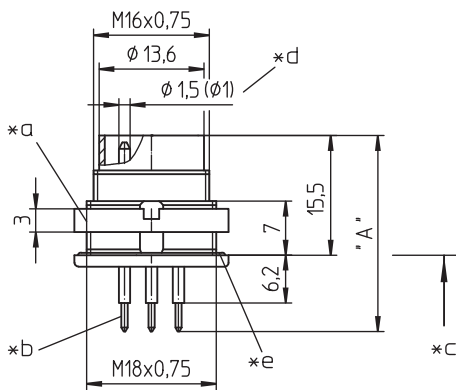
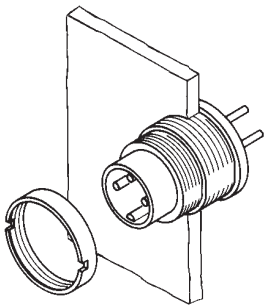

Environmental conditions

Temperature range -40 °C/+85 °C

Materials

Insulating body PA GF, V-0 according to UL94
 Contact pin CuZn, silver-plated and flash gold-plated, tin-plated in solder area (3-8 poles)
 CuZn, pre-nickel and gold-plated, tin-plated in solder area (12-14 poles)
 Housing Zn diecast, pre-copper and nickel-plated
 Ring screw CuZn, nickel-plated
 Seal NBR

Mechanical data

Tightening torque connector 1-3 Nm
 Tightening torque nut 1-3 Nm
 Protection class IP68¹

¹ according to IEC DIN EN 60529, only in locked condition with an appropriate counterpart; IPX8 requirements under agreement between manufacturer and user

Electrical data (at T_{amb} 20 °C)

Rated current 5 A (T_{amb} 40 °C, 3-8 poles)
 3 A (T_{amb} 40 °C, 12-14 poles)
 Rated voltage with pollution degree 1:
 300 V (versions 03, 04, 05-1, 06, 07)
 100 V (versions 05, 07-1, 08, 08-1)
 160 V (versions 12, 14)
 with pollution degree 2:
 250 V (versions 03, 04)
 32 V (versions 05, 07-1, 08, 08-1)
 160 V (versions 05-1, 06, 07, 12, 14)
 Rated impulse voltage 1500 V (versions 03, 04, 05-1, 06, 07, 12, 14)
 500 V (versions 05, 07-1, 08, 08-1)
 Material group II (IEC)/1 (UL) (400 ≅ CTI < 600)
 Overvoltage category I
 Insulation resistance > 100 MΩ

Associated products

Counterparts
 ☞ 0321 ☞ 0322 ☞ 0322-1
 ☞ 032200 ☞ 0360 ☞ 036000
 Accessories
 ☞ 0383 ☞ 038399 ☞ 0384

03

0317

Pin configurations, solder side view

 0385

 038899

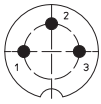

03-a
0317 03

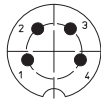

04-a
0317 04

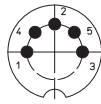

05-b
0317 05

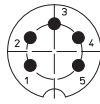

05-a
0317 05-1

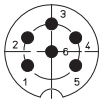

06-a
0317 06

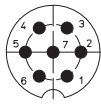

07-a
0317 07

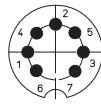

07-b
0317 07-1

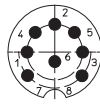

0317 08

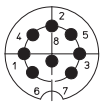

08-a
0317 08-1

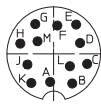

12-a
0317 12

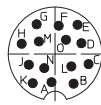

14-a
0317 14

03 0317

Printed circuit board layout, solder side view

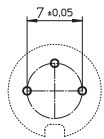

03-a
0317 03

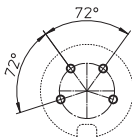

04-a
0317 04

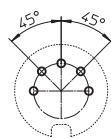

05-b
0317 05

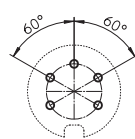

05-a
0317 05-1

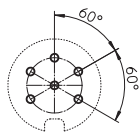

06-a
0317 06

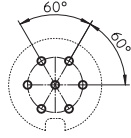

07-a
0317 07

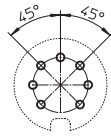

07-b
0317 07-1

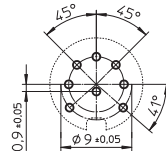

0317 08

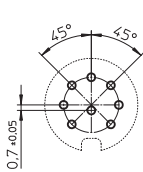

08-a
0317 08-1

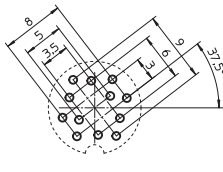

12-a
0317 12

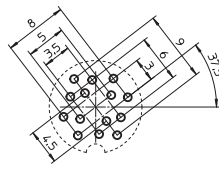

14-a
0317 14

- *a nut enclosed separately
- *b for bore hole of PCB
Ø 1,0 mm (0317 03–0317 08-1)
Ø 0,7 mm (0317 12–0317 14)
- *c mounting direction
- *d contact pin
Ø 1.5 mm (0317 03–0317 08-1)
Ø 1.0 mm (0317 12–0317 14)
- *e O-ring gasket
- *f port in mounting plate
- *g anti-rotation, alternative execution

03

0317

Designation	Pole Number	PU (Pieces)	MDQ (Pieces)	Dimensions A (mm)
0317 03	3	50	100	25.4
0317 04	4	50	100	25.4
0317 05	5	50	100	25.4
0317 05-1	5	50	100	25.4
0317 06	6	50	100	25.4
0317 07	7	50	100	25.4
0317 07-1	7	50	100	25.4
0317 08	8	50	100	25.4
0317 08-1	8	50	100	25.4
0317 12	12	50	100	24.8
0317 14	14	50	100	24.8

Packaging:
in a cardboard box

X-ON Electronics

Largest Supplier of Electrical and Electronic Components

Click to view similar products for [Circular MIL Spec Connector](#) category:

Click to view products by [Lumberg](#) manufacturer:

Other Similar products are found below :

[89075GULPR](#) [0025-262-542](#) [0025-263-3014](#) [0025-264-3014](#) [0031-065-002](#) [0031-071-002](#) [0134-201-1007](#) [0134-202-0800](#) [0134-202-1200](#)
[0134-202-2407](#) [0134-207-1206](#) [0134-207-1800](#) [0134-207-2207](#) [0134-213-0806](#) [0134-213-1007](#) [0134-213-1009](#) [0134-213-1200](#) [0134-213-1208](#) [0134-213-1800](#) [0134-213-2209](#) [0025-258-000](#) [0025-259-542](#) [0031-066-002](#) [0031-068-002](#) [0031-069-002](#) [0031-070-002](#) [0031-072-002](#)
[015-9516-002](#) [020313-0043](#) [020340-0009](#) [020418-0036](#) [020419-0080](#) [020419-0120](#) [020420-0108](#) [60-042022-07P](#) [60-042217-10P](#) [60-042722-19P](#) [0104-201-2402](#) [0114-201-1278](#) [024251-0015](#) [602GB06EG1832SN](#) [602GB06EG24-61SN](#) [0134-201-1207](#) [0134-201-1410](#) [0134-201-1806](#) [0134-201-2006](#) [0134-201-2007](#) [0134-201-2010](#) [0134-201-2200](#) [0134-202-1400](#)