

0911 ANC 101

AS-Interface Junction Branches

AS-Interface branch to connect AS-Interface slaves via a M12 connector with a flat cable system.

Technical Data

Environmental	
Degree of protection	IP 65
Housing material	PA
Nominal current at 40°C	4 A

Note

- insertion of the AS-Interface flat cable (yellow) in cable shaft "LINE1"
- insertion of the additional voltage supply (black flat cable) in cable shaft "LINE 2"

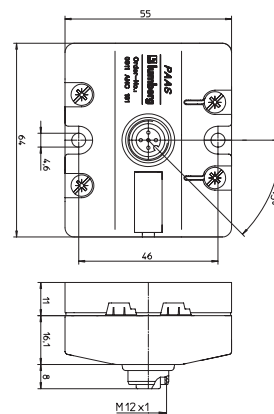
0911 ANC 401



AS-Interface branch to connect two flat cables (opening of an AS-Interface branch or additional voltage supply).

Technical Data

Environmental	
Degree of protection	IP 65
Housing material	PA
Nominal current at 40°C	8 A

Note

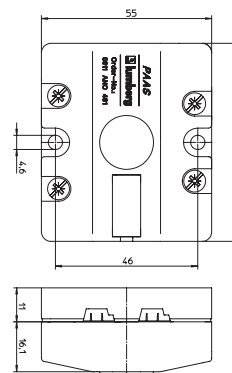
Please be aware that only two wires with the same function may be inserted into this AS-Interface branch. This means that either only the yellow or only the black AS-Interface flat cable may be used.

Pin Assignments
Cable M12 - 5 Poles

1 = AS-Interface +	brown
2 = 0 V AUX	white
3 = AS-Interface -	blue
4 = +24 V AUX	black
5 = earth	green/yellow



1 = AS-Interface +
2 = 0 V AUX
3 = AS-Interface -
4 = +24 V AUX
5 = earth

Part Number

0911 ANC 101

0911 ANC 401



The application of these products in harsh environments should always be checked before use.
 Specifications subject to alteration.

X-ON Electronics

Largest Supplier of Electrical and Electronic Components

Click to view similar products for [Circular Metric Connectors](#) category:

Click to view products by [Lumberg](#) manufacturer:

Other Similar products are found below :

[600X518037X](#) [6STD15PCR99B70A](#) [8R4000A16M020](#) [8R5000A16M005](#) [1200910002](#) [1203580030](#) [1200910008](#) [1200910011](#) [1300140094](#)
[130203-0054](#) [1300140026](#) [1300150099](#) [RF-12S1N8A90DU](#) [1-3637-600-5205](#) [1612618](#) [21036836414](#) [8R4006A16M010](#) [8R5006A18A120](#)
[1604232](#) [1R3006A20M005](#) [RF-12P1N8A80DU](#) [RF-12P1N8A90DU](#) [41-40011](#) [42-01015](#) [4-22279-4](#) [4-22281-1](#) [4-22284-9](#) [43-01088](#) [43-](#)
[01203](#) [41-40013](#) [42-00008](#) [43-00343](#) [43-01032](#) [43-01162](#) [43-10000](#) [600X518050X](#) [SACC-DSI-FS-5P-PG9-L180 SC](#) [8R5006A16M020](#)
[8R5006A16M005](#) [8R4000A16M010](#) [6-22279-3](#) [1605332](#) [N03FA03144](#) [1300140077](#) [43-01338](#) [XS2RD4265](#) [RSC 4/9](#) [XS2R-D426-1](#)
[XS8A-0441](#) [859RD04-103R004](#)