



## PROFIBUS Field Attachable Connectors

### 0976 PFC 101



#### M12 Female (Screw Terminals)

Field attachable connector, M12 female connector with threaded joint, shieldable, assembling with screw terminals 0976 PFC 101: 5 poles, B coding.

– especially suitable for Profibus signal cable 0975 254 000/... M –

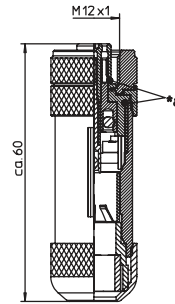

\*a O-Ring

### 0976 PFC 102



#### M12 Female (Spring-Type Terminals)

Field attachable connector, M12 female connector with threaded joint, shieldable, assembling with spring-type terminals 0976 PFC 102: 4 poles, B coding.

– especially suitable for Profibus signal cable 0975 254 000/...M Profibus signals –

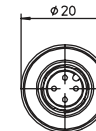
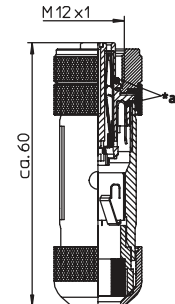

\*a O-Ring

### Pin Assignment

#### M12 - 4 Poles (B-Code)



#### M12 - 5 Poles (B-Code)





Be Certain with Belden

**PROFIBUS Field Attachable Connectors**

0976 PFC 101 | 0976 PFC 102

**Technical Data**

**Environmental**





Degree of protection IP 67 / NEMA 6P  
 Operating temperature range -25°C (-13°F) / +90°C (+194°F)

**Mechanical**

Housing / Molded body GD-ZnAl, pre-coppered and nickel-plated  
 Insert PBT  
 Contact 0976 PFC 101: CuZn, pre-coppered, CuSnZn  
 0976 PFC 102: Stainless steel, silver-plated, gold plated  
 Receptacle shell CuZn, nickel-plated  
 Shield sleeve CuBe, tin-plated  
 O-ring FKM  
 Mode of connection 0976 PFC 101: screw terminals  
 0976 PFC 102: spring-type terminals  
 Connectable conductor 0976 PFC 101: max. 0.75 mm<sup>2</sup>  
 0976 PFC 102: 0.14-0.50 mm<sup>2</sup>, 0.14 mm<sup>2</sup> with terminal pin sleeve

**Electrical**

Contact resistance ≤ 5 mΩ  
 Nominal current at 40°C 4 A  
 Nominal voltage 4 poles 120 V  
 5 poles 60 V  
 0976 PFC 102: 32 V  
 Rated voltage 4 poles 125 V  
 5 poles 63 V  
 Test voltage 4 poles 1.5 kV eff. / 60 s  
 5 poles 1.0 kV eff. / 60 s  
 0976 PFC 102: 0.65 kV eff. / 60 s  
 Insulation resistance > 10<sup>9</sup> Ω  
 Pollution degree 3

Part Number	Pins	Screw Joint for Cable			
0976 PFC 101	5B	Ø 4.0-9.0 mm			
0976 PFC 102	4B	Ø 4.0-9.0 mm			

## X-ON Electronics

Largest Supplier of Electrical and Electronic Components

*Click to view similar products for [Circular Metric Connectors](#) category:*

*Click to view products by [Lumberg](#) manufacturer:*

Other Similar products are found below :

[600X518037X](#) [6STD15PCR99B70A](#) [8R4000A16M020](#) [8R5000A16M005](#) [1200910002](#) [1203580030](#) [1200910008](#) [1200910011](#) [1300140094](#)  
[130203-0054](#) [1300140026](#) [1300150099](#) [RF-12S1N8A90DU](#) [1-3637-600-5205](#) [1612618](#) [21036836414](#) [8R4006A16M010](#) [8R5006A18A120](#)  
[1604232](#) [1R3006A20M005](#) [RF-12P1N8A80DU](#) [RF-12P1N8A90DU](#) [41-40011](#) [42-01015](#) [4-22279-4](#) [4-22281-1](#) [4-22284-9](#) [43-00113](#) [43-](#)  
[01088](#) [43-01203](#) [41-40013](#) [42-00008](#) [43-00343](#) [43-01032](#) [43-01162](#) [43-10000](#) [600X518050X](#) [SACC-DSI-FS-5P-PG9-L180 SC](#)  
[8R5006A16M020](#) [8R5006A16M005](#) [8R4000A16M010](#) [6-22279-3](#) [1605332](#) [N03FA03144](#) [1300140077](#) [43-01338](#) [XS2RD4265](#) [XS2R-](#)  
[D426-1](#) [XS8A-0441](#) [859RD04-103R004](#)