

M12-Receptacle Connectors In Accordance With IEC 61076-2-101

RSFM.../20/0.5 M | RKF.../20/0.5 M



Male, 3-, 4-, 5- and 8-Pole

M12 Receptacle connector, combined FIXCON/ M12 male connector for front mounting, assembled stranded wire, solder contacts potted with epoxy, chassis side thread M20 x 1.5 (panel nut RSKFM 20).

RSFM.../20/0.5 M

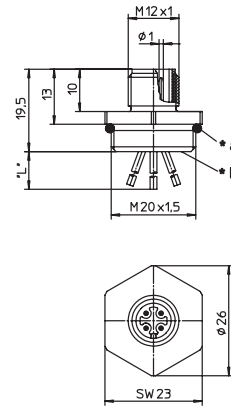

*a O-ring enclosed separately
 *b solder contacts potted with epoxy
 *L*0.5 m



M12 Female, 3-, 4-, and 5-Pole

M12 Receptacle connector, combined FIXCON/ M12 female connector for front mounting, assembled stranded wire, solder contacts potted with epoxy, chassis side thread M20 x 1.5 (panel nut RSKFM 20).

RKF.../20/0.5 M

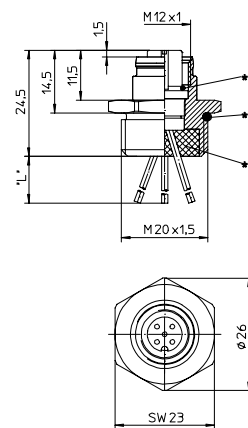

Pin Assignments

Face Views / M12, Male / Female

3 pole

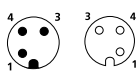

1 = brown
 3 = blue
 4 = black

4 pole

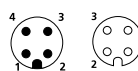

1 = brown
 2 = white
 3 = blue
 4 = black

5 pole

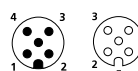

1 = brown
 2 = white
 3 = blue
 4 = black
 5 = green/yellow

8 pole

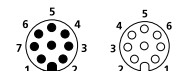

1 = white
 2 = brown
 3 = green
 4 = yellow
 5 = grey
 6 = pink
 7 = blue
 8 = red



M12-Receptacle Connectors In Accordance With IEC 61076-2-101

RSFM.../20/0.5 M | RKFM.../20/0.5 M

Technical Data

Environmental









Degree of protection IP 67 / NEMA 6P
 Operating temperature range -25°C (-13°F) / +80°C (+176°F)

Mechanical

Housing CuZn
 Surface housing Cu/Ni
 Contact bearer PA 6/66
 Contact CuZn
 Contact surface Cu/Au
 O-ring Neoprene

Electrical

Operating voltage 240 V, 3 and 4 poles
 60 V, 5 poles
 30 V, 8 poles
 Rated voltage 250 V, 3 and 4 poles
 63 V, 5 poles
 36 V, 8 poles
 Rated current 4 A, 3 - 5 poles
 1,5 A, 8 poles
 Rated impulse voltage 2,0 kV, 3 and 4 poles
 1,5 kV, 5 and 8 poles
 Pollution degree 3
 Insulation resistance > 10⁹ Ω
 Contact resistance ≤ 5 mΩ

Part Number	Pins	Lead (mm ²)	Characteristics
RSFM 3/20/0.5 M	3	0.34	 
RSFM 4/20/0.5 M	4	0.34	 
RSFM 5/20/0.5 M RKFM 5/20/0.5 M	5	4 x 0.34 / 1 x 0.50	 
RSFM 8/20/0.5 M	3	0.34	 

X-ON Electronics

Largest Supplier of Electrical and Electronic Components

Click to view similar products for [Sensor Cables / Actuator Cables](#) category:

Click to view products by [Lumberg](#) manufacturer:

Other Similar products are found below :

[60963](#) [60964](#) [M83513/19-F01CP](#) [703000D02F2002](#) [703000D02F300](#) [703001D02F0602](#) [703001D02F300](#) [704000D02F120](#) [773032K02F030](#)
[802027107404-1](#) [802027213811-1](#) [804001A09M150](#) [805001A09M0502](#) [84914-0235](#) [84914-0237](#) [885030A09M020](#) [1200651332](#)
[1200651713](#) [1200660844](#) [1200660845](#) [1200661173](#) [1200680071](#) [1200720053](#) [1200720081](#) [1200720099](#) [1200720217](#) [1200800231](#)
[1200860125](#) [1200870123](#) [1200980102](#) [1200650267](#) [1200650298](#) [1200660183](#) [1200660782](#) [1200660849](#) [1200661295](#) [1200661297](#)
[1200661342](#) [1200661343](#) [1200670080](#) [1200670220](#) [1200680331](#) [1200720252](#) [1200730184](#) [1200860344](#) [1200870359](#) [1200870643](#)
[1200980008](#) [1200980031](#) [1210502211](#)