

| | | | | |
|--------------------|--------------------------------------------|---------------|------------|-------------|
| PART NUMBER | | OED-ST-1556SN | REV | D |
| REV | E.C.N. NUMBER AND REVISION COMMENTS | | | DATE |
| A | E.C.N. #10330. | | | 04.11.97 |
| B | E.C.N. #10BRDR. | | | 12.22.97 |
| C | E.C.N. #10BRDR. & REDRAWN IN 3D. | | | 05.30.03 |
| D | ECN-Lumex201700075 | | | 09.21.17 |

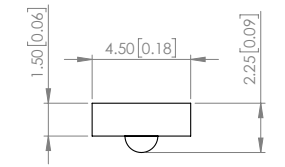

POLARITY

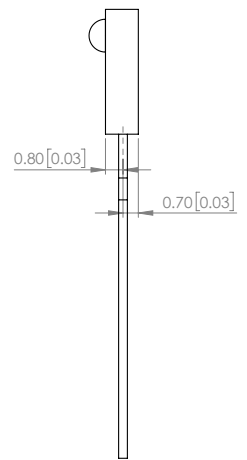
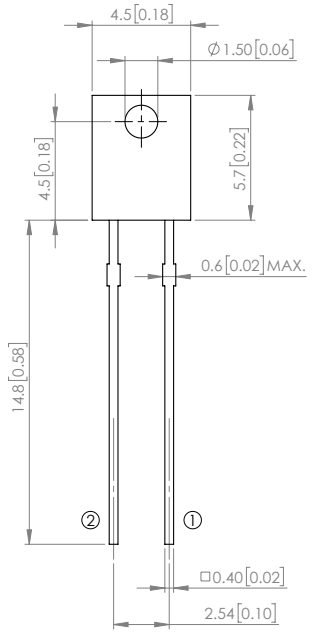
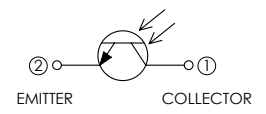

ELECTRO-OPTICAL CHARACTERISTIC TA=25°C

| PARAMETER | SYMBOL | MIN | TYP | MAX | UNITS | TEST COND |
|--------------------------------|---------------|-----|-----|-----|-------|-----------------------------------|
| C-E BREAKDOWN VOLTAGE | BV_{CEO} | 30 | - | - | V | $I_C=100\mu A$ $E_e=0mW/cm^2$ |
| E-C BREAKDOWN VOLTAGE | BV_{ECO} | 5 | - | - | V | $I_E=100\mu A$ $E_e=0mW/cm^2$ |
| C-E SATURATION VOLTAGE | $V_{CE(sat)}$ | - | - | 0.4 | V | $I_C=2mA$ $E_e=1mW/cm^2$ |
| SPECTRAL SENSITIVITY | λ_p | - | 940 | - | nm | - |
| COLLECTOR DARK CURRENT | I_{CEO} | - | - | 100 | nA | $V_{CE}=20V$ $E_e=0mW/cm^2$ |
| COLLECTOR LIGHT CURRENT | I_C | 0.8 | - | 5.0 | mA | $V_{CE}=5V$ $E_e=0.555mW/cm^2$ |
| EPOXY LENS FINISH | WATER CLEAR | | | | | |

ABSOLUTE MAXIMUM RATINGS TA=25°C

| PARAMETER | MAX | UNITS |
|-------------------------------|------------------|-------|
| C-E VOLTAGE | 30 | V |
| E-C VOLTAGE | 5 | V |
| COLLECTOR CURRENT | 20 | mA |
| POWER DISSIPATION | 75 | mW |
| OPERATING TEMPERATURE | -25 TO +85 | °C |
| STORAGE TEMPERATURE | -40 TO +85 | °C |
| SOLDERING TEMPERATURE* | 3 SEC. MAX @ 260 | °C |

* 2.0mm FROM BODY.

NOTE:

1. RoHS COMPLIANT.
2. COMPLIANCE WITH EU REACH.
3. COMPLIANCE Halogen FREE.
(Br < 900ppm, Cl < 900ppm, Br+ Cl < 1500ppm)

*UNLESS OTHERWISE SPECIFIED TOLERANCES PER DECIMAL PRECISION ARE: X=±1 (±0.039), X.X=±0.5 (±0.020), X.XX=±0.25 (±0.010), X.XXX=±0.127 (±0.005). LEAD SIZE=±0.05 (±0.002), LEAD LENGTH=±0.75 (±0.030), MIN= ^{±0.001}DECIMAL PRECISION, MAX.= ^{±0.001}DECIMAL PRECISION

LUMEX
Creating LED and LCD Solutions Together™

425 N. GARY AVE.
CAROL STREAM, IL 60188
PHONE : 800-278-5666
FAX : 630-315-2150
WEB : WWW.LUMEX.COM

4.5(L)*5.7(W)*2.25(H)mm, T-1.5mm RIGHT ANGLE DOME LENS, PHOTO TRANSISTOR, WATER CLEAR LENS.

THE SPECIFICATIONS MAY CHANGE AT ANY TIME WITHOUT NOTICE DUE TO NEW MATERIALS OR PRODUCT IMPROVEMENT.

CONFIDENTIAL INFORMATION
THE INFORMATION CONTAINED IN THIS DOCUMENT IS THE PROPERTY OF LUMEX INC. EXCEPT AS SPECIFICALLY AUTHORIZED IN WRITING BY LUMEX INC., THE HOLDER OF THIS DOCUMENT SHALL KEEP ALL INFORMATION CONTAINED HEREIN CONFIDENTIAL AND SHALL PROTECT SAME IN WHOLE OR IN PART FROM DISCLOSURE AND DISSEMINATION TO ALL THIRD PARTIES.

| | |
|-------------------|-----------------|
| DATE : 2017.09.21 | DRAWN BY : C.C. |
| PAGE : 1 OF 1 | CHKD BY : G.Y. |
| SCALE : NTF | APRVD BY : E.C. |
| UNIT : mm [INCH] | Ⓢ |

X-ON Electronics

Largest Supplier of Electrical and Electronic Components

Click to view similar products for [Phototransistors](#) category:

Click to view products by [Lumex](#) manufacturer:

Other Similar products are found below :

[LTR-5576D](#) [PT17-21B/L41/TR8](#) [PT908-7B-F](#) [QSD123A4R0](#) [ASDL-6620-C22](#) [OED-ST-8LR2](#) [OED-STR44B90-TR](#) [SD5410-109](#) [PT26-21C/CT](#) [PT15-21B-TR8](#) [PT-IC-AC-3528-520](#) [PT-IC-BC-3528-550](#) [MHT153PTBT](#) [MHS153PTBT](#) [PT5529B/L2/H2-F](#) [PT91-21C/TR10](#) [BP103-3/4](#) [BPX 38-3](#) [BPY 62](#) [KPS-3227SP1C](#) [L-53P3BT](#) [L-53P3C](#) [L-93DP3BT](#) [L-93DP3C](#) [LL-503PTC2E-1AD](#) [LL-S150PTC-1A](#) [LL-S150PTD-1A](#) [SFH 320](#) [SFH 320-3](#) [SFH 320 FA](#) [OP508FA](#) [TEMT1030](#) [LTR-301](#) [PGM5516-MP](#) [PGM5526-MP](#) [PGM5549](#) [PGM5637D](#) [VTT7125H](#) [VEMT4700F-GS08](#) [PT19-21B/L41/TR8](#) [KP-2012P3C](#) [TEKT5400S](#) [SD1410-128L](#) [SFH 313 FA-3/4](#) [SFH 313 FA-2/3](#) [SFH 320-4-Z](#) [SFH 309 FA-5/6](#) [PT4800FE000F](#) [SFH 309-5/6](#) [SFH 3410-1/2-Z](#)