

<b>PART NUMBER</b>		SML-LX3636VSC-TR	<b>REV</b>	A
<b>REV</b>	<b>E.C.N. NUMBER AND REVISION COMMENTS</b>			<b>DATE</b>
A	ECN-Lumex201900065			04.24.19

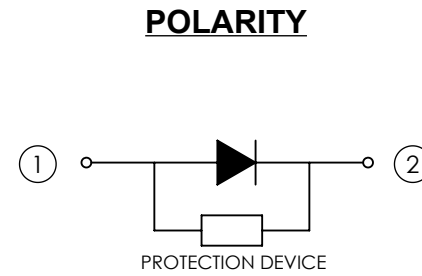

**RECOMMENDED SOLDER PAD LAYOUT**

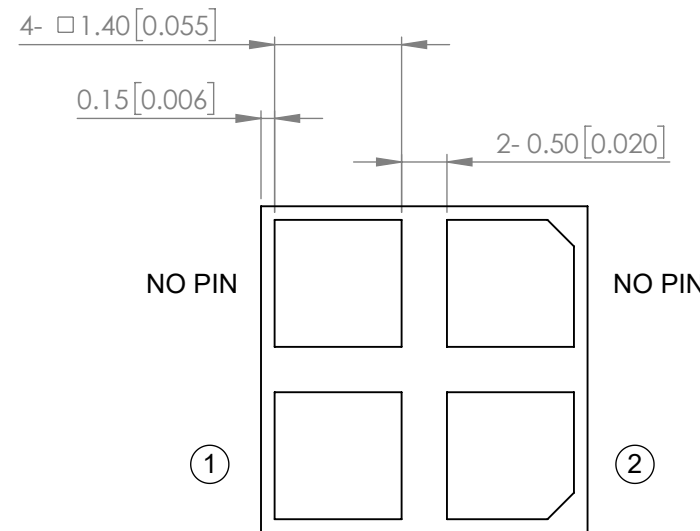
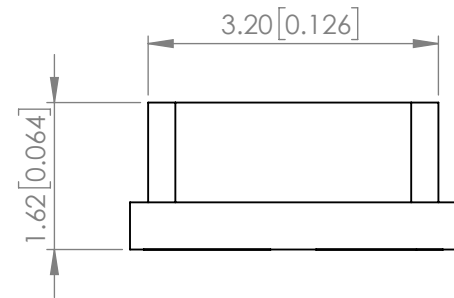
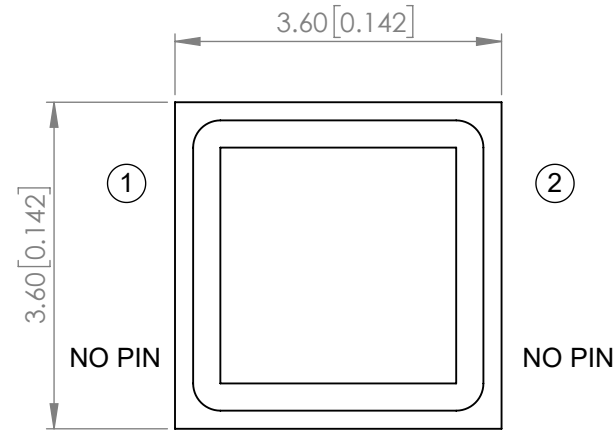
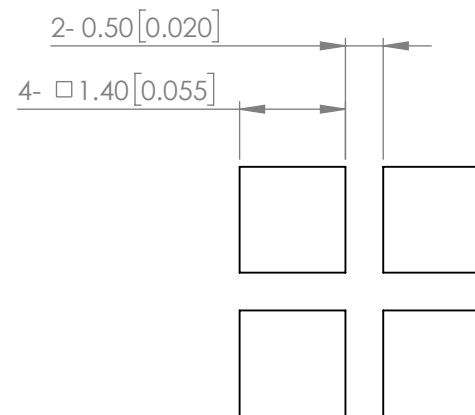

**ELECTRO-OPTICAL CHARACTERISTIC TA=25°C**

PARAMETER	MIN	TYP	MAX	UNITS	TEST COND
PEAK WAVELENGTH	265	-	285	nm	If=100mA
FORWARD VOLTAGE	-	6	8	Vf	If=100mA
RADIANT FLUX	-	12	-	mW	If=100mA
RADIANT IRRADIANCE	-	3.5	-	mW/cm <sup>2</sup>	-
VIEWING ANGLE	-	140	-	2x theta1/2	-
LED JUNCTION TEMPERATURE	-	60	80	°C	-
EMITTED COLOR	UV				
LENS MATERIAL	GLASS				

NOTE:  
1. FORWARD VOLTAGE MEASUREMENT ALLOWANCE IS ± 0.2V.  
2. RADIANT FLUX MEASUREMENT ALLOWANCE IS ± 10%.  
3. IRRADIANCE TESTED AT A DISTANCE 10mm FROM AL REFLECTOR.  
4. WAVELENGTH MEASUREMENT ALLOWANCE IS ± 3nm.

**ABSOLUTE MAXIMUM RATINGS TA=25°C**

PARAMETER	MAX	UNITS
PEAK FORWARD CURRENT	150	mA
FORWARD CURRENT	100	mA
POWER DISSIPATION	0.7	W
THERMAL RESISTANCE JUNCTION-CASE	15	°C/W
STORAGE TEMPERATURE	-40~+100	°C
OPERATING TEMPERATURE	-40~+60	°C
SOLDERING TEMPERATURE	5 SEC. MAX @ 230	°C

\*t<10us

\*UNLESS OTHERWISE SPECIFIED TOLERANCES PER DECIMAL PRECISION ARE: X=±1 (±0.039), X.X=±0.5 (±0.020), X.XX=±0.25 (±0.010), X.XXX=±0.127 (±0.005). LEAD SIZE=±0.05 (±0.002), LEAD LENGTH=±0.75 (±0.030). MIN= <sup>+DECIMAL PRECISION</sup> / <sub>-0.00</sub> MAX= <sup>+0.00</sup> / <sub>-DECIMAL PRECISION</sub>

**PROFILE**

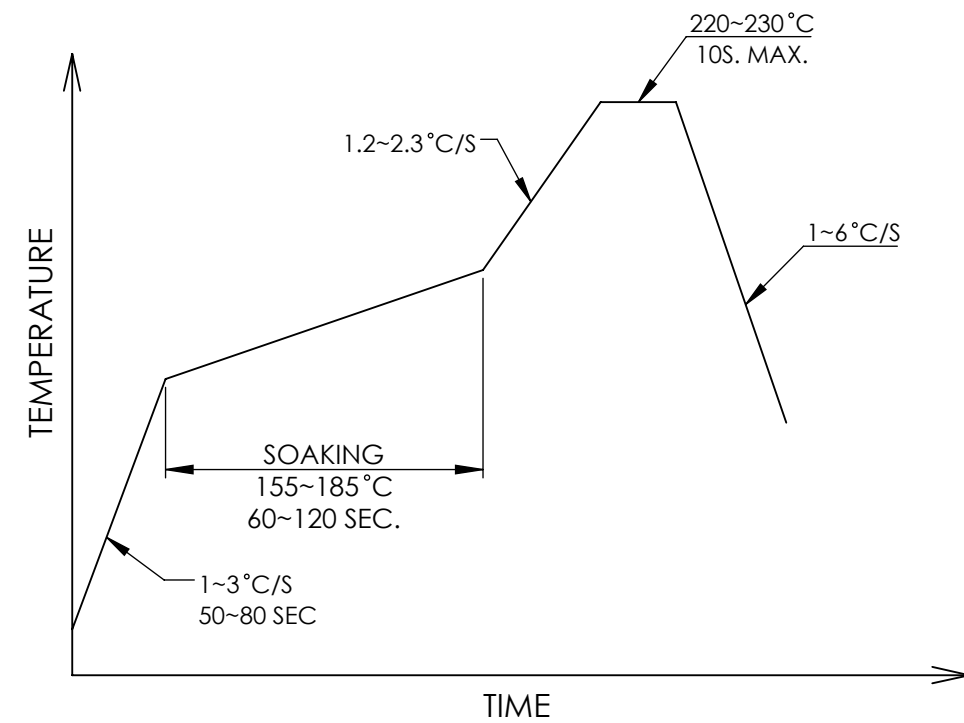

**CARRIER TAPE DIMENSION**

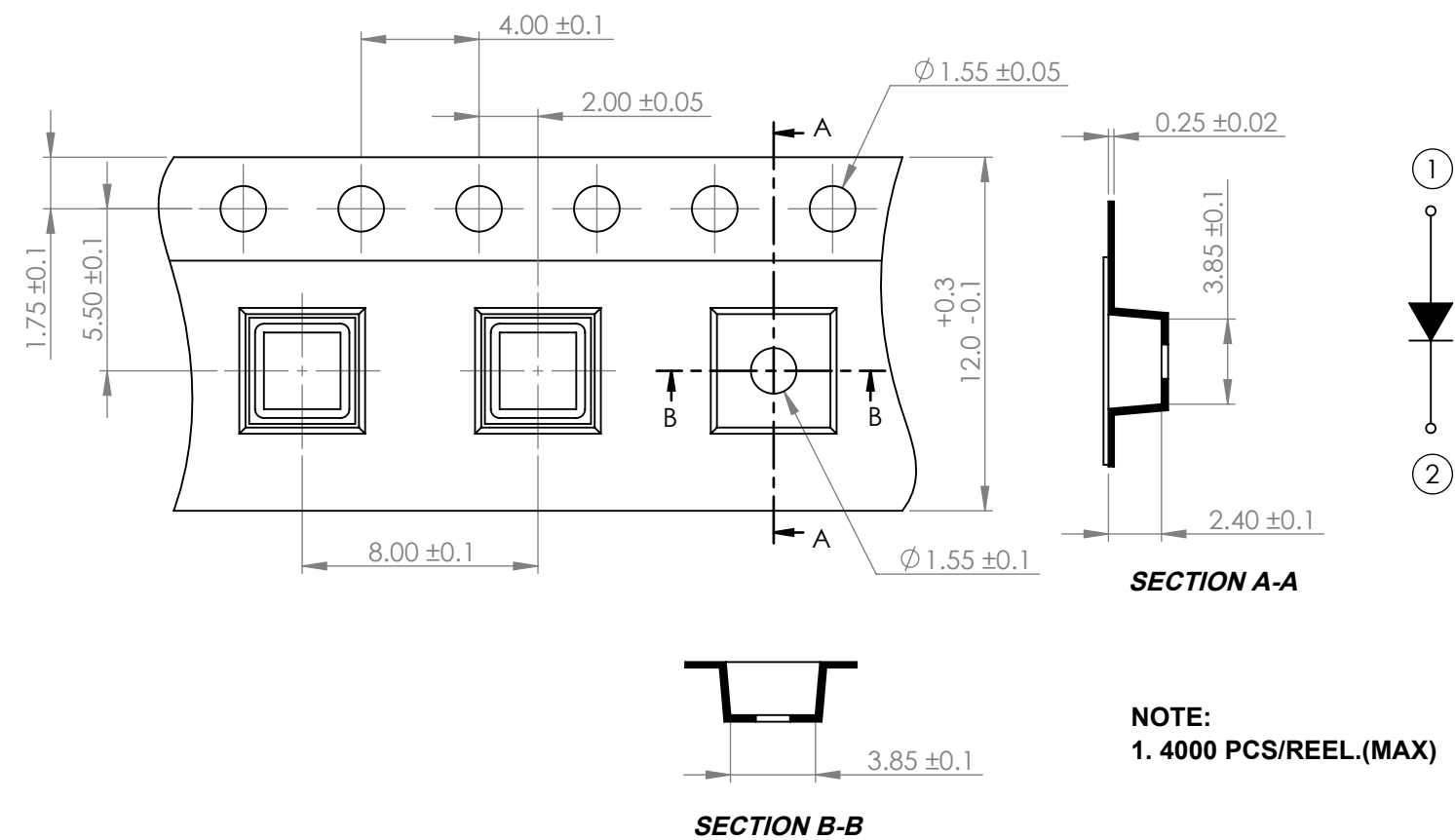

**SECTION A-A**

**SECTION B-B**

**NOTE:**  
1. 4000 PCS/REEL.(MAX)

\*UNLESS OTHERWISE SPECIFIED TOLERANCES PER DECIMAL PRECISION ARE: X=±1 (±0.039), X.X=±0.5 (±0.020), X.XX=±0.25 (±0.010), X.XXX=±0.127 (±0.005). LEAD SIZE=±0.05 (±0.002), LEAD LENGTH=±0.75 (±0.030). MIN= <sup>+DECIMAL PRECISION</sup>/<sub>-0.00</sub> MAX= <sup>+0.00</sup>/<sub>-DECIMAL PRECISION</sub>

**LUMEX**  
Creating LED and LCD Solutions Together™

425 N. GARY AVE.  
CAROL STREAM, IL 60188  
PHONE : 800-278-5666  
FAX : 630-315-2150  
WEB : WWW.LUMEX.COM

3.6(L)\*3.6(W)\*1.62(H)mm, SURFACE MOUNT TOP VIEW, SINGLE CHIP UVC LED, WATER CLEAR LENS, TAPE & REEL.

**\*\*THE SPECIFICATIONS MAY CHANGE AT ANY TIME WITHOUT NOTICE.\*\***

**CONFIDENTIAL INFORMATION**  
THE INFORMATION CONTAINED IN THIS DOCUMENT IS THE PROPERTY OF LUMEX INC. EXCEPT AS SPECIFICALLY AUTHORIZED IN WRITING BY LUMEX INC., THE HOLDER OF THIS DOCUMENT SHALL KEEP ALL INFORMATION CONTAINED HEREIN CONFIDENTIAL AND SHALL PROTECT SAME IN WHOLE OR IN PART FROM DISCLOSURE AND DISSEMINATION TO ALL THIRD PARTIES.

DATE : 2019.04.24	DRAWN BY : C.S.
PAGE : 2 OF 2	CHKD BY : E.C.
SCALE : NTF	APRVD BY : G.Y.
UNIT : mm [INCH]	(Pb)

## X-ON Electronics

Largest Supplier of Electrical and Electronic Components

*Click to view similar products for [High Power LEDs - Single Colour](#) category:*

*Click to view products by [Lumex](#) manufacturer:*

Other Similar products are found below :

[XQAAPA-00-0000-000000Y01](#) [LZ1-10A105](#) [LZ1-10UA00](#) [LTPL-C034UVH365](#) [LTPL-C034UVH385](#) [LTPL-C034UVH405](#) [SML-LX3636VSC-TR](#) [L1C1-DRD1000000000](#) [L1SP-FRD0002000000](#) [LXML-PD01-0050](#) [LXML-PH01-0060](#) [LXZ1-PD02](#) [LXZ1-PH02](#) [LXZ1-PL03](#) [SST-10-R-B90-G630](#) [SST-10-UV-A130-G395-00](#) [KY DMLS31.FY-Z8KF6-5F-8E8G](#) [150353BS74500](#) [150353GS74500](#) [150353RS74500](#) [150353YS74500](#) [XPGDRY-L1-0000-00601](#)