

| DATE | E.C.N. NUMBER AND REVISION COMMENTS | REV. |
|----------|-------------------------------------|------|
| 11.19.13 | E.C.N. #11887. | A |

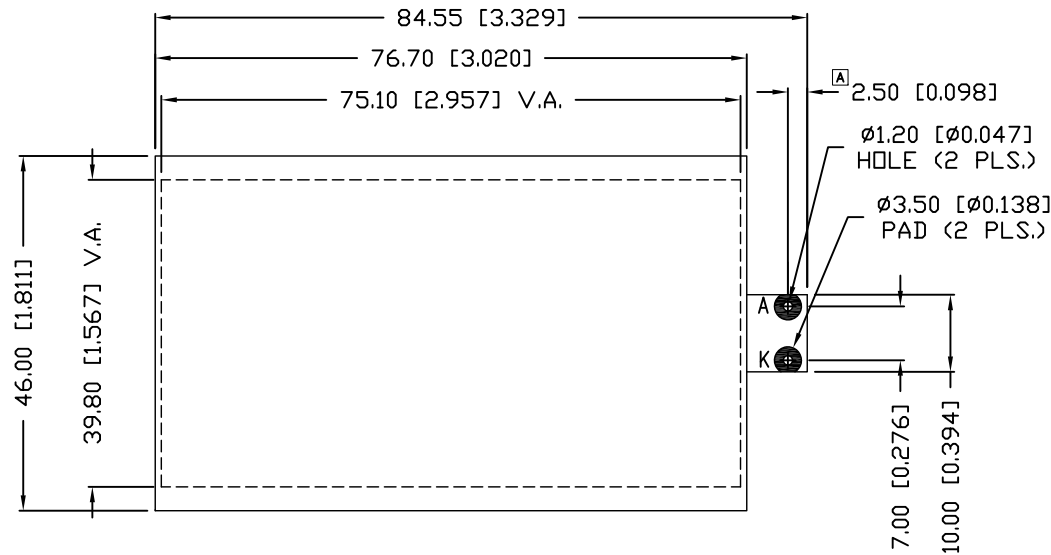

ELECTRO-OPTICAL CHARACTERISTICS $T_A=25^\circ\text{C}$ PER MODULE $I_f=360\text{mA}$

| PARAMETER | MIN | TYP | MAX | UNITS | TEST COND |
|--------------------|-------|-----|-----|------------------------|--------------------|
| PEAK WAVELENGTH | | 565 | | nm | |
| FORWARD VOLTAGE | | 4.2 | 4.5 | V_f | |
| REVERSE VOLTAGE | 8 | | | V_r | $I_r=3.6\text{mA}$ |
| LUMINOUS INTENSITY | | 265 | | cd/m^2 | $I_f=360\text{mA}$ |
| EMITTED COLOR: | GREEN | | | | |
| REFLECTOR FINISH: | WHITE | | | | |

LIMITS OF SAFE OPERATION AT 25°C PER MODULE

| PARAMETER | MAX | UNITS |
|--|------------|----------------------------|
| STEADY CURRENT | 576 | mA |
| POWER DISSIPATION | 2.59 | W |
| DERATE FROM 25°C PER DIE | -1.2 | $\text{mW}/^\circ\text{C}$ |
| OPERATING TEMP. | -20 TO +70 | $^\circ\text{C}$ |
| STORAGE TEMP. | -30 TO +80 | $^\circ\text{C}$ |
| SOLDERING TEMP. | +260 | $^\circ\text{C}$ |
| 2.0mm FROM BODY | | 3 SEC. MAX |

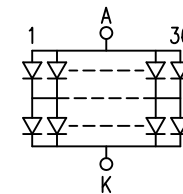
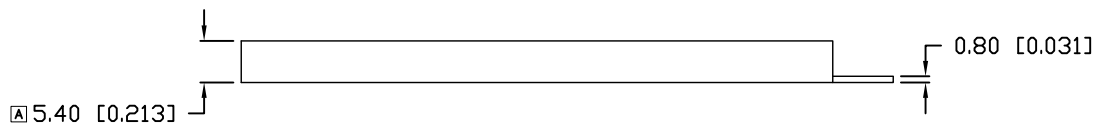

2 CHIPS IN SERIES
36 PARALLEL BRANCHES

*UNLESS OTHERWISE SPECIFIED TOLERANCES PER DECIMAL PRECISION ARE: X=±1 (±0.039), X.X=±0.5 (±0.020), X.XX=±0.25 (±0.010), X.XXX=±0.127 (±0.005). LEAD SIZE=±0.05 (±0.002), LEAD LENGTH=±0.75 (±0.030). MIN.=^{+DECIMAL PRECISION}-0.00, MAX.=^{+0.00}-DECIMAL PRECISION

| | |
|-----------|------------------------------|
| REV. A | PART NUMBER SSB-COB7540GW |
|-----------|------------------------------|

CONFIDENTIAL INFORMATION
THE INFORMATION CONTAINED IN THIS DOCUMENT IS THE PROPERTY OF LUMEX INC. EXCEPT AS SPECIFICALLY AUTHORIZED IN WRITING BY LUMEX INC., THE HOLDER OF THIS DOCUMENT SHALL KEEP ALL INFORMATION CONTAINED HEREIN CONFIDENTIAL AND SHALL PROTECT SAME IN WHOLE OR IN PART FROM DISCLOSURE AND DISSEMINATION TO ALL THIRD PARTIES.



290 E. HELEN ROAD
PALATINE, IL 60067-6976
PHONE: +1.847.359.2790
US WEB: www.lumex.com
TW WEB: www.lumex.com.tw

75mm x 40mm VIEW AREA, CHIP ON BOARD LED BACKLIGHT,
565nm GREEN, 72 CHIPS, 4.2V, 360mA.

RELIABILITY NOTE
OUR MANY YEARS OF EXPERIENCE DATA ACCUMULATION INDICATE THAT SOLDER HEAT IS A MAJOR CAUSE OF EARLY AND FUTURE FAILURE. PLEASE PAY ATTENTION TO YOUR SOLDERING PROCESS.

| | | | |
|-----------------|-------------|--------------|---|
| DRAWN BY: BC | CHECKED BY: | APPROVED BY: | DATE: 5.24.04 PAGE: 1 OF 1 SCALE: N/A |
|-----------------|-------------|--------------|---|

X-ON Electronics

Largest Supplier of Electrical and Electronic Components

Click to view similar products for [LED Backlighting](#) category:

Click to view products by [Lumex](#) manufacturer:

Other Similar products are found below :

[SSB-COB7540GW](#) [SSB-DL6528SRW](#) [SSB-CEL8040UWW](#) [8718696543603](#) [8718696711033](#) [0025 INT NATURAL BLUE](#) [0100 INT CLASSIC GLACIER WHITE](#) [0100 INT EXTREME ORANGE](#) [0100 INT NATURAL BLUE](#) [0200 INT EXTREME BLUE GREEN](#) [30531](#) [30565](#) [30590](#) [4052899326453](#) [44865WFL](#) [44892WFL](#) [JDR20W38 E14](#) [44870WFL](#) [MR16 60ST 20W](#) [MR16 60ST 50W](#) [64695 ECO](#) [64701](#) [ECO](#) [64760](#) [44890WFL](#) [SL2CD](#) [SKU 165](#) [SKU 167](#) [SKU 193](#) [SKU 194](#) [SKU 203](#) [4052899973428](#) [8718696537015](#) [8718696728352](#) [8718291787051](#) [8727900964073](#) [8727900964271](#) [8727900964295](#) [8727900964479](#) [8727900964516](#) [8727900964875](#) [DSD 1000](#) [DSD 2000](#) [EA LED40X33-ERW](#) [EB8004](#) [EB8005](#) [EB8006](#) [EB8007](#) [EB8010](#) [EB8011](#) [EB8012](#)