

ULR Series

+105 °C, Higher Ripple Current, Lower ESR than ULG

• Features

- Higher Ripple Current, Lower ESR than ULG
- Wide Temperature Range
- RoHS Compliant

• Applications

- Suitable for DC-DC Converters, Voltage Regulators, Decoupling Applications for Computer Motherboards, etc.

• Specifications



Item	Performance Characteristics				
Operating Temperature Range	-55 to +105°C				
Rated Working Voltage Range	2.5VDC to 35VDC				
Surge Voltage, SV	SV=WVx1.15VDC (Normal temperature)				
Nominal Capacitance Range	22 to 2700μF (120Hz, +20°C)				
Capacitance Tolerance	±20% (120Hz, +20°C)				
tan δ	0.10 (120Hz, +20°C)				
Leakage Current, Lc	I ≤ 0.2CV or 500 (μA) whichever is greater measured, after 2 minutes application of rated working voltage at +20°C				
Temperature Characteristics, Impedance Ratio	At -55°C 100kHz (Low temperature)			Z/Z20°C ≤ 1.25	
	At +105°C 100kHz (High temperature)			Z/Z20°C ≤ 1.25	
Frequency Coefficient for Allowable Ripple Current	Frequency	120Hz ≤ f < 1kHz	1kHz ≤ f < 10kHz	10kHz ≤ f < 100kHz	100kHz ≤ f < 500kHz
	Coefficient	0.05	0.30	0.70	1.00
Endurance	Test conditions +105°C, 2,000 hours Rated voltage applied	ΔC/C	Within ±20% of the initial measured value		
		tan δ	≤ 150% of the initial specified value		
		ESR	≤ 150% of the initial specified value		
		Lc	≤ The initial specified value		
Damp Heat Test (Steady State)	Test conditions +60°C, 90% to 95% RH 1,000 hours No applied voltage	ΔC/C	Within ±20% of the initial measured value		
		tan δ	≤ 150% of the initial specified value		
		ESR	≤ 150% of the initial specified value		
		Lc	≤ The initial specified value		
Surge Voltage Test	At normal temperature, charge at surge voltage for 30 sec. and discharge via a 1kΩ protective resistor for 330 sec. Repeat for 1,000 cycles.	ΔC/C	Within ±20% of the initial measured value		
		tan δ	≤ 150% of the initial specified value		
		ESR	≤ 150% of the initial specified value		
		Lc	≤ The initial specified value		
Others	JIS-C-5101-4				

• Dimensions

When L < 16mm, α = +1.0; L ≥ 16mm, α = +1.5

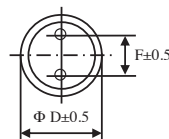
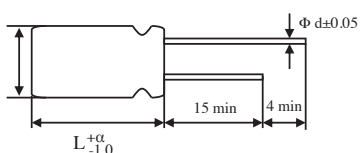

When L < 16mm, α = +1.0; L ≥ 16mm, α = +1.5

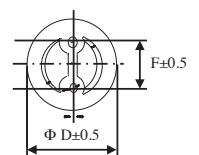
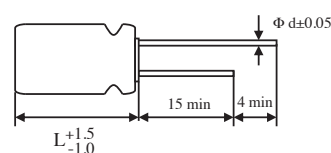

ULR Series

+105°C, Higher Ripple Current, Lower ESR than ULG

Size List

New item | RV: Rated Voltage

RV μF	Code	2.5 (0E)	4 (0G)	6.3 (0J)	6.8 (06)	7 (0S)	7.5 (07)	10 (1A)	12 (1O)	14 (14)	16 (1C)	20 (1D)	25 (1E)	35 (1V)
22	226							E08			E06		E08	
33	336							E08				E08	F08	D09
47	476							E08			E08	F08	F08	
100	107			D06, E55			D07				D07, D09, E06, E07, E08, E11	F1A	F1A	E09, F1A, G12, G1B
150	157			C65		D06		E11				G1B		
180	187							E08			X08, X09, E07, F1A			
220	227	E06		D07, X07, X08, E05, E06, E08			D07	D11, E06, E07, E08			X09, E08, E11, F08, F1A		F1A	G1B
270	277		E08	D07, E06, E08				E08, F08, F1A			X09, E11, F08, F1A			
330	337	E08		D08, D09, X08, E55, E06, E08, F08		D09	D09, X09, E08	E08, F08, F1A	D09		E09, E1K, E11, F07, F08, F1A, G09, G1B		F1A, G1B	
390	397	D07, E06		D08, D09, E08, F08			D08, D09	F08, F1A						
470	477	D09		D95, D11, X10, E06, E61, E07, E08, E09, F08, F1A	D09		E65, E07, E08, E09	E85, E11, F08, F1A, G1B	X10		E11, F08, F1A, G1B			
500	507				E61		D85, D09, X09							
560	567	D08, D09, E06, E08, F08	E08, F08, F1A	X08, E07, E08, F08			E08	F08, F1A	E09	E10			F16	
680	687	F65, F08	F08, F1A	D11, X09, E08, F08, F1A, G1B			E85, F08	E11, F1A, G1B	E11	E13	F1A, G1B		F16	
820	827	E08, F07, F08, F1A	F08, F1A	X10, E75, E85, E95, E10, E11, F07, F08, F1A, G1B		E10, F08	E09, E11	F1A			F1A, G1B			
1000	108	F08, F09, F1A	F08, G1B	E10, E1K, F08, F1A, G1B	E11		E11	F1A, G1B			F16, G1B		G16	
1200	128	F08	F08, F1A, G1B	E11, E13, F08, F1A			E13, F1A	G1B						
1500	158	F1A, G1B		F1A, G10, G1B			F1A	G1B						
1800	188			G1B										
2200	228			G1B										
2500	258			F16										
2700	278	G1B	G1B											

ULR Series

+105 °C, Higher Ripple Current, Lower ESR than ULG

(Unit: mm)

Size Code	C65	D06	D07	D08	D85	D09	D95	D11	X07	X08	X09	X10	E05
ΦDxL	4 x 6.5	5 x 6	5 x 7	5 x 8	5 x 8.5	5 x 9	5 x 9.5	5 x 11	5.5 x 7	5.5 x 8	5.5 x 9	5.5 x 10	6.3 x 5
F±0.5	2.0	2.0	2.0	2.0	2.0	2.0	2.0	2.0	2.5	2.5	2.5	2.5	2.5
Φd	0.45	0.5	0.5	0.6	0.6	0.6	0.6	0.6	0.5	0.5	0.5	0.5	0.45
α	1.0	1.0	1.0	1.0	1.0	1.0	1.0	1.5	1.0	1.0	1.0	1.0	1.0

Size Code	E55	E06	E61	E65	E07	E75	E08	E85	E09	E95	E10	E1K	E11
ΦDxL	6.3 x 5.5	6.3 x 6	6.3 x 6.1	6.3 x 6.5	6.3 x 7	6.3 x 7.5	6.3 x 8	6.3 x 8.5	6.3 x 9	6.3 x 9.5	6.3 x 10	6.3 x 10.5	6.3 x 11
F±0.5	2.5	2.5	2.5	2.5	2.5	2.5	2.5	2.5	2.5	2.5	2.5	2.5	2.5
Φd	0.45	0.45	0.45	0.5	0.5	0.6	0.6	0.6	0.6	0.6	0.6	0.6	0.6
α	1.0	1.0	1.0	1.0	1.0	1.0	1.0	1.0	1.0	1.0	1.0	1.0	1.5

Size Code	E13	F65	F07	F08	F09	F1A	F16	G09	G10	G12	G1B	G16
ΦDxL	6.3 x 13	8 x 6.5	8 x 7	8 x 8	8 x 9	8 x 11.5	8 x 16	10 x 9	10 x 10	10 x 12	10 x 12.5	10 x 16
F±0.5	2.5	3.5	3.5	3.5	3.5	3.5	3.5	5.0	5.0	5.0	5.0	5.0
Φd	0.6	0.6	0.6	0.6	0.6	0.6	0.6	0.6	0.6	0.6	0.6	0.6
α	1.5	1.0	1.0	1.0	1.0	1.0	1.5	1.5	1.5	1.5	1.5	1.5

ULR Series

X-CON[®]

Conductive Polymer
Aluminum Solid Capacitors

+105 °C, Higher Ripple Current, Lower ESR than ULG

Characteristics List

Rated Vol. (V)	Rated Cap. (μF)	Case Size ΦD x L (mm)	Size Code	Part Number	ESR (mΩ, max/ 20°C, 100kHz)	Rated Ripple (mArms/ 105°C, 100kHz)	DF (%max)	Leakage Current (μA/2 mins)
2.5	220	6.3 x 6	E06	ULR227M0EE06	15	3400	10	500
2.5	330	6.3 x 8	E08	ULR337M0EE08	7	4200	10	500
2.5	390	5 x 7	D07	ULR397M0ED07	11	3050	10	500
2.5	390	6.3 x 6	E06	ULR397M0EE06	15	3400	10	500
2.5	470	5 x 9	D09	ULR477M0ED09	7	4180	10	500
2.5	560	5 x 8	D08	ULR567M0ED08	7	4180	10	500
2.5	560	5 x 9	D09	ULR567M0ED09	7	4180	10	500
2.5	560	6.3 x 6	E06	ULR567M0EE06	15	3400	10	500
2.5	560	6.3 x 8	E08	ULR567M0EE08	7	4000	10	500
2.5	560	8 x 8	F08	ULR567M0EF08	7	6100	10	500
2.5	680	8 x 6.5	F65	ULR687M0EF65	8	4900	10	500
2.5	680	8 x 8	F08	ULR687M0EF08	7	6100	10	500
2.5	820	6.3 x 8	E08	ULR827M0EE08	7	5600	10	500
2.5	820	8 x 7	F07	ULR827M0EF07	8	5600	10	500
2.5	820	8 x 8	F08	ULR827M0EF08	7	6100	10	500
2.5	820	8 x 11.5	F1A	ULR827M0EF1A	7	6100	10	500
2.5	1000	8 x 8	F08	ULR108M0EF08	7	6100	10	500
2.5	1000	8 x 9	F09	ULR108M0EF09	7	6100	10	500
2.5	1000	8 x 11.5	F1A	ULR108M0EF1A	7	6100	10	500
2.5	1200	8 x 8	F08	ULR128M0EF08	7	6100	10	600
2.5	1500	8 x 11.5	F1A	ULR158M0EF1A	7	6100	10	750
2.5	1500	10 x 12.5	G1B	ULR158M0EG1B	7	6100	10	750
2.5	2700	10 x 12.5	G1B	ULR278M0EG1B	8	5560	10	1350
4	270	6.3 x 8	E08	ULR277M0GE08	12	3200	10	280
4	560	6.3 x 8	E08	ULR567M0GE08	7	5600	10	448
4	560	8 x 8	F08	ULR567M0GF08	7	6100	10	448
4	560	8 x 11.5	F1A	ULR567M0GF1A	7	6100	10	448
4	680	8 x 8	F08	ULR687M0GF08	7	6100	10	544
4	680	8 x 11.5	F1A	ULR687M0GF1A	7	6100	10	544
4	820	8 x 8	F08	ULR827M0GF08	7	6100	10	656
4	820	8 x 11.5	F1A	ULR827M0GF1A	7	6100	10	656
4	1000	8 x 8	F08	ULR108M0GF08	7	6100	10	800
4	1000	10 x 12.5	G1B	ULR108M0GG1B	7	6640	10	800
4	1200	8 x 8	F08	ULR128M0GF08	7	6100	10	960
4	1200	8 x 11.5	F1A	ULR128M0GF1A	7	6100	10	960
4	1200	10 x 12.5	G1B	ULR128M0GG1B	8	5600	10	960
4	2700	10 x 12.5	G1B	ULR278M0GG1B	8	6900	10	2160
6.3	100	5 x 6	D06	ULR107M0JD06	25	1897	10	280
6.3	100	6.3 x 5.5	E55	ULR107M0JE55	80	1200	10	280
6.3	150	4 x 6.5	C65	ULR157M0JC65	100	2000	10	280
6.3	220	5 x 7	D07	ULR227M0JD07	11	3700	10	280
6.3	220	5.5 x 7	X07	ULR227M0JX07	20	2390	10	280
6.3	220	5.5 x 8	X08	ULR227M0JX08	15	2920	10	280
6.3	220	6.3 x 5	E05	ULR227M0JE05	20	2267	10	280
6.3	220	6.3 x 6	E06	ULR227M0JE06	20	3160	10	280
6.3	220	6.3 x 8	E08	ULR227M0JE08	20	3400	10	280
6.3	270	5 x 7	D07	ULR277M0JD07	11	3700	10	340
6.3	270	6.3 x 6	E06	ULR277M0JE06	20	3160	10	340
6.3	270	6.3 x 8	E08	ULR277M0JE08	12	3531	10	340
6.3	330	5 x 8	D08	ULR337M0JD08	12	2900	10	416

Specifications are subject to change without notice. Should a safety or technical concern arise regarding the product, please be sure to contact our sales offices or agents immediately.

ULR Series

X-CON®

Conductive Polymer
Aluminum Solid Capacitors

+105 °C, Higher Ripple Current, Lower ESR than ULG

Rated Vol. (V)	Rated Cap. (μF)	Case Size ΦD x L (mm)	Size Code	Part Number	ESR (mΩ, max/ 20°C, 100kHz)	Rated Ripple (mArms/ 105°C, 100kHz)	DF (%max)	Leakage Current (μA/2 mins)
6.3	330	5 x 9	D09	ULR337M0JD09	11	3100	10	416
6.3	330	5.5 x 8	X08	ULR337M0JX08	12	2900	10	416
6.3	330	6.3 x 5.5	E55	ULR337M0JE55	20	3160	10	416
6.3	330	6.3 x 6	E06	ULR337M0JE06	20	3160	10	416
6.3	330	6.3 x 8	E08	ULR337M0JE08	10	4500	10	416
6.3	330	8 x 8	F08	ULR337M0JF08	8	5700	10	416
6.3	390	5 x 8	D08	ULR397M0JD08	15	2766	10	492
6.3	390	5 x 9	D09	ULR397M0JD09	11	3100	10	492
6.3	390	6.3 x 8	E08	ULR397M0JE08	10	3868	10	492
6.3	390	8 x 8	F08	ULR397M0JF08	8	5700	10	492
6.3	470	5 x 9.5	D95	ULR477M0JD95	10	3100	10	592
6.3	470	5 x 11	D11	ULR477M0JD11	11	3700	10	592
6.3	470	5.5 x 10	X10	ULR477M0JX10	11	3100	10	592
6.3	470	6.3 x 6	E06	ULR477M0JE06	20	3160	10	592
6.3	470	6.3 x 6.1	E61	ULR477M0JE61	20	2449	10	592
6.3	470	6.3 x 7	E07	ULR477M0JE07	15	4545	10	592
6.3	470	6.3 x 8	E08	ULR477M0JE08	8	4700	10	592
6.3	470	6.3 x 9	E09	ULR477M0JE09	8	2898	10	592
6.3	470	8 x 8	F08	ULR477M0JF08	8	5700	10	593
6.3	470	8 x 11.5	F1A	ULR477M0JF1A	7	6100	10	592
6.3	560	5.5 x 8	X08	ULR567M0JX08	12	3265	10	706
6.3	560	6.3 x 7	E07	ULR567M0JE07	16	3500	10	706
6.3	560	6.3 x 8	E08	ULR567M0JE08	8	4700	10	706
6.3	560	8 x 8	F08	ULR567M0JF08	8	5700	10	706
6.3	680	5 x 11	D11	ULR687M0JD11	12	3558	10	857
6.3	680	5.5 x 9	X09	ULR687M0JX09	10	3762	10	857
6.3	680	6.3 x 8	E08	ULR687M0JE08	8	4700	10	857
6.3	680	8 x 8	F08	ULR687M0JF08	8	5700	10	857
6.3	680	8 x 11.5	F1A	ULR687M0JF1A	7	6100	10	857
6.3	680	10 x 12.5	G1B	ULR687M0JG1B	7	6640	10	857
6.3	820	5.5 x 10	X10	ULR827M0JX10	12	3596	10	1033
6.3	820	6.3 x 7.5	E75	ULR827M0JE75	15	3075	10	1033
6.3	820	6.3 x 8.5	E85	ULR827M0JE85	8	4700	10	1033
6.3	820	6.3 x 9.5	E95	ULR827M0JE95	8	5030	10	1033
6.3	820	6.3 x 10	E10	ULR827M0JE10	18	3170	10	1033
6.3	820	6.3 x 11	E11	ULR827M0JE11	8	5400	10	1033
6.3	820	8 x 7	F07	ULR827M0JF07	7	5051	10	1033
6.3	820	8 x 8	F08	ULR827M0JF08	7	6100	10	1033
6.3	820	8 x 11.5	F1A	ULR827M0JF1A	7	6100	10	1033
6.3	820	10 x 12.5	G1B	ULR827M0JG1B	7	6640	10	1033
6.3	1000	6.3 x 10	E10	ULR108M0JE10	8	4755	10	1260
6.3	1000	6.3 x 10.5	E1K	ULR108M0JE1K	8	4700	10	1260
6.3	1000	8 x 8	F08	ULR108M0JF08	7	6100	10	1260
6.3	1000	8 x 11.5	F1A	ULR108M0JF1A	7	6100	10	1260
6.3	1000	10 x 12.5	G1B	ULR108M0JG1B	10	5500	10	1260
6.3	1200	6.3 x 11	E11	ULR128M0JE11	10	4433	10	1512
6.3	1200	6.3 x 13	E13	ULR128M0JE13	10	4773	10	1512
6.3	1200	8 x 8	F08	ULR128M0JF08	10	4455	10	1512
6.3	1200	8 x 11.5	F1A	ULR128M0JF1A	7	6100	10	1512
6.3	1500	8 x 11.5	F1A	ULR158M0JF1A	10	5500	10	1890
6.3	1500	10 x 10	G10	ULR158M0JG10	10	5568	10	1890
6.3	1500	10 x 12.5	G1B	ULR158M0JG1B	10	5560	10	1890

Specifications are subject to change without notice. Should a safety or technical concern arise regarding the product, please be sure to contact our sales offices or agents immediately.

ULR Series

X-CON[®]

Conductive Polymer
Aluminum Solid Capacitors

+105°C, Higher Ripple Current, Lower ESR than ULG

Rated Vol. (V)	Rated Cap. (μF)	Case Size ΦD x L (mm)	Size Code	Part Number	ESR (mΩ, max/ 20°C, 100kHz)	Rated Ripple (mArms/ 105°C, 100kHz)	DF (%max)	Leakage Current (μA/2 mins)
6.3	1800	11 x 12.5	G1B	ULR188M0JG1B	10	6100	10	2268
6.3	2200	10 x 12.5	G1B	ULR228M0JG1B	10	5560	10	2772
6.3	2500	8 x 16	F16	ULR258M0JF16	8	6100	10	3150
6.8	470	5 x 9	D09	ULR477M06D09	15	2911	10	639
6.8	500	6.3 x 6.1	E61	ULR507M06E61	20	2449	10	680
6.8	1000	6.3 x 11	E11	ULR108M06E11	11	4650	10	1033
7	150	5 x 6	D06	ULR157M0SD06	12	2900	10	280
7	330	5 x 9	D09	ULR337M0SD09	11	3100	10	462
7	820	6.3 x 10	E10	ULR827M0SE10	10	4930	10	1148
7	820	8 x 8	F08	ULR827M0SF08	10	5030	10	1148
7.5	100	5 x 7	D07	ULR107M07D07	12	2900	10	280
7.5	220	5 x 7	D07	ULR227M07D07	11	3050	10	330
7.5	330	5 x 9	D09	ULR337M07D09	12	3100	10	495
7.5	330	5.5 x 9	X09	ULR337M07X09	12	3434	10	495
7.5	330	6.3 x 8	E08	ULR337M07E08	15	3158	10	495
7.5	390	5 x 8	D08	ULR397M07D08	12	3255	10	585
7.5	390	5 x 9	D09	ULR397M07D09	12	3092	10	585
7.5	470	6.3 x 6.5	E65	ULR477M07E65	30	2051	10	705
7.5	470	6.3 x 7	E07	ULR477M07E07	12	4050	10	705
7.5	470	6.3 x 8	E08	ULR477M07E08	12	3531	10	705
7.5	470	6.3 x 9	E09	ULR477M07E09	8	4545	10	705
7.5	500	5 x 8.5	D85	ULR507M07D85	12	4000	10	750
7.5	500	5 x 9	D09	ULR507M07D09	12	3758	10	750
7.5	500	5.5 x 9	X09	ULR507M07X09	9	3434	10	750
7.5	560	6.3 x 8	E08	ULR567M07E08	8	4325	10	840
7.5	680	6.3 x 8.5	E85	ULR687M07E85	8	4700	10	1020
7.5	680	8 x 8	F08	ULR687M07F08	10	4455	10	1020
7.5	820	6.3 x 9	E09	ULR827M07E09	10	4065	10	1230
7.5	820	6.3 x 11	E11	ULR827M07E11	11	4700	10	1230
7.5	1000	6.3 x 11	E11	ULR108M07E11	8	4956	10	1500
7.5	1200	6.3 x 13	E13	ULR128M07E13	8	4773	10	1800
7.5	1200	8 x 11.5	F1A	ULR128M07F1A	10	5787	10	1800
7.5	1500	8 x 11.5	F1A	ULR158M07F1A	15	4226	10	2250
10	22	6.3 x 8	E08	ULR226M1AE08	45	1870	10	280
10	33	6.3 x 8	E08	ULR336M1AE08	35	2000	10	280
10	47	6.3 x 8	E08	ULR476M1AE08	32	2100	10	280
10	150	6.3 x 11	E11	ULR157M1AE11	25	2820	10	300
10	180	6.3 x 8	E08	ULR187M1AE08	25	2820	10	360
10	220	5 x 11	D11	ULR227M1AD11	10	3898	10	440
10	220	6.3 x 6	E06	ULR227M1AE06	15	2700	10	440
10	220	6.3 x 7	E07	ULR227M1AE07	15	2700	10	440
10	220	6.3 x 8	E08	ULR227M1AE08	12	3200	10	440
10	270	6.3 x 8	E08	ULR277M1AE08	12	3531	10	540
10	270	8 x 8	F08	ULR277M1AF08	14	4420	10	540
10	270	8 x 11.5	F1A	ULR277M1AF1A	11	5100	10	540
10	330	6.3 x 8	E08	ULR337M1AE08	11	3500	10	660
10	330	8 x 8	F08	ULR337M1AF08	11	5000	10	660
10	330	8 x 11.5	F1A	ULR337M1AF1A	11	5100	10	660
10	390	8 x 8	F08	ULR397M1AF08	11	5000	10	780
10	390	8 x 11.5	F1A	ULR397M1AF1A	9	6100	10	780
10	470	6.3 x 8.5	E85	ULR477M1AE85	12	3500	10	940
10	470	6.3 x 11	E11	ULR477M1AE11	12	3750	10	940

Specifications are subject to change without notice. Should a safety or technical concern arise regarding the product, please be sure to contact our sales offices or agents immediately.

ULR Series

+105 °C, Higher Ripple Current, Lower ESR than ULG

Rated Vol. (V)	Rated Cap. (μF)	Case Size ΦD x L (mm)	Size Code	Part Number	ESR (mΩ, max/ 20°C, 100kHz)	Rated Ripple (mArms/ 105°C, 100kHz)	DF (%max)	Leakage Current (μA/2 mins)
10	470	8 x 8	F08	ULR477M1AF08	11	5000	10	940
10	470	8 x 11.5	F1A	ULR477M1AF1A	9	5650	10	940
10	470	10 x 12.5	G1B	ULR477M1AG1B	8	6100	10	940
10	560	8 x 8	F08	ULR567M1AF08	9	5600	10	1120
10	560	8 x 11.5	F1A	ULR567M1AF1A	9	5650	10	1120
10	680	6.3 x 11	E11	ULR687M1AE11	20	3135	10	1360
10	680	8 x 11.5	F1A	ULR687M1AF1A	10	5800	10	1360
10	680	10 x 12.5	G1B	ULR687M1AG1B	8	6100	10	1360
10	820	8 x 11.5	F1A	ULR827M1AF1A	8	6100	10	1640
10	1000	8 x 11.5	F1A	ULR108M1AF1A	10	5200	10	2000
10	1000	10 x 12.5	G1B	ULR108M1AG1B	9	6100	10	2000
10	1200	10 x 12.5	G1B	ULR128M1AG1B	8	6200	10	2400
10	1500	10 x 12.5	G1B	ULR158M1AG1B	15	4981	10	3000
10	2200	10 x 16	G16	ULR228M1AG16	20	4790	10	4400
12	330	5 x 9	D09	ULR337M1OD09	12	2690	10	792
12	470	5.5 x 10	X10	ULR477M1OX10	10	3735	10	1128
12	560	6.3 x 9	E09	ULR567M1OE09	12	3711	10	1344
12	680	6.3 x 11	E11	ULR687M1OE11	12	4047	10	1632
14	560	6.3 x 10	E10	ULR567M14E10	12	3800	10	1568
14	680	6.3 x 13	E13	ULR687M14E13	15	3897	10	1904
16	22	6.3 x 6	E06	ULR226M1CE06	80	1200	10	280
16	47	6.3 x 8	E08	ULR476M1CE08	60	1500	10	280
16	100	5 x 7	D07	ULR107M1CD07	20	2262	10	320
16	100	5 x 9	D09	ULR107M1CD09	24	2820	10	320
16	100	6.3 x 6	E06	ULR107M1CE06	25	2700	10	320
16	100	6.3 x 7	E07	ULR107M1CE07	24	2820	10	320
16	100	6.3 x 8	E08	ULR107M1CE08	24	2820	10	320
16	100	6.3 x 11	E11	ULR107M1CE11	24	2820	10	320
16	180	5.5 x 8	X08	ULR187M1CX08	25	2262	10	576
16	180	5.5 x 9	X09	ULR187M1CX09	20	2660	10	576
16	180	6.3 x 7	E07	ULR187M1CE07	22	2468	10	576
16	180	8 x 11.5	F1A	ULR187M1CF1A	13	5000	10	576
16	220	5.5 x 9	X09	ULR227M1CX09	20	2660	10	704
16	220	6.3 x 8	E08	ULR227M1CE08	15	3158	10	704
16	220	6.3 x 11	E11	ULR227M1CE11	20	3100	10	704
16	220	8 x 8	F08	ULR227M1CF08	13	4300	10	704
16	220	8 x 11.5	F1A	ULR227M1CF1A	13	5000	10	704
16	270	5.5 x 9	X09	ULR277M1CX09	20	2660	10	864
16	270	6.3 x 11	E11	ULR277M1CE11	20	3100	10	864
16	270	8 x 8	F08	ULR277M1CF08	13	4300	10	864
16	270	8 x 11.5	F1A	ULR277M1CF1A	13	5000	10	864
16	330	6.3 x 9	E09	ULR337M1CE09	18	3030	10	1056
16	330	6.3 x 10.5	E1K	ULR337M1CE1K	18	3200	10	1056
16	330	6.3 x 11	E11	ULR337M1CE11	18	3200	10	1056
16	330	8 x 7	F07	ULR337M1CF07	13	4300	10	1056
16	330	8 x 8	F08	ULR337M1CF08	13	4300	10	1056
16	330	8 x 11.5	F1A	ULR337M1CF1A	10	5800	10	1056
16	330	10 x 9	G09	ULR337M1CG09	13	4300	10	1056
16	330	10 x 12.5	G1B	ULR337M1CG1B	10	6100	10	1056
16	470	6.3 x 11	E11	ULR477M1CE11	11	4227	10	1504
16	470	8 x 8	F08	ULR477M1CF08	12	4067	10	1504
16	470	8 x 11.5	F1A	ULR477M1CF1A	11	5100	10	1504

Specifications are subject to change without notice. Should a safety or technical concern arise regarding the product, please be sure to contact our sales offices or agents immediately.

ULR Series

X-CON[®]

Conductive Polymer
Aluminum Solid Capacitors

+105°C, Higher Ripple Current, Lower ESR than ULG

Rated Vol. (V)	Rated Cap. (μF)	Case Size ΦD x L (mm)	Size Code	Part Number	ESR (mΩ, max/ 20°C, 100kHz)	Rated Ripple (mArms/ 105°C, 100kHz)	DF (%max)	Leakage Current (μA/2 mins)
16	470	10 x 12.5	G1B	ULR477M1CG1B	10	6100	10	1504
16	680	8 x 11.5	F1A	ULR687M1CF1A	11	5100	10	2176
16	680	10 x 12.5	G1B	ULR687M1CG1B	10	6100	10	2176
16	820	8 x 11.5	F1A	ULR827M1CF1A	11	4935	10	2624
16	820	10 x 12.5	G1B	ULR827M1CG1B	10	6100	10	2624
16	1000	8 x 16	F16	ULR108M1CF16	10	5950	10	3200
16	1000	10 x 12.5	G1B	ULR108M1CG1B	10	6100	10	3200
20	33	6.3 x 8	E08	ULR336M1DE08	35	2000	10	280
20	47	8 x 8	F08	ULR476M1DF08	33	2100	10	280
20	100	8 x 11.5	F1A	ULR107M1DF1A	32	2750	10	400
20	150	10 x 12.5	G1B	ULR157M1DG1B	28	2900	10	600
25	22	6.3 x 8	E08	ULR226M1EE08	45	1870	10	280
25	33	8 x 8	F08	ULR336M1EF08	40	2050	10	280
25	47	8 x 8	F08	ULR476M1EF08	36	2100	10	280
25	100	8 x 11.5	F1A	ULR107M1EF1A	32	2750	10	500
25	220	8 x 11.5	F1A	ULR227M1EF1A	32	2750	10	1100
25	330	8 x 11.5	F1A	ULR337M1EF1A	32	2750	10	1650
25	330	10 x 12.5	G1B	ULR337M1EG1B	45	2700	10	1650
25	560	8 x 16	F16	ULR567M1EF16	35	2916	10	2800
25	680	8 x 16	F16	ULR687M1EF16	16	4700	10	3400
25	1000	10 x 16	G16	ULR108M1EG16	10	6100	10	5000
35	33	5 x 9	D09	ULR336M1VD09	90	1190	10	280
35	100	6.3 x 9	E09	ULR107M1EE09	70	1537	10	700
35	100	8 x 11.5	F1A	ULR107M1VF1A	55	2000	10	700
35	100	10 x 12	G12	ULR107M1EG12	70	2267	10	700
35	100	10 x 12.5	G1B	ULR107M1VG1B	60	2000	10	700
35	220	10 x 12.5	G1B	ULR227M1VG1B	50	2500	10	1540

ULR Series

Specifications are subject to change without notice. Should a safety or technical concern arise regarding the product, please be sure to contact our sales offices or agents immediately.

X-ON Electronics

Largest Supplier of Electrical and Electronic Components

Click to view similar products for [Aluminium Organic Polymer Capacitors](#) category:

Click to view products by [Man Yue](#) manufacturer:

Other Similar products are found below :

[750-1809](#) [SEAU0A0102G](#) [MPP104K6130714LC](#) [MPP223J5130508LC](#) [MPP104K6130612LC](#) [PPS333KD241017LC](#) [MPP472K4130408LC](#)
[PCZ1V221MCL1GS](#) [HHXD500ARA470MHA0G](#) [NPXB1001B271MF](#) [NPXB1101B391MF](#) [NPXC0571B221MF](#) [NPXC0701B331MF](#)
[NPXB0901B391MF](#) [NPXD0701A471MF](#) [HHXD630ARA330MJA0G](#) [HHXD350ARA270MF61G](#) [HHXD350ARA220ME61G](#)
[HHXD350ARA101MHA0G](#) [HHXD350ARA680MF80G](#) [APXJ200ARA151MF61G](#) [RS81C271MDN1CG](#) [APSF6R3ELL821MF08S](#)
[PM101M016E058PTR](#) [PM101M025E077PTR](#) [SPZ1EM221E10P25RAXXX](#) [APSE2R5ETD821MF08S](#) [SPZ1EM681F14O00RAXXX](#)
[SPZ1AM102F11000RAXXX](#) [SPV1VM471G13O00RAXXX](#) [SPV1VM101E08O00RAXXX](#) [SPZ1VM821G18O00RAXXX](#)
[SPV1HM331G15O00RAXXX](#) [SVZ1EM221E09E00RAXXX](#) [PM101M035E077PTR](#) [HV1A227M0605PZ](#) [HV1C107M0605PZ](#)
[HV1C227M0607PZ](#) [HV1H107M0810PZ](#) [HV1E107M0607PZ](#) [HV1V106M0605PZ](#) [HV1V476M0605PZ](#) [HV1H227M1010PZ](#)
[HV0J337M0607PZ](#) [HV1A477M0607PZ](#) [HV1E566M0605PZ](#) [HV1V227M0810PZ](#) [HV0J108M0810PZ](#) [M2101M035C070RT](#)
[SVZ1EM471FBRE00RAXXX](#)