

Peak Emission Wavelength: 1450nm

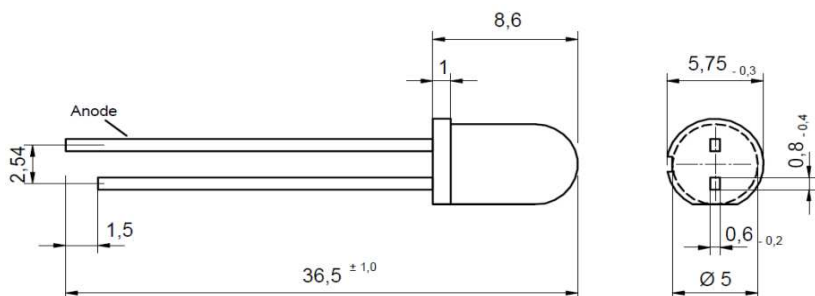

**Description**

- Standard 5mm plastic lens package housed without standoff leads
- Type: MQW
- High power
- High speed infrared

**Application**

- Optical communication
- Safety equipment
- Automation

Absolute Maximum Ratings (Ta=25°C)



| ITEMS                       | TEST CONDITIONS       | SYMBOL | RATINGS     | UNIT |
|-----------------------------|-----------------------|--------|-------------|------|
| Forward DC Current          |                       | If     | 100         | mA   |
| Peak Forward Current        | (tp ≤ 50us, tp/T=1/2) | Ifp    | 200         | mA   |
| Power Dissipation           |                       | Pd     | 150         | mW   |
| Operating Temperature Range |                       | Top    | -20 to +80  | °C   |
| Storage Temperature Range   |                       | Tstg   | -55 to +100 | °C   |
| Lead Soldering Temperature  | t<5s, 3mm from case   | Tslg   | 260         | °C   |

Electrical & Optical Characteristics (Ta = 25°C)

| ITEMS                     | SYMBOL | CONDITIONS | MIN | TYP  | MAX | UNIT |
|---------------------------|--------|------------|-----|------|-----|------|
| Forward Voltage           | Vf     | If=20mA    | --  | 0.8  | --  | V    |
| Forward Voltage           | Vf     | If=100mA   | --  | 1    | 1.2 | V    |
| Reverse Voltage           | Vr     | Ir=10uA    | 5   | --   | --  | V    |
| Radiant Power             | Φe     | If=20mA    | --  | 1.8  | --  | mW   |
| Radiant Power             | Φe     | If=100mA   | --  | 6.5  | --  | mW   |
| Peak Wavelength           | λp     | If=20mA    | --  | 1450 | --  | nm   |
| Spectral Bandwidth at 50% | Δλ0.5  | If=20mA    | --  | 150  | --  | nm   |
| Viewing Angle             | φ      | If=20mA    | --  | 20   | --  | deg  |
| Switching Time            | tr, tf | If=20mA    | --  | 40   | --  | ns   |

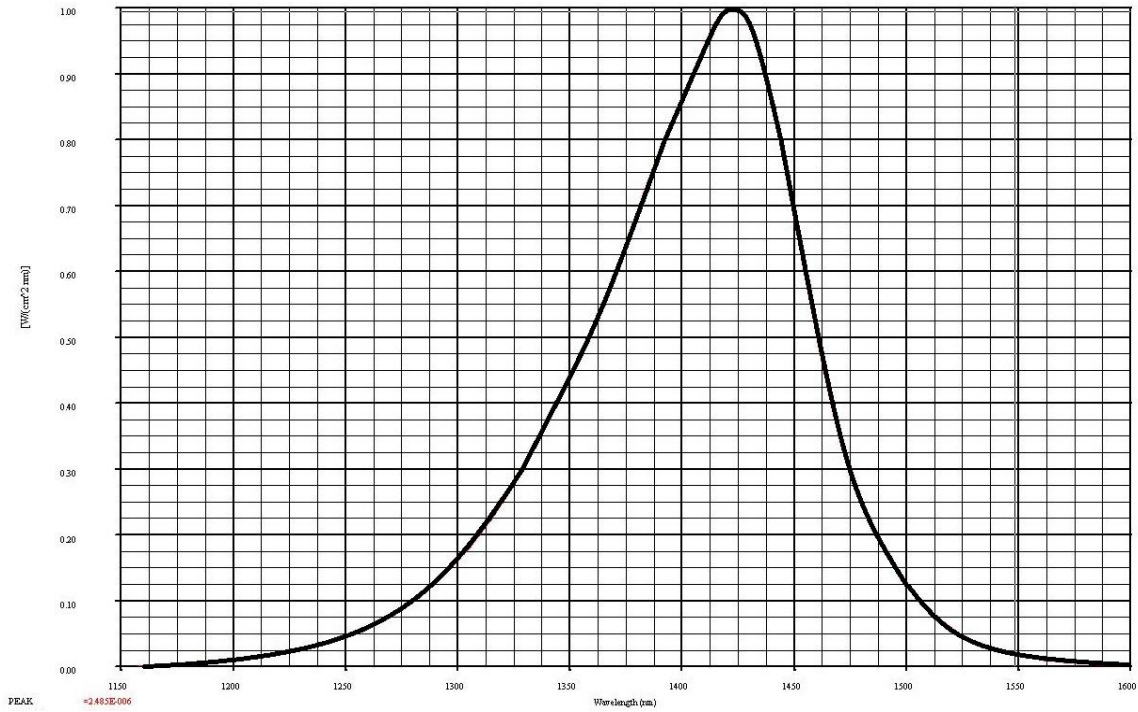

## X-ON Electronics

Largest Supplier of Electrical and Electronic Components

*Click to view similar products for [Infrared Emitters](#) category:*

*Click to view products by [Marktech](#) manufacturer:*

Other Similar products are found below :

[LTE-309](#) [LTE-3279K](#) [LTE-4206C](#) [LTE-4208C](#) [EAILP03RDAA6](#) [LTE-2871C](#) [LTE-4238](#) [ASDL-4264-C22](#) [OED-EL305F4C50-HT](#) [OP216-004](#) [LTE-3376](#) [EEL109](#) [HL-PST-1608IR1C-L4](#) [SFH 7016](#) [IN-S126ETIR](#) [IN-S126DSHIR](#) [IN-S126ETHIR](#) [IN-P32ZTHIR](#) [IN-S42CTQHIR](#) [IN-S126BTHIR](#) [IN-S63DTHIR](#) [IN-S85BTHIR](#) [IN-S63FTHIR](#) [EAIST3535A1](#) [EAIST3535A4](#) [MHT153IRCT](#) [MHS153IRCT](#) [HIR204C/H0](#) [HIR323C](#) [LTE-209](#) [IR12-21C/TR8](#) [IR17-21C/TR8](#) [IR26-21C/L110/TR8](#) [IR91-21C/TR10](#) [KM-4457F3C](#) [L-53F3BT](#) [WP3A10F3C](#) [LTE-4208](#) [OP235W](#) [IR42-21C/TR8](#) [HSDL-4261](#) [APA3010F3C-GX](#) [SE2460-140](#) [OP266-905](#) [OP280D](#) [LTE-2871](#) [HIR8323/C16](#) [KP-2012SF4C](#) [KPA-3010F3C](#) [L-7113SF6C](#)