

ESTF15SS60SC

Super Fast Recovery Diode

Features

- Hyperfast Recovery $t_{rr} = 40 \text{ ns}$ (@ $I_F = 15 \text{ A}$)
- Max Forward Voltage, $V_F = 2.1 \text{ V}$ (@ $T_C = 25^\circ\text{C}$)
- 600 V Reverse Voltage and High Reliability
- Avalanche Energy Rated
- RoHS Compliant



Applications

- Switching Power Supplies
- Power Switching Circuits
- General Purpose



Absolute Maximum Ratings @ $T_C=25^\circ\text{C}$

Symbol	Parameter	ratings	Unit
V_{RRM}	Repetitive peak reverse voltage @50 μA	600	V
V_{RWM}	Working Peak Reverse Voltage	600	V
$I_{F(AV)}$	Average forward current @ $T_C=110^\circ\text{C}$	15	A
I_{FSM}	Peak one Cycle Surge Forward @ $t=8.3\text{ms}$	30	A
E_{AVL}	Avalanche Energy(per diode) (1A, 40mH)	20	mJ
T_j	Junction Temperature	-40~+150	$^\circ\text{C}$
T_{STG}	Storage temperature range	-65~+175	$^\circ\text{C}$

Electrical Specifications @ $T_C=25^\circ\text{C}$

Symbol	Parameter		Ratings			Unit
			Min	Typ	Max	
I_R	$T_j=25^\circ\text{C}$	$V_R=V_{RRM}$			100	μA
	$T_j=125^\circ\text{C}$				500	μA
V_F	$T_j=25^\circ\text{C}$	$I_F=15\text{A}$			2.1	V
	$T_j=125^\circ\text{C}$				1.7	V
T_{rr}	$I_F=1\text{A}, I_R=1\text{A}, I_{RR}=0.25\text{A}$				35	ns
T_{rr}	$I_F=15\text{A}, V_R=30\text{V}, di_F/dt=-100\text{A}/\mu\text{s}$				40	ns
Q_{rr}	$I_F=15\text{A}, di_F/dt=-100\text{A}/\mu\text{s}$				40	nC
$R_{th(j-c)}$	Thermal resistance from junction to case	TO-220AC		1.5		$^\circ\text{C}/\text{W}$

Typical Performance Curves

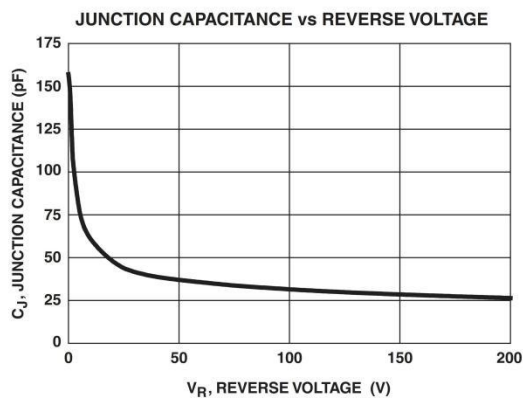
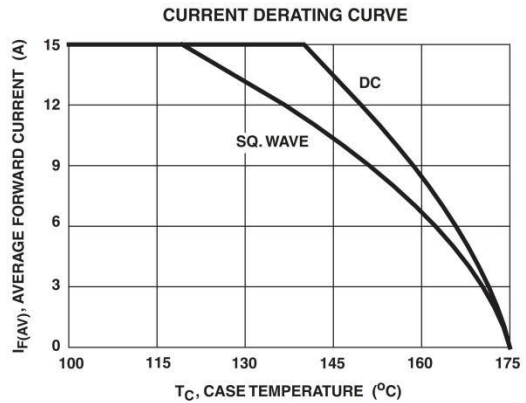
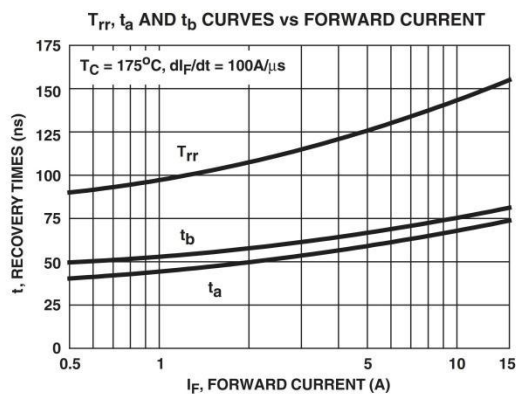
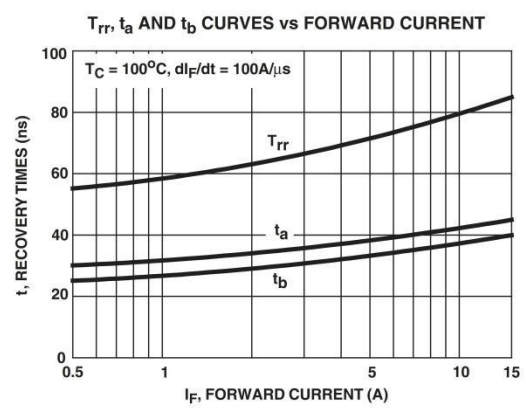
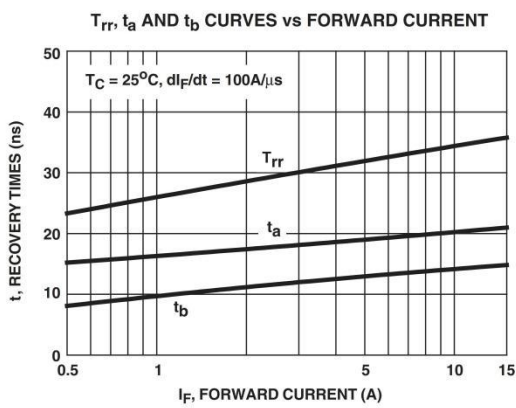
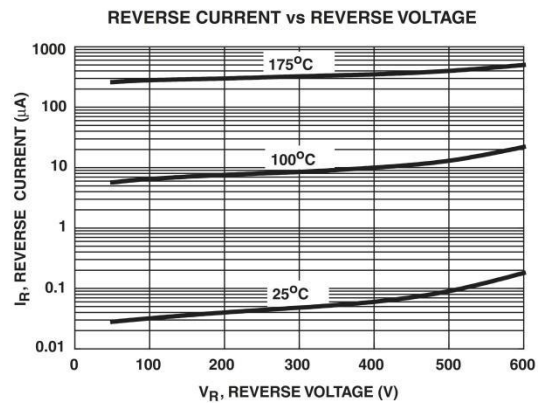
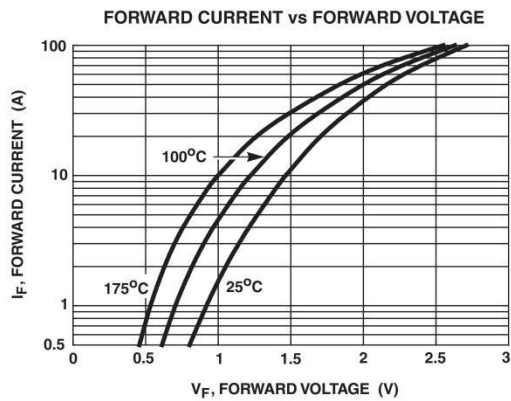

Package

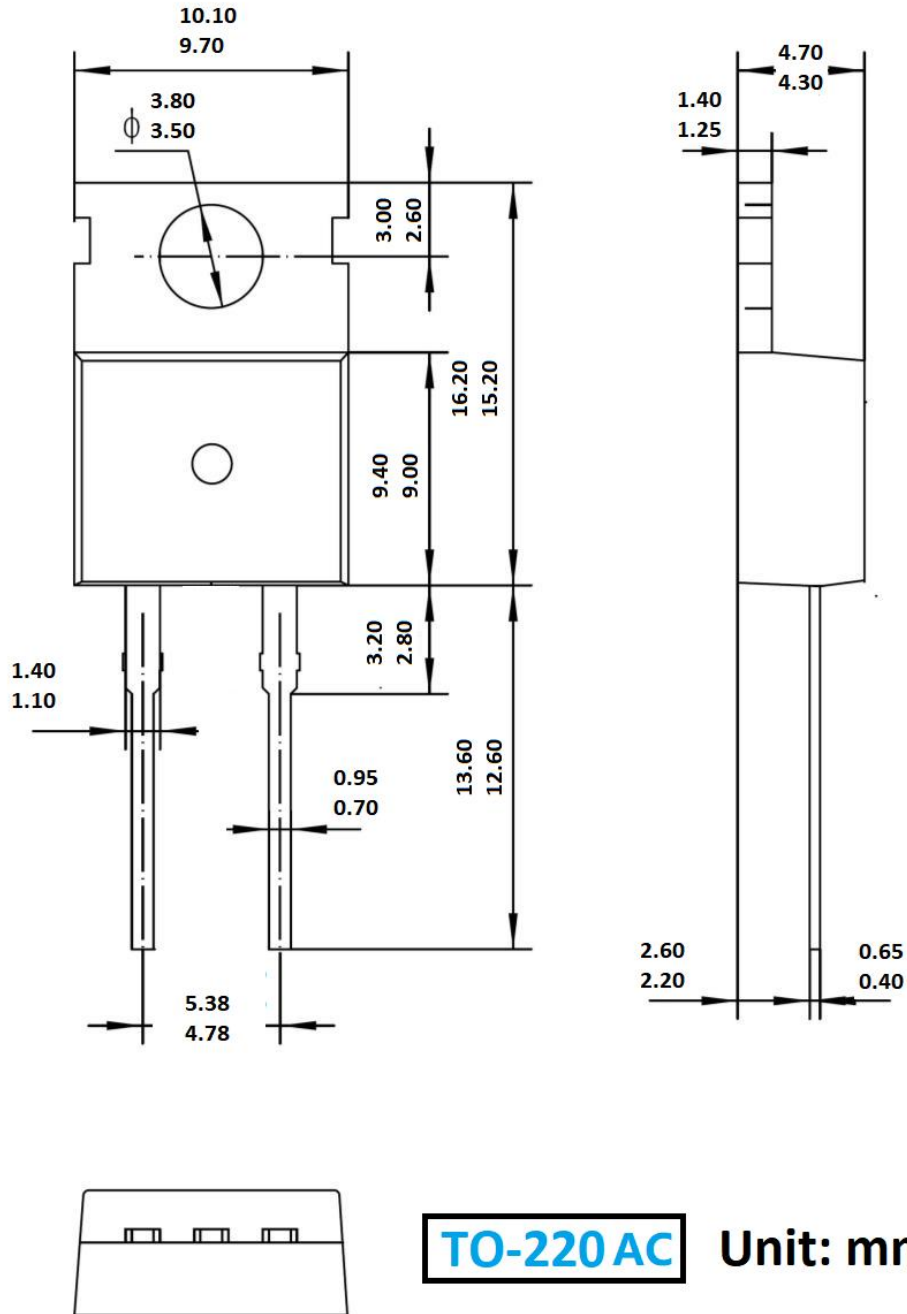

X-ON Electronics

Largest Supplier of Electrical and Electronic Components

Click to view similar products for [Rectifiers](#) category:

Click to view products by [MASPOWER](#) manufacturer:

Other Similar products are found below :

[70HFR40](#) [FR105 R0](#) [RL252-TP](#) [1N5397](#) [JANTX1N5634A](#) [1N4005-TR](#) [1N4007-BP](#) [UFS120Je3/TR13](#) [20ETS12S](#) [RRE02VS6SGTR](#)
[MS306](#) [A1N5404G-G](#) [CRF02\(T5L,TEMQ\)](#) [ACGRB207-HF](#) [CLH07\(TE16L,Q\)](#) [CLH03\(TE16L,Q\)](#) [1N5395-TP](#) [UES1302](#) [ACGRC307-HF](#)
[ACEFC304-HF](#) [DZ-1380](#) [85HFR60](#) [40HFR60](#) [70HF120](#) [85HFR80](#) [SCF7500](#) [SM100](#) [ACGRA4001-HF](#) [SKN70/08](#) [SKR70/08](#) [NTE5819](#)
[NTE5827](#) [NTE5828](#) [NTE5911](#) [NTE5915](#) [NTE6104](#) [NTE6163](#) [NTE6164](#) [NTE6165](#) [NTE6364](#) [TSD3G](#) [SET130312](#) [NRVUS110VT3G](#)
[UES1106](#) [UES1306](#) [NRVUS240VT3G](#) [D5FE60-5063](#) [R4000GPS-TP](#) [D4015L56TP](#) [UES1306HR2](#)