

注：本板为禁止运输、复制、编辑文档，以及用其内容进行交流

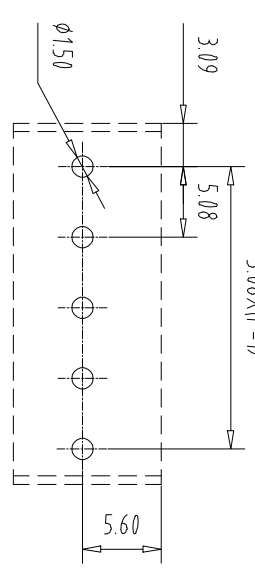
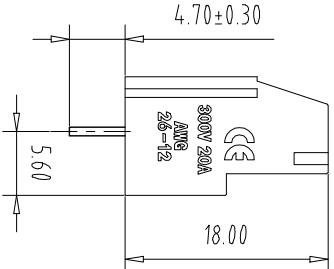
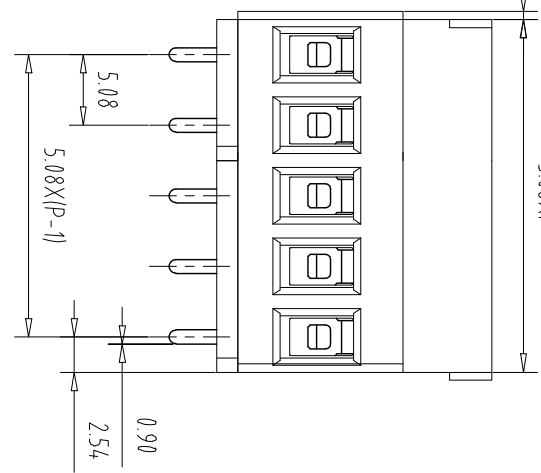
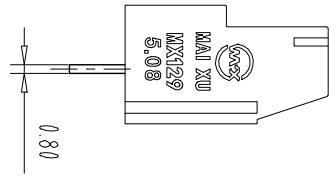
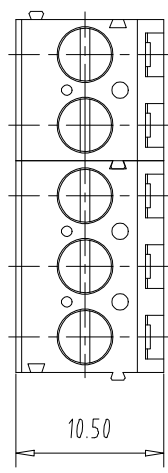

PCB Layout

Pitch Range		Nominal Dimension		Range	
mm	In	mm	In	mm	In
Over 6	Over 10	Over 30	Over 60	Over 100	Over 150
TO 6	TO 10	TO 30	TO 60	TO 100	TO 150
±0.15	±0.20	±0.30	±0.50	±0.70	±1.00
				±1.30	±2°

REV	ECN NO.	CONTENT	CHK	DATE

- NOTES1:  
UL Standard  
1.Rating voltage/current: 300V/20A  
2.withstanding voltage: AC2000V/1Min  
3.Torque value: M3, 4,43Lb.in  
4.Wire range: 26~12AWG
- IEC Standard

Pollution Degree	Overvoltage Category	Rate Impulse Voltage(kV)	Rate Voltage(V)	Rate Current(A)
3	III	/	250V	/
2	II	/	/	20A

- NOTES2:  
1.Housing: PA66(UL94V-0)  
2.Solder Pin: Copper alloy(Sn Plated)  
3.Cage: Brass(Ni Plated)  
4.Screw: Steel(M3,Zn Plated)

- NOTES3:  
1.Pitch: 5.08mm Poles: 02-24P  
2.Stripping length: 8mm  
3.Operating temperature: -40℃~+105℃  
4.RoHS Compliance

How to order  
MX129 - 508 - XXX - XXXX - XX - X - X  
产品型号 间距 板数 颜色: 01:青板颜色  
02-99: 灰色:GY 橙色:OE  
蓝色:BU 红色:RD 定制颜色  
黑色:BK 透明色:TT  
绿色:GN 黄色:YW  
透明色:TT 白色:WE

A-Z其他定制  
0-Y一字螺丝  
1-S十字螺丝  
2-P:扁平十字螺丝  
Cu:铜方块  
Fe:铁方块

ITEM	NAME OF PART	NO. OF PART	Q'TY	MATERIAL	NOTE
DWG	CHK	DATE	DATE	UNITS	SCALE
APP	DATE	DATE	SCALE	A4	1/1
CIXI MAIXU ELECTRONICS CO.,LTD			NAME	MX129-5.08-XXX	
慈溪市迈旭电子有限公司			DWGNO.		

## X-ON Electronics

Largest Supplier of Electrical and Electronic Components

*Click to view similar products for [Fixed Terminal Blocks](#) category:*

*Click to view products by [MAX](#) manufacturer:*

Other Similar products are found below :

[MBE-1512](#) [MBE-1520](#) [MBE-154](#) [MBE-156](#) [MBES-156](#) [MH-2512](#) [MHE-132](#) [MHE-163](#) [MI-254 \(35\)](#) [MI-272](#) [MPT-275](#) [15602-04-08-21](#)  
[ELM10110G](#) [BA311TU](#) [BA411SU](#) [MV-254-D](#) [MV-255](#) [MV-493](#) [MVE-252](#) [MVE-253](#) [MVEB-153](#) [1705142](#) [1712417](#) [1713088](#) [1745195](#)  
[1760594](#) [1-796689-8](#) [1800114](#) [20020314-C121B01LF](#) [KP03215000J0G](#) [KP04215000J0G](#) [S451](#) [29.007](#) [29.116](#) [30.204](#) [30.503](#) [30.756](#)  
[30.853](#) [996750](#) [1710052](#) [1777707](#) [1-796692-3](#) [20020316-G071B01LF](#) [20020327-C061B01LF](#) [29590](#) [30.652](#) [30.710](#) [30.754](#) [30.757](#) [32.058](#)