

注：本板为禁止运输、复制、翻印文件，以及用其内容进行交流

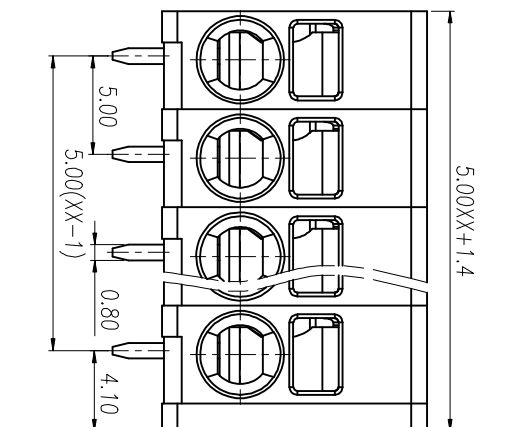
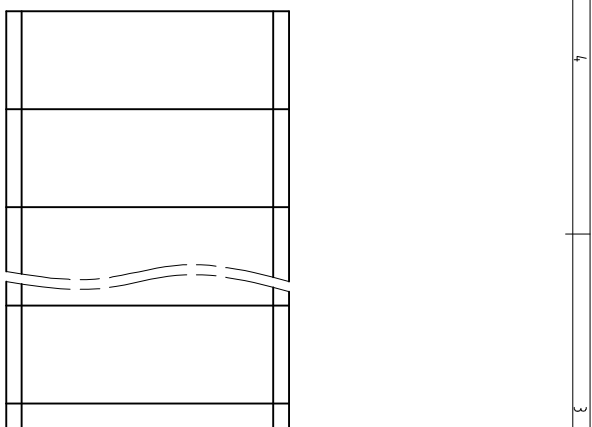
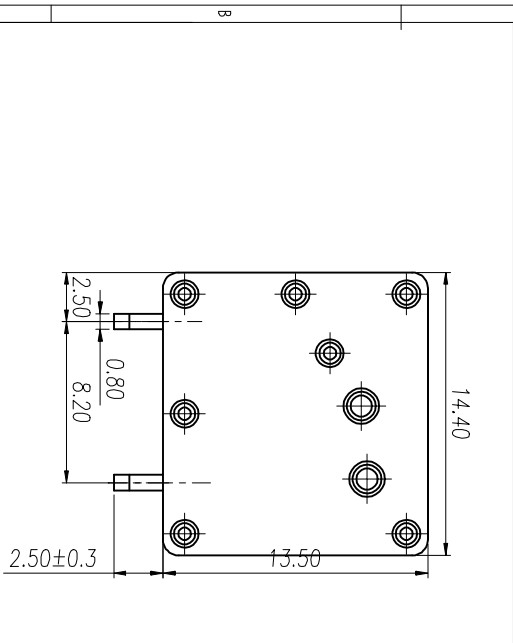
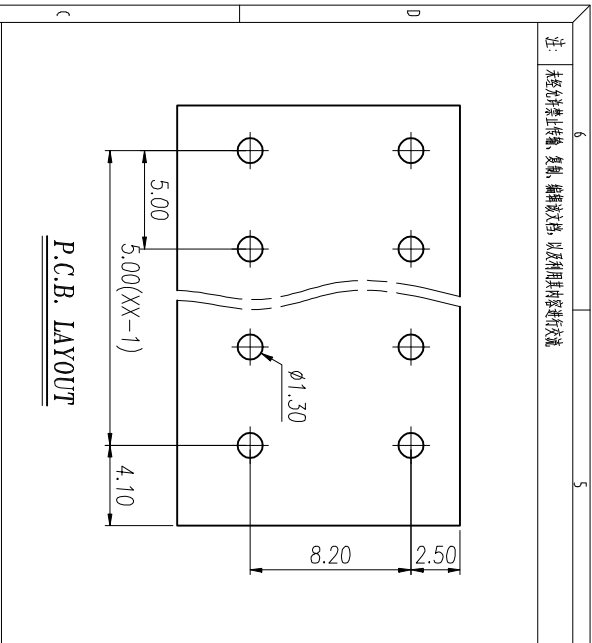

| REV | ECN NO. | CONTENT | CHK | DATE |
|-----|---------|---------|-----|------|
| | | | | |

NOTES1:
UL Standard

| 1. Use group | B | C | D |
|---------------|------|---|------|
| Rated Current | 20A | / | 10A |
| Rated Voltage | 300V | / | 300V |

2. Wire range: 24~12AWG

IEC Standard

| 1. Pollution Degree | 3 | 2 | 2 |
|--------------------------|-------|-------|-------|
| Overvoltage Category | III | III | II |
| Rate Impulse Voltage(KV) | 4.0KV | 4.0KV | 4.0KV |
| Rate Voltage(V) | 250V | 400V | 630V |
| Rate Current(A) | 24A | 24A | 24A |

2. wire range: 0.2~2.5mm², 0.2~4.0mm² Sol

NOTES2:

1. Insulation Material: PA66 (UL94V-0)
2. Conductor: Copper alloy(Sn Plated)

NOTES3:

1. Pitch: 5.0mm Poles: 01-30P
2. Stripping length: 9-10mm
3. Operating temperature: -40℃~+105℃
4. RoHS Compliance

How to order

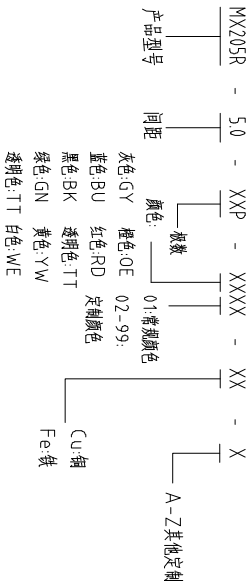

| Pitch Range In mm | Nominal Dimension Range In mm | | | | | | - / □ |
|-------------------|-------------------------------|------------|------------|------------|-------------|-------------|--------|
| | Over 6 TO | Over 10 TO | Over 24 TO | Over 30 TO | Over 60 TO | Over 100 TO | |
| ±0.15 | ±0.20 | ±0.30 | ±0.30 | ±0.50 | ±0.70 | ±1.00 | ±1.30 |
| Over 6 TO | Over 10 TO | Over 24 TO | Over 30 TO | Over 60 TO | Over 100 TO | Over 150 TO | 0.1/10 |
| ±0.15 | ±0.20 | ±0.30 | ±0.30 | ±0.50 | ±0.70 | ±1.00 | ±1.30 |

| ITEM | NAME OF PART | NO. OF PART | Q'TY | MATERIAL | NOTE |
|------|--------------|-------------|-------|----------------|------|
| DWG | CHK | DATE | SCALE | SHEET/OF | 1/1 |
| APP | DATE | DATE | SCALE | A4 | 1/1 |
| NAME | | | | MX205R-5.0-XXP | |

MAXXU 慈溪市迈旭电子有限公司

DWGNO.

X-ON Electronics

Largest Supplier of Electrical and Electronic Components

Click to view similar products for [Fixed Terminal Blocks](#) category:

Click to view products by [MAX](#) manufacturer:

Other Similar products are found below :

[MBE-1512](#) [MBE-1520](#) [MBE-154](#) [MBE-156](#) [MBES-156](#) [MH-2512](#) [MHE-132](#) [MHE-163](#) [MI-254 \(35\)](#) [MI-272](#) [MPT-275](#) [15602-04-08-21](#)
[ELM10110G](#) [BA311TU](#) [BA411SU](#) [MV-254-D](#) [MV-255](#) [MV-493](#) [MVE-252](#) [MVE-253](#) [MVEB-153](#) [1705142](#) [1712417](#) [1713088](#) [1745195](#)
[1760594](#) [1-796689-8](#) [1800114](#) [20020314-C121B01LF](#) [KP03215000J0G](#) [KP04215000J0G](#) [S451](#) [29.007](#) [29.116](#) [30.204](#) [30.503](#) [30.756](#)
[30.853](#) [996750](#) [1710052](#) [1777707](#) [1-796692-3](#) [20020316-G071B01LF](#) [20020327-C061B01LF](#) [29590](#) [30.652](#) [30.710](#) [30.754](#) [30.757](#) [32.058](#)