

注：本板为禁止传输、复制、编辑、打印、以及用其内容进行交流

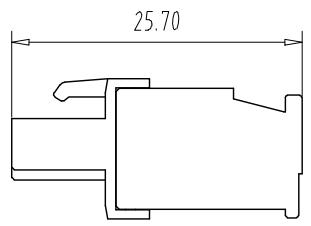
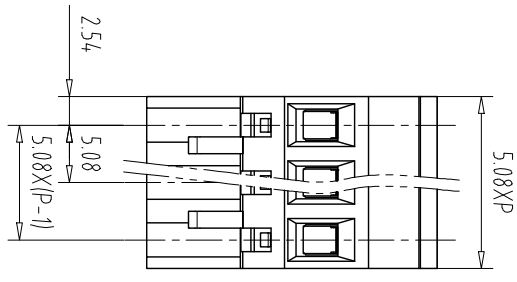
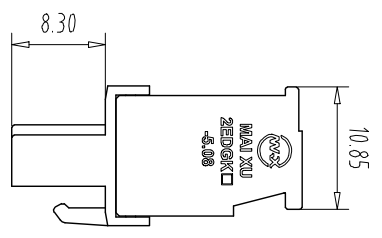
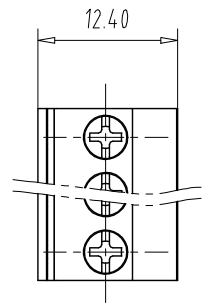

REV	ECN NO.	CONTENT	CHK	DATE

NOTES1:  
UL Standard

Use group	B	C	D
Rated Current	15A	-	10A
Rated Voltage	300V	-	300V

- Torque value: M2.5, 3.54Lb/in
- Wire range: 28~12AWG

IEC Standard	1	2	3
Pollution Degree	2	2	3
Overvoltage Category	II	II	III
Rate Impulse Voltage(KV)	/	4.0KV	/
Rate Voltage(V)	/	320V	/
Rate Current(A)	/	12A	/

- Torque value: M2.5, 0.4Nm
- Wire range: 1.0~2.5mm<sup>2</sup>

NOTES2:

- Housing: PA66 (UL94V-0)
- Cover: PA66 (UL94V-0)
- Cage: Brass (Ni Plated)
- Clamp: Copper alloy (Ni Plated)
- Screw: Steel (M2.5,Zn Plated)

NOTES3:

- Pitch: 5.08mm Poles: 02-24P
- Stripping length: 7-8mm
- Operating temperature: -40°C~+105°C
- RoHS Compliance

How to order

MXZEDGKA - 5.08 - XXP - XXXX - XX - X - X

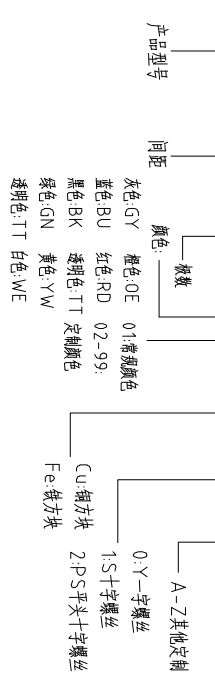

Pitch Range In mm	Nominal Dimension Range In mm						-	0.1/10
	Over 6 TO	Over 10 TO	Over 24 TO	Over 30 TO	Over 60 TO	Over 100 TO		
±0.15	±0.20	±0.30	±0.30	±0.50	±0.70	±1.00	±1.30	±2°

ITEM	NAME OF PART	NO. OF PART	Q'TY	MATERIAL	NOTE
DWG	CHK	DATE	SCALE	SHEET/OF	1/1
APP	DATE	SCALE	NAME		
CIXI MAIXU ELECTRONICS CO.,LTD			MXZEDGKA-5.08-XXP		
慈溪市迈旭电子有限公司			DWGNO.		

## X-ON Electronics

Largest Supplier of Electrical and Electronic Components

*Click to view similar products for [Pluggable Terminal Blocks](#) category:*

*Click to view products by [MAX](#) manufacturer:*

Other Similar products are found below :

[57.510.0053](#) [MC 1.5/ 6-ST-3.5 GY AU](#) [ET02015000J0G](#) [860505](#) [860516](#) [860810](#) [GBPACX-12](#) [93.731.4953.0](#) [PV05-5,08-K](#) [PVP03-3,50](#)  
[PVS02-5,00](#) [1-1986160-3](#) [1377680000](#) [1531000000](#) [1546228-5](#) [ELFP03110](#) [ELFP10210](#) [ELFT07250](#) [ELVD12100](#) [ELVF09400](#)  
[ELVP03100](#) [ELXH071G0E](#) [1700410](#) [1746952](#) [1760336](#) [1800272](#) [1809474](#) [1855000000](#) [19346](#) [1946309](#) [1950227](#) [1973592](#) [19892](#)  
[25.320.4053.1](#) [25.320.4553.9](#) [25.320.4753.1](#) [25.320.5453.1](#) [25.340.0353.1](#) [25.340.1053.1](#) [25.345.3553.0M001](#) [25.640.3553.1](#) [SH02-5,08](#)  
[SH06-3,81](#) [SH08-5,08](#) [SH08-5,08-K](#) [SH12-5,08](#) [SHS04-5,00](#) [30.303](#) [30.305](#) [30.306](#)