

注：本板为禁止运输、复制、编辑文件，以及用其内容进行交流

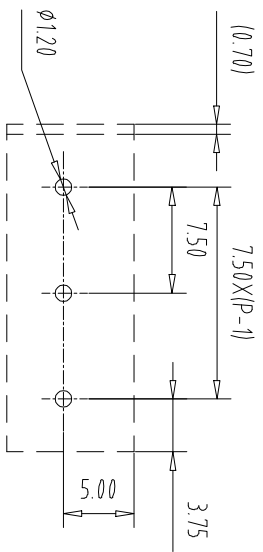
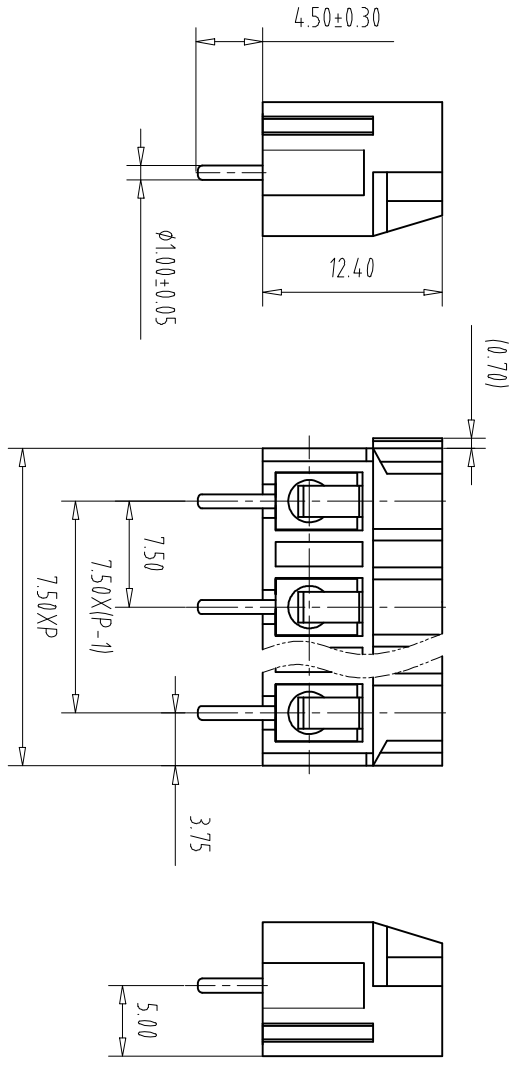
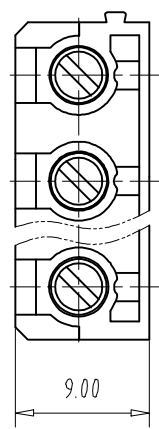

PCB Layout

Pitch	Range	In	Nominal Dimension	Range
mm	Over	In mm	Over	Over
	6	10	30	60
	TO	TO	TO	TO
	6	10	24	30
	TO	TO	60	100
	TO	TO	100	150
	TO	TO	150	150
	±0.15	±0.20	±0.30	±0.50
			±0.70	±1.00
				±1.30
				±2°

REV	ECN NO.	CONTENT	CHK	DATE

NOTES1:

UL Standard	Use group	B	C	D
	Rated Current	15A	/	10A
	Rated Voltage	300V	/	300V

1. Use group: B, C, D
2. withstanding voltage: AC2500V/1Min
3. Torque value: M3, 4, 4.3Lb.in
4. Wire range: 22~14AWG

IEC Standard	Pollution Degree	3	2	2
	Overvoltage Category	III	II	II
	Rate Impulse Voltage(KV)	/	/	/
	Rate Voltage(V)	/	250V	/
	Rate Current(A)	/	15A	/

2. Torque value: M3, 0.5Nm
3. wire range: 1.0~2.5mm²

NOTES2:

- 1.Housing: PA66(UL94V-0)
- 2.Solder Pin: Copper alloy(Sn Plated)
- 3.Spring: Stainless Steel
- 4.Screw: Steel(M3,Zn Plated)

NOTES3:

- 1.Pitch: 7.5mm Poles: 02-24P
- 2.Stripping length: 6-8mm
- 3.Operating temperature: -40℃~+105℃
- 4.RoHS Compliance

How to order

MX360 - 7.5 - XXP - XXXX - XX - X - X - X

产品型号 间距 颜色 极数

颜色: 01:常规颜色
灰色:GY 蓝色:BU 黑色:BK 透明色:TT
红色:RD 黄色:YW 绿色:GN 白色:WE
蓝色:BU 透明色:TT
红色:RD 黄色:YW
黑色:BK 透明色:TT
绿色:GN 白色:WE

0-Y一字螺丝
A-Z其他定制
1-S十字螺丝
2-P.S平头十字螺丝
Cu:轴方块 Fe:轴方块

ITEM	NAME OF PART	NO. OF PART	Q'TY	MATERIAL	NOTE
DWG	CHK	DATE	UNITS	MM	SHEET/OF
APP	DATE	SCALE	1:1	A4	1/1
CIXI MAIXU ELECTRONICS CO.,LTD			MX360-7.5-XXP		
慈溪市迈旭电子有限公司			DWGNO.		

X-ON Electronics

Largest Supplier of Electrical and Electronic Components

Click to view similar products for [Fixed Terminal Blocks](#) category:

Click to view products by [MAX](#) manufacturer:

Other Similar products are found below :

[MBE-1512](#) [MBE-1520](#) [MBE-154](#) [MBE-156](#) [MBES-156](#) [MH-2512](#) [MHE-132](#) [MHE-163](#) [MI-254 \(35\)](#) [MI-272](#) [MPT-275](#) [15602-04-08-21](#)
[ELM10110G](#) [BA311TU](#) [BA411SU](#) [MV-254-D](#) [MV-255](#) [MV-493](#) [MVE-252](#) [MVE-253](#) [MVEB-153](#) [1705142](#) [1712417](#) [1713088](#) [1745195](#)
[1760594](#) [1-796689-8](#) [1800114](#) [20020314-C121B01LF](#) [KP03215000J0G](#) [KP04215000J0G](#) [S451](#) [29.007](#) [29.116](#) [30.204](#) [30.503](#) [30.756](#)
[30.853](#) [996750](#) [1710052](#) [1777707](#) [1-796692-3](#) [20020316-G071B01LF](#) [20020327-C061B01LF](#) [29590](#) [30.652](#) [30.710](#) [30.754](#) [30.757](#) [32.058](#)