

注：本板为禁止运输、复制、编辑文件，以及用其内容进行交流

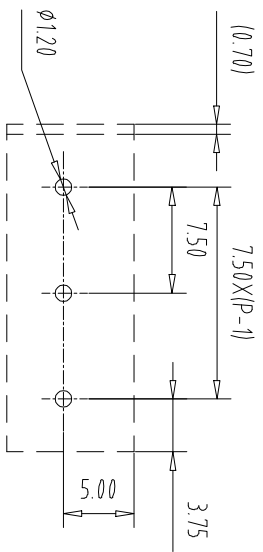
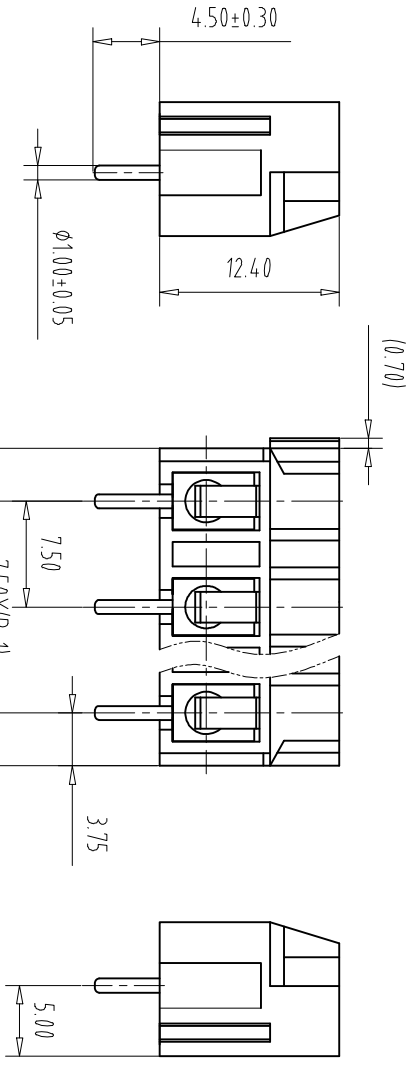
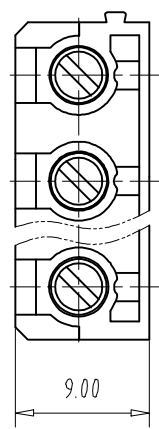

PCB Layout

Pitch	Range	In	Nominal Dimension	Range
mm	Over 6 TO 10	Over 10 TO 24	Over 30 TO 60 TO 100 TO 150	Over 150 TO 150
	±0.15	±0.20	±0.30	±0.50
			±0.70	±1.00
				±1.30
				±2°

REV	ECN NO.	CONTENT	CHK	DATE

NOTES1:
UL Standard

Use group	B	C	D
Rated Current	15A	/	10A
Rated Voltage	300V	/	300V

- 2 withstanding voltage: AC2500V/1Min
- 3.Torque value: M3, 4.43Lb.in
- 4.Wire range: 22~14AWG

IEC Standard

Pollution Degree	3	2	2
Overvoltage Category	III	II	II
Rate Impulse Voltage(KV)	/	/	/
Rate Voltage(V)	/	250V	/
Rate Current(A)	/	15A	/

2. Torque value: M3, 0.5Nm
- 3.wire range: 1.0~2.5mm²

- NOTES2:
- 1.Housing: PA66(UL94V-0)
 - 2.Solder Pin: Copper alloy(Sn Plated)
 - 3.Spring: Stainless Steel
 - 4.Screw: Steel(M3,Zn Plated)

- NOTES3:
- 1.Pitch: 7.5mm Poles: 02-24P
 - 2.Stripping length: 6-8mm
 - 3.Operating temperature: -40℃~+105℃
 - 4.RoHS Compliance

How to order

MX360 - 7.5 - XXP - XXXX - XX - X - X - X

产品型号 间距 颜色 极数

颜色: 01:常规颜色
灰色:GY 蓝色:BU 黑色:BK 透明色:TT
红色:RD 黄色:YW 绿色:GN 白色:WE
蓝色:BU 透明色:TT
红色:RD 黄色:YW
黑色:BK 透明色:TT
绿色:GN 白色:WE

0-Y一字螺丝
A-Z其他定制
1-S十字螺丝
2-P.S平头十字螺丝
Cu:轴方块 Fe:轴方块

ITEM	NAME OF PART	NO. OF PART	Q'TY	MATERIAL	NOTE
DWG	CHK	DATE	UNITS	MM	SHEET/OF 1/1
APP	DATE	SCALE	SCALE	A4	1:1
	DATE	NAME			
		MX360-7.5-XXP			

CIXI MAIXU ELECTRONICS CO.,LTD
慈溪市迈旭电子有限公司

DWGNO. 1

X-ON Electronics

Largest Supplier of Electrical and Electronic Components

Click to view similar products for [Fixed Terminal Blocks](#) category:

Click to view products by [MAX](#) manufacturer:

Other Similar products are found below :

[MBE-1512](#) [MBE-1520](#) [MBE-154](#) [MBE-156](#) [MBES-156](#) [MH-2512](#) [MHE-132](#) [MHE-163](#) [MI-254 \(35\)](#) [MI-272](#) [MPT-275](#) [15602-04-08-21](#)
[ELM023100](#) [ELM10110G](#) [BA311TU](#) [BA411SU](#) [MV-254-D](#) [MV-255](#) [MV-493](#) [MVE-252](#) [MVE-253](#) [MVEB-153](#) [1705142](#) [1712417](#)
[1713088](#) [1745195](#) [1760594](#) [1-796689-8](#) [1800114](#) [20020314-C121B01LF](#) [KP03215000J0G](#) [KP04215000J0G](#) [S451](#) [29.007](#) [29.116](#) [30.204](#)
[30.503](#) [30.756](#) [30.853](#) [9872-0-00-15-00-00-33-0](#) [996750](#) [1710052](#) [1777707](#) [1-796692-3](#) [20020316-G071B01LF](#) [20020327-C061B01LF](#)
[29590](#) [30.652](#) [30.710](#) [30.754](#)