



■ Features :

- Wall-mount and control panel acceptable
- Built-in ON/OFF button
- Digital meters for battery level, output load level, and operating status on remote control panel
- LED indicators for remote ON/OFF, abnormal and power saving mode
- Remote panel with 10FT cable length, optional for 25FT or 50FT
- Connect directly to the remote socket of inverter, no power supply needed
- 3 years warranty

■ Description : IRC1 / IRC2 / IRC3 is the monitoring and control unit used for the inverter series. It can decode the RS-232 signal sent by inverter series and display through digital meters. IRC1 / IRC2 / IRC3 can also turn ON/OFF of inverter remotely that make the basic control more easily.



SPECIFICATION

MODEL		IRC1	IRC2	IRC3
OUTPUT	DIGITAL METER	-----	Display the battery level, output load level, and operating status of inverter unit	
	CONTROL OUTPUT	Remote ON/OFF for inverter unit		
	LED INDICATOR	Remote turn ON(Green) ; Remote turn Off(Orange) ; Abnormal (Red) ; Saving mode (Orange flash)		
FUNCTION	REMOTE ON/OFF CONTROL	The controlled inverter unit can be turned ON/OFF on the remote control panel for IRC1 / IRC2 / IRC3		
	POWER SAVING CONTROL	Power saving enable / disable activation		
	SUITABLE SERIES	TS-700 / 1000 / 1500 / 3000 ; TN-1500 / 3000	TS-700 / 1000 / 1500 / 3000	TN-1500 / 3000
ENVIRONMENT	WORKING TEMP.	-20 ~ +50°C		
	WORKING HUMIDITY	20 ~ 90% RH non-condensing		
	STORAGE TEMP., HUMIDITY	-40 ~ +85°C, 10 ~ 95% RH		
	VIBRATION	10 ~ 500Hz, 2G 10min./1cycle, 60min. each along X, Y, Z axes		
EMC	EMC EMISSION	Compliance to EN55022 class A, EN61000-3-2,3, FCC PART 15 class A		
	EMC IMMUNITY	Compliance to EN61000-4-2,3,4,6,8		
OTHERS	DIMENSION	75*55*21mm (L*W*H)		
	PACKING	0.26Kg; 24pcs/7.3Kg/1.75CUFT		
NOTE	1. The remote control can not re-power on for inverter at abnormal status.			

■ Mechanical Specification

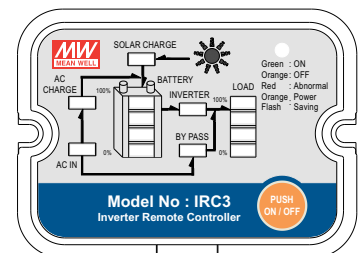
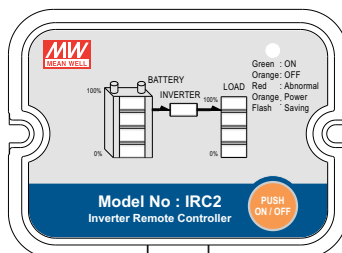
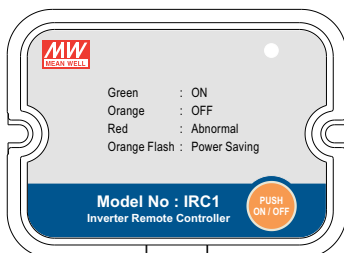
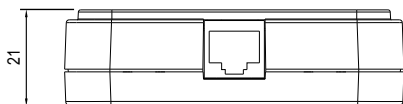
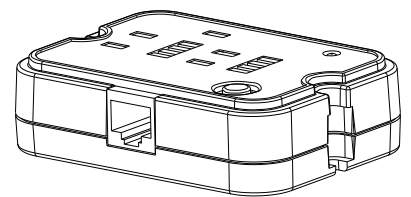
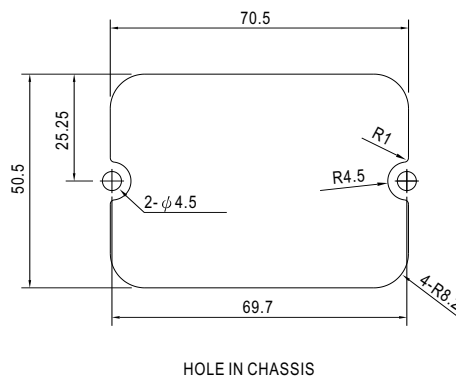
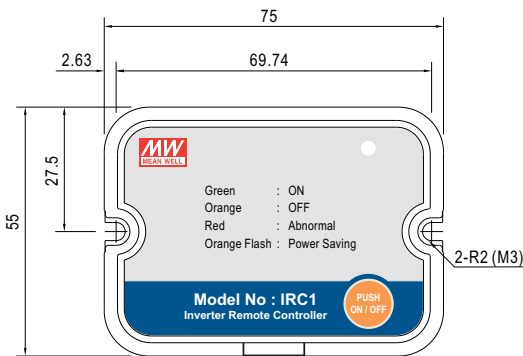

X-ON Electronics

Largest Supplier of Electrical and Electronic Components

Click to view similar products for [Power Inverters](#) category:

Click to view products by [Mean Well](#) manufacturer:

Other Similar products are found below :

[PV-400FC](#) [PV550](#) [3SIR400012](#) [IPS-900 24V/230V](#) [SINUS600 24V](#) [PE-35](#) [PE-40](#) [PS-250](#) [TS-1500-224B](#) [TS-1000-224B](#) [TS400-224B](#) [TN-1500-248B](#) [IPS-1000S 12V/230V ECO MODE](#) [IPS-1200S 24V/230V ECO MODE](#) [IPS-4000S 12V/230V ECO MODE](#) [IPS-5000S 24V/230V ECO MODE](#) [IPS-800U 12V/230V](#) [3IPS030024](#) [3IPS40012](#) [3IPS40024](#) [3IPS050012](#) [3SP091512E](#) [3IPS050024](#) [3IPS100024](#) [3IPS500012](#) [3IPS500024](#) [3IPS651012](#) [3IPS651024](#) [3IPS912246](#) [3IPS912249](#) [3SIP500012](#) [3SIP500024](#) [3SIR400024](#) [RED-16 24/12V 16A](#) [RED-6 24/12V 6A](#) [DC 200 24/12V 15A VER. 2](#) [DC-400 24/12V 30A](#) [DC PRO 400 24/12V 30A](#) [DC-600 24/12V 40A](#) [DC PRO 600 24/12V 45A](#) [3ZHP1LED34](#) [3SIP300012](#) [3SIP400012](#) [3SIP400024](#) [3SIR150012](#) [3SIR150024](#) [3SIR300012](#) [3SIR300024](#) [IPS500 PLUS 12V](#) [RV-16](#)