

## 1. Features

- Low profile
- Magnetic shielded
- SMT type, suitable for reflow soldering.



## 2. APPLICATIONS

- Portable communication equipment
- Notebook Computer
- DC/DC converters etc.

## 3. PRODUCT IDENTIFICATION

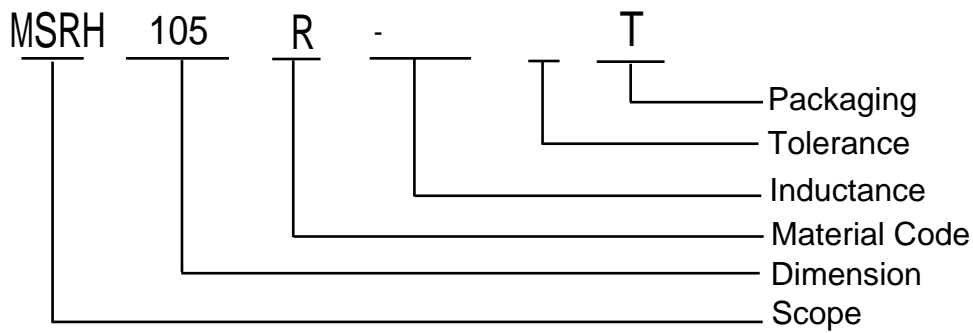

## 4. Shape and Dimensions

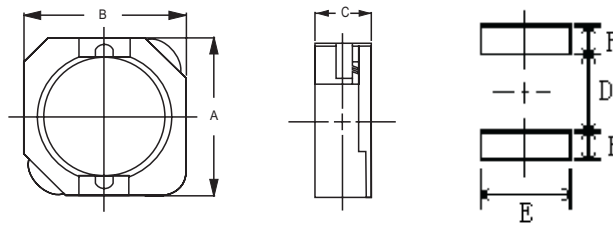

Unit: mm

Part	A	B	C	D	E	F
MSRH105R	10.2±0.3	10.0±0.3	5.0MAX	7.8	3.0	1.2

**Appendix A: Electrical Characteristics**
**I. MSRH105R TYPE INDUCTORS ELECTRICAL CHARACTERISTICS&TEST CONDITIONS**

Part Number	L (μH)	Tolerance	Test Freq.	DCR(Ω)Max	Isat(A)
MSRH105R-100MT	10	±20%	1kHz,0.25v	0.026	5.35
MSRH105R-120MT	12	±20%	1kHz,0.25v	0.033	4.50
MSRH105R-150MT	15	±20%	1kHz,0.25v	0.041	4.15
MSRH105R-180MT	18	±20%	1kHz,0.25v	0.046	3.85
MSRH105R-220MT	22	±20%	1kHz,0.25v	0.061	3.60
MSRH105R-270MT	27	±20%	1kHz,0.25v	0.069	3.25
MSRH105R-330MT	33	±20%	1kHz,0.25v	0.084	2.95
MSRH105R-470MT	47	±20%	1kHz,0.25v	0.130	2.38
MSRH105R-680MT	68	±20%	1kHz,0.25v	0.201	1.90
MSRH105R-820MT	82	±20%	1kHz,0.25v	0.227	1.75
MSRH105R-101MT	100	±20%	1kHz,0.25v	0.253	1.61
MSRH105R-151MT	150	±20%	1kHz,0.25v	0.370	1.39
MSRH105R-181MT	180	±20%	1kHz,0.25v	0.419	1.24
MSRH105R-221MT	220	±20%	1kHz,0.25v	0.500	1.17
MSRH105R-271MT	270	±20%	1kHz,0.25v	0.672	0.97
MSRH105R-331MT	330	±20%	1kHz,0.25v	0.812	0.89
MSRH105R-471MT	470	±20%	1kHz,0.25v	1.289	0.77
MSRH105R-102MT	1000	±20%	1kHz,0.25v	1.989	0.56

Products with other electrical characteristic can be provided upon customer's request. Please contact your local sales.

## X-ON Electronics

Largest Supplier of Electrical and Electronic Components

*Click to view similar products for [Fixed Inductors](#) category:*

*Click to view products by [MetalLions](#) manufacturer:*

Other Similar products are found below :

[CR32NP-100KC](#) [70F224AI](#) [MHQ1005P10NJ](#) [MHQ1005P1N0S](#) [MHQ1005P2N4S](#) [MHQ1005P3N6S](#) [MHQ1005P5N1S](#) [MHQ1005P8N2J](#)  
[PE-53601NL](#) [PE-53602NL](#) [PG0936.113NLT](#) [9220-20](#) [9310-16](#) [PM06-2N7](#) [PM06-39NJ](#) [A01TK](#) [1206CS-471XJ](#) [HC2-R47-R](#) [HC8-1R2-R](#)  
[HCF1305-3R3-R](#) [1206CS-151XG](#) [RCH664NP-4R7M](#) [RCP1317NP-391L](#) [DH2280-4R7M](#) [DS1608C-106](#) [B10TJ](#) [B82498B3101J000](#) [ELJ-](#)  
[RE27NJF2](#) [1812CS-153XJ](#) [1812CS-183XJ](#) [1812CS-223XJ](#) [1812LS-104XJ](#) [1812LS-105XJ](#) [1812LS-124XJ](#) [1812LS-154XJ](#) [1812LS-223XJ](#)  
[1812LS-224XJ](#) [1812LS-563XJ](#) [1812LS-683XJ](#) [1812LS-824XJ](#) [NIN-FB101JTR110F](#) [NIN-FB471JTR62F](#) [NIN-FC1R5JTR220F](#) [NIN-](#)  
[HCR15JTRF](#) [NIN-HCR33JTRF](#) [NIN-HDR22JTRF](#) [NIN-HDR82JTRF](#) [NIN-HK2N7STRF](#) [NIN-PA150KTR370F](#) [NIN-PB100KTR550F](#)