

SPECIFICATIONS

Customer : _____

Customer P/N: MSRH-R Series

Drawing No : _____

Quantity : 0 Pcs. Date : 2017/09/26

Meled P/N : MSRH-R Series/参照

SPECIFICATION	
ACCEPTED BY:	
COMPONENT ENGINEER	
ELECTRICAL ENGINEER	
MECHANICAL ENGINEER	
APPROVED	
REJECTED	

For Customer approval Only

Qualification Status: Full Restricted Rejected

Approved By	Verified By	Re-checked By	Checked By

Comments: _____

Meled Electronics Co., Ltd.

www.meledinc.com

Version change history

Rev.	Effective Date	Changed Contents	Change Reasons	Approved By
01	/	New release	/	/

1. Features

- Low profile
- Magnetic shielded
- SMT type, suitable for reflow soldering.



2. APPLICATIONS

- Portable communication equipment
- Notebook Computer
- DC/DC converters etc.

3. PRODUCT IDENTIFICATION

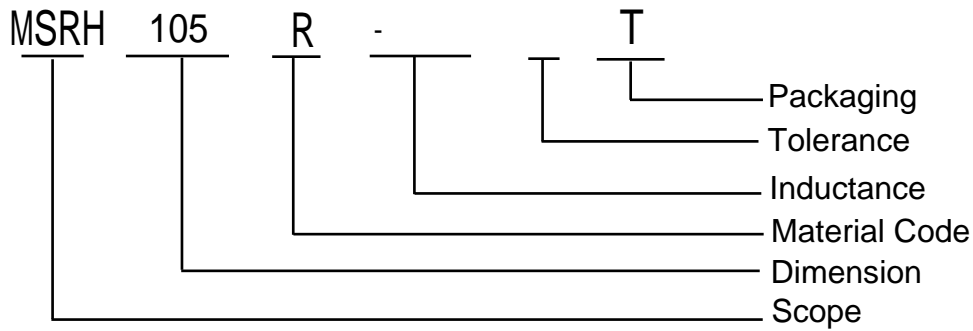

4. Shape and Dimensions

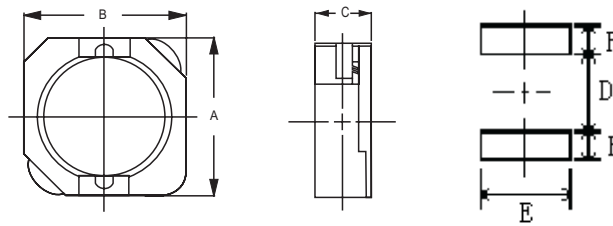

Unit: mm

Part	A	B	C	D	E	F
MSRH105R	10.2±0.3	10.0±0.3	5.0MAX	7.8	3.0	1.2

Appendix A: Electrical Characteristics

I. MSR105R TYPE INDUCTORS ELECTRICAL CHARACTERISTICS&TEST CONDITIONS

Meled PT/NO.	Inductance L(μH)	Percent Tolerance	Test Frequency	Resistance RDC(Ω)Max.	Rated DC Current		Marking
					IDC1(A)	IDC2(A)	
MSRH105R-1R5□T	1.5	N	100kHz/0.25V	5.8m	10.5	8.30	1R5
MSRH105R-2R2□T	2.2	M,N	100kHz/0.25V	7.2m	9.25	7.50	2R2
MSRH105R-3R3□T	3.3	N	100kHz/0.25V	10.4m	7.80	6.50	3R3
MSRH105R-4R7□T	4.7	M,N	100kHz/0.25V	12.3m	6.40	6.10	4R7
MSRH105R-6R8□T	6.8	N	100kHz/0.25V	18m	5.40	5.40	6R8
MSRH105R-8R2□T	8.2	M,N	100kHz/0.25V	20m	4.85	5.00	8R2

※ □ specify the inductance tolerance, K(±10%), M(±20%), N(±30%)

※ IDC1 : Based on inductance change (ΔL/Lo : ≤ drop 35%) @ambient temperature 25°C

IDC2 : Based on temperature rise (ΔT : 40°C TYP.)

Rated DC Current : The less value which is IDC1 or IDC2.

Operate temperature range: -40°C ~ +125°C (Including self temp. rise)

Products with other electrical characteristic can be provided upon customer's request. Please contact your local sales.

X-ON Electronics

Largest Supplier of Electrical and Electronic Components

Click to view similar products for [Fixed Inductors](#) category:

Click to view products by [MetalLions](#) manufacturer:

Other Similar products are found below :

[CR32NP-100KC](#) [70F224AI](#) [MHQ1005P10NJ](#) [MHQ1005P1N0S](#) [MHQ1005P2N4S](#) [MHQ1005P3N6S](#) [MHQ1005P5N1S](#) [MHQ1005P8N2J](#)
[PE-53601NL](#) [PE-53602NL](#) [PG0936.113NLT](#) [9220-20](#) [9310-16](#) [PM06-2N7](#) [PM06-39NJ](#) [A01TK](#) [1206CS-471XJ](#) [HC2-R47-R](#) [HC8-1R2-R](#)
[HCF1305-3R3-R](#) [1206CS-151XG](#) [RCH664NP-4R7M](#) [RCP1317NP-391L](#) [DH2280-4R7M](#) [DS1608C-106](#) [B10TJ](#) [B82498B3101J000](#) [ELJ-](#)
[RE27NJF2](#) [1812CS-153XJ](#) [1812CS-183XJ](#) [1812CS-223XJ](#) [1812LS-104XJ](#) [1812LS-105XJ](#) [1812LS-124XJ](#) [1812LS-154XJ](#) [1812LS-223XJ](#)
[1812LS-224XJ](#) [1812LS-563XJ](#) [1812LS-683XJ](#) [1812LS-824XJ](#) [NIN-FB101JTR110F](#) [NIN-FB471JTR62F](#) [NIN-FC1R5JTR220F](#) [NIN-](#)
[HCR15JTRF](#) [NIN-HCR33JTRF](#) [NIN-HDR22JTRF](#) [NIN-HDR82JTRF](#) [NIN-HK2N7STRF](#) [NIN-PA150KTR370F](#) [NIN-PB100KTR550F](#)