

# Data Sheet

## PT094xxHBBN

Page 1/5

P/N

313821xx

xx=number of poles

2014/01/27

### Illustration

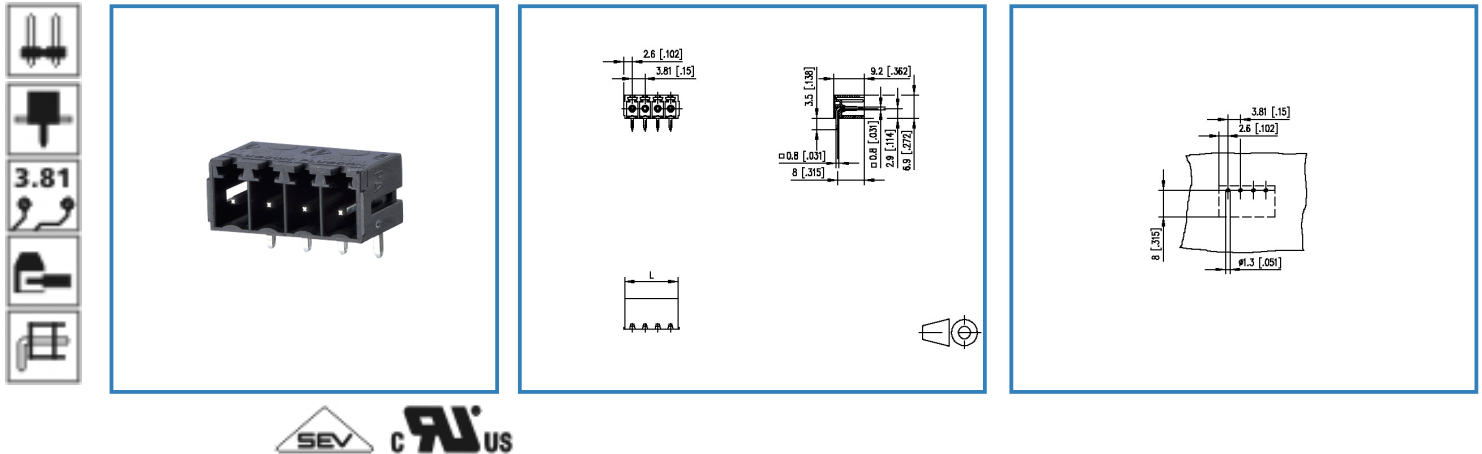

see enlarged drawing at the end of the document

### Product specification

- pin header, solderable
- centerline 3.81 mm, direction of connection 90°
- closed ends
- color black
- codeable
- Connection data

**cRUUS** V / A 300 / 8

**SEV** 9 A / 160 V / 2.5 kV / 3 / IEC 61984

# Data Sheet

## PT094xxHBBN

Page 2/5

P/N

313821xx

xx=number of poles



2014/01/27

### Technical Data

#### General Data

|                           |         |       |        |
|---------------------------|---------|-------|--------|
| Solder pin length         | 3.5 mm  |       |        |
| min. number of poles      | 2       |       |        |
| max. number of poles      | 24      |       |        |
| Insulating material class | CTI 600 |       |        |
| clearance/creepage dist.  | 3.01 mm |       |        |
| protection category       | IP 00   |       |        |
| Overvoltage category      | III     | III   | II     |
| Pollution degree          | 3       | 2     | 2      |
| Rated voltage             | 200 V   | 500 V | 500 V  |
| Rated test voltage        | 4.0 kV  | 4 kV  | 4.0 kV |

#### Connection data

|  |                                      |
|--|--------------------------------------|
|  V / A | 300 / 8                              |
|        | 9 A / 160 V / 2.5 kV / 3 / IEC 61984 |

#### Material

|                      |         |
|----------------------|---------|
| insulating material  | PA66    |
| flammability class   | V0      |
| contact pin material | CuFe    |
| contact pin surface  | Ni + Sn |

#### Climatic properties

|                         |        |
|-------------------------|--------|
| upper limit temperature | 105 °C |
| lower limit temperature | -40 °C |

#### General

|               |                                     |
|---------------|-------------------------------------|
| solderability | Acc. to JEDEC JESD22-B102E 245°C/5s |
| Tolerance     | ISO 2768 -mH                        |

# Data Sheet

## PT094xxHBBN

Page 3/5

P/N

313821xx

xx=number of poles

2014/01/27

### Matching Part to

| P/N    | Product name        |
|--------|---------------------|
| 311131 | RP034xxHBLO Typ 113 |
| 311141 | RP034xxHBLN Typ 114 |
| 313691 | RP034xxVBLN Typ 369 |
| ASP064 | SP064xxVGNN ASP064  |

### Accessories

| P/N         | Product name |
|-------------|--------------|
| 720293-01-2 | 720293       |

# Data Sheet

## PT094xxHBBN

Page 4/5

P/N

313821xx

xx=number of poles

2014/01/27

### Illustration

Drawing

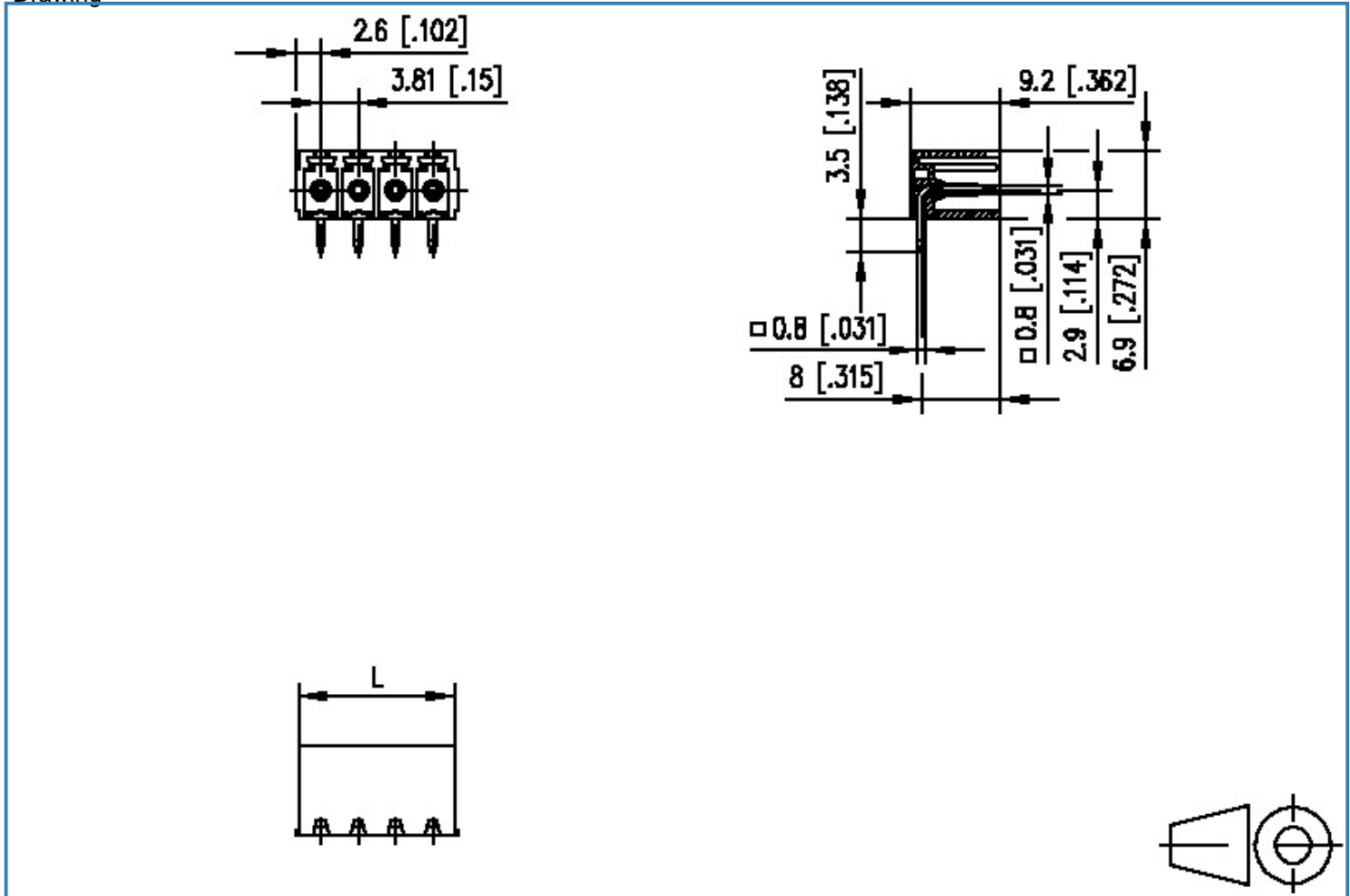

$L = (\text{pole size} - 1) \times \text{centerline} + 5.2 [0.205]$



# Data Sheet

## PT094xxHBBN

Page 5/5

P/N

313821xx

xx=number of poles

2014/01/27

### PCB Layout

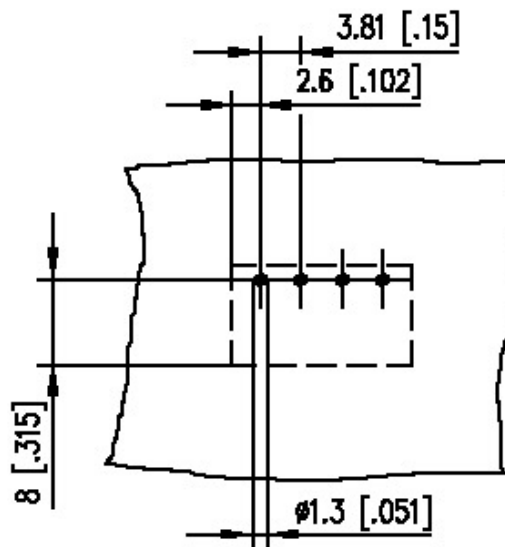

## X-ON Electronics

Largest Supplier of Electrical and Electronic Components

*Click to view similar products for [Pluggable Terminal Blocks](#) category:*

*Click to view products by [Metz](#) manufacturer:*

Other Similar products are found below :

[57.510.0053](#) [MC 1.5/ 6-ST-3.5 GY AU](#) [ET02015000J0G](#) [734-104](#) [734-302](#) [860505](#) [860516](#) [860810](#) [GBPACX-12](#) [93.731.4953.0](#) [PV05-5,08-K](#) [PVP03-3,50](#) [PVP04-3,50](#) [PVS02-5,00](#) [1-1986160-3](#) [1377680000](#) [1531000000](#) [1546228-5](#) [ELFP03110](#) [ELFT07250](#) [ELVD12100](#) [ELVF09400](#) [ELVP03100](#) [ELXH071G0E](#) [1700101](#) [1700410](#) [1702246](#) [1705229](#) [1710175](#) [1714537](#) [1717806](#) [1719600](#) [1728941](#) [1734692](#) [1734795](#) [1740291](#) [1740628](#) [1740990](#) [1746952](#) [1750207](#) [1752865](#) [1754115](#) [1754144](#) [1756913](#) [1760051](#) [1760336](#) [1765111](#) [1776388](#) [1777701](#) [1783410](#)