

Data Sheet

SP025xxHDNC

Illustration

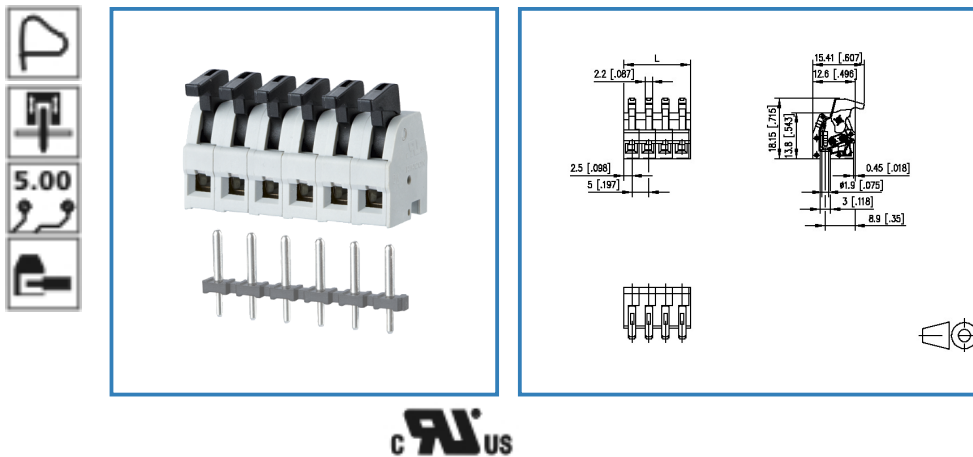

see enlarged drawing at the end of the document

Product specification

- spring clamp terminal block, Stecker
- centerline 5.00 mm, direction of connection 90°
- fittable without loss of poles
- color gray
- eccentric lever, wire entry perpendicular to plug direction

© 2017 METZ CONNECT - Technische Änderungen vorbehalten! Subject to modifications! Sous réserve de modifications techniques!



Data Sheet

SP025xxHDNC

Page 2/5

P/N

ASP025xx

xx=number of poles

2017/08/28

Technical Data

General Data

min. number of poles	2		
max. number of poles	24		
Insulating material class	CTI 400		
clearance/creepage dist.	3.7 mm		
protection category	IP 20		
Overvoltage category	III	III	II
Pollution degree	3	2	2
Rated voltage	32.0 V	200.0 V	200.0 V
Rated test voltage	1.5 kV	1.5 kV	1.5 kV

Connection data

Rated wiring solid wire	0.08 - 1.5 mm ² / AWG 28 - 16
Rated wiring stranded wire	0.08 - 0.75 mm ² / AWG 28 - 18

Approvals

 V / A / AWG	300 / 8 / 28 - 16
0.08 - 1.5 mm ²	10 A / 250 V / 4 kV / 3 /

Material

insulating material	PA46
flammability class	V0
spring material	Spring steel
contact material	CuSn
Glow-Wire Flammability GWFI	-
Glow-Wire Flammability GWIT	-
contact surface	Sn

Climatic properties

upper limit temperature	105 °C
lower limit temperature	-40 °C

General

Tolerance	ISO 2768 -mH
-----------	--------------



Data Sheet

SP025xxHDNC



Data Sheet

SP025xxHDNC

Page 4/5

P/N

ASP025xx

xx=number of poles

2017/08/28

Matching Part

P/N	Product name
310171	PR015xxVBHC Typ 017
310391	PT055xxHBHC Typ 039
310411	PT065xxVBEN Typ 041
314171	PM035xxVBHC Typ 417

Accessories

P/N	Product name
720036-01-4	720036
720036-02-2	720036



Data Sheet

SP025xxHDNC

Illustration

Drawing

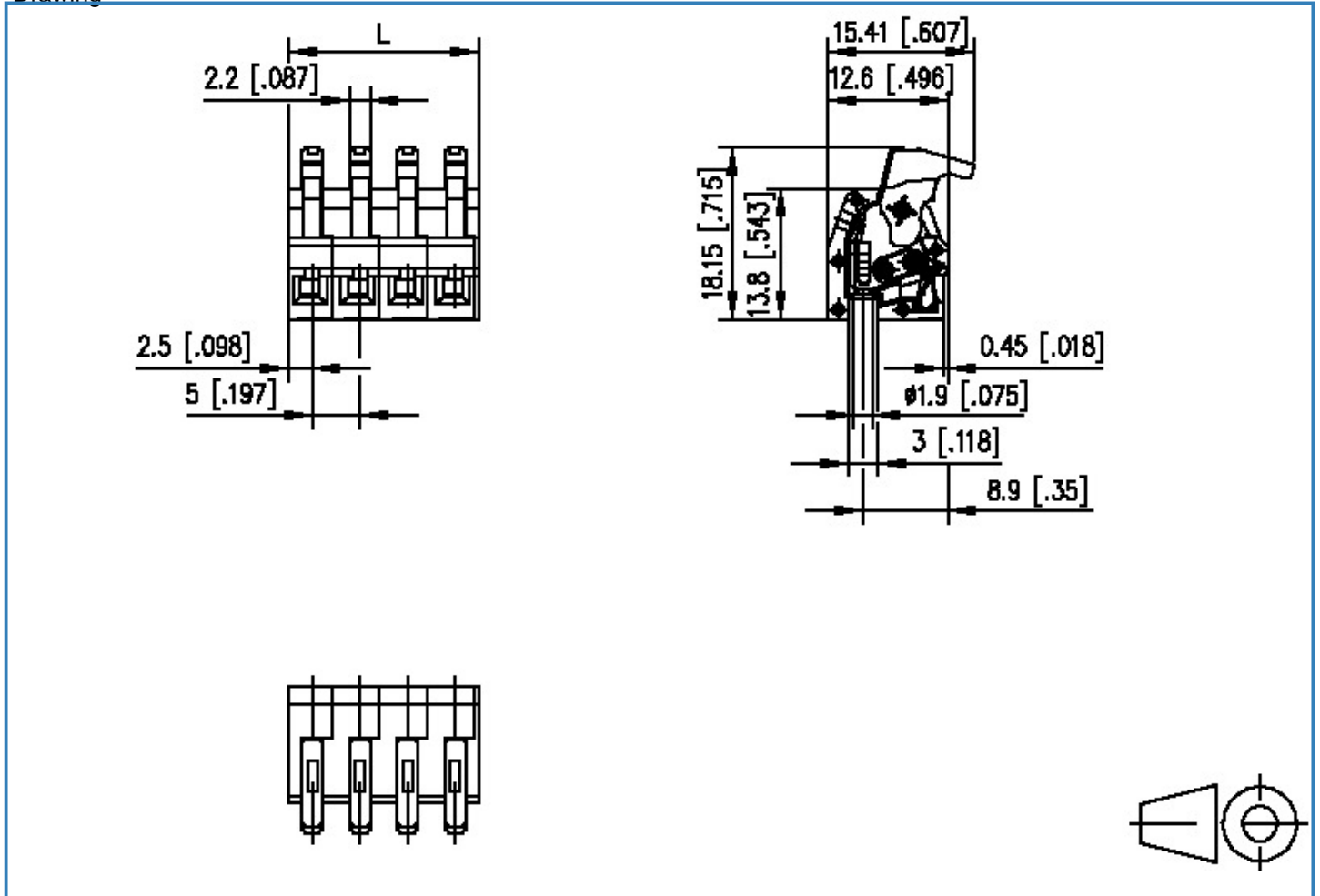

$$L = (\text{pole size} - 1) \times \text{centerline} + 5 [0.197]$$

X-ON Electronics

Largest Supplier of Electrical and Electronic Components

Click to view similar products for [metz manufacturer](#):

Other Similar products are found below :

[ASP0631006](#) [142M1D11100](#) [142M2X19020](#) [142M2X25005](#) [AST0820406](#) [1108861321](#) [1108311319](#) [1108501319](#) [11089313](#)
[142M2X1C050](#) [841ER-1.17L](#) [ASP0450401](#) [PT11608VBBN](#) [130920-E](#) [130924-E](#) [1108841319](#) [110304412004](#) [1108831326](#) [15024AD206-E](#)
[150240C30310S](#) [135015-SSC-E](#) [1528SBGT19E](#) [PR04302VBBN](#) [142M2X15010](#) [31189102](#) [11085813](#) [810-500](#) [31336104](#) [ASP0430922](#)
[AST0450504](#) [AST1350604](#) [SP06502VBNF](#) [31072103](#) [SP02512HDNC](#) [142M1D19020](#) [31251104](#) [31359104](#) [834B-375ML](#) [832WC-3L](#)
[31009105](#) [31020205](#) [31024102](#) [31027103](#) [ASP0251204](#) [PR01503VBVC](#) [PT11504HBBF](#) [RP01505WBWC](#) [130922-03-E](#) [150240C30610E](#)
[11027605](#)