

TECHNICAL SPECIFICATIONS

Material: UL 94 V-0 Plastic Material
Operating Temperature: -55°C to +110°C
Cable Entry: Top Entry
Cable O.D: Up to 9mm
Colour: Black
Jackscrew: UNC 4-40
 Male or Female Version

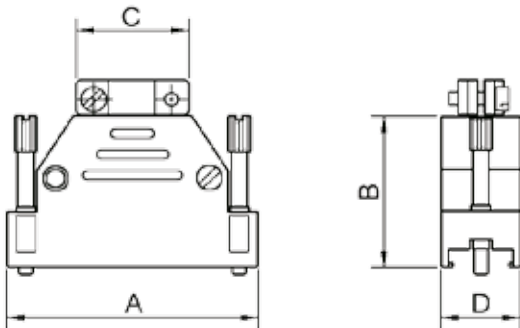
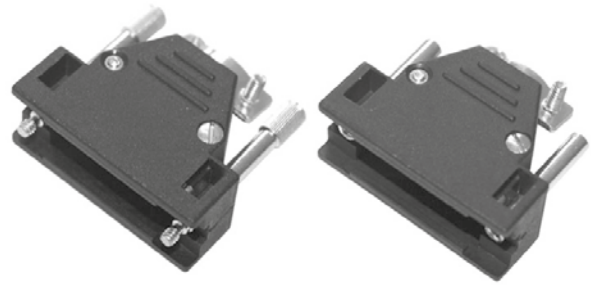

Features:

- Suitable for sizes 9, 15, 25 and 37
- Easy to re-open
- Male or female Jackscrew

Size	A	B	C	D	E
9	31,4	24,0	14,5	38,0	18,2
15	42,0	30,0	14,5	38,0	18,2
25	55,5	36,0	25,1	38,0	18,2
37	69,8	38,0	39,2	38,0	18,2

Ordering information: Male Jackscrew

Size:	P/N - Kitted:	Product Code:
9-way, Male JS	2801-0102-01	MHED-D09T-K
15-way, Male JS	2801-0102-02	MHED-D15T-K
25-way, Male JS	2801-0102-03	MHED-D25T-K
37-way, Male JS	2801-0102-04	MHED-D37T-K

Ordering information: Female Jackscrew

Size:	P/N - Kitted:	Product Code:
9-way, Female JS	2801-0102-11	MHED-D09TF-K
15-way, Female JS	2801-0102-12	MHED-D15TF-K
25-way, Female JS	2801-0102-13	MHED-D25TF-K
37-way, Female JS	2801-0102-14	MHED-D37TF-K

X-ON Electronics

Largest Supplier of Electrical and Electronic Components

Click to view similar products for [MH Connectors](#) manufacturer:

Other Similar products are found below :

[6560-0139-12](#) [MH3101-CAT5E](#) [MHD45PK9-DB9P-K](#) [MHD45PPK25DB25PK](#) [MHD45PPK9-DB9P-K](#) [MHD45ZK15-DB15S-K](#)
[MHD45ZK25-DB25P-K](#) [MHD45ZK25-DM25P-K](#) [MHD45ZK9-DM9P-K](#) [MHDA9-PMJ8-M-K-RC](#) [MHDBC25SS-NW](#) [MHDBC37SS-NW](#)
[MHDBC9SP](#) [MHDBCTFR](#) [MHDCMR37-ULP](#) [MHDD15-F-T-B-M](#) [MHDD25-F-T-B-M](#) [MHDD25-M-T-B-S](#) [MHDD9-F-T-B-S](#)
[MHDM15SP](#) [MHDM15SS](#) [MHDPPK25-K](#) [MHDPPK9-B-K](#) [MHDPPK9-Y-K](#) [MHDPPK-M-37-K](#) [MHDTPK25-DB25S-K](#) [MHDTPK37-K](#)
[MHDTPPK25-DB25PK](#) [MHDTPPK37-K](#) [MHDTZK25-RA-PC-K](#) [MHDTZK50-K](#) [MHDVSL15-K](#) [MHHDS15-M-T-B-S](#) [MHHDS26-F-T-B-](#)
[S](#) [MHRJ114P4CR](#) [MHRJ45SRB-RET-W](#) [MHRJJ44NFV](#) [MHRJJ66NFRAS](#) [MHRJJ88NFRA](#) [MHTRI-37-M-K](#) [GA0909FFLGK-RC](#)
[GA2525MFLGK-RC](#) [GA2525MMLGK-RC](#) [GA0909MFLGK-RC](#) [GA2525FFLGK-RC](#) [2801-0102-02](#) [2801-0102-12-8](#) [MDS15S](#) [MH3101S-](#)
[CAT6](#) [MHDA9-SMJ8-M-K-RC](#)