

ROHS COMPLIANT

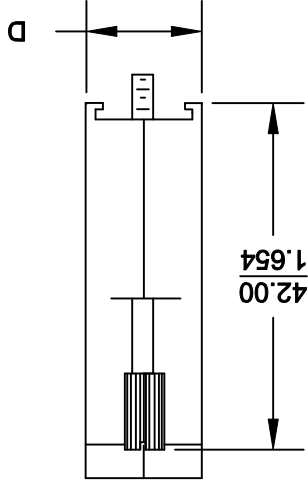

MH CONNECTORS LTD.

PLASTIC: ABS POLYLAC - BLACK - UL RECOGNIZED
 JACKSCREWS: STEEL - BLACK OXIDE
 M3 HOODSCREWS: STEEL - BLACK OXIDE
 COMPRESSION INSERT: ABS UL RECOGNIZED
 M3 NUT: STEEL - BLACK OXIDE
 OPERATING TEMP: - 55°C TO + 110°C

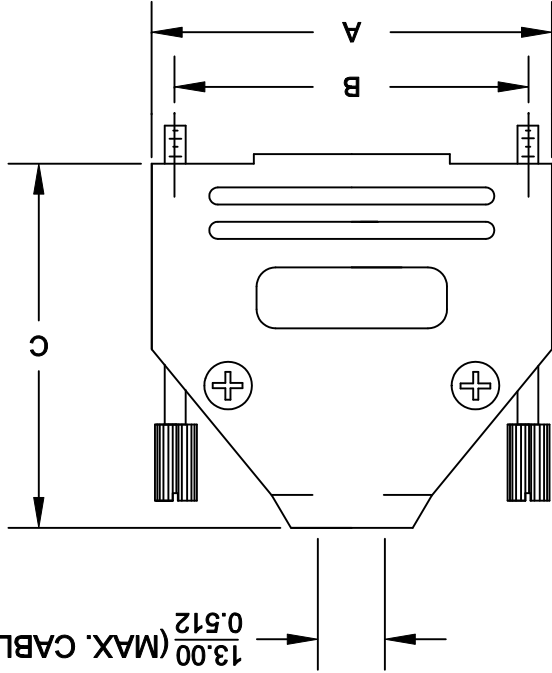

BACKSHELL KIT INCLUDES:
 (2) BACKSHELL HALVES
 (2) 4-40 THUMBSCREWS
 (2) HOUSING SCREWS/NUTS
 (1) SET OF COMPRESSION INSERTS-VARIOUS SIZES
 DIAMETERS: 4mm (.157"), 5mm (.197"), 7mm (.276"), 9mm (.354")

THESE DRAWINGS AND SPECIFICATIONS ARE THE PROPERTY OF MH CONNECTORS LTD. AND SHALL NOT BE REPRODUCED, COPIED OR USED AS THE BASIS FOR THE MANUFACTURE OR SALE OF APPARATUS WITHOUT WRITTEN PERMISSION.

DRAWN		P. JENKINS		DATE		03-14-12	
APPROVED		D. CRDFT		DATE		03-14-12	
SCALE		NTS		SHEET		OF	
REV:		1		1		A	
DRAWING No				MHDTPPK-SERIES			

SIZE:	P/N - BULK:	PRODUCT CODE:
9-WAY	6561-0108-01	MHDTPPK-9
15-WAY	6561-0108-02	MHDTPPK-15
25-WAY	6561-0108-03	MHDTPPK-25
37-WAY	6561-0108-04	MHDTPPK-37

SIZE:	P/N - KITTED:	PRODUCT CODE:
9-WAY	6560-0108-01	MHDTPPK-9-K
15-WAY	6560-0108-02	MHDTPPK-15-K
25-WAY	6560-0108-03	MHDTPPK-25-K
37-WAY	6560-0108-04	MHDTPPK-37-K

ORDERING INFORMATION:

SIZE	DIMENSIONS (mm/in)		
	A ±.25	B ±.005	C ±.010
9	31.20	24.99	39.90
	1.228	0.984	1.571
	0.590	0.590	0.590
15	39.50	33.32	41.50
	1.555	1.312	1.634
	0.590	0.590	0.590
25	53.40	47.04	48.60
	2.102	1.852	1.913
	0.590	0.590	0.590
37	69.70	63.50	53.60
	2.744	2.500	2.110
	0.590	0.590	0.590

X-ON Electronics

Largest Supplier of Electrical and Electronic Components

Click to view similar products for [D-Sub High Density Connectors](#) category:

Click to view products by [MH Connectors](#) manufacturer:

Other Similar products are found below :

[1484349-1](#) [163A16769X](#) [163A16809X](#) [163A17089X](#) [164A17199X](#) [164A17209X](#) [164A17479X](#) [164A18209X](#) [17BH-044S-AA110](#) [K86X-AD-26S](#) [KF66X-A26P-NJ](#) [KF66X-E15P-N](#) [241A17320X](#) [242A18390X](#) [242A25740X](#) [L717HDB44POL2R210](#) [L717HDCH62POL2RM5](#) [L717HDEH15POL2](#) [L777HDE15P](#) [L77HDC62S](#) [L77HDE15SC309](#) [163A16779X](#) [163A16839X](#) [163A17049X](#) [163A17079X](#) [164A17309X](#) [164A17329X](#) [164A18219X](#) [241A16440X](#) [241A16550X](#) [241A16680X](#) [241A17390X](#) [241A20810X](#) [241A25740X](#) [CT25-44P](#) [K66X-E15S-N30](#) [K86X-BA-44S](#) [K86X-ED-15S-BR15](#) [K86X-ED-15SK](#) [L177HDE15SOL2RM23](#) [L177HRC62S](#) [L177HRC62SVFM](#) [L177HRCG62S](#) [L717HDBH44POL2RM5](#) [L717HDEG15POL2RM5](#) [L77HDA26SVF](#) [L77HDE15SD1CO](#) [L77HDEH15SOL2RM832](#) [DAMA-15S-WS](#)
[443895-3](#)