

WRAPOST RECEPTACLES

FOR .015" - .025" DIAMETER PINS

1702/1703

170X-X-15-XX-30-XX-02-0

Press-fit in .057 mounting hole

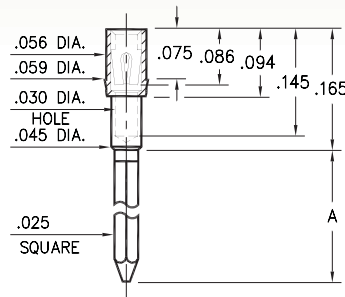

| Basic Part Number | # of Wraps | Length A |
|-------------------|------------|----------|
| 1702-2 | 2 | .370 |
| 1703-3 | 3 | .510 |

0038 ⇨ 0040/0066 ⇨ 0068

00XX-X-17-XX-30-XX-02-0

Press-fit in .057 mounting hole

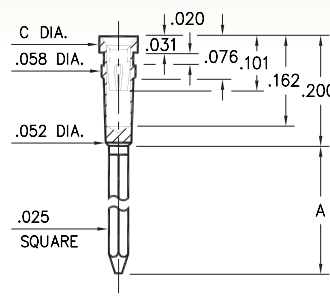

| Basic Part # | # of Wraps | Length A | Dia. C |
|--------------|------------|----------|--------|
| 0040-1 | 1 | .260 | .072 |
| 0039-2 | 2 | .360 | |
| 0038-3 | 3 | .500 | |
| 0068-1 | 1 | .260 | .062 |
| 0067-2 | 2 | .360 | |
| 0066-3 | 3 | .500 | |

0086/0088/0089

008X-X-17-XX-3X-XX-02-0

Press-fit in .057 mounting hole

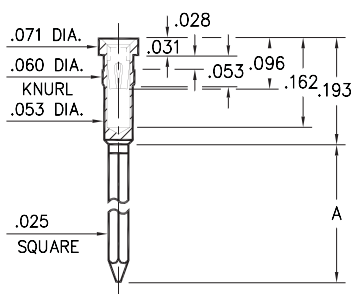

| Basic Part Number | # of Wraps | Length A |
|-------------------|------------|----------|
| 0089-2 | 2 | .370 |
| 0088-3 | 3 | .510 |
| 0086-4 | 4 | .630 |

1030 ⇨ 1036

103X-X-17-XX-3X-XX-02-0

Press-fit in .057 mounting hole

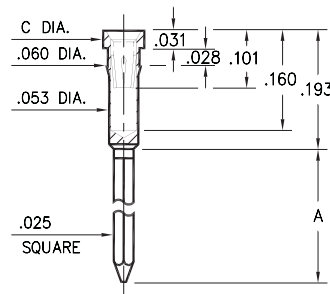

| Basic Part # | # of Wraps | Length A | Dia. C |
|--------------|------------|----------|--------|
| 1032-1 | 1 | .260 | .072 |
| 1031-2 | 2 | .360 | |
| 1030-3 | 3 | .510 | |
| 1036-1 | 1 | .260 | .062 |
| 1035-2 | 2 | .360 | |
| 1034-3 | 3 | .510 | |

1045

1045-3-17-XX-30-XX-02-0

Press-fit in .043 mounting hole

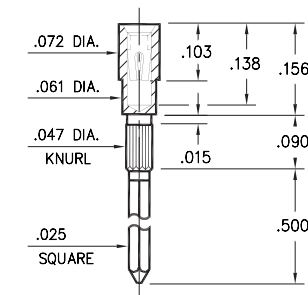

1040

1040-3-17-XX-30-XX-02-0

Press-fit in .056 mounting hole

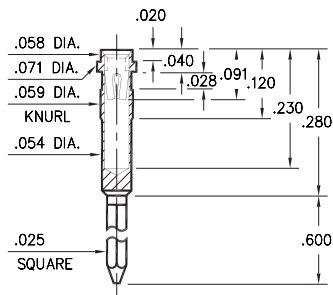

SPECIFICATIONS:

Shell Material: Brass Alloy 360, 1/2 Hard

Contact Material: Beryllium Copper Alloy 172, HT

Dimensions: Inches

Tolerances On: Lengths: ±.005

Diameters: ±.002

Angles: ±2°



ORDER CODE: XXXX - X - 17 - XX - XX - XX - 02 - 0

BASIC PART #

SPECIFY SHELL FINISH:

- 01 200 μ" TIN/LEAD OVER NICKEL
- ◆ 80 200 μ" TIN OVER NICKEL (RoHS)
- ◆ 15 10 μ" GOLD OVER NICKEL (RoHS)

SPECIFY CONTACT FINISH:

- 02 100 μ" TIN/LEAD OVER NICKEL
- ◆ 84 100 μ" TIN OVER NICKEL (RoHS)
- ◆ 27 30 μ" GOLD OVER NICKEL (RoHS)

SELECT CONTACT:

#30 or #32 CONTACT (DATA ON PAGE 253)

(For alternate contact choices, see groups B and C on page 248)



X-ON Electronics

Largest Supplier of Electrical and Electronic Components

Click to view similar products for [IC & Component Sockets](#) category:

Click to view products by [Mill-Max](#) manufacturer:

Other Similar products are found below :

[0066-3-17-15-30-14-02-0](#) [670](#) [672](#) [673](#) [694-13-640-00-672-000](#) [712-93-120-41-001000](#) [714-93-104-31-018000](#) [8059-4G1-LF](#) [807-22-001-10-001101](#) [807-22-001-10-006101](#) [807-22-001-30-011101](#) [807-22-001-30-012101](#) [807-22-001-30-013101](#) [807-22-001-30-014101](#) [8-1437531-4](#) [8150-6P10](#) [833-93-034-10-001000](#) [851-41-006-10-001000](#) [851-43-008-20-001000](#) [851-43-014-20-001000](#) [851-93-006-20-001000](#) [851-93-010-20-001000](#) [853-43-020-10-001000](#) [86.010.0053.0](#) [116-43-308-41-007000](#) [PX-68LCC](#) [121-13-318-41-001000](#) [121-13-320-41-001000](#) [121-13-308-41-001000](#) [123-43-314-41-801000](#) [123-43-420-41-001000](#) [123-87-320-41-001101](#) [122-13-316-41-001000](#) [123-13-624-41-001000](#) [123-43-306-41-001000](#) [12-3513-11](#) [123-91-320-41-001000](#) [126-43-310-41-002000](#) [AKSUN 37V-T](#) [1437503-9](#) [1437504-1](#) [146-44-308-41-013000](#) [APO-320-G-T](#) [146-43-308-41-012000](#) [160-10-308-00-001000](#) [160-40-320-00-001000](#) [214-99-306-01-670800](#) [232-1270-02-0602](#) [2-382761-4](#) [2-5331677-4](#)