

MALE PCB PINS

WRAPOST TERMINALS

1096

1096-X-05-XX-00-00-01-0

Press-fit in .057 mounting hole

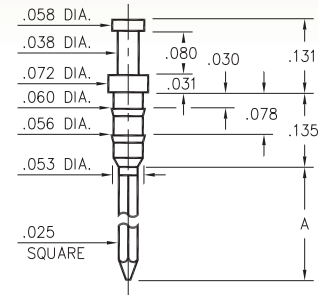

| Basic Part Number | # of Wraps | Length A |
|-------------------|------------|----------|
| 1096-2 | 2 | .381 |
| 1096-3 | 3 | .527 |

1106

1106-X-23-XX-00-00-01-0

Press-fit in .057 mounting hole

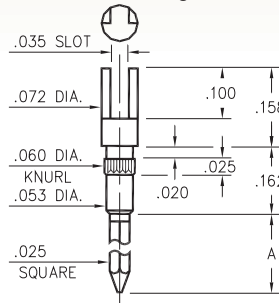

| Basic Part Number | # of Wraps | Length A |
|-------------------|------------|----------|
| 1106-2 | 2 | .370 |
| 1106-3 | 3 | .510 |

1093

1093-0-05-XX-00-00-01-0

Press-fit in .056 mounting hole

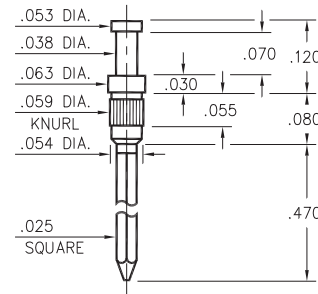

0730

0730-3-05-XX-00-00-01-0

Press-fit in .057 mounting hole

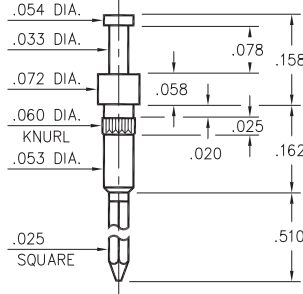

1122

1122-0-22-XX-00-00-01-0

Press-fit in .053 mounting hole

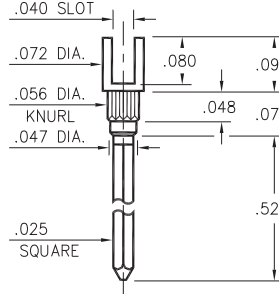

1064

1064-0-23-XX-00-00-01-0

Press-fit in .056 mounting hole

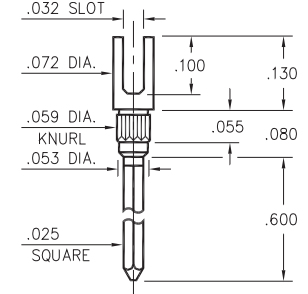

1092

1092-0-05-XX-00-00-01-0

Press-fit in .056 mounting hole

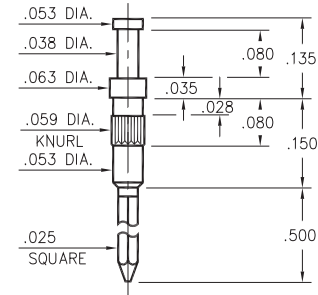

1068

1068-0-23-XX-00-00-01-0

Press-fit in .057 mounting hole

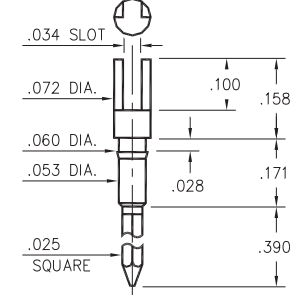

1070 → 1072

107X-X-23-XX-00-00-01-0

Press-fit in .057 mounting hole

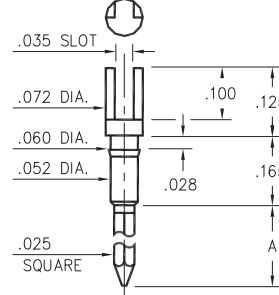

| Basic Part Number | # of Wraps | Length A |
|-------------------|------------|----------|
| 1072-1 | 1 | .260 |
| 1071-2 | 2 | .370 |
| 1070-3 | 3 | .510 |

SPECIFICATIONS:

Pin Material: Brass Alloy 360, 1/2 Hard
(Except where noted)

Dimensions: Inches

Tolerances On: Lengths: ±.005
Diameters: ±.002
Angles: ±2°



ORDER CODE: XXXX - X - XX - XX - 00 - 00 - 01 - 0

BASIC PART #

SPECIFY PIN FINISH:

- 01 200 μ" TIN/LEAD OVER NICKEL
- ◆ 80 200 μ" TIN OVER NICKEL (RoHS)
- ◆ 15 10 μ" GOLD OVER NICKEL (RoHS)
- ◆ 21 20 μ" GOLD OVER NICKEL (RoHS)



X-ON Electronics

Largest Supplier of Electrical and Electronic Components

Click to view similar products for [Circuit Board Hardware - PCB category](#):

Click to view products by [Mill-Max manufacturer](#):

Other Similar products are found below :

[8919-0-00-15-00-00-03-0](#) [0135-0-15-01-30-27-04-0](#) [5970-1-15-01-32-14-04-0](#) [0149-0-15-15-30-27-04-0](#) [MBI 1 BLUE](#) [7305-0-15-15-47-14-10-0](#) [MLN 150/1 BLACK](#) [8579-0-15-80-11-27-10-0](#) [8579-1-15-15-11-27-10-0](#) [8830-0-15-01-22-14-10-0](#) [8836-0-00-21-00-00-03-0](#) [PRUEF 2 RED](#) [9976-0-00-00-00-00-03-0](#) [PW1616](#) [1215-3-05-00-00-00-01-0](#) [1231](#) [1303-0-15-15-47-14-04-0](#) [1404-3](#) [1404-4](#) [1406-4](#) [1407-3](#) [1406-3](#) [1407-4](#) [1408-3](#) [1424-4](#) [1427-3](#) [1419-4](#) [1426-4](#) [1548-103](#) [1938-0-00-00-00-00-03-0](#) [1942-0-00-00-00-00-03-0](#) [2101-3-00-44-00-00-07-0](#) [2108-2-00-50-00-00-07-0](#) [2109-2-00-44-00-00-07-0](#) [2110-2-00-44-00-00-07-0](#) [2111-2-00-00-00-00-07-0](#) [2113-4-00-44-00-00-07-0](#) [2301-3-00-44-00-00-07-0](#) [2308-1-00-50-00-00-07-0](#) [2313-2-00-00-00-00-07-0](#) [2315-2-01-44-00-00-07-0](#) [2333-1-00-50-00-00-07-0](#) [9000-0-00-00-00-00-03-0](#) [2506-2-00-50-00-00-07-0](#) [2507-2-01-44-00-00-07-0](#) [2508-2-00-44-00-00-07-0](#) [2561-2-00-44-00-00-07-0](#) [9220](#) [9234-0-15-15-30-14-10-0](#) [LAS S G BLACK](#)