

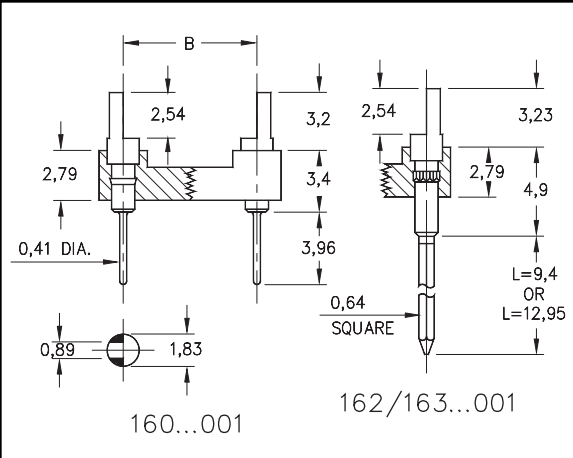

DUAL-IN-LINE SLOTTED HEADERS

Solder Tail and Wrapost Open Frame

Series 160, 162, 163



- Series 160, 162, and 163 DIL Headers are equipped with slotted heads to accept wires or component leads.
- Series 160 terminations are pluggable 0,46 dia. solder tails MM #0282, See page 183 for details. Series 162 and 163 terminations are two or three level wrapposts MM #1106. See page 195 for details.
- Insulators are high temperature thermoplastic.

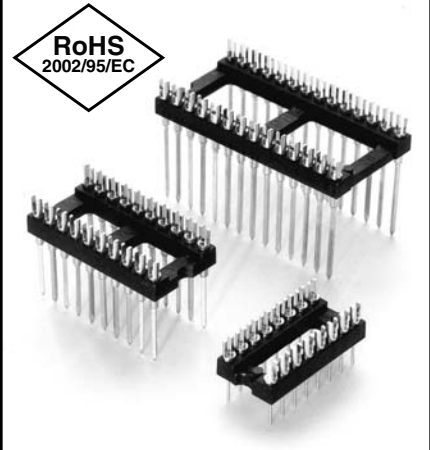

Total number of pins				Quantity per tube	Ordering Information <i>For Electrical, Mechanical & Environmental Data, See pg. 4</i> XX=Plating Code See Below		
	A	B	C		Solder Tail	2 Level Wrapost L = 9,4	3 Level Wrapost L = 12,95
10	12,6	5,08	7,6	41	160-XX-210-00-001000	162-10-210-00-001000	163-10-210-00-001000
4	5,0	7,62	10,1	102	160-XX-304-00-001000	162-10-304-00-001000	163-10-304-00-001000
6	7,6	7,62	10,1	67	160-XX-306-00-001000	162-10-306-00-001000	163-10-306-00-001000
8	10,1	7,62	10,1	50	160-XX-308-00-001000	162-10-308-00-001000	163-10-308-00-001000
10	12,6	7,62	10,1	40	160-XX-310-00-001000	162-10-310-00-001000	163-10-310-00-001000
14	17,7	7,62	10,1	28	160-XX-314-00-001000	162-10-314-00-001000	163-10-314-00-001000
16	20,3	7,62	10,1	25	160-XX-316-00-001000	162-10-316-00-001000	163-10-316-00-001000
18	22,8	7,62	10,1	22	160-XX-318-00-001000	162-10-318-00-001000	163-10-318-00-001000
20	25,3	7,62	10,1	20	160-XX-320-00-001000	162-10-320-00-001000	163-10-320-00-001000
22	27,8	7,62	10,1	18	160-XX-322-00-001000	162-10-322-00-001000	163-10-322-00-001000
24	30,4	7,62	10,1	16	160-XX-324-00-001000	162-10-324-00-001000	163-10-324-00-001000
28	35,5	7,62	10,1	14	160-XX-328-00-001000	162-10-328-00-001000	163-10-328-00-001000
20	25,4	10,16	12,7	20	160-XX-420-00-001000	162-10-420-00-001000	163-10-420-00-001000
22	27,8	10,16	12,7	18	160-XX-422-00-001000	162-10-422-00-001000	163-10-422-00-001000
24	30,4	10,16	12,7	16	160-XX-424-00-001000	162-10-424-00-001000	163-10-424-00-001000
28	35,5	10,16	12,7	14	160-XX-428-00-001000	162-10-428-00-001000	163-10-428-00-001000
32	40,6	10,16	12,7	12	160-XX-432-00-001000	162-10-432-00-001000	163-10-432-00-001000
24	30,4	15,24	17,7	16	160-XX-624-00-001000	162-10-624-00-001000	163-10-624-00-001000
28	35,5	15,24	17,7	14	160-XX-628-00-001000	162-10-628-00-001000	163-10-628-00-001000
32	40,6	15,24	17,7	12	160-XX-632-00-001000	162-10-632-00-001000	163-10-632-00-001000
36	45,7	15,24	17,7	11	160-XX-636-00-001000	162-10-636-00-001000	163-10-636-00-001000
40	50,8	15,24	17,7	10	160-XX-640-00-001000	162-10-640-00-001000	163-10-640-00-001000
42	53,3	15,24	17,7	9	160-XX-642-00-001000	162-10-642-00-001000	163-10-642-00-001000
48	60,9	15,24	17,7	8	160-XX-648-00-001000	162-10-648-00-001000	163-10-648-00-001000
50	63,5	15,24	17,7	8	160-XX-650-00-001000	162-10-650-00-001000	163-10-650-00-001000
52	66,0	15,24	17,7	7	160-XX-652-00-001000	162-10-652-00-001000	163-10-652-00-001000
50	63,5	22,86	25,3	8	160-XX-950-00-001000	162-10-950-00-001000	163-10-950-00-001000
52	66,0	22,86	25,3	7	160-XX-952-00-001000	162-10-952-00-001000	163-10-952-00-001000
64	81,2	22,86	25,3	6	160-XX-964-00-001000	162-10-964-00-001000	163-10-964-00-001000

For RoHS compliance select ◇ plating code.

SPECIFY PLATING CODE XX=	10 ◇	90	40 ◇
Pin Plating	0,25µm Au	5,08µm Sn/Pb	5,08µm Sn

X-ON Electronics

Largest Supplier of Electrical and Electronic Components

Click to view similar products for [IC & Component Sockets](#) category:

Click to view products by [Mill-Max](#) manufacturer:

Other Similar products are found below :

[0066-3-17-15-30-14-02-0](#) [670](#) [672](#) [673](#) [694-13-640-00-672-000](#) [712-93-120-41-001000](#) [714-93-104-31-018000](#) [8059-4G1-LF](#) [807-22-001-10-001101](#) [807-22-001-10-006101](#) [807-22-001-30-011101](#) [807-22-001-30-012101](#) [807-22-001-30-013101](#) [807-22-001-30-014101](#) [8-1437531-4](#) [8150-6P10](#) [833-93-034-10-001000](#) [851-41-006-10-001000](#) [851-43-008-20-001000](#) [851-43-014-20-001000](#) [851-93-006-20-001000](#) [851-93-010-20-001000](#) [853-43-020-10-001000](#) [86.010.0053.0](#) [116-43-308-41-007000](#) [PX-68LCC](#) [121-13-318-41-001000](#) [121-13-320-41-001000](#) [121-13-308-41-001000](#) [123-43-314-41-801000](#) [123-43-420-41-001000](#) [123-87-320-41-001101](#) [122-13-316-41-001000](#) [123-13-624-41-001000](#) [123-43-306-41-001000](#) [12-3513-11](#) [123-91-320-41-001000](#) [126-43-310-41-002000](#) [AKSUN 37V-T](#) [1437503-9](#) [1437504-1](#) [146-44-308-41-013000](#) [APO-320-G-T](#) [146-43-308-41-012000](#) [160-10-308-00-001000](#) [160-40-320-00-001000](#) [214-99-306-01-670800](#) [232-1270-02-0602](#) [2-382761-4](#) [2-5331677-4](#)