

# INTERCONNECTS

## SERIES 310, 330, 351 • 2,54 GRID (0,46 DIA. PINS), SURFACE MOUNT HEADERS AND SOCKETS • SINGLE ROW STRIPS

### Mates with Series 310...023 Surface Mount Z-Bend Socket (See Fig. 3)

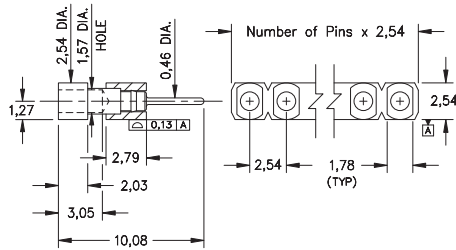

Coplanarity 0,13. For pin counts >10 positions, consult Technical Support.

**FIG. 1**

### Mates with Series 310...023 Surface Mount Z-Bend Socket (See Fig. 3)

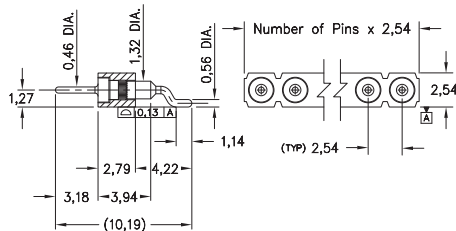

Coplanarity 0,13. For pin counts >10 positions, consult Technical Support.

**FIG. 2**

### Mates with Series 351...002 and 330...027 Surface Mount Header (See Fig. 1 & 2)

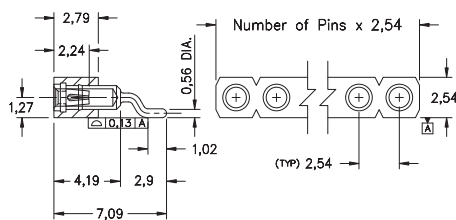

Coplanarity 0,13. For pin counts >10 positions, consult Technical Support.

**FIG. 3**

- Series 351 horizontal surface mount headers are available with 0,46 dia. pluggable pins (MM #5102). Series 330 horizontal surface mount z-bend headers use MM #3027 pins. See page 224 for details
- Series 310 horizontal surface mount Z-Bend sockets uses MM #1023 receptacles that accept pin diameters from 0,38 - 0,64. See pages 171 for details
- Insulators are high temperature thermoplastic, suitable for all soldering operations
- Ideal for daisy chaining parallel boards

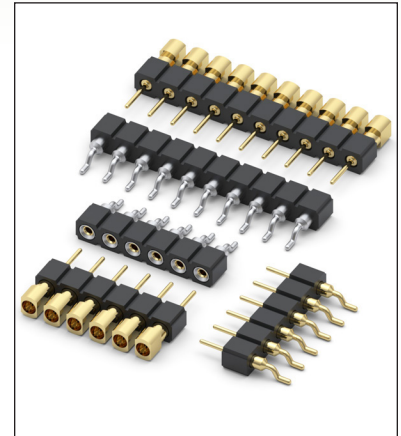

## ORDERING INFORMATION

<b>FIG. 1</b>	<b>Series 351...002</b>	<b>0,46 Dia. Surface Mount Header</b>		
		351-10-1	-40-002000	
	<b>Specify number of pins</b>	02-10		
<b>FIG. 2</b>	<b>Series 330...027</b>	<b>0,46 Dia. Surface Mount Z-Bend Header</b>		
		330-XX-1	-40-027000	
	<b>Specify number of pins</b>	02-10		
<b>SPECIFY PLATING CODE XX=</b>		10	40	
Pin Plating		0,25µm Au	5,08µm Sn	

<b>FIG. 3</b>	<b>Series 310...023</b>	<b>0,46 Dia. Surface Mount Z-Bend Socket</b>					
		310-XX-1	-40-023000				
	<b>Specify number of pins</b>	02-10					
<b>SPECIFY PLATING CODE XX=</b>		91	93	99	41	43	44
Sleeve (Pin)		5,08µm Sn/Pb	5,08µm Sn/Pb	5,08µm Sn/Pb	5,08µm Sn	5,08µm Sn	5,08µm Sn
Contact (Clip)		0,25µm Au	0,76µm Au	2,54µm Sn/Pb	0,25µm Au	0,76µm Au	2,54µm Sn



## X-ON Electronics

Largest Supplier of Electrical and Electronic Components

*Click to view similar products for [Headers & Wire Housings](#) category:*

*Click to view products by [Mill-Max](#) manufacturer:*

Other Similar products are found below :

[892-18-020-10-001101](#) [58102-G61-06LF](#) [582553-1](#) [0009485154](#) [009176003701906](#) [0050291907](#) [LY20-4P-DT1-P1E-BR](#) [02.125.8002.8](#)  
[609-3404](#) [61062-3](#) [622-0430](#) [622-3653LF](#) [63453-116](#) [636-1030](#) [636-1427](#) [636-3427](#) [636-4007](#) [641938-9](#) [641991-4](#) [644827-2](#) [65817-010LF](#)  
[65817-015LF](#) [65863-015LF](#) [66207-023LF](#) [67095-007LF](#) [67601157](#) [68648-049](#) [70.362.1628.0](#) [70-4210](#) [70-4226B](#) [70-4853B](#) [707-5020](#) [707-5028](#) [71.350.2428.0](#) [71918-208LF](#) [71961-016LF](#) [733-134](#) [733-162](#) [754199-000](#) [760-3052](#) [787-8014-00](#) [79531-3000](#) [FCN-360C032-B](#) [FCN-367T-T012/H](#) [FCN-723D010/2](#) [80.063.4001.1](#) [800-90-001-10-001000](#) [800-90-010-10-002000](#) [801-43-002-10-013000](#) [801-43-006-10-002000](#)