

INTERCONNECTS

SERIES 310, 330, 351 • 2,54 GRID (0,46 DIA. PINS), SURFACE MOUNT HEADERS AND SOCKETS • SINGLE ROW STRIPS

Mates with Series 310...023 Surface Mount Z-Bend Socket (See Fig. 3)

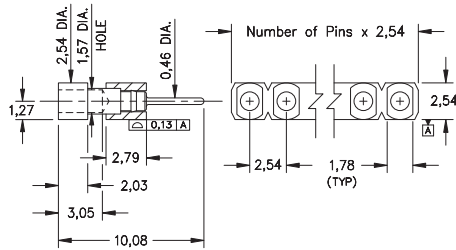

Coplanarity 0,13. For pin counts >10 positions, consult Technical Support.

FIG. 1

Mates with Series 310...023 Surface Mount Z-Bend Socket (See Fig. 3)

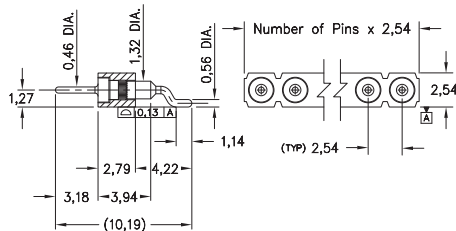

Coplanarity 0,13. For pin counts >10 positions, consult Technical Support.

FIG. 2

Mates with Series 351...002 and 330...027 Surface Mount Header (See Fig. 1 & 2)

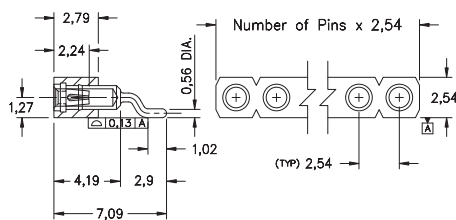

Coplanarity 0,13. For pin counts >10 positions, consult Technical Support.

FIG. 3

- Series 351 horizontal surface mount headers are available with 0,46 dia. pluggable pins (MM #5102). Series 330 horizontal surface mount z-bend headers use MM #3027 pins. See page 224 for details
- Series 310 horizontal surface mount Z-Bend sockets uses MM #1023 receptacles that accept pin diameters from 0,38 - 0,64. See pages 171 for details
- Insulators are high temperature thermoplastic, suitable for all soldering operations
- Ideal for daisy chaining parallel boards

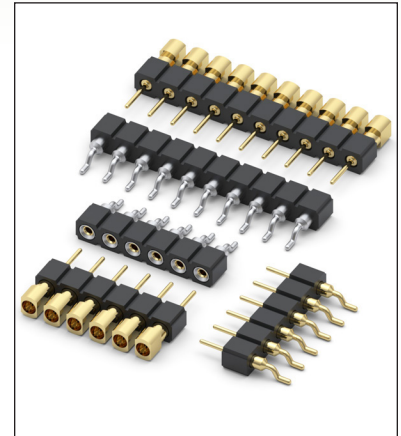

ORDERING INFORMATION

FIG. 1	Series 351...002	0,46 Dia. Surface Mount Header		
		351-10-1	-40-002000	
	Specify number of pins	02-10		
FIG. 2	Series 330...027	0,46 Dia. Surface Mount Z-Bend Header		
		330-XX-1	-40-027000	
	Specify number of pins	02-10		
SPECIFY PLATING CODE XX=		10	40	
Pin Plating		0,25µm Au	5,08µm Sn	

FIG. 3	Series 310...023	0,46 Dia. Surface Mount Z-Bend Socket					
		310-XX-1	-40-023000				
	Specify number of pins	02-10					
SPECIFY PLATING CODE XX=		91	93	99	41	43	44
Sleeve (Pin)		5,08µm Sn/Pb	5,08µm Sn/Pb	5,08µm Sn/Pb	5,08µm Sn	5,08µm Sn	5,08µm Sn
Contact (Clip)		0,25µm Au	0,76µm Au	2,54µm Sn/Pb	0,25µm Au	0,76µm Au	2,54µm Sn



X-ON Electronics

Largest Supplier of Electrical and Electronic Components

Click to view similar products for [Headers & Wire Housings](#) category:

Click to view products by [Mill-Max](#) manufacturer:

Other Similar products are found below :

[892-18-020-10-001101](#) [58102-G61-06LF](#) [582553-1](#) [0009485154](#) [009176003701906](#) [0050291907](#) [LY20-4P-DT1-P1E-BR](#) [02.125.8002.8](#)
[609-3404](#) [61062-3](#) [622-0430](#) [622-3653LF](#) [63453-116](#) [636-1030](#) [636-1427](#) [636-3427](#) [636-4007](#) [641938-9](#) [641991-4](#) [644827-2](#) [65817-010LF](#)
[65817-015LF](#) [65863-015LF](#) [66207-023LF](#) [67095-007LF](#) [67601157](#) [68648-049](#) [70.362.1628.0](#) [70-4210](#) [70-4226B](#) [70-4853B](#) [707-5020](#) [707-5028](#) [71.350.2428.0](#) [71918-208LF](#) [71961-016LF](#) [733-134](#) [733-162](#) [754199-000](#) [760-3052](#) [787-8014-00](#) [79531-3000](#) [FCN-360C032-B](#) [FCN-367T-T012/H](#) [FCN-723D010/2](#) [80.063.4001.1](#) [800-90-001-10-001000](#) [800-90-010-10-002000](#) [801-43-002-10-013000](#) [801-43-006-10-002000](#)