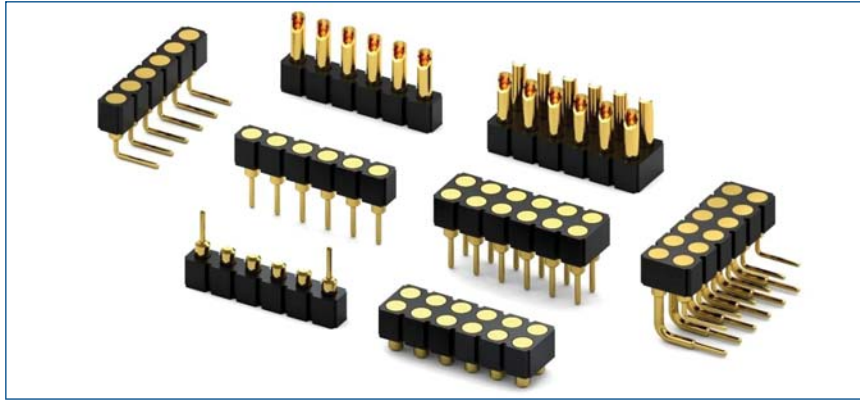


# MAXIMUM SOLUTIONS

## Mill-Max Target Connectors for Spring Pins Hit the Mark



Mill-Max Target Connectors provide a convenient mating surface to connect with Mill-Max spring pins. They can be utilized in any spring pin application requiring conductive lands. Examples are: board stacking, elevated circuits or recharging applications.

Mill-Max precision-machined pins are plated with 10 micro inches hard gold and assembled in high temperature PCT thermoplastic.

The large .070" diameter target pin face is a convenient, easy-to-hit target for .042" diameter plungers, common to Mill-Max spring pins.

In non-standard applications, modifying a Mill-Max Target Connector is a much more cost-effective approach than modifying its complex, multi-part spring pin mate. For more information, visit [www.mill-max.com/PR587](http://www.mill-max.com/PR587).

We offer our spring-loaded connectors in a variety of families of single and double row strip assemblies for .50" or .100" mounting grids – low and high profile surface mount styles are available on carrier tape and through-hole style for manual placement. We also offer a choice of 50+ discrete spring-loaded contacts for use in customer specific assemblies. Ask for datasheet PR561 for details on our spring-loaded parts.

For expert assistance with your specific application, please contact our engineers at [techsupport@mill-max.com](mailto:techsupport@mill-max.com), or call 516-922-6000.

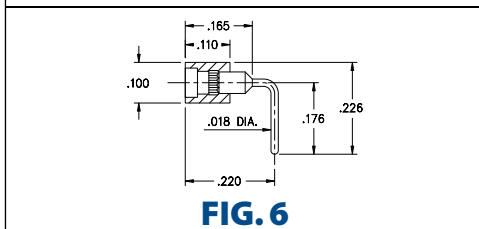
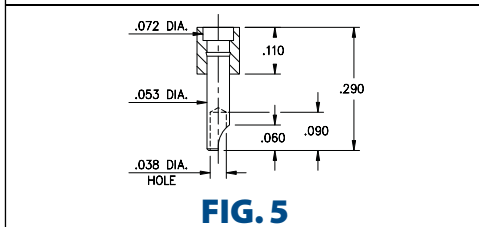
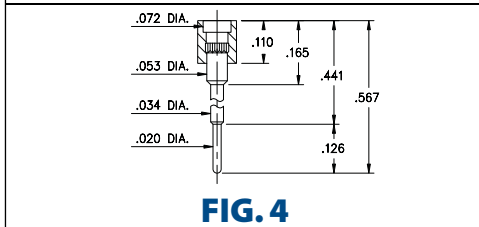
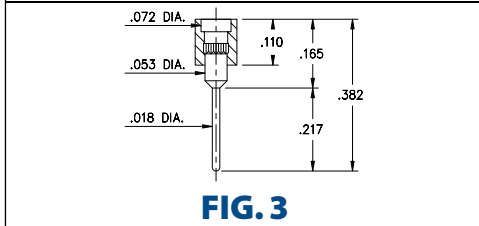
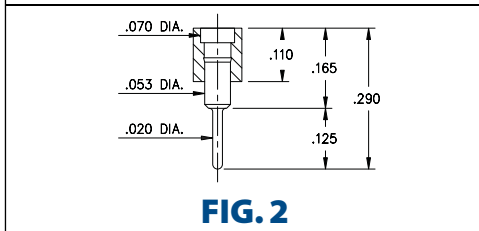
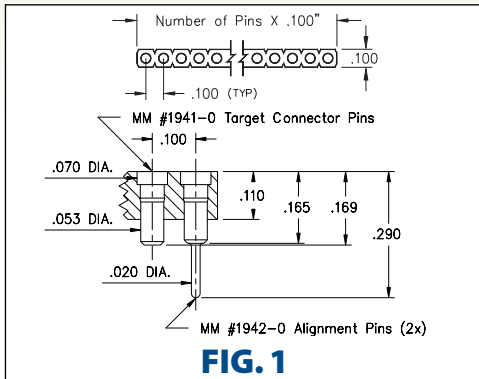
(5/14 -- PR587)

Mill-Max Mfg. Corp. • 190 Pine Hollow Road, Oyster Bay, NY 11771  
516-922-6000 • Fax: 516-922-9253 • [www.mill-max.com](http://www.mill-max.com)

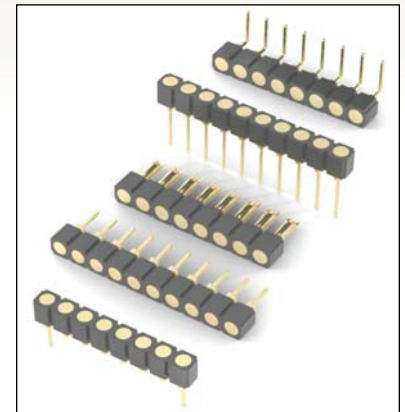


# SPRING-LOADED CONNECTORS

## SERIES 319, 330, 399 • .100" GRID TARGET CONNECTORS FOR SPRING-LOADED ASSEMBLIES • SINGLE ROW STRIPS



- Series 319, 330 and 399 Spring Target Connectors, supplied in single row strips
- Spring Target Connectors present a large flat surface for making contact with our standard .042" dia. spring pin plungers. The target connectors provide an excellent gold-plated conductive path back to the board mounted spring pin connector
- Target connectors use MM #1938, #1940, #1941, #1942 and #3024 pins. See page 218 for details
- Insulators are high temperature thermoplastic



### ORDERING INFORMATION

<b>FIG. 1</b>	<b>Series 319...041</b> <b>Surface Mount w/ Alignments Pins</b>
	319-10-1__-30-041000 Specify number of pins      03-64
<b>FIG. 2</b>	<b>Series 319...001</b> <b>Standard Solder Tails</b>
	319-10-1__-00-001000 Specify number of pins      01-64
<b>FIG. 3</b>	<b>Series 319...002</b> <b>Long Solder Tails</b>
	319-10-1__-00-002000 Specify number of pins      01-64
<b>FIG. 4</b>	<b>Series 319...005</b> <b>Elevated with Solder Tails</b>
	319-10-1__-00-005000 Specify number of pins      01-64
<b>FIG. 5</b>	<b>Series 330...240</b> <b>Solder Cups</b>
	330-10-1__-00-240000 Specify number of pins      01-64
<b>FIG. 6</b>	<b>Series 399...008</b> <b>Right Angle Solder Tails</b>
	399-10-1__-10-008000 Specify number of pins      01-64
<div style="display: flex; justify-content: space-around; align-items: center;"> <div style="border: 1px solid black; padding: 5px; background-color: #90EE90;">RoHS-2 2011/65/EU</div> <div style="border: 1px solid black; border-radius: 50%; padding: 5px;">XX=Plating Code See Below</div> <div style="border: 1px solid black; border-radius: 50%; padding: 5px;">For Electrical, Mechanical &amp; Environmental Data, See page 264</div> </div>	
<b>SPECIFY PLATING CODE XX=</b>	10 <span style="color: green;">◆</span>
Pin Plating	10 μ" Au

# SPRING-LOADED CONNECTORS

## SERIES 419, 430, 499 • .100" GRID TARGET CONNECTORS FOR SPRING-LOADED ASSEMBLIES • DOUBLE ROW STRIPS

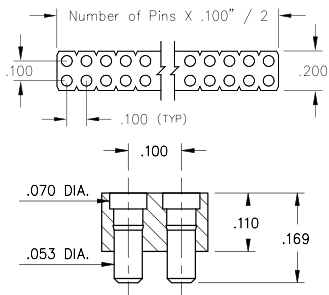
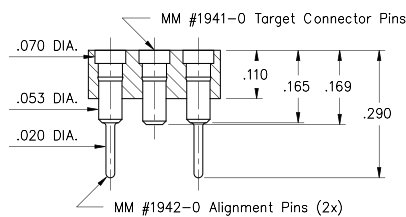
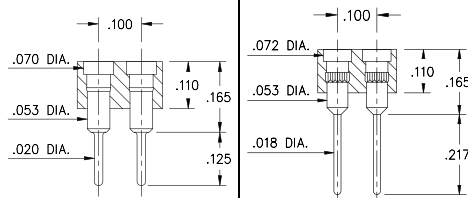


Fig. 1 and Fig. 2 Coplanarity .005". For pin counts >20 positions, consult Technical Support.

**FIG. 1**

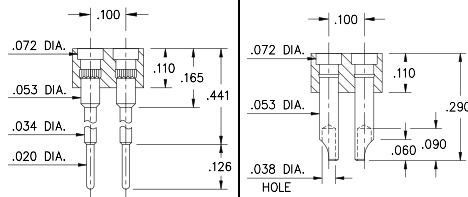


**FIG. 2**



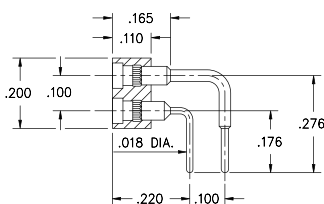
**FIG. 3**

**FIG. 4**



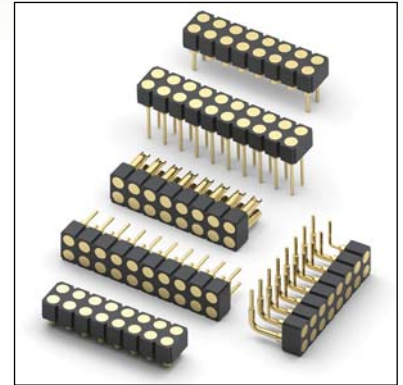
**FIG. 5**

**FIG. 6**



**FIG. 7**

- Series 419, 430 and 499 Spring Target Connectors, supplied in double row strips
- Spring Target Connectors present a large flat surface for making contact with our standard .042" dia. spring pin plungers. The target connectors provide an excellent gold-plated conductive path back to the board mounted spring pin connector
- Target connectors use MM #1938, #1940, #1941, #1942 and #3024 pins. See page 218 for details
- Insulators are high temperature thermoplastic



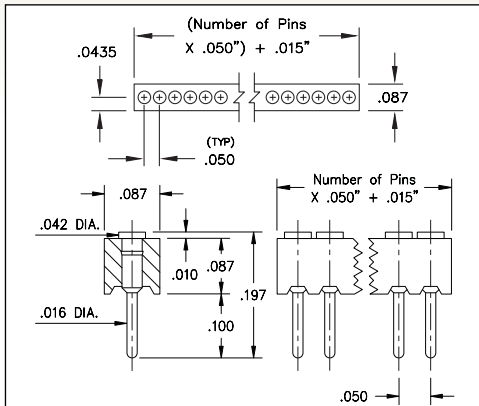
## ORDERING INFORMATION

<b>FIG. 1</b>	<b>Series 419...041</b> <b>Surface Mount</b>	419-10-2__-30-041000	Specify number of pins	04-64
	<b>Series 419...042</b> <b>Surface Mount w/ Alignments Pins</b>	419-10-2__-30-042000	Specify number of pins	06-64
<b>FIG. 3</b>	<b>Series 419...001</b> <b>Standard Solder Tails</b>	419-10-2__-00-001000	Specify number of pins	04-64
	<b>Series 419...002</b> <b>Long Solder Tails</b>	419-10-2__-00-002000	Specify number of pins	04-64
<b>FIG. 5</b>	<b>Series 419...005</b> <b>Elevated with Solder Tails</b>	419-10-2__-00-005000	Specify number of pins	04-64
	<b>Series 430...240</b> <b>Solder Cups</b>	430-10-2__-00-240000	Specify number of pins	04-64
<b>FIG. 7</b>	<b>Series 499...008</b> <b>Right Angle Solder Tails</b>	499-10-2__-10-008000	Specify number of pins	04-64
	<div style="display: flex; justify-content: space-around; align-items: center;"> <div style="border: 1px solid black; padding: 5px; background-color: #c8e6c9;">RoHS-2 2011/65/EU</div> <div style="border: 1px solid black; border-radius: 50%; padding: 5px;">XX=Plating Code See Below</div> <div style="border: 1px solid black; border-radius: 50%; padding: 5px;">For Electrical, Mechanical &amp; Environmental Data, See page 264</div> </div>			
<b>SPECIFY PLATING CODE XX=</b>		10	◆	
Pin Plating			10 μ" Au	

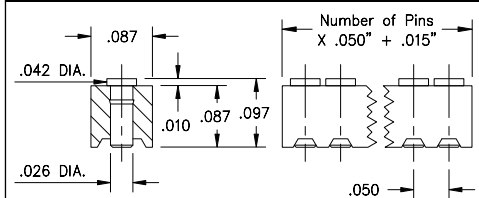


# SPRING-LOADED CONNECTORS

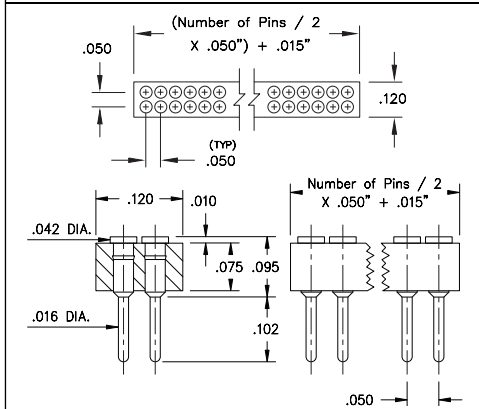
## SERIES 856, 857 • .050" GRID TARGET CONNECTORS FOR SPRING-LOADED ASSEMBLIES • SINGLE AND DOUBLE ROW STRIPS



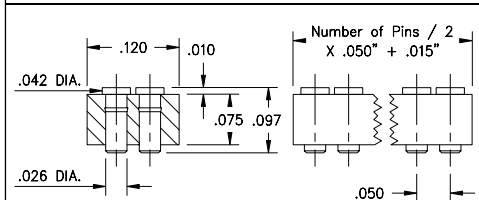
**FIG. 1**



**FIG. 2**

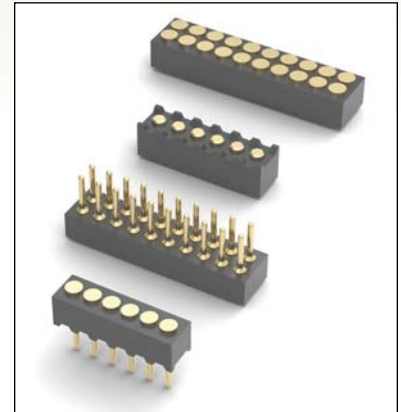


**FIG. 3**



**FIG. 4**

- Series 856 and 857 Spring Target Connectors, supplied in single and double row strips
- Spring Target Connectors present a large flat surface for making contact with our standard .019" dia. spring pin plungers. The target connectors provide an excellent gold-plated conductive path back to the board-mounted spring pin connector
- Target connectors use MM #1933 and #1935 pins. See page 213 for details
- Insulators are high temperature thermoplastic



### ORDERING INFORMATION

	Series 856...051	Standard Solder Tails
<b>FIG. 1</b>	856-10-0	-10-051000
	Specify number of pins	01-20
<b>FIG. 2</b>	Series 856...051	Surface Mount
	856-10-0	-30-051000
	Specify number of pins	02-20
<b>FIG. 3</b>	Series 857...051	Standard Solder Tails
	857-10-0	-10-051000
	Specify number of pins	04-40
<b>FIG. 4</b>	Series 857...051	Surface Mount
	857-10-0	-30-051000
	Specify number of pins	04-40
<div style="display: flex; justify-content: space-around; align-items: center;"> <div style="border: 1px solid black; padding: 5px; background-color: #90EE90;">RoHS-2 2011/65/EU</div> <div style="border: 1px solid black; border-radius: 50%; padding: 5px;">XX=Plating Code See Below</div> <div style="border: 1px solid black; border-radius: 50%; padding: 5px;">For Electrical, Mechanical &amp; Environmental Data, See page 264</div> </div>		
<b>SPECIFY PLATING CODE XX=</b>		10 <span style="color: green;">◆</span>
Pin Plating		10 μ" Au



## X-ON Electronics

Largest Supplier of Electrical and Electronic Components

*Click to view similar products for [Pin & Socket Connectors](#) category:*

*Click to view products by [Mill-Max](#) manufacturer:*

Other Similar products are found below :

[6450822-1](#) [770392-1](#) [794042-1](#) [796885-1](#) [8-794535-1](#) [PLR3455ACS-222](#) [R929991004](#) [R929993003](#) [1403611-1](#) [1-480349-5](#) [152302-5](#)  
[153211-2](#) [1586092-1](#) [1586129-1](#) [1586681-4](#) [1586700-1](#) [1586368-1](#) [1586380-1](#) [1586616-1](#) [1586680-5](#) [16-06-0038](#) [164164-5](#) [1-6609930-1](#)  
[172296-1](#) [19-09-2035](#) [200503-1](#) [200788-2](#) [2029090-4](#) [2029095-4](#) [925061-7](#) [293734-4](#) [293737-2](#) [1-765362-4](#) [1871534-1](#) [200833-4](#)  
[2008625-2](#) [2029027-2](#) [2029096-4](#) [R929991000](#) [R929991002](#) [R929993000](#) [319-10-101-00-005000](#) [319-10-102-00-001000](#) [319-10-104-00-001000](#) [319-10-105-00-001000](#) [319-10-108-00-001000](#) [319-10-112-00-006000](#) [39-01-8019](#) [319-10-101-00-001000](#) [319-10-102-00-005000](#)