



DUAL-IN-LINE SOCKETS

Carrier Type

Ultra Low Profile

Series 614

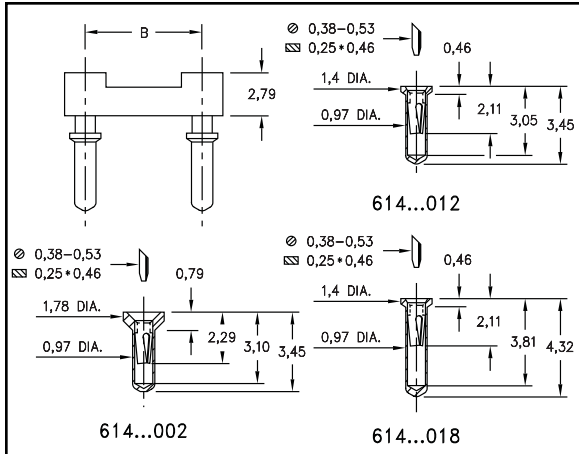

- Ultra low profile receptacles sit only 0,46 to 0,79 high above the board.
- Removable plastic carriers can be returned for reloading.
- Hi-Rel, 3-finger BeCu #11 contact is rated at 3 amps. See page 217 for details.
- Series 614 use MM #0552-1, #0552-2 or #0442-0 pins. See pages 128 and 129 for details.
- Insulators are high temperature thermoplastic.

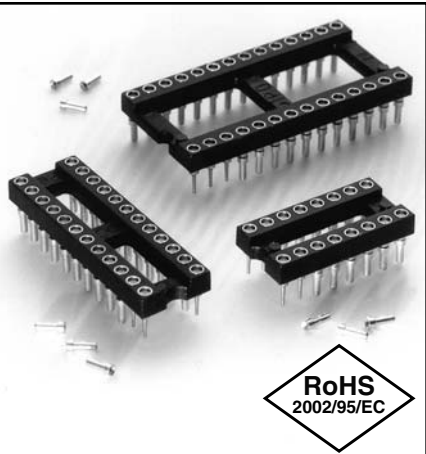

Total number of pins				Quantity per tube	Ordering Information <i>For Electrical, Mechanical & Environmental Data, See pg. 4</i>		
	A	B	C		Length = 3,45 (1,0 Min. Mounting Hole)	Length = 3,45 (1,0 Min. Mounting Hole)	Length = 4,32 (1,0 Min. Mounting Hole)
10	12,6	5,08	7,6	40	614-XX-210-31-012000	614-XX-210-31-002000	614-XX-210-31-018000
4	5,0	7,62	10,1	102	614-XX-304-31-012000	614-XX-304-31-002000	614-XX-304-31-018000
6	7,6	7,62	10,1	67	614-XX-306-31-012000	614-XX-306-31-002000	614-XX-306-31-018000
8	10,1	7,62	10,1	50	614-XX-308-31-012000	614-XX-308-31-002000	614-XX-308-31-018000
10	12,6	7,62	10,1	40	614-XX-310-31-012000	614-XX-310-31-002000	614-XX-310-31-018000
14	17,7	7,62	10,1	28	614-XX-314-31-012000	614-XX-314-31-002000	614-XX-314-31-018000
16	20,3	7,62	10,1	25	614-XX-316-31-012000	614-XX-316-31-002000	614-XX-316-31-018000
18	22,8	7,62	10,1	22	614-XX-318-31-012000	614-XX-318-31-002000	614-XX-318-31-018000
20	25,3	7,62	10,1	20	614-XX-320-31-012000	614-XX-320-31-002000	614-XX-320-31-018000
22	27,8	7,62	10,1	18	614-XX-322-31-012000	614-XX-322-31-002000	614-XX-322-31-018000
24	30,4	7,62	10,1	16	614-XX-324-31-012000	614-XX-324-31-002000	614-XX-324-31-018000
28	35,5	7,62	10,1	14	614-XX-328-31-012000	614-XX-328-31-002000	614-XX-328-31-018000
20	25,4	10,16	12,7	20	614-XX-420-31-012000	614-XX-420-31-002000	614-XX-420-31-018000
22	27,8	10,16	12,7	18	614-XX-422-31-012000	614-XX-422-31-002000	614-XX-422-31-018000
24	30,4	10,16	12,7	16	614-XX-424-31-012000	614-XX-424-31-002000	614-XX-424-31-018000
28	35,5	10,16	12,7	14	614-XX-428-31-012000	614-XX-428-31-002000	614-XX-428-31-018000
32	40,6	10,16	12,7	12	614-XX-432-31-012000	614-XX-432-31-002000	614-XX-432-31-018000
24	30,4	15,24	17,7	16	614-XX-624-31-012000	614-XX-624-31-002000	614-XX-624-31-018000
28	35,5	15,24	17,7	14	614-XX-628-31-012000	614-XX-628-31-002000	614-XX-628-31-018000
32	40,6	15,24	17,7	12	614-XX-632-31-012000	614-XX-632-31-002000	614-XX-632-31-018000
36	45,7	15,24	17,7	11	614-XX-636-31-012000	614-XX-636-31-002000	614-XX-636-31-018000
40	50,8	15,24	17,7	10	614-XX-640-31-012000	614-XX-640-31-002000	614-XX-640-31-018000
42	53,3	15,24	17,7	9	614-XX-642-31-012000	614-XX-642-31-002000	614-XX-642-31-018000
48	60,9	15,24	17,7	8	614-XX-648-31-012000	614-XX-648-31-002000	614-XX-648-31-018000
50	63,5	15,24	17,7	8	614-XX-650-31-012000	614-XX-650-31-002000	614-XX-650-31-018000
52	66,0	15,24	17,7	7	614-XX-652-31-012000	614-XX-652-31-002000	614-XX-652-31-018000
50	63,5	22,86	25,3	8	614-XX-950-31-012000	614-XX-950-31-002000	614-XX-950-31-018000
52	66,0	22,86	25,3	7	614-XX-952-31-012000	614-XX-952-31-002000	614-XX-952-31-018000
64	81,2	22,86	25,3	6	614-XX-964-31-012000	614-XX-964-31-002000	614-XX-964-31-018000

SPECIFY PLATING CODE XX=		93		43 ◇	
Sleeve (Pin)		5,08µm Sn/Pb		5,08µm Sn	<div style="border: 1px solid green; padding: 5px; display: inline-block;"> <i>For RoHS compliance select ◇ plating code.</i> </div>
Contact (Clip)		0,76µm Au		0,76µm Au	

X-ON Electronics

Largest Supplier of Electrical and Electronic Components

Click to view similar products for [IC & Component Sockets](#) category:

Click to view products by [Mill-Max](#) manufacturer:

Other Similar products are found below :

[0066-3-17-15-30-14-02-0](#) [670](#) [672](#) [673](#) [694-13-640-00-672-000](#) [712-93-120-41-001000](#) [714-93-104-31-018000](#) [8059-4G1-LF](#) [807-22-001-10-001101](#) [807-22-001-10-006101](#) [807-22-001-30-011101](#) [807-22-001-30-012101](#) [807-22-001-30-013101](#) [807-22-001-30-014101](#) [8-1437531-4](#) [8150-6P10](#) [833-93-034-10-001000](#) [851-41-006-10-001000](#) [851-43-008-20-001000](#) [851-43-014-20-001000](#) [851-93-006-20-001000](#) [851-93-010-20-001000](#) [853-43-020-10-001000](#) [86.010.0053.0](#) [116-43-308-41-007000](#) [PX-68LCC](#) [121-13-318-41-001000](#) [121-13-320-41-001000](#) [121-13-308-41-001000](#) [123-43-314-41-801000](#) [123-43-420-41-001000](#) [123-87-320-41-001101](#) [122-13-316-41-001000](#) [123-13-624-41-001000](#) [123-43-306-41-001000](#) [12-3513-11](#) [123-91-320-41-001000](#) [126-43-310-41-002000](#) [AKSUN 37V-T](#) [1437503-9](#) [1437504-1](#) [146-44-308-41-013000](#) [APO-320-G-T](#) [146-43-308-41-012000](#) [160-10-308-00-001000](#) [160-40-320-00-001000](#) [214-99-306-01-670800](#) [232-1270-02-0602](#) [2-382761-4](#) [2-5331677-4](#)