

# INTERCONNECTS

## SERIES 800, 801, 830 • 2,54 GRID (0,76 DIA. PINS), SURFACE MOUNT HEADERS AND SOCKETS • SINGLE ROW STRIPS

### Mates with Series 801...002 Surface Mount Z-Bend Socket (See Fig. 3)

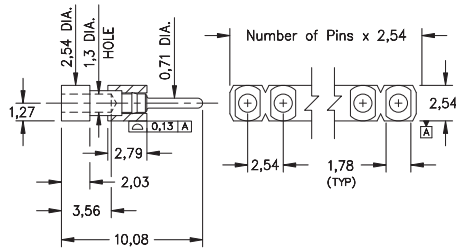

Coplanarity 0,13. For pin counts >10 positions, consult Technical Support.

**FIG. 1**

### Mates with Series 801...002 Surface Mount Z-Bend Socket (See Fig. 3)

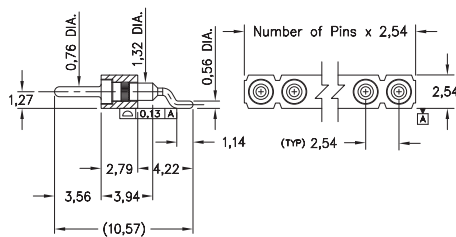

Coplanarity 0,13. For pin counts >10 positions, consult Technical Support.

**FIG. 2**

### Mates with Series 800...002 and 830...028 Surface Mount Header (See Fig. 1 & 2)

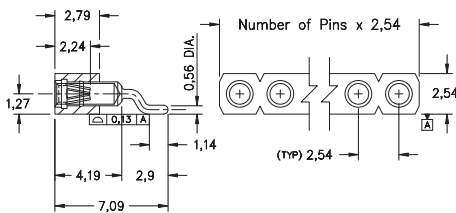

Coplanarity 0,13. For pin counts >10 positions, consult Technical Support.

**FIG. 3**

- Series 800 horizontal surface mount headers are available with 0,71 dia. pluggable pins (MM #1502). Series 830 horizontal surface mount z-bend headers use MM #3028 pins. See page 224 for details
- Series 801 horizontal surface mount Z-Bend sockets uses MM #1303 receptacles that accept pin diameters from 0,64 - 0,94 and 0,64 square leads. See pages 180 for details
- Insulators are high temperature thermoplastic, suitable for all soldering operations
- Ideal for daisy chaining parallel boards

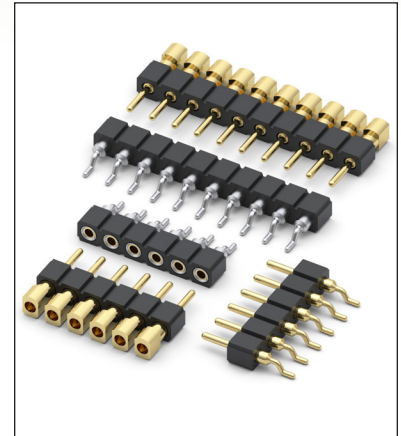

## ORDERING INFORMATION

<b>FIG. 1</b>	<b>Series 800...002</b>	<b>0,71 Dia. Surface Mount Header</b>		
		800-10-0	-40-002000	02-10
		Specify number of pins		
<b>FIG. 2</b>	<b>Series 830...028</b>	<b>0,76 Dia. Surface Mount Z-Bend Header</b>		
		830-XX-0	-40-028000	02-10
		Specify number of pins		
<b>SPECIFY PLATING CODE XX=</b>		10	40	
Pin Plating		0,25µm Au	5,08µm Sn	

<b>FIG. 3</b>	<b>Series 801...002</b>	<b>0,71 Dia. Surface Mount Z-Bend Socket</b>					
		801-XX-0	-40-002000	02-10			
		Specify number of pins					
<b>SPECIFY PLATING CODE XX=</b>		91	93	99	41	43	44
Sleeve (Pin)		5,08µm Sn/Pb	5,08µm Sn/Pb	5,08µm Sn/Pb	5,08µm Sn	5,08µm Sn	5,08µm Sn
Contact (Clip)		0,25µm Au	0,76µm Au	2,54µm Sn/Pb	0,25µm Au	0,76µm Au	2,54µm Sn



## X-ON Electronics

Largest Supplier of Electrical and Electronic Components

*Click to view similar products for [Headers & Wire Housings](#) category:*

*Click to view products by [Mill-Max](#) manufacturer:*

Other Similar products are found below :

[892-18-020-10-001101](#) [58102-G61-06LF](#) [582553-1](#) [0009485154](#) [009176003701906](#) [0050291907](#) [LY20-4P-DT1-P1E-BR](#) [02.125.8002.8](#)  
[609-3404](#) [61062-3](#) [622-0430](#) [622-3653LF](#) [63453-116](#) [636-1030](#) [636-1427](#) [636-3427](#) [636-4007](#) [641938-9](#) [641991-4](#) [644827-2](#) [65817-010LF](#)  
[65817-015LF](#) [65863-015LF](#) [66207-023LF](#) [67095-007LF](#) [67601157](#) [68648-049](#) [70.362.1628.0](#) [70-4210](#) [70-4226B](#) [70-4853B](#) [707-5020](#) [707-](#)  
[5028](#) [71.350.2428.0](#) [71918-208LF](#) [71961-016LF](#) [733-134](#) [733-162](#) [754199-000](#) [760-3052](#) [787-8014-00](#) [79531-3000](#) [FCN-360C032-B](#) [FCN-](#)  
[367T-T012/H](#) [FCN-723D010/2](#) [80.063.4001.1](#) [800-90-001-10-001000](#) [800-90-010-10-002000](#) [801-43-002-10-013000](#) [801-43-006-10-002000](#)