

Coaxial Power Splitter/Combiner

ZCSC-3-R3+

3 Way-0° 50Ω 2 to 300 MHz

Maximum Ratings

Operating Temperature	-55°C to 100°C
Storage Temperature	-55°C to 100°C
Power Input (as a splitter)	1W max.
Internal Dissipation	0.375W max.

Permanent damage may occur if any of these limits are exceeded.

Coaxial Connections

SUM PORT	S
PORT 1	1
PORT 2	2
PORT 3	3

Outline Drawing

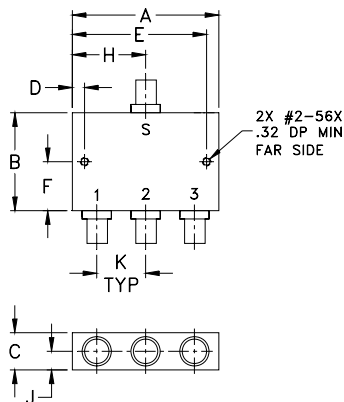

Outline Dimensions (inch/mm)

A	B	C	D	E	F	
1.50	1.00	.38	.125	1.375	5.70	
38.10	25.40	9.65	3.18	34.93	12.70	
G	H	J	K			wt
--	.75	.19	.50			grams
--	19.05	4.83	12.70			28

Features

- low insertion loss, 0.4 dB typ.
- high isolation, 31 dB typ.
- excellent VSWR, 1.1:1 typ.
- excellent phase unbalance 1 deg. typ.
- rugged shielded case

Applications

- VHF/UHF
- instrumentation
- communication system

Electrical Specifications at 25°C

FREQ. RANGE (MHz)	ISOLATION (dB)						INSERTION LOSS (dB) ABOVE 4.8 dB						PHASE UNBALANCE (Degrees)			AMPLITUDE UNBALANCE (dB)		
	L		M		U		L		M		U		L	M	U	L	M	U
f_L - f_U	Typ.	Min.	Typ.	Min.	Typ.	Min.	Typ.	Max.	Typ.	Max.	Typ.	Max.	Max.	Max.	Max.	Max.	Max.	
2-300	32	26	31	28	32	22	0.3	0.8	0.4	1.0	0.8	1.2	1.0	2.0	3.0	0.1	0.3	0.3

L = low range [f_L to $10 f_L$] M = mid range [$10 f_L$ to $f_U/2$] U = upper range [$f_U/2$ to f_U]

Typical Performance Data

Freq. (MHz)	Total Loss ¹ (dB)			Amp. Unbal. (dB)	Isolation (dB)			Phase Unbal. (deg.)	VSWR S	VSWR 1	VSWR 2	VSWR 3
	S-1	S-2	S-3		1-2	1-3	2-3					
2.00	5.07	5.06	5.07	0.00	31.14	31.55	31.03	0.03	1.11	1.09	1.09	1.09
4.00	5.05	5.04	5.05	0.01	31.99	32.25	31.85	0.02	1.11	1.07	1.07	1.07
14.00	5.05	5.04	5.05	0.01	32.30	32.50	32.24	0.05	1.11	1.06	1.06	1.06
20.00	5.05	5.04	5.05	0.01	32.17	32.44	32.21	0.04	1.10	1.05	1.05	1.05
44.00	5.08	5.07	5.08	0.01	31.81	32.22	31.97	0.09	1.09	1.04	1.04	1.04
68.00	5.10	5.09	5.11	0.01	31.49	32.04	31.82	0.23	1.08	1.03	1.03	1.03
92.00	5.11	5.11	5.12	0.01	31.25	32.01	31.79	0.32	1.07	1.03	1.03	1.02
120.00	5.13	5.13	5.16	0.03	31.15	32.15	31.93	0.33	1.07	1.04	1.04	1.04
150.00	5.18	5.18	5.25	0.06	31.34	32.56	32.42	0.42	1.06	1.04	1.05	1.05
180.00	5.17	5.17	5.26	0.09	31.91	33.29	33.26	0.45	1.04	1.03	1.03	1.04
220.00	5.19	5.20	5.33	0.14	33.67	35.24	35.57	0.56	1.04	1.04	1.04	1.04
250.00	5.30	5.31	5.47	0.18	36.27	37.44	39.06	0.68	1.10	1.07	1.07	1.09
270.00	5.28	5.30	5.48	0.21	38.73	38.61	42.11	0.76	1.14	1.08	1.08	1.10
290.00	5.29	5.31	5.51	0.23	40.66	38.38	42.54	0.72	1.17	1.07	1.08	1.11
300.00	5.29	5.31	5.54	0.25	40.04	37.45	40.72	0.81	1.18	1.07	1.07	1.10

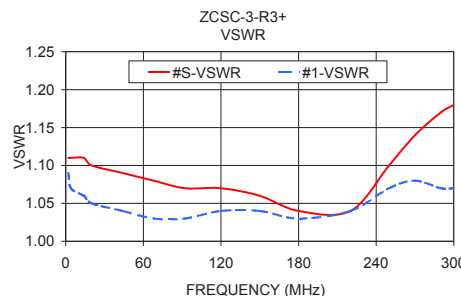
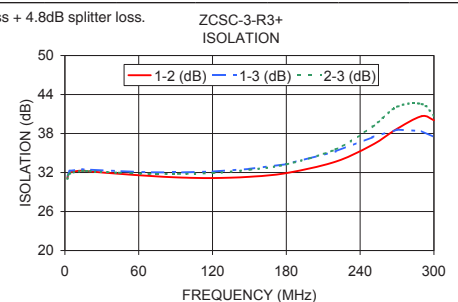
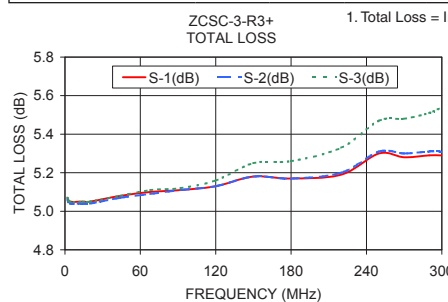

electrical schematic



Notes

- Performance and quality attributes and conditions not expressly stated in this specification document are intended to be excluded and do not form a part of this specification document.
- Electrical specifications and performance data contained in this specification document are based on Mini-Circuit's applicable established test performance criteria and measurement instructions.
- The parts covered by this specification document are subject to Mini-Circuits standard limited warranty and terms and conditions (collectively, "Standard Terms"); Purchasers of this part are entitled to the rights and benefits contained therein. For a full statement of the Standard Terms and the exclusive rights and remedies thereunder, please visit Mini-Circuits' website at www.minicircuits.com/WCLStore/terms.jsp



X-ON Electronics

Largest Supplier of Electrical and Electronic Components

Click to view similar products for [Signal Conditioning](#) category:

Click to view products by [Mini-Circuits](#) manufacturer:

Other Similar products are found below :

[MAPDCC0001](#) [MAPDCC0004](#) [PD0409J5050S2HF](#) [880157](#) [HHS-109-PIN](#) [DC1417J5005AHF](#) [AFS14A30-2185.00-T3](#) [AFS14A35-1591.50-T3](#) [DS-323-PIN](#) [B39321R801H210](#) [1A0220-3](#) [JP510S](#) [LFB212G45SG8C341](#) [LFB322G45SN1A504](#) [LFL182G45TC3B746](#) [SF2159E](#) [30057](#) [FM-104-PIN](#) [CER0813B](#) [MAPDCC0005](#) [3A325](#) [40287](#) [41180](#) [ATB3225-75032NCT](#) [BD0810N50100AHF](#) [BD2425J50200AHF](#) [C5060J5003AHF](#) [JHS-115-PIN](#) [JP503AS](#) [DC0710J5005AHF](#) [DC2327J5005AHF](#) [DC3338J5005AHF](#) [43020](#) [LFB2H2G60BB1C106](#) [LFL15869MTC1B787](#) [X3C19F1-20S](#) [XC3500P-20S](#) [10013-20](#) [SF2194E](#) [CDBLB455KCAX39-B0](#) [TGL2208-SM, EVAL](#) [RF1353C](#) [PD0922J5050D2HF](#) [1E1305-3](#) [1G1304-30](#) [B0922J7575AHF](#) [2020-6622-20](#) [TP-102-PIN](#) [TP-103-PIN](#) [BD1222J50200AHF](#)