

| REV. | ECN. NO.          | APPD.          |
|------|-------------------|----------------|
| A    |                   |                |
| 序号   | 品名                | 材质             |
| ①    | 1.0E压胶态<br>(H2.0) | LCP UL94V-0 本色 |
| ②    | 0.5E压端子<br>(H2.0) | 铜合金/表面镀锡<br>镀金 |
| ③    | 0.5E压后盖<br>(H2.0) | LCP UL94V-0 黑色 |
| ④    | 0.5E压垫片<br>(H2.0) | 铜合金/表面镀锡       |

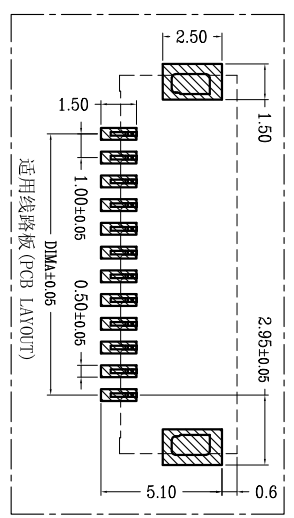
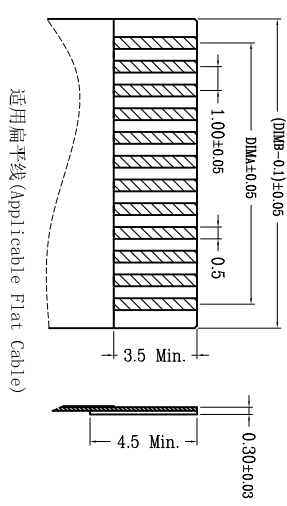
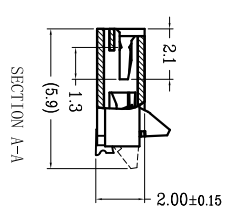
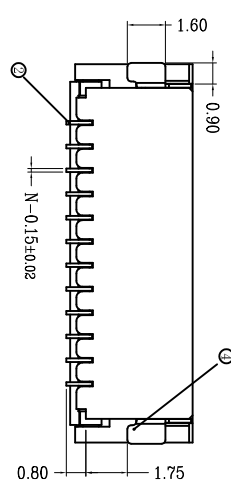
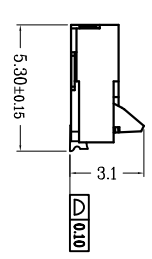
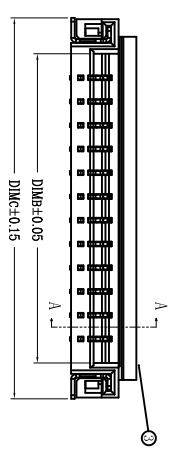
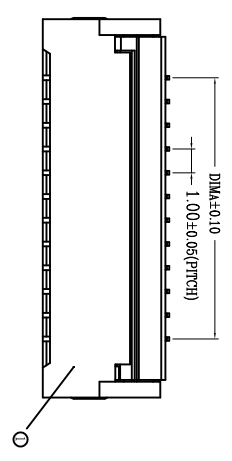

| CKT | DIMA  | DIMB  | DIMC  |
|-----|-------|-------|-------|
| 4   | 3.00  | 5.02  | 8.04  |
| 5   | 4.00  | 6.02  | 9.04  |
| 6   | 5.00  | 7.02  | 10.04 |
| 7   | 6.00  | 8.02  | 11.04 |
| 8   | 7.00  | 9.02  | 12.04 |
| 9   | 8.00  | 10.02 | 13.04 |
| 10  | 9.00  | 11.02 | 14.04 |
| 11  | 10.00 | 12.02 | 15.04 |
| 12  | 11.00 | 13.02 | 16.04 |
| 13  | 12.00 | 14.02 | 17.04 |
| 14  | 13.00 | 15.02 | 18.04 |
| 15  | 14.00 | 16.02 | 19.04 |
| 16  | 15.00 | 17.02 | 20.04 |
| 17  | 16.00 | 18.02 | 21.04 |
| 18  | 17.00 | 19.02 | 22.04 |
| 19  | 18.00 | 20.02 | 23.04 |
| 20  | 19.00 | 21.02 | 24.04 |
| 21  | 20.00 | 22.02 | 25.04 |
| 22  | 21.00 | 23.02 | 26.04 |
| 23  | 22.00 | 24.02 | 27.04 |
| 24  | 23.00 | 25.02 | 28.04 |
| 25  | 24.00 | 26.02 | 29.04 |
| 26  | 25.00 | 27.02 | 30.04 |
| 27  | 26.00 | 28.02 | 31.04 |
| 28  | 27.00 | 29.02 | 32.04 |
| 29  | 28.00 | 30.02 | 33.04 |
| 30  | 29.00 | 31.02 | 34.04 |

技术指标:  
 1. 塑件表面应光洁、无毛边、无明显收缩、缺陷、裂纹等现象。  
 2. 温度范围: -25°C~85°C。  
 3. 额定电压: 50V, AC/DC(等效)。  
 4. 接触电阻: ≤0.03Ω。  
 5. 绝缘电阻: ≥500MΩ。  
 6. 产品料号:  
 HW10200—XX X X

NO OF CKT (产品PIN数) → XX X X  
 Plating(电镀方式) → T  
 0: 端子全穿锡  
 1: 端子全金(G/F OVERALL)  
 5: 端子半金锡

Packing(包装方式)  
 T: TUBE 管装  
 R: TAPE & REEL 卷装

| X.   | ± 0.30 | X°    | ± 5°   | UNITS  | mm | NAME(INTENDED USE) |
|------|--------|-------|--------|--------|----|--------------------|
| X    | ± 0.20 | X°    | ± 2°   | MATL   |    |                    |
| .XX  | ± 0.10 | .XX°  | ± 1°   |        |    |                    |
| .XXX | ± 0.05 | .XXX° | ± 0.5° | FINISH |    |                    |

| FPC CONNECTOR | QTY | NAME(INTENDED USE)     |
|---------------|-----|------------------------|
|               |     | PART NO.(INTENDED USE) |
|               |     | APPD: SUNNY            |
|               |     | CHKD: LISA             |
|               |     | DR: ZOE                |
|               |     | 2019-07-11             |

| TITLE:              |     | MINTRON CO.,LTD.      |     |
|---------------------|-----|-----------------------|-----|
| FPC1.0 后压卧式 (H=2.0) |     | DWG NO.: HW10200-XXXX |     |
| SCALE               | 1/1 | SHEET                 | 1/1 |
| REV.                | A   |                       |     |

## X-ON Electronics

Largest Supplier of Electrical and Electronic Components

*Click to view similar products for [FFC & FPC Connectors](#) category:*

*Click to view products by [MINTRON](#) manufacturer:*

Other Similar products are found below :

[00-6200-227-022-800](#) [006205250500825+](#) [006205280500825+](#) [FPH-1602G](#) [086222026001800](#) [52610-0675](#) [62674-201121DLF](#) [52746-1671-TR250](#) [10051922-1610EHLF](#) [10051922-2810EHLF](#) [686322124422](#) [XF3M-2915-1B-R100](#) [AYF353125A](#) [AYF530665TA](#) [AYF534065TA](#) [20FLH-RSM1-TB](#) [PCA-7F-25-HL-3-G](#) [207356-1](#) [52807-0430](#) [FFC05011-10SBB114W5M](#) [502250-8027](#) [FH28K-40S-0.5SH](#) [200528-0260](#) [FH28K-10S-0.5SH](#) [501951-1250](#) [X05B20U43T](#) [0.5K-DX-30PWB](#) [DS1020-08-10VBT12](#) [THD0515-34CL-GF](#) [X05A10L28G](#) [ECC2841061EU](#) [20539-030E-01](#) [1.0K-DHQX-16PWB](#) [1.0K-DHQX-30PWB](#) [1775333-6](#) [10054365-202110ELF](#) [10054365-242110ELF](#) [10054365-282110ELF](#) [10064555-392220HLF](#) [59453-041110EBHLF](#) [59453-091110EDHLF](#) [62674-241141ALF](#) [62684-432100ALF](#) [62684-451100AHLF](#) [62684-5721N0ALF](#) [HFW11R-1STE1MTLF](#) [HFW12R-1STE9LF](#) [HFW14R-1STE9MTLF](#) [HFW18S-2STE9LF](#) [HFW20R-1STAE1HLF](#)