

REV.	ECN. NO.	APPD.
A		
REV.	ECN. NO.	APPD.

REV.	ECN. NO.	APPD.
A		
REV.	ECN. NO.	APPD.

序号	品名	材质
①	1.0 K型连接器 (H2.5)	LCF UL94V-0 米色
②	1.0 K型立式端子 (H5.5)	铜合金/表面镀锌
③	1.0 K型立式后盖 (H2.5)	LCF UL94V-0 黑色
④	1.0 K型立式垫片 (H5.5)	铜合金/表面镀锌

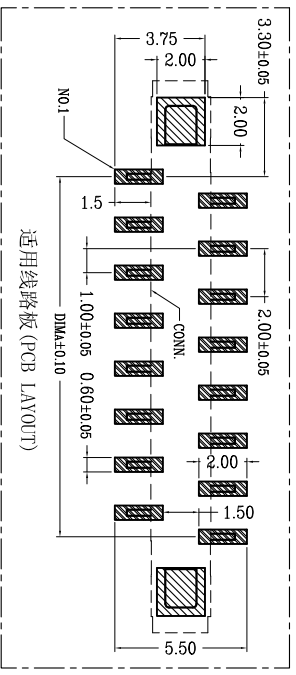
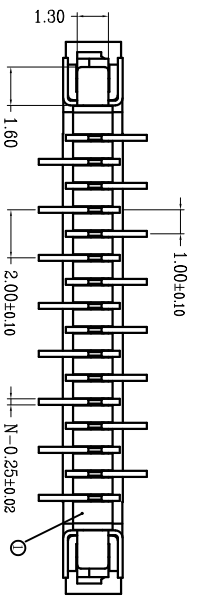
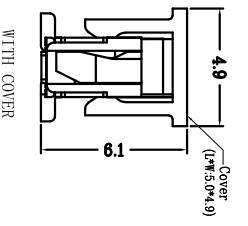
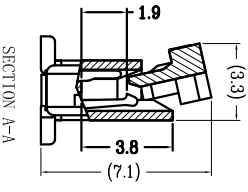
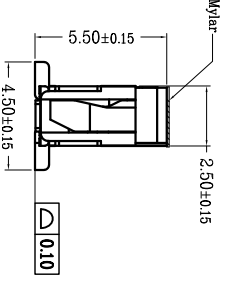
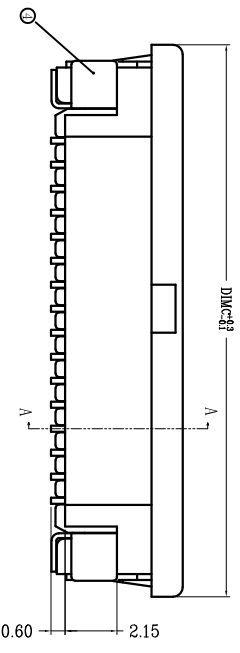
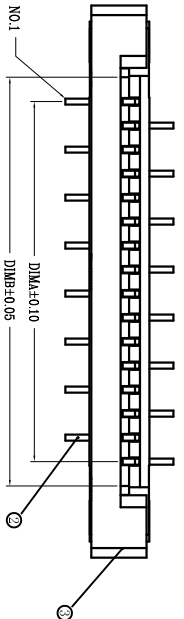
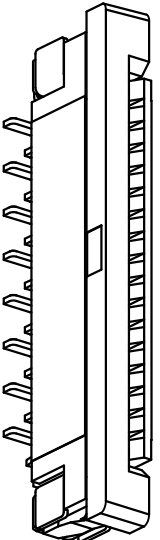

CKT	D1M	D1M	D1M	D1M
4	3.00	5.03	11.10	
5	4.00	6.03	12.10	
6	5.00	7.03	13.10	
7	6.00	8.03	14.10	
8	7.00	9.03	15.10	
9	8.00	10.03	16.10	
10	9.00	11.03	17.10	
11	10.00	12.03	18.10	
12	11.00	13.03	19.10	
13	12.00	14.03	20.10	
14	13.00	15.03	21.10	
15	14.00	16.03	22.10	
16	15.00	17.03	23.10	
17	16.00	18.03	24.10	
18	17.00	19.03	25.10	
19	18.00	20.03	26.10	
20	19.00	21.03	27.10	
21	20.00	22.03	28.10	
22	21.00	23.03	29.10	
23	22.00	24.03	30.10	
24	23.00	25.03	31.10	
25	24.00	26.03	32.10	
26	25.00	27.03	33.10	
27	26.00	28.03	34.10	
28	27.00	29.03	35.10	
29	28.00	30.03	36.10	
30	29.00	31.03	37.10	
31	30.00	32.03	38.10	
32	31.00	33.03	39.10	
33	32.00	34.03	40.10	
34	33.00	35.03	41.10	
35	34.00	36.03	42.10	
36	35.00	37.03	43.10	
37	36.00	38.03	44.10	
38	37.00	39.03	45.10	
39	38.00	40.03	46.10	
40	39.00	41.03	47.10	

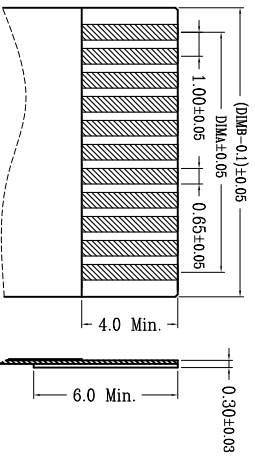

技术指标:

1. 塑件表面应光洁、无毛边、无明显收缩、缺陷、裂纹等现象。
2. 温度范围: -25°C~85°C。
3. 额定电压: 50V, AC/DC(等效)。
4. 接触电阻: ≤0.03Ω。
5. 绝缘电阻: ≥500MΩ。
6. 产品料号: LL10553-XX X X

NO OF CKT (产品PIN数)
Plating(电镀方式)
O: 端子全雾锡
1: 端子全金(G/F OVERALL)

Packing(包装方式)
T: TUBE 管装
R: TAPE & REEL 卷装
C: TAPE & REEL WITH COVER 加盖卷装

TITLE: FPC1.0 K型立式正副位

MINTRON CO., LTD.

NAME(INTENDED USE)	UNITS	mm
X. ±0.30	X.° ±5°	
.X ±0.20	.X° ±2°	MATL
.XX ±0.10	.XX° ±1°	
.XXX ±0.05	.XXX° ±0.5°	FINISH

PART NO.(INTENDED USE)	APPD:	SUNNY
	CHKD: LISA	
	DR: ZOE	2015-12-10

DWG NO.:	SCALE	SHEET	REV.
LL10553-XXXX	1/1	1/1	A

X-ON Electronics

Largest Supplier of Electrical and Electronic Components

Click to view similar products for [FFC & FPC Connectors](#) category:

Click to view products by [MINTRON](#) manufacturer:

Other Similar products are found below :

[00-6200-227-022-800](#) [006205250500825+](#) [006205280500825+](#) [FPH-1602G](#) [086222026001800](#) [52610-0675](#) [62674-201121DLF](#) [52746-1671-TR250](#) [10051922-1610EHLF](#) [10051922-2810EHLF](#) [686322124422](#) [XF3M-2915-1B-R100](#) [AYF353125A](#) [AYF530665TA](#) [AYF534065TA](#) [20FLH-RSM1-TB](#) [PCA-7F-25-HL-3-G](#) [207356-1](#) [52807-0430](#) [FFC05011-10SBB114W5M](#) [502250-8027](#) [FH28K-40S-0.5SH](#) [200528-0260](#) [FH28K-10S-0.5SH](#) [501951-1250](#) [X05B20U43T](#) [0.5K-DX-30PWB](#) [DS1020-08-10VBT12](#) [THD0515-34CL-GF](#) [X05A10L28G](#) [ECC2841061EU](#) [20539-030E-01](#) [1.0K-DHQX-16PWB](#) [1.0K-DHQX-30PWB](#) [1775333-6](#) [10054365-202110ELF](#) [10054365-242110ELF](#) [10054365-282110ELF](#) [10064555-392220HLF](#) [59453-041110EBHLF](#) [59453-091110EDHLF](#) [62674-241141ALF](#) [62684-432100ALF](#) [62684-451100AHLF](#) [62684-5721N0ALF](#) [HFW11R-1STE1MTLF](#) [HFW12R-1STE9LF](#) [HFW14R-1STE9MTLF](#) [HFW18S-2STE9LF](#) [HFW20R-1STAE1HLF](#)